



b-MOLA 空氣處理系統 使用說明書

型號：NCCO1701

目錄

基本信息	2-5
• 安全注意事項	2-3
• NCCO 技術	4
• 主要部件名稱	5
使用入門	6-8
• 初次使用	6
• 使用說明	7-8
維護保養	9-10
• 清潔方法	9
• 濾網的護理和更換	10
其他	11-13
• 常見問題	11
• 疑難排解	12
• 產品規格	13



附保證

感謝您選用b-MOLA空氣處理系統。
使用和維護本產品前，請仔細閱讀本使用說明書。
使用本產品前請務必仔細閱讀「安全注意事項」。
不遵照說明書使用本產品有可能導致受傷或財產受損。
請妥善保管此說明書以供日後參考。
請妥善保管保證以備日後維修之用。



基本信息

請務必遵守

安全注意事項

- 八歲或以上兒童，有身體缺陷，感官或精神問題，或者缺乏知識經驗的人士在獲得有關安全使用本裝置的監督/指導，並清楚所涉及的危害情況下可以使用本裝置。請勿讓兒童將本裝置當作玩具。兒童不得在沒有監督/指導的情況下進行清洗和維護設備的相關工作。
- 如果電源線損壞，必須由製造商或合資格服務供應商進行更換，以免出現危險。
- 進行清潔和保養前，必須切斷本產品的電源。

■ 為了避免對您或其他人造成傷害或財物損害，請務必遵守安全注意事項。

以下標誌是根據錯誤使用所產生的危險或受傷程度進行分類。

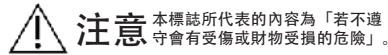
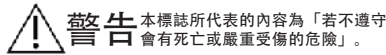

■ 以下標誌為務必遵守的指示種類。（下列標誌為例子）

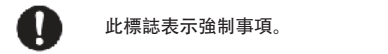

警告

- 禁止拉扯電源線來移動本產品。
(否則電源線可能會損壞，導致火災或觸電)
- 禁止損壞電源線或電源插頭。
- 禁止切割、改裝、過度扭曲、擰絞、擠壓電源線，禁止電源線靠近熱源或在電源線上壓放重物等。
(否則電源線可能會損壞，導致火災或觸電)
- 禁止使用指定電壓（110-240V~ 50-60Hz）以外的電源。
(否則電源線可能會過熱，導致火災)
- 禁止將手指或金屬物等異物放入進風口、出風口或縫隙中。
(否則可能會接觸到產品內部，導致觸電或受傷)
- 禁止手濕時觸摸電源插頭。
(否則可能會導致觸電)
- 禁止將本產品放置在容易被水或其他液體濺到的地方。
(否則可能會造成短路，導致火災或觸電的危險)



● 當有以下任何情況出現時，請立即停止使用本產品並拔出電源插頭。

否則可能會導致觸電、起火或冒煙)
<以下為異常故障的例子>

- 移動電源線時，產品運轉停止；
 - 如果任何控制按鈕故障；
 - 如果斷路器起作用或保險絲燒毀；
 - 如果電源線或電源插頭異常發熱；
 - 如果您發覺有燒焦的異味或異常的聲音或振動；
 - 如果有其他任何異常現象或故障。
- 立即停止操作本產品，並拔出電源插頭，聯絡客戶諮詢服務中心或經銷商進行檢查、維修。

請定期清潔電源插頭。

(如果電源插頭上有灰塵、濕氣，可能會破壞電源插頭的絕緣部分，導致火災)

- 拔出電源插頭，用乾布擦淨。
- 長期不使用產品時，應拔出電源插頭。

維護保養產品前，請務必拔出電源插頭。

(否則產品可能會突然運轉，導致觸電或受傷)

請將電源插頭完全插入電源插座。

(如果電源插頭沒有完全插牢，可能會造成電源線過熱，導致火災或觸電)

- 禁止使用已損壞的電源插頭或鬆動的電源插座。

- 禁止擅自拆開或改裝本產品。
(否則產品可能會異常動作或起火，引起火災或觸電)
→ 需要維修時請聯繫客戶諮詢服務中心或經銷商。

基本信息

請務必遵守

安全注意事項

注意

- 禁止放置本產品於以下場所。
 - 不平穩的場所（否則產品可能會翻倒，導致受傷或產品損壞）
 - 浴室或廚房等濕潤或高溫場所（否則可能會令到產品破裂、漏電，導致火災、觸電或受傷的危險）
 - 油或可燃性氣體可能出現洩漏的場所（否則吸入產品內可能會起火，導致火災）
 - 暖爐等熱源附近（否則產品可能會過熱，導致火災）
- 禁止使用汽油或其他揮發性混合溶劑擦拭產品。
(否則產品可能會破裂或短路，導致受傷、火災或觸電)
- 使用煙熏型殺蟲劑時，禁止運轉產品。
(否則產品內可能會積聚藥物，然後從出風口排出，危害身體健康)
→ 使用殺蟲劑後，應先讓房間徹底通風，然後才可運轉產品。
- 禁止阻塞入風口或出風口，例如放置衣物或書本等雜物。
(否則會導致冒煙、起火)
- 禁止坐、站立或倚靠本產品。
(否則產品可能會翻倒，導致受傷或產品損壞)
- 有小孩的家庭要多加注意。
- 禁止將點燃的香煙、香火等接近產品。
(否則易燃物可能會被吸入產品內導致起火，發生火災)
- 禁止在本產品周圍噴灑殺蟲劑或空氣清新劑等易燃物品。

- 請手持插頭部位拔出電源插頭。
(否則電源線可能會損壞，導致火災或觸電)

基本信息

NCCO技術

獨有 NCCO 氧聚解專利技術，給您帶來清新潔淨的空氣

NCCO (Nano Confined Catalytic Oxidation) 納米氧聚解空氣處理技術，是與香港科技大學創業計劃成員合作研發，並且獲得全球多國專利，可以全方位解決室內空氣質素問題，打造空氣清新的家居及辦公環境，保障您及您家人的健康。



NCCO技術特點

- ◆NCCO專利技術持續高效去除細菌及病毒。
- ◆NCCO專利技術有效分解空氣中致癌物，例如甲醛等。
- ◆有害污染物會被分解為無害的水及二氧化碳，不會積存於濾芯，有效避免因為飽和而重新釋放到空氣中，不會造成二次污染。
- ◆正常維護情況下，NCCO濾芯可以長期使用。由於無需頻繁更換濾芯，使用成本遠較市面上同類產品為低。
- ◆有效去除室內空氣中的異味。
- ◆NCCO專利技術獲廣泛應用，例如學校、醫院、護老中心及公眾洗手間等。

關於智能斷電保護

當機器連續開機 8 小時後，機器會斷電進入休眠狀態 30 分鐘，此時所有指示燈會熄滅，30 分鐘後機器會自動重啟。休眠狀態期間，按電源開關可重啟機器。

產品安放位置

- 針對室內揚塵。
由於灰塵容易落到地板附近，建議將本產品放在房間中的平坦的地方。
- 使房間裏的空氣有效循環。
請將本產品設置在其左右與上方距離牆壁、傢俱、窗簾等約 15cm 以上的場所，否則污染物難以被吸入機體。
- 請勿設置本產品於以下場所。
 - 陽光直射、被空調吹到或受熱等場所
(否則可能會造成變形、老化、變色或縮短壽命)
 - 電視機及收音機等物體附近
(否則可能會導致影像紊亂以及雜音)
→ 距離 1m 以上設置。
- 請勿與電視機、收音機等設備使用同一電源插座。
(電源插頭插入時有可能會產生影像紊亂以及雜音)
→ 請將電源插頭插到其他電源插座上。
- 請勿在產品上放置物品。
(否則產品可能會誤操作或故障)
- 請勿在產品進風口和出風口處放置障礙物。
(否則可能會影響產品性能)

基本信息

主要部件名稱

部件名稱：

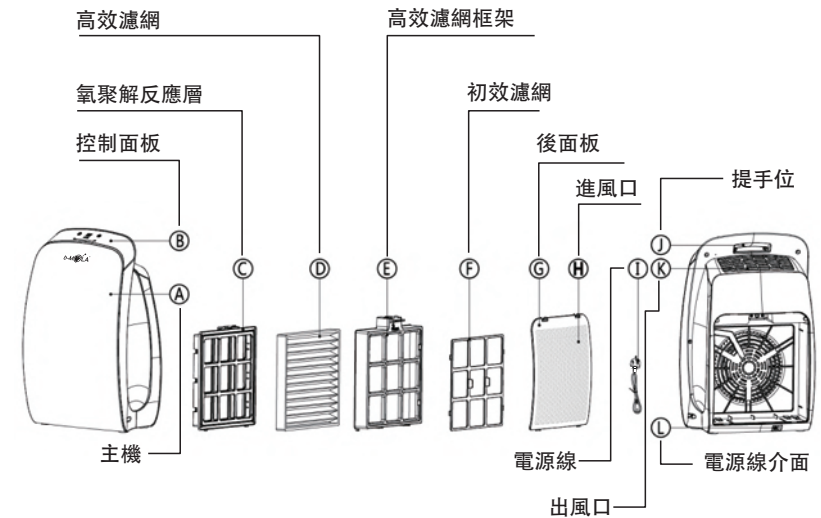

控制面板：

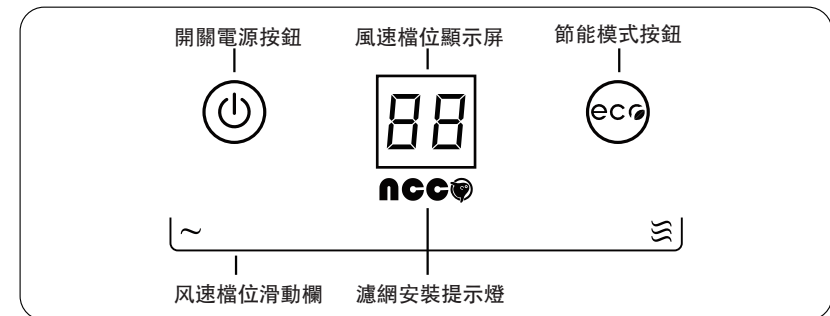

使用入門

初次使用

1. 拆除所有包裝，用一塊柔軟乾燥的布將所有可拆卸的部件以及本產品的凹槽清潔一遍，然後再將這些部件安裝起來。
2. 將本產品置於一個乾燥、平整的平面，並確保它與附近的牆體或物品都保持至少15釐米的距離，以確保本產品能夠正常工作。
3. 檢查插座和所有外接電源線，確保其均符合產品的要求。確保產品在使用前已經接好電源。
4. 本產品裝有感應器以監測濾網組件的位置。如果濾網組件的位置不正確，本產品將無法工作。
5. 本產品首次工作時，如果產品的出風口排出具有礦物氣味的暖風是屬於正常情況，因為氧聚解反應層內部在進行催化氧化反應。

安裝步驟：

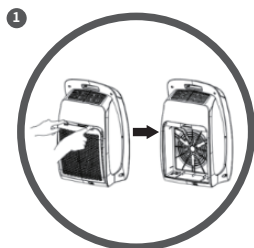

雙手同時按下背板扣，向外取出背板。

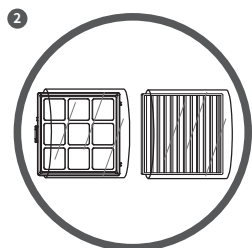

在使用濾網之前，請移除上面所有的包裝材料。

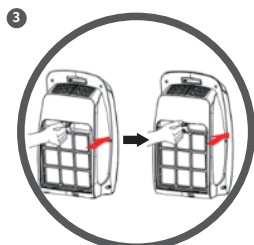

先安裝氧聚解反應層，再安裝高效濾網及初效濾網。聽到“啪嗒”一聲表示扣好。對好背板側邊扣位，雙手按回並扣好。

提示事項

- 安裝濾網時，請用力按入濾網，以確保濾網被鞏固安裝。

使用入門

使用說明

控制面板按鈕：

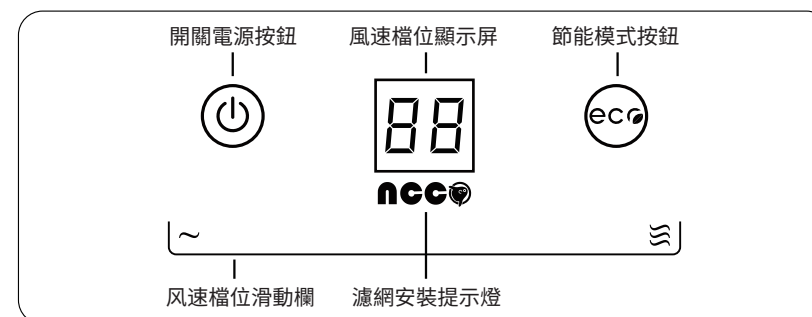

1. 打開/關閉

打開：接通電源後，會有音樂聲提示電源接通。按下開關電源按鈕打開本產品，產品控制面板燈光會在開啟一分鐘後熄滅。

關閉：再按開關電源按鈕，就可以關閉本產品。



2. 默認風速及記憶功能

出廠設置：每次切斷電源後再按開關電源按鈕開啟機器，機器開機默認風速檔位為03檔風量。

記憶功能：若未切斷電源，而是按了開關電源按鈕進行關機，再開機時，機器會記憶上次運行的風速檔位模式來運行。（注意：SS檔除外）



3. 選擇風量模式

加速：用手指觸摸控制面板上的風速檔位滑動欄由左至右滑過，選擇所需要的檔位。

減速：用手指觸摸控制面板上的風速檔位滑動欄由右至左滑過，選擇所需要的檔位。

單擊加/減速：單擊加速或減速按鈕，選擇所需要的檔位。

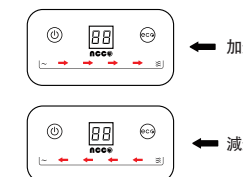

使用入門

使用說明

4. 選擇疾風模式

需要先開啟到最大風量 10 檔，然後長按風速檔位滑動欄最右邊位置 3 秒，將轉變為疾風模式 (SS)。
如需要在短時間之內清潔高污染環境，建議可使用此模式。
如需要切換回風量模式，只需要長按風速檔位滑動欄最右邊位置 3 秒，或選擇按開關電源按鈕關機後再開機。



5. 節能模式

開啟：按“Eco”按鈕開啟節能模式 (Eco 模式)，顯示屏內顯示“Eo”，進入此模式時，機器自行調節至較低風速，風速聲會減弱，所有顯示燈會變暗。

退出：如需退出節能模式，只需輕按一次節能模式按鈕，即可退出節能模式變回風量模式。(建議：睡眠時間可選用此模式。)



6. 濾網安裝提示

當高效濾網或氧聚解反應層安裝不正確時，顯示屏顯示“EE”、濾網安裝提示燈紅藍交替閃爍、機器發出“嘀·嘀·嘀”聲且機器不運作。

(做法：斷開電源，打開機器背扣，重新安裝濾網。正確安裝濾網後，“EE”消失、提示燈停止閃爍、機器恢復運行。)



提示事項

- 本機設有特別保護功能：當機器連續開機 8 小時後，機器會斷電進入休眠狀態 30 分鐘，此時所有指示燈會熄滅，30 分鐘後機器會自動重啟。休眠狀態期間，按電源開關按鈕即可重啟機器。
- 如果在設備運行 1 分鐘後沒有進行任何操作，控制面板上的所有指示燈光及風速檔位顯示屏將關閉，其他功能照常運行。若要喚醒指示燈光，請按下控制面板中的任何按鈕。

維護保養

警告

- ! 維護保養產品前 (除進行濾網更換操作外)，請務必拔出電源插頭。
(否則產品可能會突然運轉，導致觸電或受傷。)

提示事項

- 使用經過化學處理的抹布時，請務必按說明操作。
- 進行維護時，請勿隨意擺放拆卸的零件。
(否則可能會絆倒路人或造成零件損壞)
- 濾網未安裝時，請勿運轉本產品。
(否則將會對氧聚解反應層造成不可逆轉的損壞)
- 如果沒有定期更換高效濾網，會導致氧聚解反應層處理效率嚴重降低。

清潔方法

1 清潔外部機身



用柔軟的乾布擦拭機身。

提示事項

可以用濕布來清潔設備表面，但請勿使用帶有磨料的材質。

2 清潔進風口和出風口



用柔軟的毛刷或真空吸塵器清潔進風口和出風口。

提示事項

不可用水清洗高效能除塵濾網或氧聚解反應層，也不可將它們浸泡在水中。

3 清洗初效濾網



初效濾網可以用水清洗，之後擦乾，方可使用。



維護保養

濾網的護理和更換

1. 根據環境、使用方式和設備所處位置的不同，濾網的壽命也各不相同。
2. 如需讓設備維持最佳狀態，建議僅使用推薦的濾網。
3. 建議定期清洗初效濾網。
4. 在更換濾網時，請保持機器關機狀態，但請勿斷開機器與電源的連接。
5. 高效濾網可根據下表的濾網顏色變化更換指標進行操作。

濾網的清潔和更換週期建議		
濾網	週期時長	方法
初效濾網	/	清洗 <small>(請參閱手冊之《維護保養》章節)</small>
高效濾網	每 6-12 個月 *	更換
氧聚解反應層	可長效使用 **	可持續使用

* 濾網更換週期可能會因運行環境的不同而有變化。

** 如高效濾網沒有定期更換或受損，拆開見到氧聚解反應層表面有灰塵/油性物質遮蓋或污染，可能會減低效用從而導致需要更換氧聚解反應層。

高效濾網表面顏色變化更換指標		
不需要更換	建議更換	需要更換

其他

常見問題

- Q1** 顯示屏顯示“EE”、濾網安裝提示燈紅藍交替閃爍、機器發出“嘀·嘀·嘀·嘀”聲且機器不運作。
- A** 請重新檢查濾網組件是否安裝正確，並重新安裝濾網組件。
- Q2** 高效濾網是否可以清洗？
- A** 高效濾網為複合材料製成，水洗後會嚴重影響淨化效果。
- Q3** 在長時間運行後，空氣質量仍然沒有改善。
- A** 當在一個污染較嚴重的地方使用本產品時，空氣質量的改善需要較長時間。可使用更高一級的性能設置或在必要情況下讓設備運行更長的時間。
- Q4** 設備散發出異常氣味或煙霧（例如：煙霧、火苗或燃燒）。
- A** 請立即關閉設備切斷電源，並立即致電客服中心或聯繫有授權的服務機構處理。
- Q5** 3,000 小時屏幕出現紅色NCCO字樣並長亮，這個是機器運行達到 3,000 小時的高效濾網提醒功能，提醒您查看高效濾網是否需要更換。
- A** 屏幕出現紅色NCCO字樣並長亮時，機器在關機狀態下長按開關電源按鈕 10 秒鐘。聽到“嗒”聲後，按風量減鍵一次，數碼管顯示“HF”，3 秒鐘後清除並自動退出，重新開機工作正常。
- Q6** 11,000 小時屏幕出現紅色NCCO字樣並閃爍，這個是機器運行達到 11,000 小時的氧聚解反應層提醒功能，提醒您查看氧聚解反應層使用狀況。
- A** 屏幕出現紅色NCCO字樣並閃爍時，機器在關機狀態下長按開關電源按鈕 10 秒鐘。聽到“嗒”聲後，按風量加鍵一次，數碼管顯示“nF”，3 秒鐘後清除並自動退出，重新開機工作正常。

其他

疑難排解

故障描述	解決方法
設備不工作	查看設備是否已經接通電源。 啟動設備。
顯示屏顯示“EE”、濾網安裝提示燈紅藍交替閃爍、機器發出“嘀·嘀·嘀·嘀”聲且機器不運作。	檢查濾網是否安裝正確。 重新安裝濾網。
出風口沒有排風	查看設備是否已經接通電源。 檢查電源線接口是否正確連接並插穩。
在長時間運行後，空氣質量仍然沒有改善	當在一個污染較嚴重的地方使用本產品時，空氣質量的改善需要較長時間。可使用更高一級的風速檔位或在必要的情況下讓設備運行更長的時間。
	可能需要清潔或更換濾網。 清潔、更換濾網。
出風口的氣流速度減慢	除塵濾網可能被阻塞。 更換除塵濾網。 (請參見本手冊的“濾網的護理和更換”部分)
	確認所有的包裝材料都被拆卸。
設備發出異常噪音	確認所有的包裝材料都被拆卸。
	確保進風口和出風口沒有被異物阻塞。 將設備周圍所有可能阻擋氣流的物體全部移開。
	設備可能出現故障。 致電客服中心尋求建議或諮詢有授權的供應商。
設備散發出異常氣味或煙霧 (例如：煙、火苗或燃燒)	關閉設備，切斷電源。 立即致電客服中心或聯繫有授權的供應商。

其他

產品規格

供電規格	額定電壓	110-240V~	
	額定頻率	50-60Hz	
耗電量 (瓦特)	模式	低速	8
		高速	18
		疾風	20
風量 (立方米/小時)	模式	低速	<40
		高速	110
		疾風	130
噪音水平 (分貝)	模式	低速	38
		高速	53
		疾風	57
產品尺寸 (長 x 寬 x 高) (毫米)	292 (L) x 174 (W) x 441 (H)		
淨重 (公斤)	4		
處理系統	活氧產生器	殺菌消毒	
	初效濾網	過濾塵埃和毛屑	
	高效濾網	去除灰塵、毛髮和漂浮在空氣中的懸浮粒子、致敏原、花粉、細菌、病毒和真菌。	
	氧聚解反應層	去除異味，將諸如甲醛和VOC等有害污染物分解。	



b-MOLA NCCO Air Treatment Unit Operation Manual

Model No.: NCCO1701

CONTENT

Basic Information	2-5
♦ Safety Instructions	2-3
♦ NCCO Technology	4
♦ Parts & Components	5

Setup	6-8
♦ Before Startup	6
♦ Operation Instructions	7-8

Maintenance & Care	9-10
♦ Cleaning Method	9
♦ Filter Maintenance and Replacement	10

Other Information	11-13
♦ FAQ	11
♦ Trouble Shooting	12
♦ Product Specification	13

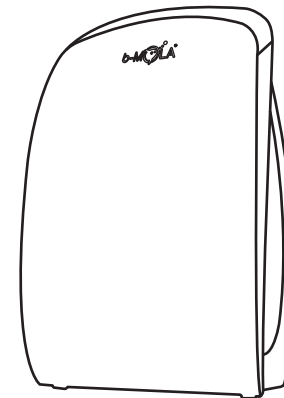

Warranty Card Attached

Thank you for choosing b-MOLA product;
Please read this manual prior to operation and maintenance work;
Please read the 'Safety Instructions' before operation. (Page 2-3);
Injury or property loss may occur if not operated according to this manual;
Please retain this manual for future reference. (Retain manual in reserve).



Basic Information

Please Follow Instructions Below

Safety Instructions

- This appliance can be used by children aged from 8 years and above and persons with reduced physical, sensory or mental capabilities or lack of experience and knowledge if they have been given supervision or instruction concerning use of the appliance in a safe way and understand the hazards involved. Children shall not play with the appliance. Cleaning and user maintenance shall not be made by children without supervision.
- If the supply cord is damaged, it must be replaced by the manufacturer, its service agent or similarly qualified persons in order to avoid a hazard.
- Prior to cleaning or maintenance, the appliance must be disconnected from the supply mains.

- The following symbols are classified based on the hazard level or injury effects caused by improper use or operation.

 **WARNING**
This symbol means 'May cause fatalities or serious injury if instructions are not followed'.

 **ATTENTION**
This symbol means 'May cause minor injury or damage to property if instructions are not followed correctly'.

- The two symbols below refer to the relevant instructions that need to be followed.

 **Prohibited Item**

 **Mandatory Item**

WARNING

-  It is prohibited to pull the power cord with force when user needs to move or store the unit at other places and the power plug is still inserted into power source. The power cord might otherwise be damaged leading to a potential fire risk or electric shocks.
- It is prohibited to damage the power cord or power plug. It is prohibited to cut, refit, excessively twist, 'wring' or squeeze the power cord. It is prohibited to put the power cord near a heat source or place under a heavy object. (Otherwise this could lead to a fire or an electric shock.)
- It is prohibited to use no other power source than a voltage of 110-240V~ 50-60Hz. (Otherwise this could cause overheating leading to a possible fire.)
- It is prohibited to place one's finger / thumb, any metal object or anything else into the air inlet, air outlet or any gap. (Otherwise the user might touch an internal component, leading to an electric shock or personal injury.)
- It is prohibited to touch the power plug or any electrical component with a wet hand. (Otherwise the user may suffer an electric shock.)
- It is prohibited to place any liquid receptacle (e.g. water bottle) on any part of the unit. (Otherwise this might cause the unit to short circuit leading to a possible fire or electric shock.)



-  If one of the following abnormal or malfunctioning situations occurs, please immediately stop using the unit and pull the plug from its power source.
 - Unit stops running when moving the power cord.
 - Any control button fails.
 - If the circuit breaker moves or fuse burns up.
 - If the power cord or plug is abnormally warm or heated.
 - If there is a burnt smell, abnormal noise or vibration.
 - If there is anything deemed abnormal in the unit's function.→Please contact your local service centre or distributor to check the malfunction.
- Please periodically clean the power plug. If there is any dust found on the plug in a humid environment, this could damage the insulator leading to a possible fire.
 - Pull out the power plug and clean it with a dry cloth.
 - If you do not intend to use the unit for a long period of time, please pull plug out of power source.
- Please pull out the power plug before any maintenance or cleaning work is undertaken. (Otherwise the unit might start functioning unexpectedly causing an electrical shock or personal injury.)
- Please fully insert the plug into the power source. If not fully inserted, then power cord could become overheated causing a possible fire or an electric shock.
 - Do not use damaged power plug or loosen power socket.

-  It is prohibited to arbitrarily disassemble or refit the unit otherwise it might function abnormally, causing a fire or electric shock. If any maintenance work is required on the unit, please contact your local customer care centre or distributor.

Basic Information

Please Follow Instructions Below

Safety Instructions

ATTENTION

-  It is prohibited to place the unit in the following places.
 - An uneven place. (Unit might fall causing injury or product damage.)
 - A bathroom, shower room or other places where there is high temperature, high humidity or where the unit could get wet. (Otherwise the unit could suffer electrical leakage leading to a possible fire or impart an electric shock.)
 - A kitchen or similar places with cooking oil fumes. (Otherwise unit may break up and cause personal injury.)
 - Locations where oil or other combustible gases might be leaking. (Otherwise such an environment might cause the unit to catch fire, leading to a disaster.)
 - Places where the unit inlet / outlet is situated close to animal or plant resting areas. (Otherwise the animal could feel discomfort and the plant might not develop properly.)
- It is prohibited to wipe the unit using gasoline or other volatile solvents, or to spray the unit with insecticide. (Otherwise the unit casing might fracture, resulting in a short circuit.)
- It is prohibited to operate the unit when using insecticide smoke. (Otherwise insecticide particles might accumulate inside the unit resulting in the exhaust draft from the air outlet possibly causing damage to health.)
→Ventilate the room after using insecticide smoke, and then operate the unit.
- It is prohibited to place objects such as books or clothes near to or against the air outlet. (Otherwise with a blocked outlet could cause smoke or even fire.)
- It is prohibited to sit or lean on the unit. (Otherwise the unit might turnover or crack, causing personal injury or unit damage.)
* Families with children, please pay attention to the operation process.
- It is prohibited to light up a cigarette, cigar or burn incense near the unit. (Since the HEPA Filter is made of fibre, if the inflammable (e.g. spark) is adsorbed into unit, it may cause fire.)

-  Please pull the power plug by holding the correct part of the plug. (Otherwise the power cord might cause fire or electric shock.)
Maintain good indoor ventilation when operating unit together with combustor.

Basic Information

NCCO Technology

Patented NCCO Air Purification Technology Brings You Fresh and Clean Air

Our patented NCCO (Nano Confined Catalytic Oxidation) technology used inside our b-MOLA NCCO Air Treatment Unit is able to effectively remove fine particulates, passive smoke, pollen, PM₁₀, bacteria, viruses and more.

It brings you clean fresh air indoors when the outside air environment is polluted. The unit has safe operation of up to 8 hours under the control of its intelligent control of an automatic power-off and re-start function after 30 minutes of rest (See 'About Intelligent Power-Off Protection' for further info).



About NCCO (Nano Confined Catalytic Oxidation) Air Purification Technology

- NCCO Air Purification Technology has world-wide patents.
- The principle of NCCO technology is based on the efficient adsorption of pollutants through the use of active oxygen to break the chemical bonds of the pollutant molecule and then decomposing them to Carbon Dioxide and water molecules.
- Characteristics of the technology are – extremely long filter / Reactor life, no secondary pollution, sterilises and removes carcinogenic pollutants such as formaldehyde and effectively deodorises.
 - Long Life – Take example of adsorption capacity of activated carbon, which has a lifetime of only about three months, on the contrary, NCCO product is available to sustainable use.
 - No Secondary Pollution – For other types of filters, they will be saturated relatively quickly and thus release unabsorbed pollutants back into the air and is called secondary pollution. NCCO technology continuously decomposes pollutants into harmless Carbon Dioxide and water.
 - Sterilisation and Formaldehyde Removal – NCCO technology can effectively decompose chemical pollutants including formaldehyde which is deemed to be carcinogenic. It also filters suspended particles, heavy metal particles, pollen, viruses and bacteria.
 - Efficient Deodorisation – NCCO technology can completely remove offensive odours found in public washrooms and indoor environment near landfills.
- NCCO IS AN INNOVATIVE TECHNOLOGY INVENTED BY MEMBER OF HKUST ENTREPRENEURSHIP PROGRAM.

About Intelligent Power-Off Protection

b-MOLA NCCO Air Treatment Unit is designed using an Intelligent Power-Off Protection System.

The unit will intelligently power off with all extinguished indicators after continuous use over a period of 8 hours and then will restart automatically after 30 minutes downtime. During downtime, user might restart unit by pressing ON / OFF Button.

Our Intelligent power-off system is able to effectively avoid excessive load and eliminate any risk during the supply of power.

For highest efficiency of air filtration!

- Removing indoor dust.
 - Place unit on a flat surface in an open area where dust falls easy.
- Best air circulation location area.
 - Place unit at least 15cm (6") from a wall, furniture, curtains etc, otherwise its filtration efficiency will possibly be diminished.
- Do not place the unit in the following places or areas.
 - Direct sunlight, near air-conditioning unit airflow or heat. (This may cause distortion, colour change or reduced life.)
 - Near television, radio etc. (This may cause television image disorder and radio noise.) →Keep the unit 1m or above away from such devices.
- Do not obstruct air inlet or outlet. (This could reduce efficiency of air filtration by unit.)
- Do not use the same power socket as one already used for television or radio. (Television image disorder and radio noise may appear when power plug is inserted into socket.) →Please use alternative power sockets.
- Do not place objects on the unit. (This might affect the operation of the unit.)

Basic Information

Parts & Components

Parts & Components:

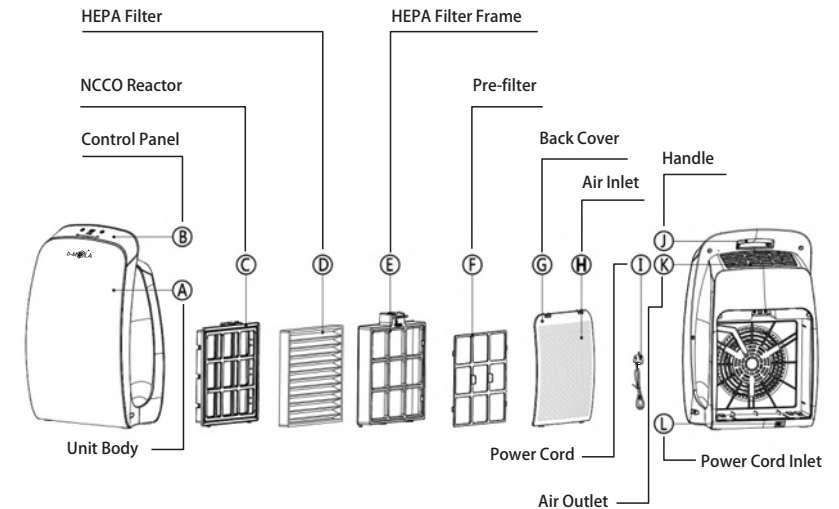

Control Panel:

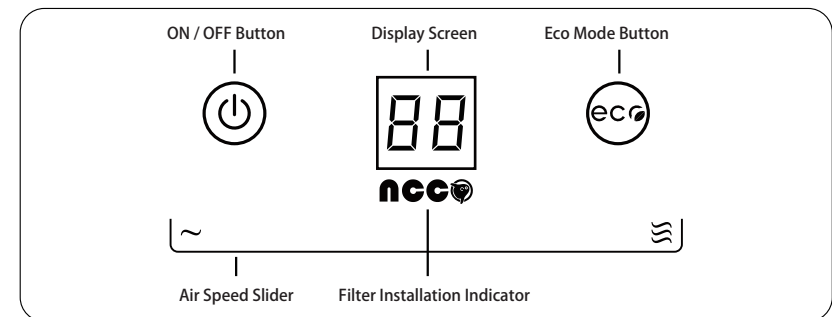

Setup

Before Startup

For the first-time operation of the unit:

1. Please carefully read and retain the operation manual for future reference.
2. Remove all packaging materials, wipe all removable parts and grooves by a soft and dry cloth, then reassemble all these parts.
3. Place the unit at a dry and even place. Keep the unit at least 15cm away from wall or surrounding objects for normal operation.
4. Check power socket and all external power cords to meet operation requirements. Make sure the unit has been connected with power supply before operation.
5. The unit is installed with inductor to induce filters' location. If the filters have not been properly installed, the unit won't operate.
6. When first switched on there will be warm air. This is perfectly normal and is due to special manufacturing technique of the NCCO Reactor.

Installation Procedures:

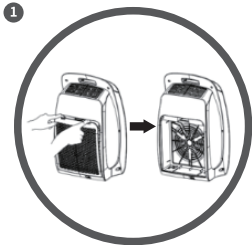

Simultaneously press the two buckles to open Back Cover.

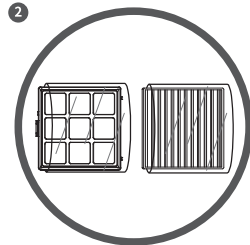

Before installing filters, please remove all packaging materials.

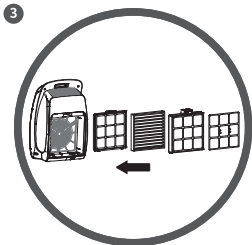

Install NCCO Reactor, HEPA Filter and Pre-filter in sequence into HEPA Filter Frame. Clicking sound should be heard indicating successful filters installation. Re-install Back Cover to finish the installation process.

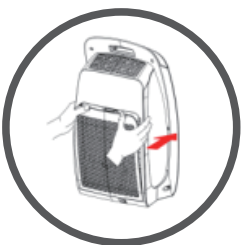

Notice

- Please press filters with force for proper installation.

Setup

Operation Instructions

Control Panel Buttons:

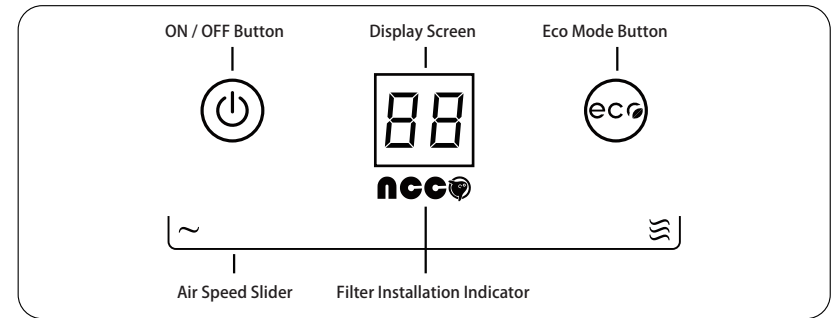

1. ON / OFF

ON: Crystal ring should be heard indicating Power On after the unit has been connected with power supply. User shall press the ON / OFF Button to turn on unit, where indicators at control panel will be extinguished 1 minute after the unit has been turned on.



OFF: Press ON / OFF Button again to turn off unit.

2. DEFAULT AIR SPEED & MEMORY FUNCTION

Factory Setting: The default air speed is 03. When unit is running, if user deliberately disconnects power supply and then connects power supply to turn on unit, the air speed will be reset to default value.



Memory Function: When unit is running, if user presses the ON / OFF Button to turn off unit and then turns on unit again, the unit will operate with the last air speed (Excluding SS Mode).

3. AIR SPEED MODE

Increase Speed: Press the Air Speed Slider from left to right to increase air speed.
Reduce Speed: Press the Air Speed Slider from right to left to reduce air speed.
User also can press the Air Speed Increase / Reduce Indicator to directly increase / reduce air speed.



Increase Speed Reduce Speed

Setup

Operation Instructions

4. SS MODE

First increase air speed to the highest air speed (10), then long press the rightmost of the Air Speed Slider for 3 seconds to enter into SS Mode. It is recommended to select SS mode to treat a seriously contaminated environment at a short time. Long press the rightmost of the Air Speed Slider for 3 seconds or press the ON / OFF Button to turn off unit and then turn on unit again for turning back to Air Speed Mode.

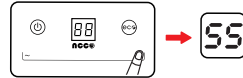

5. TURBO MODE

Enter Eco Mode: Press the Eco Mode Button to enter into Eco Mode, where 'Eo' displays at the Screen. Under Eco Mode, the unit operates with lower air speed, weaker noise and dimmer indicators. Exit Eco Mode: Press the Eco Mode Button again to exit Eco Mode and turn back to Air Speed Mode. It is recommended to select Eco Mode during sleep time.

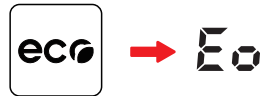

6. FILTER INSTALLATION SUGGESTION

If HEPA Filter or NCCO Reactor has not been properly installed, the Filter Installation Indicator will flash red and blue alternately, 'EE' will display at Display Screen, 'Di · Di · Di · Di' sound will be heard from unit and the unit won't operate. Proper Operation: Disconnect power supply and open Back Cover to re-install filters. After properly installing filters, the flashing and 'Di · Di · Di · Di' will stop, 'EE' will disappear, and the unit start running again.



ATTENTION

- The unit is equipped with a special protection feature: It will stop operating with all indicating lights off for 30mins, after every 8 hours' non-stop operation. 30mins later the unit resume operating automatically. Press Power Button can awake the unit at any time.
- Once after the unit runs for 1 minute without receiving any further operation instructions, all indicating lights and the Fan Speed Display will be dimmed, while other functions remained. To wake up, press any button on the control panel.

Maintenance & Care

! WARNING

! Always disconnect the power supply of the unit before any maintenance or care process is carried out (except replacing filters).
(Otherwise the unit might still be running and could cause an electrical shock or injury)

- Notice**
- It is prohibited to clean the unit with any detergent.
 - If cleaning the unit by using a cloth that is chemically treated, please read the instructions supplied.
 - During maintenance work, do not touch the disassembled parts randomly and ensure you do not stumble over them, thus injuring yourself or damaging the parts.
 - If the HEPA Filter has not been installed, please do not operate the unit since this could cause irreversible damage to the NCCO Reactor.
 - If the HEPA Filter is not replaced periodically as indicated in instructions, it may seriously affect the efficiency of the NCCO Reactor.

Cleaning Method

1 Cleaning External Surfaces of Unit Body



Wipe Unit body by soft and dry cloth.

Notice

A damp (non-abrasive) cloth can be used to clean the unit surface.

2 Cleaning Air Inlet and Air Outlet



Use a soft brush or light vacuum to clean the air inlet and air outlet.

Notice

Never rinse or soak the HEPA Filter or NCCO Reactor with water.



3 Cleaning Pre-filter



Available to use water to clean Pre-filter. Wipe up Filter before reassembling Filter into unit.

Maintenance & Care

Filter Maintenance and Replacement

1. Filter lifetime will vary depending on the environment, amount of usage and location of the unit.
2. To maintain optimal operating condition of the unit, only use the recommended filter.
3. It is recommended to regularly clean Pre-filter.
4. Turn off unit but maintain power supply when replacing filters.
5. When NCCO Reactor needs to be replaced, please follow the HEPA Filter Surface Color Changing Indicator to dispose HEPA Filter.

RECOMMENDED FILTER CLEANING AND REPLACEMENT CYCLES AND ETHODS		
Filter	Cycle	Method
Pre-filter	/	Clean <small>(Please refer to the Section of Filter Maintenance and Replacement.)</small>
HEPA Filter	Every 6-18 months *	Replace
NCCO Reactor	Available to sustainable use **	Available to sustainable use **

* The filters cleaning and replacement cycle may vary depending on the operating environment.

** If the HEPA Filter has not been replaced periodically or it has been damaged, and the surface of the NCCO Reactor is covered with dust or oily substances after disassembling, the removal capacity of the NCCO Reactor may be badly reduced and should be replaced.

HEPA FILTER SURFACE COLOR CHANGING INDICATOR		
No need to Replace	Replacement is Recommended	Replacement is Needed

Other Information

FAQ

- Q1** The Filter Installation Indicator flashes red and blue alternately, 'EE' displays at Display Screen, 'Di · Di · Di · Di' sound is heard from unit and the unit doesn't operate.
- A** Please check if filters have been properly installed. If not, please re-install them.
- Q2** Is the HEPA Filter can be washed by water?
- A** HEPA Filter is made of composite material, water would seriously affect the purification effect.
- Q3** The air quality is not yet improved after a long time operation.
- A** If the unit is used in a seriously polluted area, the treatment process would take longer time. It is recommended to operate the unit with high airflow mode, or extend the operation time, until the pollution diminishes.
- Q4** The unit emits an unusual smell or smog. (e.g. smoke, flame, or burning)
- A** Turn off the unit and disconnect it from power supply right away. Call the customer service center immediately or contact with a qualified agent.
- Q5** When the HEPA Filter has operated for 3,000 hours, 'NCCO' in red illuminates at Display Screen as a reminding to check whether HEPA Filter needs to be replaced.
- A** When 'NCCO' in red illuminates at Display Screen, under Power-Off state but without disconnecting power supply, long press the ON / OFF Button for 10 seconds, where a 'Da' sound should be heard from the unit. Then, press the Air Speed Reduce Button. 'HF' will display at the Display Screen for 3 seconds to exit reminding mode. Next, turn on the unit for normal operation.
- Q6** When the NCCO Reactor has operated for 11,000 hours, 'NCCO' in red flashes at Display Screen as a reminding to check the operation situation of NCCO Reactor.
- A** When 'NCCO' in red flashes at Display Screen, under Power-Off state but without disconnecting power supply, long press the ON / OFF Button for 10 seconds, where a 'Da' sound should be heard from the unit. Then, press the Air Speed Increase Button. 'nF' will display at the Display Screen for 3 seconds to exit reminding mode. Next, turn on the unit for normal operation.

Other Information

Trouble Shooting

Problem	Solution
Unit does not operate.	Check whether the unit is correctly connected to its power supply. Turn on unit.
The Filter Installation Indicator flashes red and blue alternately, 'EE' displays at Display Screen, 'Di · Di · Di · Di' sound is heard from unit and the unit doesn't operate.	Check whether the filters have been correctly installed. Re-install filters.
No air is being blown out of the Air Outlet.	Check whether the unit is correctly connected to its power supply. Check whether the power cord interface is in good service condition.
Air quality still has not improved despite operating for a long time.	If the unit is used in a seriously polluted area, the treatment process will take longer than normal. It is recommended to operate the unit using it high airflow mode until the pollution diminishes.
	Filters might require cleaning or replaced. Clean or replace filters.
Air speed at Air Outlet becomes slow.	HEPA Filter may be clogged or blocked. Replace HEPA Filter. (Please refer to 'Filter Maintenance and Replacement').
	Make sure all packaging materials are removed.
Unit produces abnormal noise.	Make sure all packaging materials are removed.
	Make sure Air Inlet and Air Outlet are not be blocked by foreign matter. Remove all surrounding matter which may block the airflow.
	The unit may be malfunctioning. Seek advice from service centre or an authorised service provider.
Unit emits unusual smell, odour or smoke (also flames or burning).	Immediately switch off unit and disconnect its power source. Contact local service centre or authorised service provider.

Other Information

Product Specification

Power Supply	Rated Voltage	110-240V~	
	Rated Frequency	50-60Hz	
Power Consumption (W)	Mode	Lowest	8
		Highest	18
		Turbo	20
Airflow Volume (m ³ /hr)	Mode	Lowest	<40
		Highest	110
		Turbo	130
Noise Level (dB)	Mode	Lowest	38
		Highest	53
		Turbo	57
Product Dimension (L x W x H) (mm)	292 (L) x 174 (W) x 441 (H)		
Net Weight (kg)	4		
Treatment System	Active Oxygen Generator	Sterilization	
	Pre-filter	Remove dust and hair	
	HEPA Filter	Remove dust, hair and airborne particles such as allergens and pollen, bacteria, viruses and fungus.	
	NCCO Reactor	Remove odor, decompose and oxidize harmful pollutants such as formaldehyde and VOCs.	