



使用說明書

型號:BM100

附保修證

感謝您選用b-MOLA空氣處理系統。
使用和維護本產品前，請仔細閱讀本使用說明書。
使用本產品前請務必仔細閱讀「安全注意事項」。
不遵照說明書使用本產品有可能導致受傷或財產受損。
請妥善保管此說明書以供日後參考。
請妥善保管保修證以供日後維修之用。



目錄

基本事項	02-05
安全注意事項	02-03
NCCO技術	04
主要部件名稱	05
使用入門	06-09
初次使用	06
使用說明	07-09
維護保養	10-11
清潔方法	10
濾網的護理和更換	11
其他	12-14
常見問題	12
疑難排解	13
產品規格	14

請務必遵守 安全注意事項

基本事項

- 八歲或以上兒童，有身體缺陷，感官或精神問題，或者缺乏知識經驗的人士在獲得有關安全使用本裝置的監督/指導，並清楚所涉及的危害情況下可以使用本裝置。請勿讓兒童將本裝置當作玩具。兒童不得在沒有監督/指導的情況下進行清洗和維護設備的相關工作。
- 如果電源線損壞，必須由製造商或合資格服務供應商進行更換，以免出現危險。
- 進行清潔和保養前，必須切斷本產品的電源。

- 為了避免對您或其他人造成傷害或財物損害，請務必遵守安全注意事項。以下標誌是根據錯誤使用所產生的危險或受傷程度進行分類。

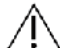
 **警告** 本標誌所代表的內容為「若不遵守會有死亡或嚴重受傷的危險」。

 **注意** 本標誌所代表的內容為「若不遵守會有受傷或財物受損的危險」。

- 以下標誌為務必遵守的指示種類。

 此標誌表示禁止事項

 此標誌表示強制事項

 ■ 禁止拉扯電源線來移動本產品。
(否則電源線可能會損壞，導致火災或觸電)

 **警告**

■ 禁止損壞電源線或電源插頭。

◎ 禁止切割、改裝、過度扭曲、擰絞、擠壓電源線，禁止電源線靠近熱源或在電源線上壓放重物等。(否則電源線可能會損壞，導致火災或觸電)

■ 禁止使用指定電壓 (110-240V~ 50/60Hz) 以外的電源。
(否則電源線可能會過熱，導致火災)

■ 禁止將手指或金屬物等異物放入進風口、出風口或縫隙中。
(否則可能會接觸到產品內部，導致觸電或受傷)

■ 禁止手濕時觸摸電源插頭。
(否則可能會導致觸電)

■ 禁止將本產品放置在容易被水或其他液體濺到的地方。
(否則可能會造成短路，導致火災或觸電的危險)



 ■ 禁止擅自拆開或改裝本產品。
(否則可能會導致火災或觸電，如需進行維修，請聯絡客戶諮詢服務中心或經銷商。)

 **警告**

- !** ■ 當有以下任何情況出現時，請立即停止使用本產品並拔除電源插頭。
(否則可能會導致觸電、起火或冒煙)
<異常・故障的例子>
- 移動電源線時，產品運轉停止。
 - 如果任何控制按鈕故障。
 - 如果斷路器起作用或保險絲燒毀。
 - 如果電源線或電源插頭異常發熱。
 - 如果您發覺有燒焦的異味或異常的聲音或振動。
 - 如果有其他任何異常現象或故障。
- 立即停止操作本產品，並拔除電源插頭，聯絡客戶諮詢服務中心或經銷商進行檢查、維修。
- 請定期清潔電源插頭。
○ 如果電源插頭上有灰塵、濕氣，可能會破壞電源插頭的絕緣部分，導致火災。
○ 拔除電源插頭，用乾布擦淨。
○ 長期不使用產品時，應拔除電源插頭。
- 維護保養產品前，請務必拔除電源插頭。
(否則產品可能會突然運轉，導致觸電或受傷)
- 請將電源插頭完全插入電源插座。
(如果電源插頭沒有完全插牢，電源線可能會過熱並導致火災或觸電)



警告

- ⊘** ■ 禁止放置本產品於以下場所。
- 不穩的場所 (否則產品可能會翻倒，導致受傷或產品損壞)
 - 浴室或廚房等濕潤或高溫場所 (否則可能會令到產品破裂、漏電，導致火災、觸電或受傷的危險)
 - 油或可燃性氣體可能出現洩漏的場所 (否則吸入產品內可能會起火，導致火災)
 - 暖爐等熱源附近 (否則產品可能會過熱，導致火災)
- 禁止使用汽油或其他揮發性混合溶劑擦拭產品。
(否則產品可能會破裂或短路，導致受傷、火災或觸電)
- 使用煙霧型殺蟲劑時，禁止使用本產品。
(否則產品內可能會積聚藥物，然後從出風口排出，危害身體健康)
使用殺蟲劑後，應先讓房間徹底通風，然後才使用本產品。
- 禁止阻塞入風口或出風口，例如放置衣物或書本等雜物。
(否則會導致冒煙、起火)
- 禁止坐、站立或倚靠本產品。
(否則產品可能會翻倒，導致受傷或產品損壞)
- 禁止將點燃的香煙、香火等接近產品。
(否則易燃物可能會被吸入產品內導致起火，發生火災)
- 禁止在本產品周圍噴灑殺蟲劑或空氣清新劑等易燃物品。



注意

- !** ■ 從電源插座拔除電源線時，請手持電源插頭，不要拉扯電源線。
(否則電源線可能會損壞，導致火災或觸電)



注意

NCCO 納米氧聚解專利技術，帶來清新潔淨的空氣

NCCO (Nano Confined Catalytic Oxidation) 納米氧聚解空氣處理技術，是與香港科技大學創業計劃成員合作研發，並且獲得全球多國專利，可以全方位解決室內空氣質素問題，打造空氣清新的家居及辦公環境，保障您及您家人的健康。



NCCO 技術特點

- ◆ NCCO 專利技術持續高效去除細菌及病毒。
- ◆ NCCO 專利技術有效分解空氣中致癌物，例如甲醛等。
- ◆ 有害污染物被分解為無害的水分子及二氧化碳，不會造成二次污染。
- ◆ 正常維護情況下，NCCO 濾芯可以長期使用。由於無需頻繁更換濾芯，使用成本遠較市面上同類產品為低。
- ◆ 有效去除室內空氣中的異味。
- ◆ NCCO 專利技術獲廣泛應用，例如學校、醫院、護老中心及公眾洗手間等。

關於智能斷電保護

當機器連續開機 8 小時後，機器會斷電進入休眠狀態 30 分鐘，此時所有指示燈會熄滅，30 分鐘後機器會自動重啟。休眠狀態期間，按電源開關可重啟機器。

產品安放位置

- 保持空氣有效循環。
請將本產品設置在其左右與上方距離牆壁、傢俱、窗簾等約 15cm 以上的場所，否則污染物難以被吸入機體。
- 請勿將本產品置於以下場所。
 - 陽光直射或溫度變化較大的場所
 - 電視機及收音機等物體附近
- 請勿與電視機、收音機等設備使用同一電源插座。
- 請勿在產品上放置物品。
(否則可能會造成產品錯誤操作或故障)
- 距離 1m 以上設置。
- 請勿在產品進風口和出風口處放置障礙物。
(否則可能會影響產品性能)

主要部件名稱

基本事項

初次使用

使用入門

部件名稱：

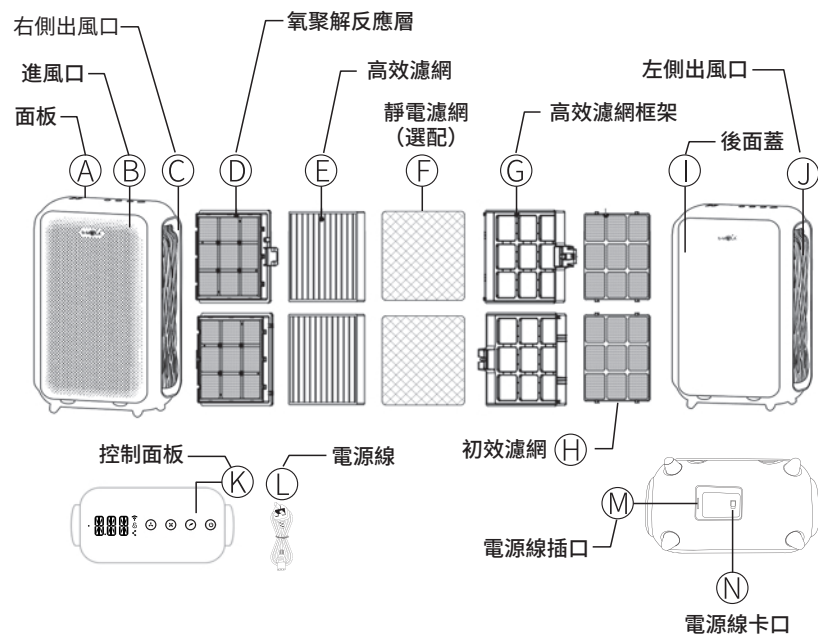

1. 拆除所有包裝，用一塊柔軟乾燥的布將所有可拆卸的部件以及本產品的凹槽清潔一遍，然後再將這些部件安裝起來。
2. 將本產品置於一個乾燥、平整的平面，並確保它與附近的牆體或物品都保持至少15釐米的距離，以確保本產品能夠正常工作。
3. 檢查插座和所有外接電源線，確保其均符合產品的要求。確保產品在使用前已經接好電源。
4. 本產品裝有感應器以監測過濾組件的位置。如果過濾組件的位置不正確，本產品將無法工作。
5. 本產品首次工作時，如果產品的出風口排出具有礦物氣味的暖風是屬於正常情況，因為氧聚解反應層內部在進行催化氧化反應。

安裝步驟：

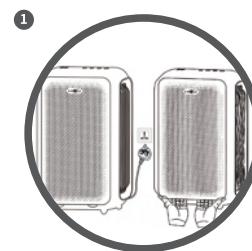

拔掉電源開關，找到前面板下方的兩個扣位，向外取出前面板。

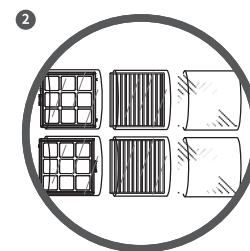

在使用濾網之前，請移除上面所有的包裝材料。

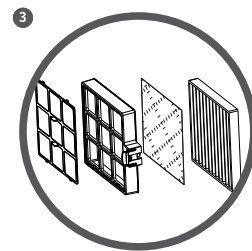

將靜電濾網放在高效濾網上方後裝入高效濾網框架中，然後把初效濾網按照扣位裝入高效濾網框架上。

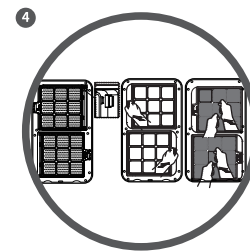

先安裝上層的氧聚解反應層，再安裝組合好的高效濾網框架。聽到“啪嗒”一聲表示扣好，下層的安裝步驟同上。

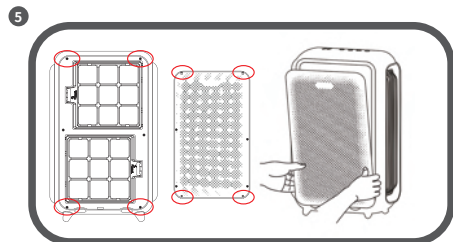

對準前面板與機身上的四個定位柱，輕輕往內推，磁石會將前面板吸附緊貼機身，前面板安裝完成。

提示事項

■ 安裝濾網時，請用力按入濾網，以確保濾網被鞏固安裝。

控制面板按鈕



*本產品支援802.11 b/g/n 2.44 GHz WiFi，如有接駁問題，請聯絡閣下的路由器供應商查詢設定方法

1. 開機/關機



開機：當接通電源後，會有音樂聲提示電源接通。按下開關電源按鈕以開機。

關機：再按開關電源按鈕以關機。

注：開機狀態下長按開關電源按鈕 5 秒重啟WiFi模式。

2. 默認風速及記憶功能

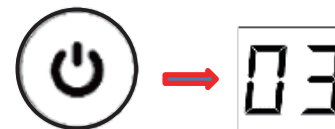

出廠設置：用戶每次切斷電源後再按開關電源按鈕開啟機器，機器設定開機風速檔位為 03 檔風量。

記憶功能：用戶按了開關電源按鈕關機後，待下次重新開機時，機器會記憶上次運行的風速檔位模式來運行。

3. 選擇風量模式



加速：用手指輕按風速增加按鈕，每按一下即為加速。

減速：用手指輕按風速減少按鈕，每按一下即為減速。

4. 選擇疾風模式



在風速檔為 10 檔時，同時按住加速按鈕和減速按鈕進入疾風模式（SS）。

如用戶需要在短時間之內清潔高污染環境，建議可使用此模式。

如需要切換回風量模式：單擊減速按鈕；切換回風量模式後，風速為 10 檔。

5. 節能模式



輕按按鈕可進入產品節能模式，再輕按一次則可退出該模式，建議睡眠時間可選用該模式。

6. 童鎖模式

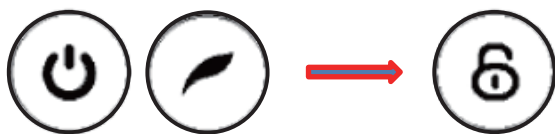

在開機狀態下，同時按下開關電源按鈕和節能模式按鈕 5 秒，機器發出提示音，童鎖圖標出現，機器進入童鎖模式。如需退出童鎖模式，再同時按下開關電源按鈕和節能模式按鈕 5 秒即可。

注意：童鎖模式下按任何按鈕將失效。

7. 濾網安裝提示



當顯示屏出現“EE”字樣、發出“嘀嘀·嘀嘀”聲且機器不運作時，即表示產品的高效濾網或氧聚解反應層安裝不正確，請重新安裝過濾組件。

提示事項

- 本機設有智能保護功能：當機器連續開機 8 小時後，機器會進入休眠狀態 30 分鐘，此時所有指示燈會熄滅，30 分鐘後機器會自動重啟。休眠狀態期間，按電源開關按鈕可重啟機器。
- 按開關電源按鍵可選擇開啟或關閉本產品。若 1 分鐘後沒有任何指令，除電源按鍵的亮度變暗 50% 之外，其他按鍵燈和顯示屏會熄滅，按任何按鍵可以點亮燈光。

! 維護保養產品前（除進行濾網更換操作外），請務必拔除電源插頭。（否則產品可能會突然運轉，導致觸電或受傷。）



警告

提示事項

- 使用經過化學處理的抹布時，請務必按說明操作。
- 進行維護時，請勿隨意擺放拆卸的零件。
- 濾網未安裝時，請勿運轉本產品，否則會對氧聚解反應層造成不可逆轉的損壞。
- 如果沒有定期更換高效濾網，會導致氧聚解反應層處理效率嚴重降低。

清潔方法

- 

清潔外部機身
用柔軟的乾布擦拭機身。

提示事項

 - 可以用濕布來清潔設備表面，但請勿使用帶有磨料的材質。
- 

清潔進風口和出風口
柔軟的毛刷或吸塵機
清潔進風口和出風口。
- 

清洗初效濾網
初效濾網可以用水清洗，
之後擦乾，方可使用。
- 

提示事項

 - 不可用水清洗靜電濾網、高效濾網或氧聚解反應層，也不可將它們浸泡在水中。

濾網的護理和更換

維護保養

1. 根據環境、使用方式和設備所處位置的不同，濾網的壽命也各不相同。
2. 如需讓設備維持最佳狀態，建議僅使用推薦的濾網。
3. 建議定期清洗初效濾網。
4. 在更換濾網時，請保持機器關機狀態，但請勿斷開機器與電源的連接。
5. 高效濾網可根據下表的濾網顏色變化更換指標進行操作。

濾網及濾芯的清潔和更換週期建議

濾網 / 濾芯	週期時長	方法
初效濾網	/	清洗 (請參閱手冊之《維護保養》章節)
靜電濾網	每 3-6 個月	更換
高效濾網	每 6-12 個月*	更換
氧聚解反應層	可長效使用**	可持續使用

* 濾網更換週期可能會因運行環境的不同而有變化。

** 如高效濾網沒有定期更換或受損，拆開見到氧聚解反應層表面有灰塵/油性物質遮蓋或污染，可能會減低效用從而導致需要更換氧聚解反應層。

高效濾網表面顏色變化更換指標

不需要更換	建議更換	需要更換

常見問題

其他

Q1

設備發出“滴滴·滴滴”聲響、顯示“EE”及不運作。

A

請重新檢查過濾組件是否安裝正確，並重新安裝。

Q2

高效濾網是否可以清洗？

A

高效濾網為複合材料製成，水洗後會嚴重影響淨化效果。

Q3

在長時間運行後，空氣質量仍然沒有改善。

A

當在一個污染較嚴重的地方使用本產品時，空氣質量的改善需要較長時間。建議可使用更高一級的風速檔位或在必要情況下讓設備運行更長的時間。

Q4

設備散發出異常氣味或煙霧例如燒焦的氣味。

A

請立即關閉設備及切斷電源，並立即致電客服中心或聯繫有授權的服務機構處理。

Q5

為什麼第一次開機的時候有礦石的氣味？

A

初次使用時，因氧聚解反應層特殊的製造工藝，會有輕微的礦物氣味，這是正常現象，對人體無害，使用一段時間後氣味便會消失，請您放心使用。

Q6

當機器顯示屏間歇閃爍“HP”字樣且亮起紅燈時，即為高效濾網已累計使用超過3,000小時，用戶需要檢查或更換高效濾網。

A

在機器保持通電運行的狀態下，打開機器面蓋取出所有高效濾網（無需取出氧聚解反應層），此時，“HP”字樣和紅燈消失，顯示屏顯示“EE”字樣。然後，將新的高效濾網正確安裝進機身內，“EE”字樣消失，高效濾網檢查提示重設完成。在上述整個更換過程中，請保持機器通電運行的狀態。請注意，當高效濾網累計運行時間並未達到3,000小時，且“HP”字樣和紅燈尚未出現之前用戶便重新拆裝了高效濾網，高效濾網檢查提示不會重設。

故障描述	解決方法
設備不工作	查看設備是否已經接通電源。 啟動設備。
設備發出“滴滴·滴滴”聲響、顯示“EE”及不運作	檢查過濾組件是否安裝正確。 重新安裝過濾組件。
出風口沒有排風	查看設備是否已經接通電源。 檢查電源線界面是否正確連接並插穩。
在長時間運行後，空氣質量仍然沒有改善	當在一個污染較嚴重的地方使用本產品時，空氣質量的改善需要較長時間。可使用更高一級的風速檔位或在必要的情況下讓設備運行更長的時間。
	可能需要清潔或更換濾網。
出風口的氣流速度減慢	濾網可能被阻塞。 更換濾網。 (請參見本手冊的“濾網的護理和更換”部分)
	確認所有的包裝材料都被拆卸。
設備發出異常噪音	確認所有的包裝材料都被拆卸。
	確保進風口和出風口沒有被異物阻塞。 將設備周圍所有可能阻擋氣流的物體全部移開。
	設備可能出現故障。 致電客服中心尋求建議或諮詢有授權的服務供應商。
設備散發出異常氣味或煙霧 例如燒焦的氣味。	關閉設備，切斷電源。 立即致電客服中心或聯繫有授權的服務供應商。

供電電源	額定電壓	110-240V~	
	額定頻率	50-60Hz	
耗電量 (瓦特)	模式	低速	16
		高速	35
		疾風	40
風量 (立方米/小時)	模式	低速	<80
		高速	230
		疾風	280
噪音水平 (分貝)	模式	低速	37
		高速	50
		疾風	54
產品尺寸 (長 x 寬 x 高) (毫米)	340 (L) x 200 (W) x 550 (H)		
淨重 (公斤)	8.5		
處理系統	活氧產生器	殺菌消毒	
	初效濾網	過濾塵埃和毛屑	
	靜電濾網 (選配)	過濾10微米以上的細微顆粒和香煙焦油	
	高效濾網	去除灰塵、毛髮和漂浮在空氣中的顆粒，比如致敏原、花粉、細菌、病毒和真菌。	
	氧聚解反應層	去除異味，將諸如甲醛和VOC等有害污染物分解	



User Manual

Model : BM100

WARRANTY CARD ATTACHED

Thank you for choosing the b-MOLA product.
Please read this manual before using and maintaining the appliance.
Please read the 'Safety Instructions' carefully before using the appliance.
Failure to follow the instructions to use this appliance may result in injury
or property damage.
Please keep this manual for future reference.
Please keep the warranty card for future servicing.



CONTENTS

Basic Information _____	02-05
Safety Instructions	02-03
NCCO Technology	04
Main Parts & Components	05
Getting Started _____	06-09
First time use	06
Operating Instructions	07-09
Care & Maintenance _____	10-11
Cleaning Instructions	10
Filter Replacement & Maintenance	11
Other Information _____	12-14
FAQs	12
Trouble Shooting	13
Product Specifications	14

Please Follow Instructions Below

Safety Instructions

Basic Information

- This appliance can be used by children aged from 8 years and above and persons with reduced physical, sensory or mental capabilities or lack of experience and knowledge if they have been given supervision or instruction concerning use of the appliance in a safe way and understand the hazards involved. Do not allow children to use this device as a toy. Cleaning and maintenance shall not be made by children without supervision.
- If the power cord is damaged, you must have it replaced by the manufacturer, its service agent or similarly qualified persons to avoid a hazard.
- Before cleaning or maintenance, you must disconnect the appliance from the power supply.
- To avoid injury of operation or others, please follow safety instructions.
- The classification of the following two icons is according to the degree of risk or injury caused by the incorrect operation:



WARNING

This icon indicates that "if not follow the warning, it would cause injury or death."



PRECAUTION

This icon indicates that "if not follow the precaution, it would cause injury or property loss."

- The following icons are the types of instructions that must be followed:



PROHIBITIONS



MANDATORY MATTERS



- Do not move the appliance by pulling on the power cord. Otherwise, the power cord could be damaged, resulting in fire or electric shock.
- Do not damage the power cord or the plug.
- Do not cut, refitting, over twisting, extruding power cord.
- Do not put the power cord near any heat sources.
- Do not put any heavy objects over the power cord. Otherwise, the power cord could be damaged, resulting in fire or electric shock.
- Do not use a power source other than 110-240V~ 50/60Hz. Failure to comply may cause a fire.
- Do not insert your fingers or any other objects into the air inlet or air outlet to prevent injury, electric shock or malfunctioning of the appliance.
- Do not handle the plug with wet hands. Failure to comply could result in electric shock.
- Do not place the appliance where water or other liquids easily splash on it. Failure to comply may result in short-circuiting of the appliance and cause fire or electric shock.



- Do not disassemble, repair or modify the appliance by yourself. Otherwise, it may cause fire or electric shock. For maintenance, please consult your dealer or authorized service centre.



- 
Stop using the appliance and unplug it from the power supply immediately if any following situations occur:
 - The appliance stops operating when moving the power cord.
 - If any control button fails.
 - If the circuit breaker works or the fuse burns out.
 - If the power cord or plug is abnormally hot.
 - If you notice a burnt odour or abnormally sound or vibration.
 - If there are any other abnormal phenomena or faults.

Please consult your dealer or authorized service centre for inspection and maintenance.
- Please clean the plug regularly.**
 - If there is dust and moisture on the plug, it may damage the insulation part of the plug and cause fire.
 - Unplug the plug and wipe it with a dry cloth.
 - Unplug the appliance when not use for a long time.
- Make sure to unplug the power supply before maintaining the appliance.**

Otherwise, the appliance may run suddenly and cause electric shock or injury.
- Please plug the power plug completely into the power socket.**

Failure to comply may cause fire or electric shock.
- Do not use damaged power plugs or power sockets.



- 
It is prohibited to place this product in the following places
 - Unstable places.
Otherwise, the appliance may tip over, resulting in injury or equipment damage.
 - Bathrooms, kitchens or places with high humidity/temperature.
Otherwise, the appliance may crack or electrical leakage, resulting in the risk of fire, electric shock or injury.
 - Places where oil or flammable gas may leak.
Failure to comply may lead to fire as the appliance inhaled combustible substances.
 - Near heating devices, fireplaces or any heat sources.
Otherwise, the appliance may overheat and cause a fire.
- Do not use gasoline or other volatile mixed solvents to wipe the unit**

Otherwise, the appliance may rupture or be short-circuited, resulting in injury, fire or electric shock.
- Do not use this appliance when you are using indoor smoke-type insect repellents.**
 - Otherwise, the insecticide may accumulate in the product and be discharged through the air outlet, endangering your health.
 - Ventilate the room thoroughly before using the appliance.
- Do not block the air inlet or outlet by placing clothes, books or other obstacles.**
- Do not sit, stand or lean on this product as it may lead to potential injury or unit damage.**
- Do not allow ignited cigarettes or incense near the appliance.**
- Do not spray any flammable materials such as insecticides or air fresheners around this product.**



- 
Do not unplug the appliance by pulling its power cord.

Otherwise, the power cord may be damaged, resulting in fire or electric shock.



Patented NCCO Air Purification Technology Brings Fresh and Clean Air

Nano Confined Catalytic Oxidation (NCCO) Air Purification Technology was invented by member of the HKUST Entrepreneurship Program and obtained global patents. It can solve indoor air quality problems in an all-around way, create a home/office environment with fresh air, and protect you and your family's health.



Features of NCCO Technology

- ◆ Continuously removes bacteria and viruses efficiently.
- ◆ Effectively decomposes gaseous carcinogens, such as formaldehyde.
- ◆ Decompose harmful pollutants into harmless water molecules and carbon dioxide, which will not cause secondary pollution.
- ◆ Under normal maintenance conditions, NCCO Reactor can use for a long time. Since there is no need to replace NCCO Reactor frequently, the operating cost is much lower than similar products on the market.
- ◆ Effectively remove offensive odour.
- ◆ NCCO is widely used in hospitals, elderly care centres, schools and public toilets.

About Intelligent Power-Off Protection System

After 8 hours of continuous operation, the air purifier will automatically power off and enter sleep mode for 30 minutes. Press the power switch to restart the appliance during sleep mode.

Placement of air purifier

- Maintaining efficient air circulation**
 Place the appliance on a dry, stable, level, and horizontal surface. Leave at least 15 cm free space from walls, furniture, curtains or any objects.
- Do not place the appliance exposed to direct sunlight, directly below an air conditioner, or in a room with apparent temperature change.**
 Otherwise, it may cause product deformation, aging, discoloration or shorten the lifespan.
- Do not use the same power supply with TVs, radios and other electrical appliances.**
- Do not place anything on top of the appliance. Otherwise, it may cause the product to function incorrectly or malfunction.**
- Place the appliance at least 1 meter away from electrical devices such as televisions or radios to prevent interference.**
- Do not block the air inlet and outlet by placing articles on the air outlet or in front of the air inlet.**

Illustration Diagram:

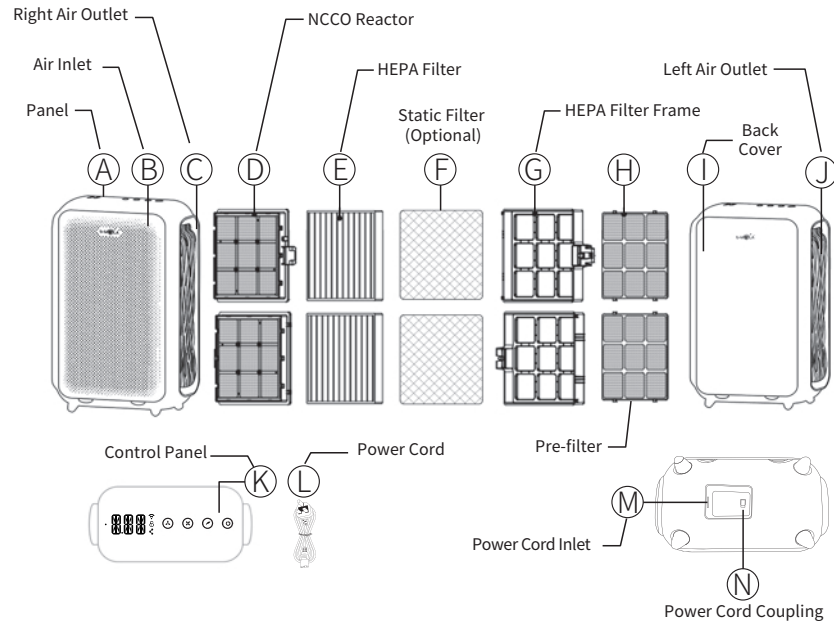

1. Remove all packaging and clean all removable parts and the grooves of the product with a soft, dry cloth.
2. Make sure the power sockets and extension units meet the requirements of the product. Make sure the product connects to the power supply before use.
3. This product is equipped with a sensor to monitor the position of the filter unit. If the filter unit is not in the correct position, the product will not work.
4. It is normal for the product to emit warm air with a mineral smell from the air outlet when the product first works. It is because the catalytic oxidation reaction is going on inside the NCCO Reactor.

Installing the filters

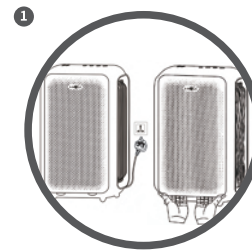

Unplug the appliance, find the two grooves under the front panel, and remove the front panel by pulling it outward.

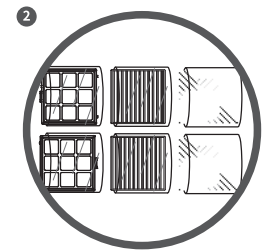

Remove all packaging before use.

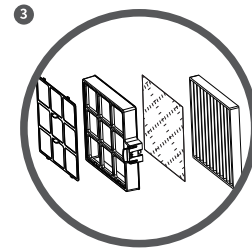

Install HEPA filter, static filter and pre-filter in sequence into HEPA filter frame.

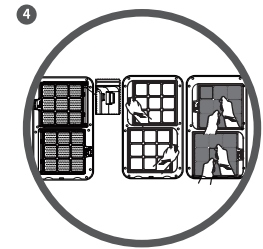

Install the upper NCCO Reactor and HEPA Filter Frame in sequence into the device. There is a click sound to indicate all the filters install successfully. Lower filters installation is as above.

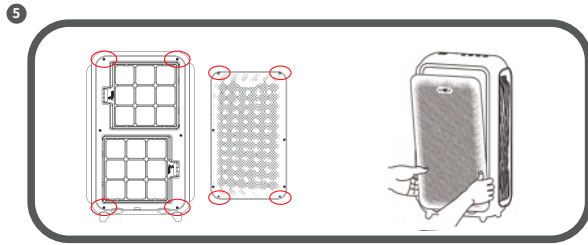

Align the front cover with the four positioning posts on the body, gently push inward, and the magnet will attach tightly to the body, and the front cover installation is complete.

ATTENTION

Please make sure all filters are installed.

Control Panel :

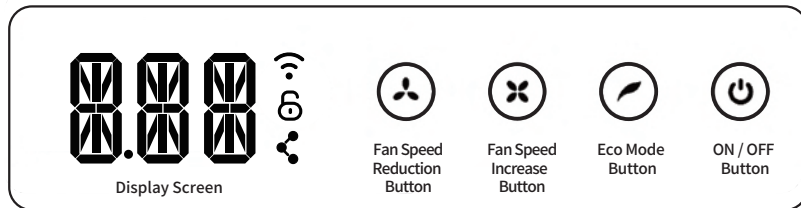

*This appliance supports 802.11 b/g/n 2.4GHz WiFi. If there is any connection problem, please contact your router supplier for problem solution.

1. Power On/Off Switch



ON: Press ON/OFF Switch to turn on the appliance. There will be a music sound to indicate that the power is on.

OFF: Press ON/OFF Switch again to turn off the appliance.

Note: Press and hold the reset button for 5 seconds when the machine is turned on to reset WiFi mode.

2. Default Fan Speed & Memory Function

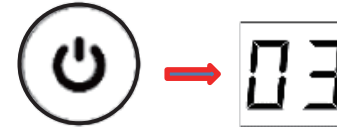

Default Setting: The fan speed will be restored to the default setting '03' when the appliance is unplugged from the power supply.

Memory Function: Use the power on/off button to turn off the appliance, and when it turns on again, it will maintain the same fan speed as before.

3. Adjust Fan Speed



Increase Speed: Each time you press the fan speed increase button, the speed will be increased by one level.

Reduce Speed: Each time you press the fan speed reduction button, the speed will be decreased by one level.

4. Turbo Mode



When the fan speed reaches level 10, press the speed increase and reduction buttons simultaneously to enter the Turbo Mode (SS).

'SS' mode is recommended to decontaminate a highly polluted environment quickly. Press the fan speed reduction button to exit 'SS' mode.

5. ECO Mode



Press the Eco mode button to enter Eco Mode and press once more to exit. Eco mode is recommended for sleeping time.

6. Child Lock Mode



Press the power on/off button and the ECO mode button for 5 seconds to activate the child lock. You will hear a reminder alarm, the child lock icon appear. Repeat the above steps to exit Child Lock Mode.

Note: When the child lock is activated, all buttons are not responsive.

7. Filter Installation Alert



If the HEPA filter/NCCO Reactor does not install properly, the display panel will show "EE". The product will not operate and making a warning alarm. Please reinstall the HEPA filter/NCCO Reactor.

ATTENTION

- The product equips with an intelligent protection system. It will stop operating with all indicating lights off for 30 minutes after 8 hours consecutive operation. The appliance will resume working automatically after 30 minutes. The user can reactivate the product at any time by pressing the Power On/Off button.
- When the product is left idle for 1 minute, the power button indicator will dim while other indicators will off.

! Always unplug the appliance before cleaning or carrying out other maintenance except replacing filters.



ATTENTION

- When using chemically treated cloth, be sure to follow the instructions.
- Do not leave disassembled parts unattended while performing maintenance.
- Do not operate the product without the filter installed, as this may cause irreversible damage to the NCCO Reactor.
- The efficiency of the NCCO Reactor will significantly decline if the HEPA filter does not replace as indicated in instructions.

Cleaning Instructions

- Cleaning the body of air purifier**
Use a soft, dry cloth to clean the interior and exterior of the air purifier.

ATTENTION
Never use abrasive, aggressive, or flammable cleaning agents such as bleach or alcohol to clean any part of the air purifier.
- Cleaning air inlet and outlet**
Clean the air inlet and outlet with a soft brush or vacuum cleaner.
- Cleaning pre-filter**
Pre-filter is washable.
To optimize the lifespan of the pre-filter, make sure it is air-dried thoroughly after cleaning.
- WARNING**
Never rinse or soak the HEPA filter or NCCO Reactor with water.

Filter Replacement & Maintenance

Care & Maintenance

1. Filter lifespan may vary on the environment, usage and location of the unit.
2. To optimize the performance of the air purifier, use the filter recommended only.
3. Clean the pre-filter regularly.
4. Users can follow the colour change indicators below to decide whether to replace the HEPA filter.
5. Turn off the air purifier but do not unplug from the power socket when replacing filters.

Recommended Filters Cleaning /Replacement Intervals and Solutions

Filter	Intervals	Solution
Pre-filter	/	Washing
HEPA Filter	Every 6 - 12 Months *	Replacement
NCCO Reactor	Sustainable use**	Sustainable use

* The filters cleaning and replacement intervals may vary on the operating environment.

** The NCCO Reactor may cover with dust or oily substances if the HEPA filter does not replace regularly or is damaged. It may result in a significant decline in the efficiency of the NCCO Reactor and require replacement.

HEPA FILTER COLOUR CHANGE INDICATOR

No need to replace	Recommended replacement	Need to replace
--------------------	-------------------------	-----------------

FAQs

Other Information

Q1

The device emits a "beep-beep" alarm and does not operate. The display screen shows "EE".

A

Please check if all filters are properly installed. If not, reinstall them.

Q2

Is HEPA filter washable?

A

HEPA filters are made of composite materials. Washing with water will significantly decrease its performance.

Q3

The air quality does not improve despite operating for a long time.

A

It will take a longer time for the air quality to improve when using this product in a very polluted environment. Recommended to use higher fan speed or allow it to run longer if necessary.

Q4

The appliance produces a burnt smell or smoke.

A

Turn off the appliance and disconnect it from the power supply immediately. Call the customer service center or contact a qualified agent.

Q5

The appliance releases a mineral smell during the first time use.

A

It is normal as catalytic oxidation reaction is taking place inside the NCCO Reactor. The smell is harmless to human body, and it would disappear after a period of operating time.

Q6

The display flashes "HP" intermittently, and the red-warning light on the body is on.

A

This is to remind the user that the device has been running for 3,000 hours. Need to check if the HEPA filter should be replaced.

(1) Please make sure the machine is on and running.

(2) Remove the HEPA filter(s).

(3) The display panel will show "EE". The product will not operate and making a warning alarm.

(4) Replace the HEPA filter(s).

(5) "EE" will disappear and the device back to normal.

Other Information

Problems	Solutions
The device does not operate.	Check if the device connects to the power supply. Turn on the device.
Display screen shows "EE". The device does not operate and making a "DiDiDiDi" warning alarm.	Check if the filters install correctly. Reinstall all filters.
The air quality does not improve despite operating for a long time.	It will take a longer time for the air quality to improve when using this product in a very polluted environment. Recommended to use higher fan speed or allow it to run longer if necessary.
	The filters may require cleaning or replacement.
The airflow that comes out of the air outlet is significantly weaker than before.	The filters may require cleaning or replacement. Clean or replace the filter(s). (See "Filter cleaning and maintenance")
	Check if the packing material is removed from the filters.
The device makes an abnormal noise.	Check if the packing material is removed from the filters.
	Make sure the air inlet and outlet are not blocked. Remove all objects that block the air inlet and outlet.
	Possible malfunction. Call the customer service center or contact a qualified agent.
The device produces a burnt smell or smoke.	Turn off the device and disconnect it from the power supply immediately. Call the customer service center or contact a qualified agent.

Other Information

Power Supply	Rated Voltage	110-240V~	
	Rated Frequency	50-60Hz	
Power Consumption (W)	Mode	Lowest	16
		Highest	35
		Turbo	40
Airflow Volume (m ³ /hr)	Mode	Lowest	<80
		Highest	230
		Turbo	280
Noise Level (dB)	Mode	Lowest	37
		Highest	50
		Turbo	54
Product Dimension (L x W x H) (mm)	340 (L) x 200 (W) x 550 (H)		
Net Weight (kg)	8.5		
Treatment System	Active Oxygen Generator	Sterilization	
	Pre-filter	Remove dust and hair	
	Static Filter (Optional)	Remove small particles larger than 10µm and cigarette smoke.	
	HEPA Filter	Remove dust, hair and airborne particles such as allergens and pollen, bacteria, viruses and fungus.	
	NCCO Reactor	Remove odour and decompose harmful pollutants such as formaldehyde and VOCs.	