



# 使用說明書

型號: BM10

## 附保修證

感谢您選用b-MOLA空氣處理系統。  
使用和維護本產品前，請仔細閱讀本使用說明書。  
使用本產品前請務必仔細閱讀「安全注意事項」。  
不過閱說明書使用本產品有可能導致受傷或財產受損。  
請妥善保管此說明書以供日後參考。  
請妥善保管保修證以供日後維修之用。



## 目錄

基本事項	02-06
安全注意事項	02-03
設置與使用要求	04
NCCO技術	05
主要部件名稱	06
使用入門	07-10
初次使用	07
使用說明	08-10
維護保養	11-12
清潔方法	11
濾網的護理和更換	12
其他	13-15
常見問題	13
疑難排解	14
產品規格	15

## 安全注意事項

## 基本事項

- 八歲或以上兒童，有身體缺陷，感官或精神問題，或者缺乏知識經驗的人士在獲得有關安全使用本裝置的監督/指導，並清楚所涉及的危害情況下可以使用本裝置。請勿讓兒童將本裝置當作玩具。兒童不得在沒有監督/指導的情況下進行清洗和維護設備的相關工作。
- 如果電源線損壞，必須由製造商或資格服務供應商進行更換，以免出現危險。
- 進行清潔和保養前，必須切斷本產品的電源。
- 為了避免对您或其他人造成傷害或財物損害，請務必遵守安全注意事項。以下標誌是根據錯誤使用所產生的危險或受傷程度進行分類。



**警告**

本標誌所代表的內容為「若不遵守會有死亡或嚴重受傷的危險」。



**注意**

本標誌所代表的內容為「若不遵守會有受傷或財物受損的危險」。

- 以下標誌為務必遵守的指示種類。（下列標誌為例子）



此標誌表示禁止事項



此標誌表示強制事項



- 禁止拉扯電源線來移動本產品。  
(否則電源線可能會損壞，導致火災或觸電)

- 禁止損壞電源線或電源插頭。

- 禁止切割、改裝、過度扭曲、摺紋、擠壓電源線，禁止電源線靠近熱源或在電源線上壓放重物等。（否則電源線可能會損壞，導致火災或觸電）

- 禁止使用指定電壓（DC5V 2A）以外的電源。  
(否則電源線可能會過熱，導致火災)

- 禁止將手指或金屬物等異物放入進風口、出風口或縫隙中。  
(否則可能會接觸到產品內部，導致觸電或受傷)

- 禁止手溫時觸摸電源插頭。  
(否則可能會導致觸電)

- 禁止將本產品放置在容易被水或其他液體濺到的地方。  
(否則可能會造成短路，導致火災或觸電的危險)

- 禁止將細小部件放置在嬰幼兒可觸及到的地方。  
(萬一吞食請速醫治)

- 禁止將產品內置電池投入火中及加熱、分解、改造。  
(如損傷了絕緣物或排氣閥等，電池可能會發熱、破裂導致受傷)



**警告**



- 禁止擅自拆開或改裝本產品。

- (否則可能會導致火災或觸電，如需進行維修，請聯絡客戶諮詢服務中心或經銷商)



**警告**



- 當有以下任何情況出現時，請立即停止使用本產品並拔出電源插頭。  
(否則可能會導致觸電、起火或冒煙)

-異常·故障的例子-

- 移動電源線時，產品運轉停止。
- 如果任何控制按鈕故障。
- 如果斷路器起作用或保險絲燒毀。
- 如果電源線或電源插頭異常發熱。
- 如果您發覺有燒焦的異味或異常的聲音或振動。
- 如果有其他任何異常現象或故障。

→ 立即停止操作本產品，並拔出電源插頭，聯絡客戶諮詢服務中心或經銷商進行檢查、維修。

- 請定期清潔電源插頭。

- (如果電源插頭上有灰塵、濕氣，可能會破壞電源插頭的絕緣部分，導致火災)
- 拔出電源插頭，用乾布擦淨。
- 長期不使用產品時，應拔出電源插頭。

- 維護保養產品前，請務必拔出電源插頭。

- (否則產品可能會突然運轉，導致觸電或受傷)

- 請將電源插頭完全插入電源插座。

- (如果電源插頭沒有完全插牢，可能會因電源線過熱導致火災或觸電)
- 禁止使用已損壞的電源插頭或鬆動的電源插座。



**警告**



- 禁止放置本產品於以下場所。

- 不平整的場所（否則產品可能會翻倒，導致受傷或產品損壞）
- 浴室或廚房等濕潤或高溫場所（否則可能會令到產品破裂、漏電，導致火災、觸電或受傷的危險）
- 油或可燃性氣體可能出現洩漏的場所（否則吸入產品內可能會起火，導致火災）
- 暖爐等熱源附近（否則產品可能會過熱，導致火災）

- 禁止使用汽油或其他揮發性混合溶劑擦拭產品。

- (否則產品可能會破裂或短路，導致受傷、火災或觸電)

- 使用煙熏型殺蟲劑時，禁止使用本產品。

- (否則產品內可能會積聚藥物，然後從出風口排出，危害身體健康)
- 使用殺蟲劑後，應先讓房間徹底通風，然後才可運轉產品。

- 禁止阻塞入風口或出風口，例如放置衣物或書本等雜物。  
(可能會導致冒煙、起火)

- 禁止坐、站立或倚靠本產品。

- (否則產品可能會翻倒，導致受傷或產品損壞)
- 有小孩的家庭要多加注意。

- 禁止將點燃的香煙、香火等接近產品。

- (否則易燃物可能會被吸入產品內導致起火，發生火災)

- 禁止在本產品周圍噴灑殺蟲劑或空氣清新劑等易燃物。



**注意**



- 請手持插頭部位拔出電源插頭。

- (否則電源線可能會損壞，導致火災或觸電)



**注意**

## 基本事項



### 嚴禁裝拆電池。

電池內部具有保護機構和保護電路，可以避免發生危險。不合適的拆裝會損壞保護功能，造成電池發熱、冒煙、變形或燃燒。

### 嚴禁加熱和焚燒電池。

加熱和焚燒電池將會造成電池隔離物的熔化、安全功能喪失或電解質燃燒，過熱就會使電池發熱、冒煙、變形或燃燒。

### 禁止弄濕產品。

本產品帶有電池，請勿弄濕產品，更不能將產品投入水中，否則會造成電池內部保護電路和功能喪失及發生不正常的化學反應，亦可能會導致電池發熱、冒煙、變形或燃燒。

### 避免在火源附近或陽光直射下充電或使用產品。

切勿在火源、烤爐附近或過高溫度的環境中充電或使用產品。過熱將會導致產品功能喪失、電池內部短路和發生不正常的化學反應，電池有可能發熱、冒煙、變形或燃燒。



警告

### 產品內置鋰電池安全事項說明

- ◎ 在第一次使用產品時，若發現產品內置電池有異味等不正常現象，請勿繼續使用產品，應及時聯繫銷售商更換產品。
- ◎ 在使用產品過程中，應遠離熱源、高壓，避免兒童玩弄摔跌產品。
- ◎ 避免產品在劇烈搖晃環境中使用。
- ◎ 避免在強光曝曬環境下存放或使用產品，以免發熱、變形、冒煙、降低電池壽命。
- ◎ 避免在會產生靜電的環境使用產品，以免電池工作不正常：發熱、變形、冒煙、降低電池壽命。
- ◎ 請使用專用充電器和推薦的充電方式給電池充電。
- ◎ 勿將產品正負極短路，切勿自己拆裝產品及電池，也勿讓產品放在受潮處，以免發生危險。
- ◎ 長期不用時，請將產品儲存完好，讓電池處於半荷電狀態，將產品保存於陰涼乾燥處。
- ◎ 切勿將產品投入火中或水中。



注意

## NCCO技術

## 基本事項

### 獨有NCCO納米氧聚解專利技術，帶來清新潔淨的空氣

NCCO (Nano Confined Catalytic Oxidation) 納米氧聚解空氣處理技術，是與香港科技大學創業計劃成員合作研發，並且獲得全球多國專利，可以全方位解決室內空氣質素問題，打造空氣清新的家居及辦公環境，保障您及您家人的健康。



### NCCO技術特點

- ◆ NCCO專利技術持續高效去除細菌及病毒。
- ◆ NCCO專利技術有效分解空氣中致癌物，例如甲醛等。
- ◆ 有害污染物會被分解為無害的水及二氧化碳，不會積存於濾芯，有效避免因飽和而重新釋放到空氣中，不會造成二次污染。
- ◆ 正常維護情況下，NCCO濾芯可以長期使用。由於無需頻繁更換濾芯，使用成本遠較市面上同類產品為低。
- ◆ 有效去除室內空氣中的異味。
- ◆ NCCO專利技術獲廣泛應用，例如學校、醫院、護老中心及公眾洗手間等。

### 關於智能斷電保護

自帶智能斷電保護系統，當使用接通外置電源時，機器運行 8 小時後智能斷電，30 分鐘後自動重啟；當使用內置電源時，機器運行 2 小時後智能斷電，10 分鐘後自動重啟。智能斷電能有效避免機器過度負荷，消除用電安全隱患。

### 產品安放位置

- 針對室內揚塵。  
由於灰塵容易落到地板附近，建議將本產品放在房間中的平坦的地方。
- 使室內的空氣有效循環。  
請將本產品設置在其左右與上方距離牆壁、傢俱、窗簾等約 15cm 以上的場所，否則污染物難以被吸入機體。
  - 請勿設置本產品於以下場所：
    - ◎ 陽光直射、被空調吹到或受熱等場所 (否則可能會造成變形、老化、變色或縮短壽命)
    - ◎ 電視機及收音機等物體附近 (否則可能會導致影像紊亂以及雜音)
  - 請勿與電視機、收音機等設備使用同一電源插座。  
(電源插頭插入時有可能會產生影像紊亂以及雜音) → 請將電源插頭插到其他電源插座上。
  - 請勿在產品上放置物品。  
(否則產品可能會誤操作或故障)

- 請勿在產品進風口和出風口處放置障礙物。  
(否則可能會影響產品性能)

## 主要部件名稱

部件名稱：

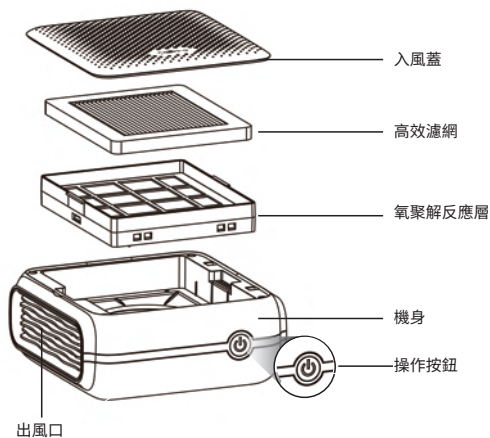

電源適配器



USB Type-C電源線



綁帶 (選配)



硅膠套 (選配)

## 基本事項

## 初次使用

## 使用入門

1. 拆除所有包裝，用一塊柔軟乾燥的布將所有可拆卸的部件以及本產品的凹槽清潔一遍，然後再將這些部件安裝起來。
2. 將本產品置於一個乾燥、平整的平面，並確保它與附近的牆體或物品都保持至少15釐米的距離，以確保本產品能夠正常工作。
3. 檢查插座和所有外接電源線，確保其均符合產品的要求。確保產品在使用前已經接好電源。
4. 本產品裝有感應器以監測濾網組件的位置。如果濾網組件的位置不正確，本產品將無法工作。
5. 本產品首次工作時，如果產品的出風口排出具有礦物氣味的暖風是屬於正常情況，因為氧聚解反應層內部在進行催化氧化反應。

### 安裝步驟：

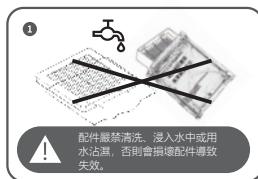

撕開包裝袋，取出高效濾網和氧聚解反應層。

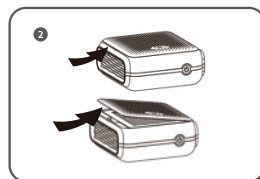

手指向上輕推位於機身側面的凹位可以打開入風蓋。

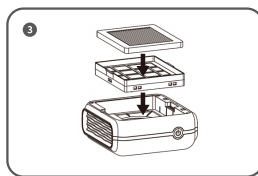

把高效濾網裝入氧聚解反應層盒子。把裝好的整套的濾網向下按壓裝入機身裡面。

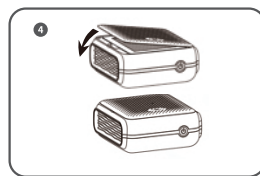

將入風蓋裝回原位，接通電源，按下開關電源按鈕即可啟動本產品。

使用方法：



◎ 開/關

接駁電源後，輕按開關按鈕以啟動空氣淨化機，指示燈會亮起白色光，顯示為靜音模式。

再輕按開關按鈕一次，空氣淨化機轉為高效模式，指示燈會亮起藍色光。

再輕按一次開關按鈕，以關閉空氣淨化機。

本產品備有記憶功能，記錄關機前的操作模式。



◎ 燈光

以下為不同燈光閃爍時所表示的情況：

	風速	慢閃	快閃
藍燈	高	運行、充電	電量低
白燈	低	運行、充電	電量低

■ 當燈光白色和藍色交替閃爍時，表示設備處於關機充電狀態。



◎ 記憶功能

當外接電源停止供電時機器會自動轉換使用內置電池工作模式，當電池電量耗盡停機的時候，機器會自動記憶斷電時的模式，重新連接外部電源時，會繼續保持斷電前的工作狀態。

車內安裝說明(本公司不提供車充用品)：

A. 安置於車內平整表面



將電源線Type-C連接端插入產品底部Type-C插孔內。

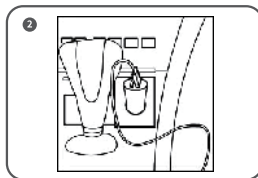

再將電源線另一端連接至車載充電器插頭，並且接駁至車載充電器插座。

不建議放置在汽車儀表板之上，因為溫度可能較高，有機會對空氣淨化機的內置電池造成損壞。

注意事項

- 若濾網組合沒有裝入機器內，機器會發出“滴滴滴”的報警聲，請確保濾網組合被正確放置。
- 初次使用時，因氣聚解反應層特殊的製造工藝會有輕微的礦物味道，這是正常現象，對人體無害，使用一段時間後味道便會消失。
- 該產品的輸入功率為DC5V 2A，請確保正確的電源供應。
- 在車內安裝使用前，請先確保中斷電源供應，小心提起產品。

B. 安置於車枕後方

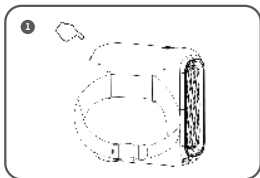

將硅膠套對準機身位置套入，將綁帶扣解開，穿入硅膠套上的兩個預留口。



將電源線Type-C連接端插入產品Type-C插孔內。

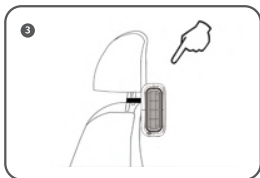

利用綁帶將空氣淨化機穩妥固定在車枕後方，請確保空氣淨化機不會晃動。

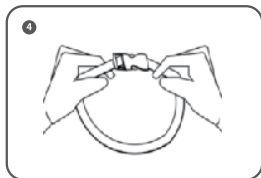

**!** 維護保養產品前（除進行濾網更換操作外），請務必拔出電源插頭。（否則產品可能會突然運轉，導致觸電或受傷。）



提示事項

- 使用經過化學處理的抹布時，請務必按說明操作。
- 進行維護時，請勿隨意擺放拆卸的零件。（否則可能會絆倒路人或造成零件損壞）
- 濾網未安裝時，請勿運轉本產品。（否則將會對氧聚解反應層造成不可逆轉的損壞）
- 如果沒有定期更換高效濾網，會導致氧聚解反應層處理效率嚴重降低。

清潔方法

清潔外部機身



請先將入風蓋與機身分離後，方可用水沖洗入風蓋（僅入風蓋用水沖洗），再用柔軟的乾布擦拭機身，以免將灰塵落入機體內。

提示事項

- 切記：沖洗完入風蓋後，需用乾布把入風蓋完全擦乾才能蓋回。
- 小貼士：可以用濕布來清潔產品表面，但請勿使用帶有磨料的材質。

清潔入風口和出風口

用柔軟的毛刷或吸塵機清潔入風口和出風口。

提示事項

警告：不可用水清洗高效濾網和氧聚解反應層，也不可將它們浸泡在水中。



長期閒置時

- ① 停止運轉產品，並拔出電源插頭。
- ② 需進行維護保養。
- ③ 放入塑膠袋和紙箱中，並存放於乾爽處。

## 濾網的護理和更換

## 維護保養

1. 根據環境、使用方式和設備所處位置的不同，濾網的壽命也各不相同。
2. 如需讓設備維持最佳狀態，建議僅使用推薦的濾網。
3. 在更換濾網時，請保持機器關機狀態，但請勿斷開機器與電源的连接。
4. 高效濾網可根據下表的濾網顏色變換指標進行操作。

濾網及濾芯的清潔和更換週期建議

濾網/濾芯	週期時長	方法
高效濾網	每 6-12 個月*	更換
氧聚解反應層	可長效使用**	可持續使用

\* 濾網更換週期可能會因運行環境的不同而有變化

\*\* 如高效濾網沒有定期更換或受損，拆開見到氧聚解反應層表面有灰塵/油性物質遮蓋或污染，可能會減低效用從而導致需要更換氧聚解反應層。

高效濾網表面顏色變換更換指標

不需要更換	建議更換	需要更換

## 常見問題

## 其他

**Q1** 設備發出“嗡嗡”聲響及不運作。

**A**

請重新檢查濾網組件是否安裝正確，並重新安裝濾網組件。

**Q2**

高效濾網是否可以清洗？

**A**

高效濾網為複合材料製成，水洗後會嚴重影響淨化效果。

**Q3**

在長時間運行後，空氣品質仍然沒有改善。

**A**

當在一個污染較嚴重的地方使用本產品時，空氣品質的改善需要較長時間。可使用更高一級的性能設置或在必要情況下讓設備運行更長的時間。

**Q4**

設備散發出異常氣味或煙霧（例如：煙霧、火苗或燃燒）。

**A**

請立即關閉設備切斷電源，並立即致電客服中心或聯繫有授權的服務供應商處理。

故障描述	解決方法
設備不工作	查看設備是否已經接通電源。 啟動設備。
設備發出“嗚嗚”聲響及不運作	檢查濾網是否安裝正確。 重新安裝濾網。
出風口沒有排風	查看設備是否已經接通電源。 啟動設備。
在長時間運行後，空氣質量仍然沒有改善	當在一個污染較嚴重的地方使用本產品時，空氣品質的改善需要較長時間。可使用更高一級的風速檔位或在必要的情況下讓設備運行更長的時間。
	可能需要清潔或更換濾網。 清潔、更換濾網。
出風口的氣流速度減慢	濾網可能被阻塞。 更換濾網。 (安裝濾網的方法見第7頁。)
	確認所有的包裝材料都被拆卸。
設備發出異常噪音	確認所有的包裝材料都被拆卸。
	確保入風口和出風口沒有被異物阻塞。
	設備可能出現故障。 致電客服中心尋求建議或諮詢有授權的服務供應商。
設備散發出異常氣味或煙霧 (例如：煙、火苗或燃燒)	關閉設備，切斷電源。 立即致電客服中心或聯繫有授權的服務供應商。

供電電源			DC5V 2A
耗電量 (瓦特)	模式	低速	1.8
		高速	2.2
風量 (立方米/小時)	模式	低速	18
		高速	23
噪音水平 (分貝)	平均聲壓級		40 dB-43 dB
	聲功率級		44 dB-47.3 dB
產品尺寸 (長 x 寬 x 高) (毫米)	170 (L) x 170 (W) x 78 (H)		
淨重 (kg)	0.88		
處理系統	活氧產生器	殺菌消毒	
	高效濾網	去除灰塵、毛髮和漂浮在空氣中的顆粒， 比如致敏原、花粉、細菌、病毒和真菌	
	氧聚解反應層	去除異味，將諸如甲醛和VOC等有害污染物分解	





# Operation Manual

Model No.: BM10

## WARRANTY CARD ATTACHED

Thank you for choosing b-MOLA NCCO Air Treatment Unit.  
Before using and maintaining this appliance, please read this manual carefully and thoroughly.  
Please read the "Safety Instructions" carefully before using this appliance.  
Failure to follow the instructions to use this appliance may result in injury or property damage.  
Please keep this manual in a safe place for future reference.  
Please keep the warranty card for future repairs.



## CONTENT

<b>Basic Information</b> .....	<b>02-06</b>
Safety Instructions .....	02-03
Setting & Operation Requirement .....	04
NCCO Technology .....	05
Main Parts & Components .....	06
<b>Getting Started</b> .....	<b>07-10</b>
First-time Operation .....	07
Operating Instructions .....	08-10
<b>Care &amp; Maintenance</b> .....	<b>11-12</b>
Cleaning Instructions .....	11
Filter Replacement & Maintenance .....	12
<b>Other Information</b> .....	<b>13-15</b>
FAQs .....	13
Trouble Shooting .....	14
Product Specification .....	15

## Basic Information

- This appliance can be used by children aged from 8 years and above and persons with reduced physical, sensory or mental capabilities or lack of experience and knowledge if they have been given supervision or instruction concerning use of the appliance in a safe way and understand the hazards involved. Do not let children use this device as a toy. Cleaning and user maintenance shall not be made by children without supervision.
- If the supply cord is damaged, it must be replaced by the manufacturer, its service agent or similarly qualified persons in order to avoid a hazard.
- Prior to cleaning or maintenance, the appliance must be disconnected from the supply mains.
- In order to avoid injury of operatives or others, please follow safety instructions. These 2 symbols below are classified as according to the risk or degree of injury caused by incorrect operation:



**WARNING**

This symbol indicates "if not follow the warning, it would cause injury or death."



**PRECAUTION**

This symbol indicates "if not follow the precaution, it would cause injury or property loss."

- The following symbols are the types of instructions that must be followed:



**PROHIBITION**



**MANDATORY**



- Do not move the unit by pulling on the power cord.
  - (Otherwise the power cord could be damaged, resulting in fire or electric shock.)
- Do not damage the power line or the plug.
  - Do not cut, refitting, over twisting, extruding power line. Do not put the power line near to any heat sources, do not put any heavy objects over the power line. (Otherwise the power line could be damaged, resulting in fire or electric shock.)
- Do not use power source other than DCSV 2A.
  - (Otherwise the power line would overheat, resulting in fire.)
- Do not put fingers, metal, or any other objects into air inlet / outlet or gap.
  - (Otherwise it could result in electric shock or injury.)
- Do not touch power plug with wet hand.
  - (Otherwise it could result in electric shock.)
- Do not place the unit in a location near a water / liquid source or where it can easily get wet.
  - (Otherwise, the unit may be short-circuited, and resulting in fire or electric shock.)
- It is prohibited to place small objects near any area of the unit where a child or infant might be liable to touch.
  - (If the child or infant eat these small objects by mistake, please immediately take the child or infant to hospital.)
- It is prohibited to place the battery in the fire or near heat.
  - (Damage to the battery outer insulation cover or release valve could cause personal injury.)



**WARNING**



- Do not disassemble, repair, or modify the unit on your own.
  - (Otherwise it could result in fire or electric shock. If maintenance work is needed, please contact Customer Service Centre or the distributor.)



**WARNING**



- When any of the following situations occur, please stop operating the unit and disconnect the power supply immediately.
  - (Otherwise, it may lead to electric shock, fire or smoke.)

- When the power line is moved, the unit stops operating.
  - If any control button fails.
  - If the circuit breaker works or the fuse burns out.
  - If the power line or plug is unusually hot.
  - If you notice burning odour or abnormal sound or vibration.
  - If there are any other abnormal phenomena or faults.
- Stop operating unit, pull out power plug, and contact Customer Service Centre or distributor for inspection and maintenance.

- Please regularly clean the plug.

(If there is dust and moisture on the plug, it may damage the insulation part of the plug and cause fire.)

- Pull out the power plug and wipe it with a dry cloth.
- Pull out the power plug when the unit is not used for a long time.

- Make sure disconnect the power supply before maintaining the unit.
  - (Otherwise the unit may suddenly operate, resulting in electric shock or injury.)

- Please insert the power plug completely into the power socket.
  - (Otherwise it may cause fire or electric shock if the power line is overheated.)

- Do not use damaged power plugs or power sockets.



**WARNING**



- Do not place the unit in the following places:

- Unstable place.
  - (Otherwise the unit may be fall off, resulting in injury or damage to the unit.)
- Bathroom, kitchen or other places with high humidity / temperature.
  - (Otherwise the unit may be damaged or suffer from electric leakage, resulting in fire, electric shock or personnel injury.)
- Places where oil or flammable gas may leak.
  - (Otherwise fire may occur in the inhaled monitor, leading to fire.)
- Near heater or other heat sources.
  - (Otherwise the unit may be overheated, leading to fire disaster.)
- Do not use gasoline or other volatile mixed solvents to wipe the unit.
  - (Otherwise, the unit may rupture or short circuited, resulting in injury, fire or electric shock.)
- Do not operating the unit while smoking pesticide is used.
  - (Otherwise, the pesticide may accumulate in the unit and then released from the outlet, endangering health.)
- After using pesticide, the room should be ventilated thoroughly, before the unit can be operated.
- Do not block the air inlet or outlet by placing clothes, books or other obstacles.
  - (Otherwise, blocking the air outlet may lead to smoke and fire.)
- Do not sit, stand or lean on this product.
  - (Otherwise, the unit may be overturned, resulting in injury or unit damage.)
- If children is around, please supervised carefully.
- Do not approach the unit with ignited cigarettes, incense and others.
  - (Otherwise, flammables may be sucked into the unit and cause fire.)
- Do not spray flammable materials such as insecticides or air fresheners around this product.



**PRECAUTION**

## Setting & Operation Requirement



- Please pull out the power plug at the hand plug position. (Otherwise, the power line may be damaged, resulting in fire or electric shock.)



- It is prohibited to disassemble battery.  
There are protection mechanisms and protection circuits inside the battery to protect the user. Any improper dismantling will damage the protection mechanisms and possibly cause the battery to get heated, generate smoke and fire.

- It is prohibited to heat or burn the battery.

This may cause the melting of the battery insulator with the loss of its safety function and burn the electrolyte within. High temperatures might cause the battery to overheat, distort the case and lead to smoke and possibly fire.

- It is prohibited to wet the unit.

The unit is installed with an internal battery. Wetting the unit or placing it into water may cause the loss of functionality of the battery protective circuits. This could lead to an abnormal chemical reaction leading to possible heating of the battery, giving off smoke and start a fire.

- Please avoid charging or operating the unit near a source of fire or under direct strong sunlight.

Do not charge or operate the unit near the source of a fire or oven, or in an environment of excessive high temperatures. Overheating could ensue causing functionality loss, short circuit of the battery together with an abnormal chemical reaction. This could overheat the battery leading to smoke and possibly fire.



### LITHIUM BATTERY SAFETY PRECAUTION

- If one observes an undesirable odour from the installed battery, or from other areas within the unit on first-time operation, please do not operate and return to the distributor.
- Please keep the unit away from an environment involving a heat source, a high barometric pressure or an increasing pressure on the surface of unit during its operation. Place the unit in a secure and safe operating location and away from children.
- Avoid the unit being shaken in a serious vibrating environment.
- Please avoid storing or operating the unit in a strong sunlight and hot environment. This will prevent the battery from overheating, becoming distorted, smoking or shortening its life.
- Please avoid operating the unit in an environment which might conduct static electricity and induce the battery to overheat, distort, generate smoke or shorten its life.
- Please only charge the battery with the dedicated charger and follow the recommended charging method.
- Insert battery in correct polarities. It is prohibited to arbitrarily disassemble or re-fit unit and battery. For safety concern, do not place unit at a wet location.
- To keep the battery at half-charged condition without any damage and place in the unit a cool dry location when stored for a long period of time.
- Do not put unit into fire or water.



## NCCO Technology

## Basic Information

### Patented NCCO Air Purification Technology Brings Fresh and Clean Air

Patented NCCO (Nano Confined Catalytic Oxidation) Air Purification Technology is invented by Member of HKUST Entrepreneurship Program, and has obtained global patents. Our technology can solve indoor air quality problems in an all-round way, create a home / office environment with fresh air, and protect you and your family's health.



### NCCO Technology's Characteristics

- ◆ Patented NCCO Technology continuously removes bacteria and viruses efficiently.
- ◆ Patented NCCO Technology effectively decomposes carcinogens in the air, such as formaldehyde.
- ◆ Hazardous pollutants will be decomposed into harmless water molecule and carbon dioxide, and will not accumulate in the filter, effectively avoiding re-release into the air due to saturation, and will not cause secondary pollution.
- ◆ Under normal maintenance conditions, NCCO Reactor can be used for a long time. Since there is no need to replace NCCO Reactor frequently, the operating cost is much lower than similar products on the market.
- ◆ Effectively remove offensive odour.
- ◆ Patented NCCO Technology has been widely used in different industries, such as schools, hospitals, nursing centers and public toilets.

### About Intelligent Power-Off Protection System

b-MOLA NCCO Air Treatment Unit is designed using an Intelligent Power-Off Protection System. The unit will intelligently power off after continuous use over a period of 8 hours and then will restart automatically after 30 minutes downtime once connected to an external power supply. The unit will use the intelligent system to power-off after continuous use of 2 hours, and then will restart automatically after 10 minutes of downtime when using its internal (battery) power supply. Our intelligent power-off system is able to effectively avoid excessive load and eliminate any risk during the supply of power.

### Placing Area Guideline

- **Indoors**  
As dust falls on the floor, it is recommended to place the unit on a flat surface in the room.
- **Excellent Air Circulation**  
Placing the unit on a dry, solid, level surface, and ensure the unit is provided with reasonable space of at least 15 cm from any objects, in order to operate effectively.
- **Do not put the unit in the following places:**
  - In the direct sunlight; blown by air conditioner; high temperature area. (Otherwise, it may cause deformation, aging, discoloration or reduction of service life.)
  - Distance over 1 meter to objects such as televisions and radios. (Otherwise, it may lead to image disorders and loss of sound.)
- **Do not place objects at air inlet and outlet.**  
(Otherwise, it may affect the operating performance.)
- **Do not use the same power outlet with TV, radio and other equipment.**  
(Otherwise, it may lead to image disorders and loss of sound.)  
→ Please plug into other power outlets.
- **Do not place any items on top of the unit.**  
(Otherwise, the unit may be malfunctioned.)

## Illustration Diagram:

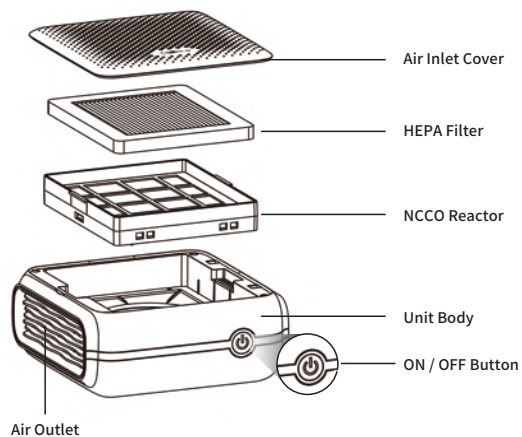

Power Adapter

USB Type-C  
Power Cord

Ribbon (Optional)

Silicon Rubber Case  
(Optional)

1. Remove all packaging materials, use a soft dry cloth to clean all the parts then re-assemble parts back together.
2. Placing the unit on a dry, solid, level surface, and ensure the unit is provided with reasonable space of at least 15 cm from any objects, in order to operate effectively.
3. Check power sockets and any extension cords to confirm compliance with unit requirements. Ensure that the unit is plugged in before usage.
4. The unit is installed a sensor, if filters have not been properly installed, the unit wouldn't operate.
5. When the unit is turned on for the first time, warm air and mineral smell may be released from the air outlet. This is normal as catalytic oxidation is taking place inside the NCCO Reactor, and completely harmless to human body.

## Installation Procedures:

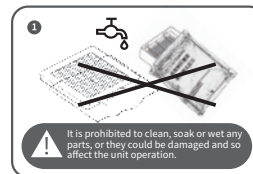

Take out HEPA Filter and NCCO Reactor from protective packaging material.

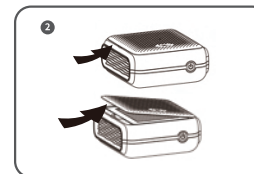

Slightly push the concave upward to open Air Inlet Cover.

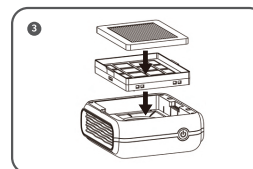

First, put HEPA Filter into NCCO Reactor Frame. Then, install the filter set into unit body.

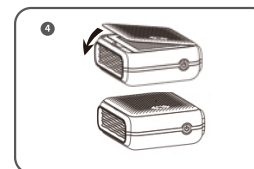

Close the Air Inlet Cover, connect the unit with power supply then press the ON / OFF Button to turn on unit.

Operation Method:

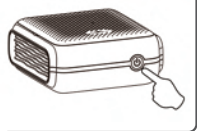

◎ ON / OFF Button

After connecting unit with power supply, press ON / OFF Button to switch on unit. The white light indicates the unit operates with Silent Mode.

Press ON / OFF Button again, the unit operates with High Flow Mode indicated by blue light.

Press ON / OFF Button for the third time to switch off unit.

The unit is designed with memory function to memorize the last operation mode before switching off.



◎ LED Indicator

When the power ON/OFF indicator flashes in different colours, they indicate following situations:

	Fan Speed	Slow Flash	Fast Flash
Blue Indicator	Highest	Running & Charging	Low Power
White Indicator	Lowest	Running & Charging	Low Power

■ When the indicator flashes white and then blue alternately, it indicates that the unit is off and is charging.



◎ Memory Function

When the external power supply is stopped or interrupted unexpectedly, the unit will automatically transfer to its internal battery power supply. When the battery is exhausted and the unit stops running, it will memorise the operation mode and will return to the previous mode when external power is reconnected to it.

In-Car Installation (No car charger will be provided.):

A. Put the unit on a flat surface



First, insert the Type-C connector of the power cord into the Type-C jack at the bottom of the unit.

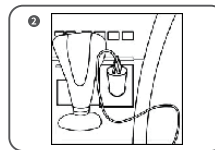

Insert the other end of the power cord into the plug of the car charger, and then insert into the charger socket.

It is not recommended put the unit on the car dashboard, where the surrounding higher temperature may damage the built-in battery.

ATTENTION

- If the filter set should not be installed into the unit, a 'DiDiDi' alarm sound will be heard from the unit. Please ensure that the filter set is properly installed prior to switching the unit on.
- When first switched on there will be a slight mineral smell. This is perfectly normal and is due to special manufacturing technique of the NCCO Reactor. The smell is harmless and will disappear after a period of time operating the unit.
- Please check and ensure that the car power supply is correct. The power input of this unit is DC5V 2A.
- Prior to installing and operating the unit in car, please make sure that the power supply has been disconnected and lift it up carefully.

### B. Hang at the back of car pillow:

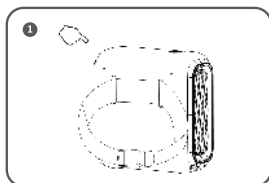

First, properly place the unit into Silicon Rubber Case. Then, unbuckle the ribbon and put it into case.



Insert the Type-C connector of the power cord into the Type-C jack at the bottom of the unit.

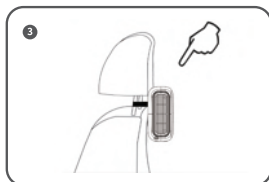

Tightly hang the unit with ribbon at the back of car pillow and ensure unit away from swinging.

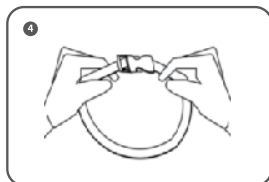

Always disconnect the power supply of the unit before any maintenance or care process is carried out (except replacing filters). (Otherwise the unit might still be running and could cause an electrical shock or injury)



**WARNING**

### ATTENTION

- Please follow the instructions to clean the unit with detergent cloth.
- During maintenance, do not touch the disassembled parts. (Otherwise could cause stumble or parts damaged.)
- Do not operate the unit if Filters have not been installed, since this could cause irreversible damage to the unit.
- If the HEPA Filter is not replaced periodically as indicated in instructions, it may seriously affect the efficiency of the NCCO Reactor.

## Cleaning Instructions

### Cleaning External Surfaces of Unit Body

Please remove Air Inlet Cover before washing it with water (only Air Inlet Cover can be washed with water). The main body of the unit can be wiped with a soft dry cloth but avoid dust falling on the unit.

1



### ATTENTION

- After washing the air inlet cover, please ensure that it is completely dry before replacing onto the main unit.
- Tips: A damp (non-abrasive) cloth can be used to clean the unit surface.

2



### Cleaning Air Inlet and Air Outlet

Use a soft brush or light vacuum to clean the air inlet and air outlet.

### ATTENTION

**WARNING:**

Never rinse or soak HEPA Filter or NCCO Reactor with water. When the unit has not been used for a long period of time:

- ① Stop operating unit and pull power plug from power source.
- ② Carry out any maintenance or care work.
- ③ Place the unit in a plastic or box carton, and store in a cool dry place.

## Filter Replacement & Maintenance

## Care & Maintenance

1. Filter lifetime will vary depends on environment, amount of usage and location of the unit.
2. To maintain optimal operating condition of the unit, only use the recommended filter.
3. Turn off unit but maintain power supply when replacing filters.
4. Please follow HEPA Filter Surface Color Changing Indicator to dispose HEPA Filter.

### Recommended Filter Cleaning and Replacement Cycles and Methods

Filters	Cycle	Method
HEPA Filter	Every 6 - 12 Months *	Replacement
NCCO Reactor	Substantial**	Substantial

\* The filters cleaning and replacement cycle may vary depending on the operating area.

\*\* If the HEPA Filter has not been replaced periodically, or it has been damaged, the surface of the NCCO Reactor is covered with dust or oily substances after disassembling, the removal capacity of the NCCO Reactor may be badly reduced and should be replaced.

### HEPA FILTER SURFACE COLOR CHANGING INDICATOR

No replacement needed	Replacement is recommended	Replacement is needed

## FAQs

## Other Information

Q1

Unit is making 'DiDiDi' sound and not operating.

A

Please check if filters have been properly installed. If not, please re-install them.

Q2

Can HEPA Filter be washed with water?

A

HEPA Filter is made of composite material, water would seriously affect the purification effect.

Q3

The air quality has not improved even after the unit has been turned on for a long time.

A

If the unit is used in a severely polluted area, the treatment process will take longer. It is recommended to use the HIGH FLOW MODE or extend the operational time until the pollution diminishes.

Q4

The unit emits an unusual smell or smog. (e.g. smoke, flame, or burning)

A

Turn off the unit and disconnect it from power supply right away. Call the customer service center immediately or contact with a qualified service provider.

Problems	Solutions
The unit does not operate.	Check if the unit is correctly connected to its power supply. Turn on the unit.
Unit is making 'DiDiDi' sound and not operating.	Check if the filters have been correctly installed. Re-install all filters.
No air is blowing through air outlet.	Check if the unit is correctly connected to its power supply. Check if the power cord interface is in good service condition.
The air quality is not yet improved after a long time operation.	If the unit is used in a seriously polluted area, the treatment process would take longer than normal. It is recommended to operate the unit with high airflow mode until the pollution diminishes.
	The Filter may require cleaning and replacement.
The airflow from air outlet becomes slow.	Filter may be blocked. Replace the filter. (For the method to install filters, please refer to Page 7.)
	Make sure all packaging materials are removed.
The unit makes an abnormal noise.	Make sure all packaging materials are removed.
	Make sure the air inlet and outlet are not blocked by external objects. Remove all adjacent objects that block the air inlet and outlet.
	The unit may malfunction. Call the customer service center for advice or consult with a qualified service provider.
The unit emits an unusual smell or smog. (e.g. smoke, flame, or burning)	Turn off the unit and disconnect it from power supply. Call the customer service center immediately or contact with a qualified service provider.

Power Supply		DC5V 2A	
Power Consumption (W)	Mode	Lowest	1.8
		Highest	2.2
Airflow Volume (m <sup>3</sup> /hr)	Mode	Lowest	18
		Highest	23
Noise Level (dB)	Sound Pressure Level		40 dB-43 dB
	Sound Power Level		44 dB-47.3 dB
Product Dimension (L x W x H) (mm)	170 (L) x 170 (W) x 78 (H)		
Net Weight (kg)	0.88		
Treatment System	Active Oxygen Generator	Sterilization	
	HEPA Filter	Remove dust, hair and airborne particles such as allergens and pollen, bacteria, viruses and fungus.	
	NCCO Reactor	Remove odour and decompose harmful pollutants such as formaldehyde and VOCs.	