

Tomfaucet

User's Manual



RB0922

This listing period is based upon the last date of the month indicated on the Effective Date and Void After Date shown above. Any change in material, manufacturing process, marking or design without having first obtained the approval of the Product Certification Committee, or any evidence of non-compliance with applicable codes and standards or of inferior workmanship, may be deemed sufficient cause for revocation of this listing. Production of or reference to this form for advertising purposes may be made only by specific written permission of IAPMO Research and Testing, Inc.

► Notes before installation

1. Confirm whether the inlet pipe and corner valve have been properly installed before installation.
2. Before installation, be sure to clean the dust, sand and other foreign bodies in the water supply pipe to ensure that the inlet pipe is free of sundries, so as not to shadow sound water outlet function.
3. Inlet water pressure of $0.05\text{Mpa} \leq \text{inlet water pressure} \leq 0.75\text{Mpa}$, if the water pressure is lower than 0.05Mpa , it may cause poor effect for the water outlet.
4. The cold and hot water piping should not be mismatched, and the heating pipes should not use steam.

► Recommend Tools And Materials

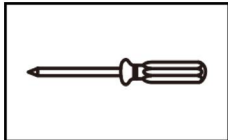

Screwdriver



A Tape Measure



Sealant

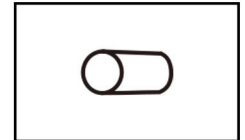

PVC Tube

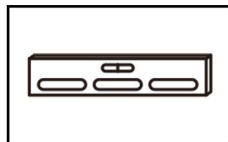

Level

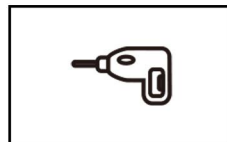

Impact Drill

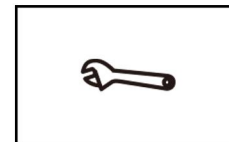

Adjustable Wrench

► Installation Dimension

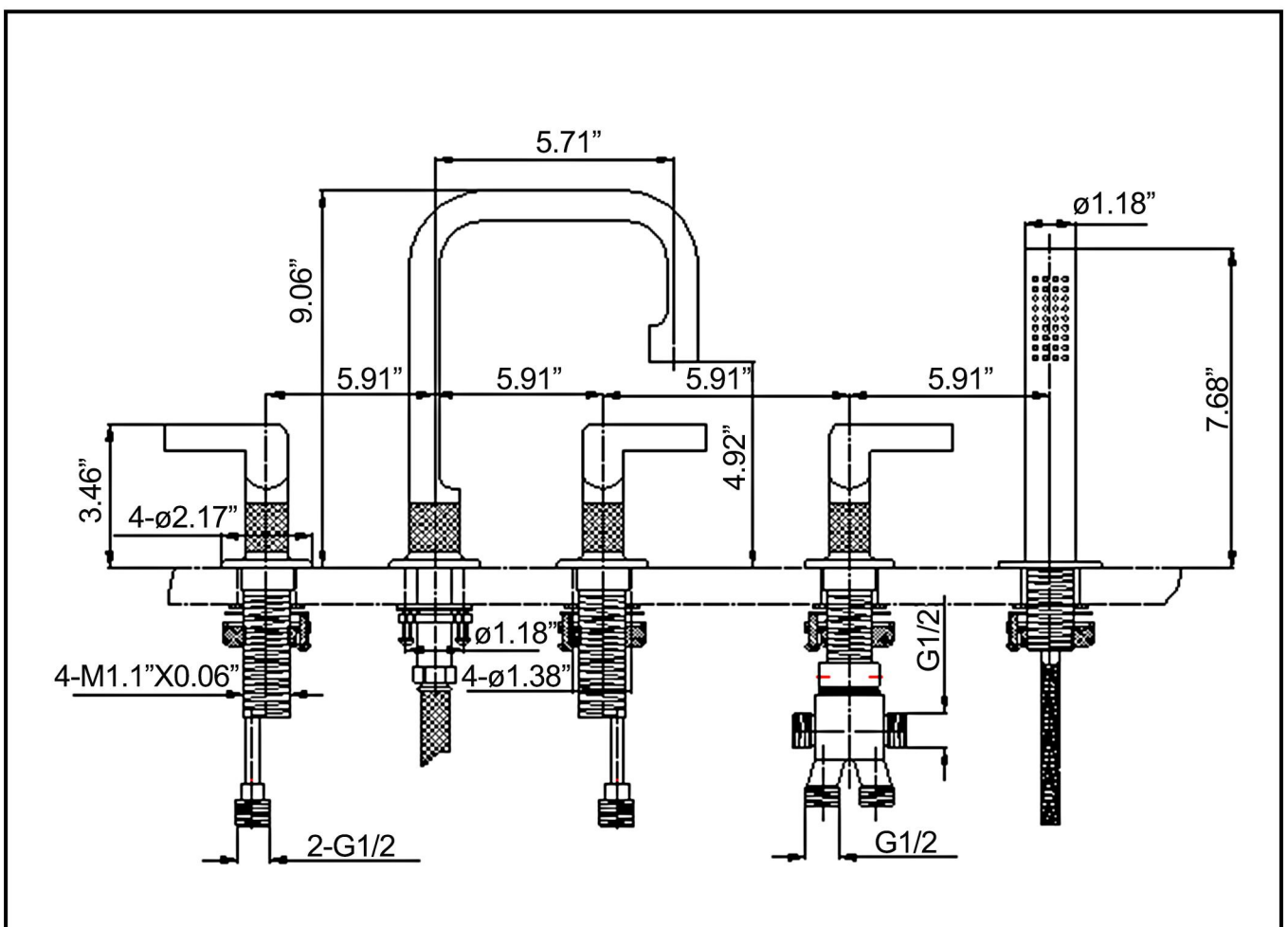

This product has been inspected and debugged by the factory to the best condition. Please do not disassemble and assemble it yourself.



Before installing the faucet, please be sure to remove sundries and sludge from the water pipe to prevent sundries from blocking the faucet.

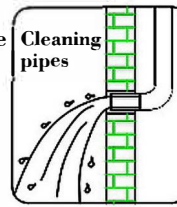

1

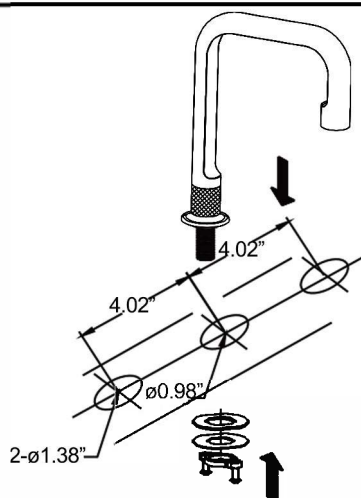

1. Remove the fixing nut and washer under the water outlet, then put the spout into the deck mounted hole, tightening the washer and fixing nut to the spout in turn.

2

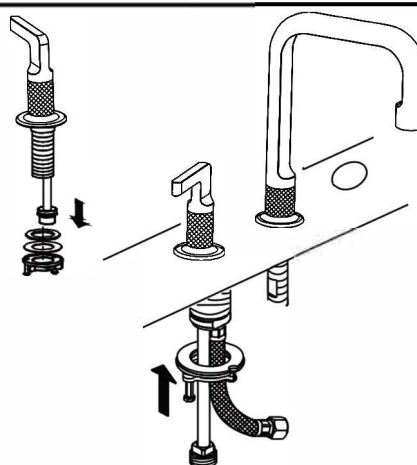

2. Remove the fixing nut and washer under the handle set. (Don't disassemble the handle set), then insert the handle set into the deck mounted hole, tightening the fixing washer and fixing nut in turn.

3

Installation diagram of diverter

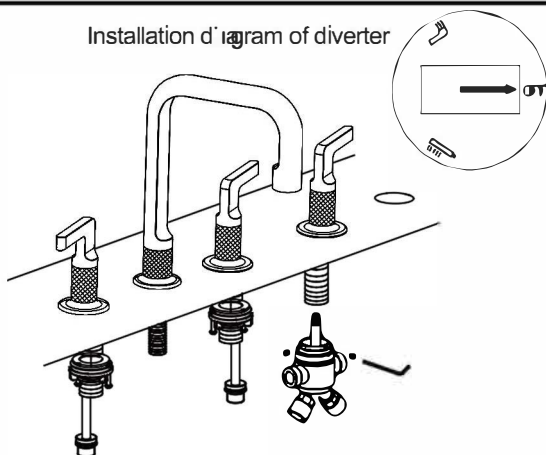

3. Loosen the screws of the diverter, removing the valve. Then install the diverter, tightening the nut. After that, please install the valve according to the mark of the diverter (Make the valve align with the red line), finally tighten the screws.

4

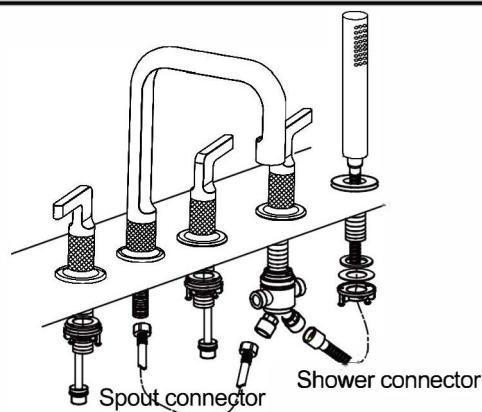

4. After installing the handheld shower bracket, tighten the nut, and then connect the shower hose to the connector on the right side of the diverter, connecting the hose of the spout to the connector on the left side. And the hot water handle is connected to the red side connector of the diverter, the cold water handle is connected to the blue connector of the diverter.

CLEANING CARE

In order to keep the appearance of faucet clean, bright and good performance, please take care of the faucet as follows:

1. Rinse with water only and dry with soft cotton cloth;
2. Use mild liquid and colorless glass cleaner to remove surface dirt and scale film, or use polish without abrasive effect;
3. Do not use abrasive detergent, polish, emery cloth, paper towel or scraper, etc.;
4. Do not use acid cleaner, or cleaner and soap with insoluble gran etc.;
5. In the process of use, mud may accumulate in the bubbler and make the water flow show, The bubbler can be unscrewed, rinsed with water, and then installed back in place.





Tomfaucet

Match Your Ideal Bathroom & Kitchen

www.tomfaucet.com