

Alen BreatheSmart 75i HEPA Air Purifier

USER MANUAL



We would love to hear from you. If you have any questions,
please contact us at **1(800) 630-2396**.

TABLE OF CONTENTS

Air Purifier Safety	4
Using Your Air Purifier	5
Operating Your Unit	
Identification Of Parts	
Know Your Air Purifier	7
Care & Maintenance	7
Replacing The Filter	
Why You Should Replace Your Filter	
Alen's <i>AutoShip</i> Filter Plans	
How To Replace The Filter	
Troubleshooting Tips	10
Lifetime Limited Warranty	10



The 8 hr TWA Ozone for this product is 0.001 ppmv when tested in a 30 m3 chamber. Refer to safety instructions in manual for more information.

AIR PURIFIER SAFETY

Provided in this manual are important safety messages regarding your electrical home appliance. Always read, follow, and save all safety directions.

Location Requirements

- Use a level surface at least 6" (15.2cm) from heat sources such as ranges or heaters.
- Do not block air vent openings or place air purifier on a soft surface such as a bed or sofa.
- Never insert fingers or foreign objects into air grills or vents.
- Operate indoors only.

Electrical and Safety Requirements — Reduce your risk of fire or electrical shock. Failure to follow these instructions can result in death, fire or electrical shock.





- Do not connect unit to any electrical socket that is damaged.
- Ensure filter is correctly installed before turning on unit. Do not run the unit without a filter
- Always turn off the air purifier before unplugging.
- Do not use next to a source of heat, such as a range, heater or dryer.
- Do not use near a bath, shower, swimming pool or where a unit can get wet.
- Do not plug the air purifier into an outlet controlled by a dimmer switch.
- Do not use in a window.
- Unplug air purifier before servicing.
- Do not use an adapter. Do not use an extension cord.
- Always unplug the unit before changing the filter.
- Do not cover the unit or impede air flow.
- Change your filter at the recommended interval, so excess dust and particles do not build up.
- Do not exceed the rating of the power outlet or connection device. May cause electric shock or fire due to excess heat generation.
- Do not insert or pull out plug with wet hands, it may cause electric shock.
- Never try to take apart or repair the unit by yourself.
- Disconnect the power if strange sounds, smell or smoke comes from it.
- Do not try to change the filter during operation.
- Do not drop the unit, as this can result in damage.
- Do not place heavy objects on the power cord and take care so that the cord is not compressed as there is danger of fire or electric shock.
- Do not climb up or sit on the unit. You may be injured if you fall or if the unit falls over.
- Do not spray insecticides or any other flammable sprays near the machine. It may cause explosion or fire.
- Use only in the proper electrical socket type. Socket type (voltage & hertz) can be found on the product sticker on the side or bottom of the unit. Plugging the unit in to the incorrect socket type can damage/destroy the unit.
- **WARNING!** To reduce the risk of electric shock, this equipment has a grounding type plug that has a third (grounding) pin. This plug will only fit into a grounding type power outlet. If the plug does not fit into the outlet, contact qualified personnel to install the proper outlet. Do not alter the plug in any way.

USING YOUR AIR PURIFIER

PLEASE NOTE:

The BreatheSmart 75i has a capacitive touch panel. The buttons only operate with a quick, light touch. Holding the buttons down will not activate the controls properly. A chime will indicate that the control has registered your touch.

Operating Your Unit:

1. Plug your air purifier into a grounded outlet.
2. Touch  Power Button in the center to start the air purifier. When your unit is on, the lights will light up. To turn off the lights on your unit, touch the  Power Button. To turn off the air purifier, touch the  Power Button again after the lights have turned off.
3. The Color Ring around the  Power Button indicates the air quality being measured by the particle sensor.

COLOR	MEANING
Blue	Very low level of airborne particles detected
Green	Low level of airborne particles detected
Orange	Medium level of airborne particles detected
Red	Significant level of airborne particles detected
Purple	Very significant level of airborne particles detected

4. Press IONIZER to activate the ozone-safe ionizer. Activation of the ionizer enhances your unit's ability to remove airborne particles (similar to the way dust is attracted to a TV screen). Press the ionizer button again to turn off.
5. FILTER life Indicator — There are three lights above the FILTER button: Green, Yellow and Red. The Green light will be illuminated for most of the life of the filter. The Yellow light will come on shortly before your filter should be replaced. This is the ideal time to order a new filter. The Red light will be illuminated when it is time to replace the filter.
6. After changing the filter, hold the FILTER button down for five seconds. The Red light will be reset to Green.
7. Press TIMER to have the air purifier run for a set amount of hours (either two, four, or twelve) before turning off.

Identification of Parts – BreatheSmart 75i Control Panel

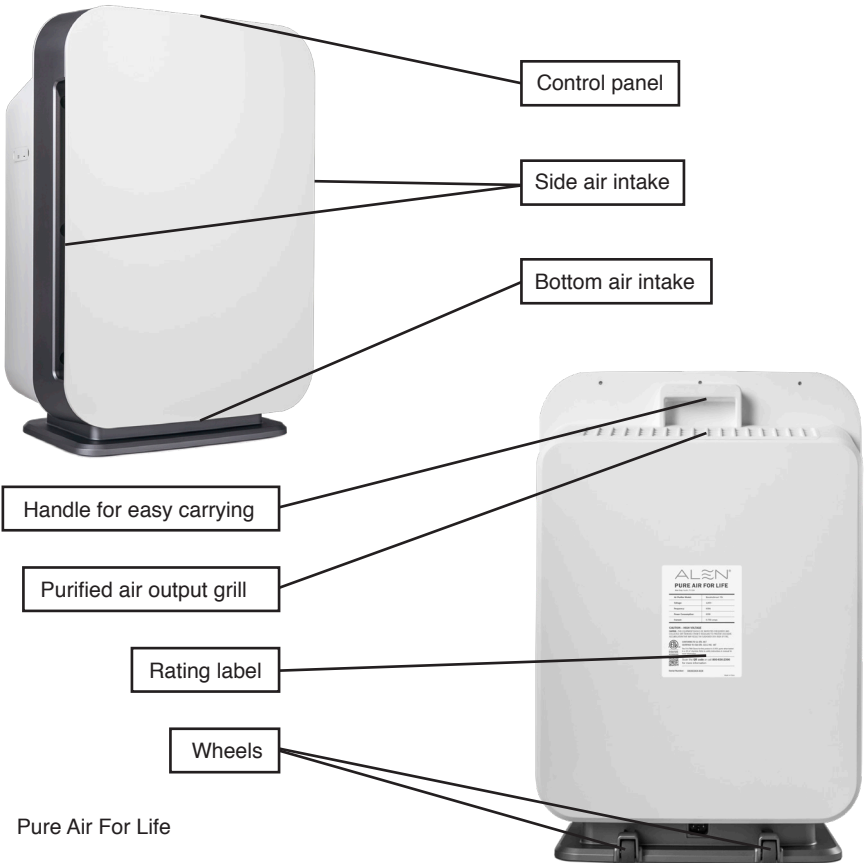
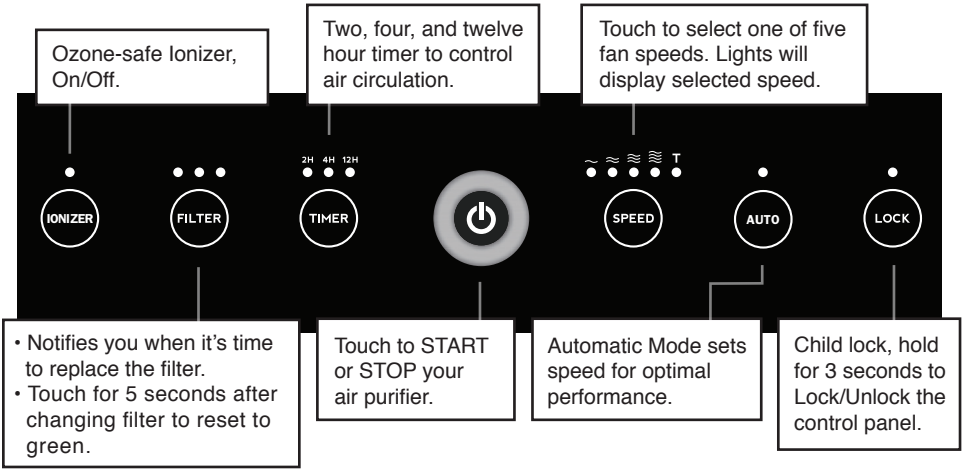

KNOW YOUR AIR PURIFIER



When using the air purifier for the first time in a room, we recommend that you use a higher fan speed like speed four (4) or Turbo (T), for at least two hours in order to clean the room's air initially. Then, we recommend that the air purifier run continuously on speed two (2) or three (3) or be set on Auto mode.

Features

- True HEPA filtration captures dust, allergens, and airborne pollutants
- 5 fan speeds with a two, four, and 12 hour timer to control air circulation
- Filter change indicator light keeps replacements on schedule
- Simple and intuitive touch button controls
- Auto-off safety feature when front cover is removed

CARE & MAINTENANCE

Turn The Lights Off/On

To turn the lights off on your unit, touch the  Power Button. The lights will go out but the unit will not turn off. Touch any button to turn the lights back on, or touch the  Power Button a second time to turn the unit off completely.

Replacing The Filter

The Filter Indicator has 3 lights: Green, Yellow and Red. The Green light will be illuminated for most of the life of the filter. Yellow light will come on shortly before your filter should be replaced. This is the ideal time to order a new filter. You may order a new filter at www.alen.com/filters or by calling 1-800-630-2396. The Red light will be illuminated when it is time to replace the filter.

The filters used in Alen Air Purifiers are not designed to be washed, cleaned or otherwise reused. Over time, the filters become overloaded with particles, decreasing their filtration performance. We recommend regular filter replacements to extend the life of your air purifier and maximize performance.

The black screen layer of the filter, known as the Pre-Filter, captures large dust and hair. This layer can be vacuumed periodically to maintain efficient operation of the unit.

Reset the Filter Indicator

After replacing the filter, hold the FILTER button down for 5 seconds. The Red light will be reset to Green.

Cleaning Instruction: Control Panel

To avoid scratching the control panel, do not use abrasive/caustic cleaning solutions or scrubbing pads. With the unit unplugged, dampen a clean towel with soap and water to clean the control panel, then dry gently with a soft cloth or paper towel. Glass cleaner (e.g. Windex) is also OK. To avoid damaging electronic components DO NOT allow liquid to seep into the unit.

Why You Should Replace Your Filter

- Fulfills the terms of Alen's Lifetime Limited Warranty which states that the filters are required to be changed on a regular basis in order to prevent excessive stress on the unit.
- You have bought an Alen Air Purifier to improve the quality of your indoor air. Changing your filters will maintain the level of air quality you require. Excessively dirty filters can compromise the level of clean air your air purifier can provide.

Alen's *AutoShip* Filter Plan — Convenience, Pure Air and Savings

Regular replacement of your filter will extend the life of your air purifier and keep your air pure. Alen filters provide efficient filtration for 12 months of heavy usage, and 15 months of moderate usage. With Alen's convenient *AutoShip* Filter Plan your filters will be shipped FREE right to your door, exactly when needed.

Save — Get FREE SHIPPING on every filter.

Convenience — Your filters are delivered right to your door exactly when needed. Choose your desired monthly frequency and cancel at anytime.

Lifetime Limited Warranty — An Alen *AutoShip* plan is the convenient way to extend the life of your air purifier and benefit from the Lifetime Limited Warranty.

To sign up and save just visit alen.com/filters or call 1-800-630-2396.

How To Replace The Filter

1. Always unplug the unit when installing a filter.
2. Distinguish the front side from the back side of the filter. The front side has a screen pre-filter and pull loop at the top.
3. Place the used filter in a plastic bag to prevent dust from re-entering the air.



1. With the unit standing upright, pull firmly on the cover near the intake vents with one or both hands to release the magnets.

2. After pulling the cover out, lift it away from the unit.



3. Remove used filter by pulling out and down on the pull loop. Place the used filter in a plastic bag to prevent dust from re-entering the air.

4. Take new filter out of the plastic bag, insert the bottom. Firmly push top of filter frame in until it clicks into place.

5. Insert the bottom hooks on the front cover first and then the upper part of the cover will snap into place.



WARNING! RISK OF ELECTRIC SHOCK - To reduce risk of electric shock, do not perform any servicing other than that contained in the operating instructions.

TROUBLESHOOTING TIPS

Unit will not power on.

Check that filter is pushed in all the way and evenly seated in the unit. Firmly push top of filter frame up and in until it clicks. Last, check that front panel is on properly (fit snugly to the purifier).

How do I reset the filter indicator lights? I put in a new filter but the red or yellow lights are still illuminated.

After changing the filter, RESET the filter indicator by holding down the FILTER button for 5 seconds while the unit is ON. The light above the FILTER button should reset to green.

How do I find out what electric specifications my unit needs?

Please refer to the rating label on the back of the unit. Here you will find your unit's voltage, hertz, amps and outlet requirements.

Can I clean the filter?

The black screen layer of the filter, known as the Pre-Filter, captures large dust and hair. This layer can be vacuumed to maintain efficient operation of the unit. No other layers or parts of the filter can be washed, cleaned, or otherwise reused. Please replace the filter regularly to maintain optimal performance.

I have an issue not listed in this manual.

Please visit www.alen.com and send us a message or call 1-800-630-2396 during business hours. A customer service representative will respond to your inquiry in a timely manner.

What information do I need when I contact customer service for warranty?

Please refer to the rating label on the back of the unit. This rating label has your unit's lot code and other important information we need to assist you.

LIFETIME LIMITED WARRANTY

What is covered?

Alen offers the industry's first LIFETIME LIMITED WARRANTY program for all our air purifiers. We warrant your Alen Air Purifier to be free from defects in materials or workmanship for as long as you own it. Register your Alen Air Purifier at www.alencorp.com/register.

What will Alen do?

Alen will, at its option, either furnish a replacement part or replace your air purifier provided the product is determined by Alen to be defective as a result of faulty material or workmanship while in normal use. Replacement parts or units will, at Alen's option, be either new or refurbished. Alen's sole obligation under this warranty is to replace defective parts or replace your air purifier free of charge. All parts or units that are replaced become the property of Alen.

How to get service?

This warranty will be valid only for units in possession of the original purchaser. Proof of purchase must be presented to Alen's warranty service representative. To help us validate your warranty, we encourage you to register your Alen Air Purifier at www.alen.com/register.

To obtain warranty service, complete our online form or call 1-800-630-2396. The defective product or part must be shipped or delivered to Alen's authorized service center. All postage, insurance, and shipping charges are the responsibility of Alen and included in this warranty.

Your Lifetime Limited Warranty program remains in effect only if:

Your Alen Air Purifier is operated in accordance with the instructions provided in the Alen user manual. This includes replacing the filter at least once a year to prevent excessive stress on the motor.

Your Alen Air Purifier is connected to a proper power supply (see voltage label on unit).

Your Alen Air Purifier shows no evidence of tampering, mishandling, neglect, accidental damage, modification, and/or repair by anyone other than authorized Alen service personnel.

Ownership of the air purifier has never been transferred.

DISCLAIMERS/LIMITATIONS

ALEN'S LIFETIME LIMITED WARRANTY IS VALID ONLY FOR THE ORIGINAL PURCHASER AND IS IN LIEU OF ALL OTHER WARRANTIES, EXPRESSED OR IMPLIED, INCLUDING WARRANTIES OF MERCHANTABILITY AND FITNESS FOR A PARTICULAR USE OR PURPOSE. ALEN'S SOLE LIABILITY WITH RESPECT TO DEFECTS IN MATERIALS AND WORKMANSHIP IN THE AIR PURIFIER SHALL BE, AT ALEN'S OPTION, TO FURNISH REPLACEMENT(S) OF THE DEFECTIVE PART(S) OR REPLACE THE AIR PURIFIER ON THE BASIS DESCRIBED ABOVE. ALEN WILL NOT INSTALL ANY REPLACEMENT PARTS IT PROVIDES OR PROVIDE LABOR WITH RESPECT TO THE SAME. EXCEPT AS STATED IN THE IMMEDIATELY PRECEDING SENTENCE, ALEN SHALL HAVE NO LIABILITY, WHETHER UNDER A CAUSE OF ACTION IN TORT, STRICT LIABILITY, CONTRACT, OR OTHERWISE, TO ANY PERSON FOR ANY CLAIM, INJURY, LOSS, DAMAGE OR EXPENSE (INCLUDING ANY DIRECT, INDIRECT, SPECIAL, CONSEQUENTIAL, INCIDENTAL, PUNITIVE OR EXEMPLARY DAMAGES) IN ANY WAY ARISING OUT OF OR RELATING TO THE AIR PURIFIER OR ITS USE BY ANY PERSON.

SOME STATES DO NOT ALLOW LIMITATIONS ON AN IMPLIED WARRANTY OR HOW LONG AN IMPLIED WARRANTY LASTS, SO ANY SUCH LIMITATION IN ALEN'S LIFETIME WARRANTY MAY NOT APPLY TO YOU. SOME STATES DO NOT ALLOW THE EXCLUSION OR LIMITATION OF INCIDENTAL OR CONSEQUENTIAL OR OTHER DAMAGES SO ANY SUCH EXCLUSIONS OR LIMITATIONS IN ALEN'S LIFETIME WARRANTY MAY NOT APPLY TO YOU. ALEN'S LIFETIME LIMITED WARRANTY GIVES YOU SPECIFIC LEGAL RIGHTS. YOU MAY ALSO HAVE OTHER RIGHTS WHICH VARY FROM STATE TO STATE.



Copyright © 2018 Alen Corp. All Rights Reserved.
BreatheSmart-75i-pm-June-1-2018