

CHAMBORD GRAND PENDANT

LXP10316

General Product Information

 Intertek	 SAVE THESE INSTRUCTIONS!	 INDOOR	 DAMP LOCATION SAFE
 NEC COMPLIANT JUNCTION BOX	 CONVERTS TO LED	 PLEASE SEE visualcomfort.com FOR PRODUCT SPECS	 CLEAN WITH SOFT, DRY CLOTH ONLY. NO HARSH CHEMICALS!

WARRANTY

FCC STATEMENT

Tools Required

 PHILLIPS-HEAD SCREWDRIVER	 WIRE CUTTER
--	--

Safety Information

CAUTION-RISK OF FIRE

This product must be installed in accordance with the applicable installation code by a person familiar with the construction and operation of the product and the hazards involved.

USE MINIMUM 90°C SUPPLY CONDUCTORS.



Turn off electrical current at the source before working with any lighting fixture or portable lamp.

Install and use this product in adherence with local electrical codes and regulations.



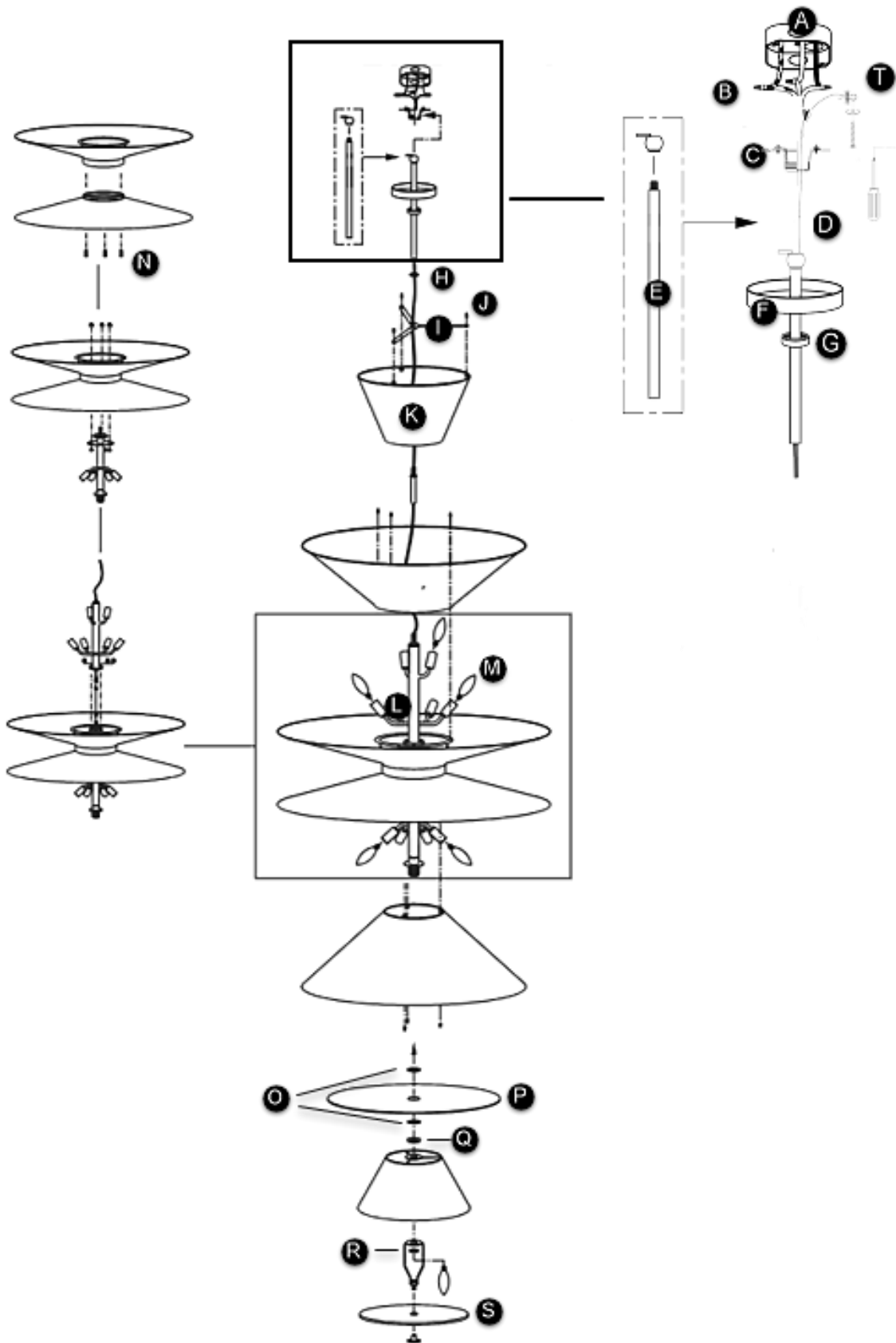

FIXTURE PARTS

- A. Junction Box
- B. Wires and Nuts
- C. Mounting Plate
- D. Half Ball
- E. Top Stem
- F. Canopy
- G. Collar Nut
- H. Hex Nut
- I. Shade Spider
- J. Shade Screws
- K. Paper Shades
- L. Upper Socket Cluster
- M. Bulbs (Not Included)
- N. Knurled screws
- O. Silicone Washers
- P. Large Glass Diffuser
- Q. Large Round Nut
- R. Small Round Nut
- S. Small Glass Diffuser
- T. Safety Cable

INSTRUCTIONS

Preparing for Installation

1. Attach and secure two metal shades together using provided knurled screws (N).
2. Assemble the lower socket cluster onto the metal shades using the supplied screws and hex nuts.
3. Align the male connector from the lower socket cluster with the female connector from the upper socket cluster, then plug them together.
4. Carefully tuck all the wires and wire connectors into the fixture, then slide the upper socket cluster over the metal shades and secure them in place using the provided screws.
5. Feed fixture wires and safety cable through a large paper shade, then place the shade through the upper socket cluster so that it sits on the metal shade. Secure them together using provided screws.
6. Feed the fixture wires and safety cable through the upper pipe, then screw it onto the upper socket cluster.
7. Secure the shade spider onto the top paper shade using the provided shade screws, then feed the fixture wires and safety cable through the shade and the provided nut.
8. Seat the shade spider on the upper pipe, then secure the shade in place using the provided nut.
9. Screw the half ball to the top stem.
10. Determine the wanted height of look of the fixture with the stems, then assemble them by screwing them together.
11. Feed the fixture wires and safety cable through the stem assembly, then screw the stem assembly onto the threaded nipple on the top of the fixture assembly.
12. Feed the fixture wires and safety cable through the collar nut, canopy, and the half ball assembly then screw it onto the stem assembly.
13. Align and secure the mounting plate to the junction box, then slide the half ball assembly onto the mounting plate.
14. Trim the cord leaving enough to make electrical connection.
15. Loop and secure the safety cable over a stable structure that agrees with the local building code.

II. Wiring the Fixture

1. Safety first! Locate the circuit breaker and switch it off to cut off the power supply to the relevant circuits to ensure there's no electricity running through the wiring.
2. In accordance with local electrical codes, connect the fixture ground wire (bare copper or silver wire) to suitable ground. This may be a green ground screw on the mounting plate or a house wire (green or bare copper wire without insulation).
3. Twist the bare ends of the following pairs of wires together using a wire nut to secure a connection:
 - a) Hot fixture wire (round & smooth) and hot power line wire from the junction box (hot to hot)
 - b) Neutral fixture wire (neutral power line [square & rigid] wire from the junction box (neutral to neutral)
4. Carefully tuck all the wires into the junction box.

III. Installing the Fixture

1. Install the canopy to the junction box and secure with the collar nut.
2. Place the second-to-last paper shade through the lower socket cluster against the metal shade, then align and secure it in place using the provided shade screws.
3. Screw the bulbs into the sockets. Refer to the label on the bulb socket for Max Wattage information.
4. Place the silicon washer, large glass diffuser and the other silicon washer over the threaded nipple on the bottom of the lower socket cluster, then secure the glass in place with the large round nut. **Note: The silk screen side of the glass is facing up, and the clear side is facing down.**
5. Place the last paper shade and shade bracket over the threaded nipple on the bottom of the lower socket cluster, then lock them together using the small round nut.
6. Screw the bulb into the socket.
7. Slide the small glass diffuser over the threaded nipple of the shade bracket, then secure it in place with the end cap.