

## ASSEMBLY INSTRUCTIONS

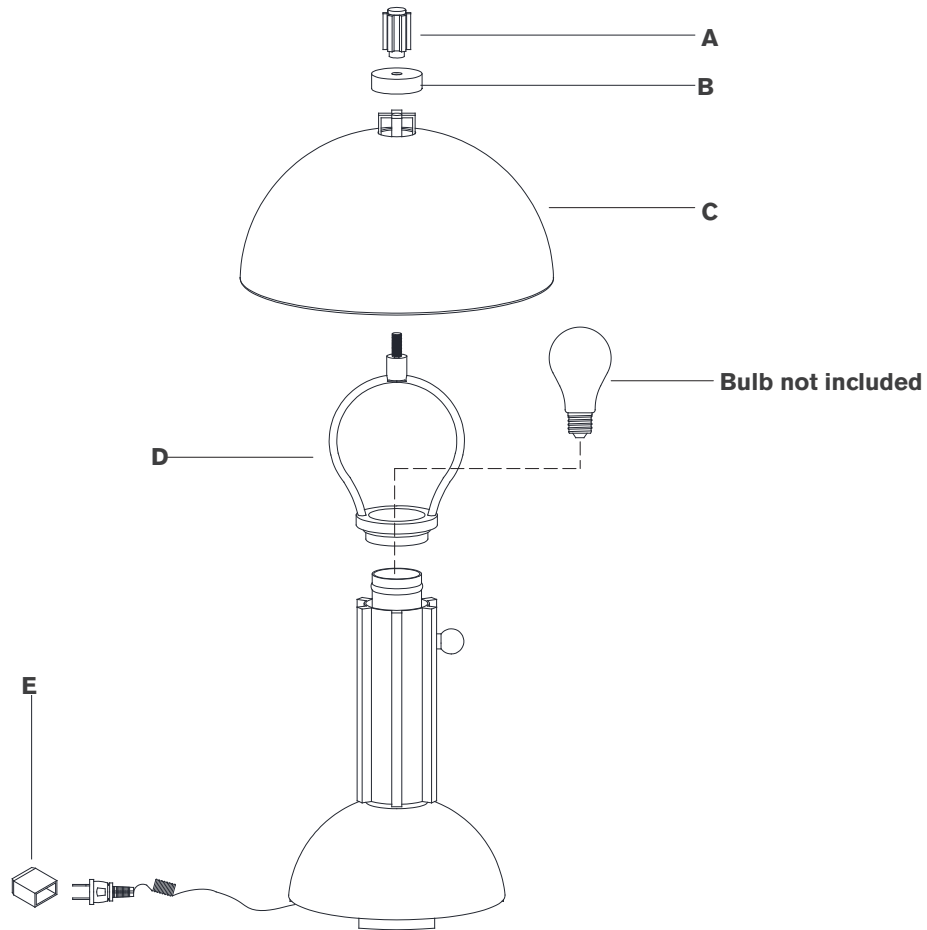

## Dally 13" Desk Lamp

Item # TOB 3146

### NOTICE:

This light fixture should be installed in accordance with all applicable, local installation codes, and by a person familiar with the construction and operation of it, as well as the hazards involved. Inspect item and contents carefully. If any damage or defect is found, do not install. Retain all packaging material until installation is complete and approved.

1. Carefully remove all parts from the box. Place on a clean, soft surface.
2. Thread harp (D) to fixture body.
3. Remove finial (A) and cap (B) from harp (D).
4. Install light bulb into the socket.
5. Install metal shade (C) to harp (D) and secure with cap (B) and finial (A).
6. Remove protective cover (E) from plug.
7. Plug into electrical outlet and test fixture.

**Care Instructions:** Clean only with a soft dry cloth or feather duster. Do not use abrasive or chemical agents.