

Instructions

Flowerpot VP10 Verner Panton 1968



Please read these instructions carefully and retain them for future reference to ensure the product is used correctly. For your own safety, please study each step of this instruction manual first. &Tradition is not responsible for any faults or damage caused by not following these instructions correctly. Do not modify this product in any way. If you have any questions or comments, please do not hesitate to contact us by mail on: info@andtradition.com

&Tradition[®]

Flowerpot VP10

Verner Panton

1968

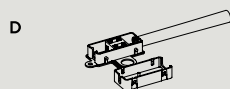
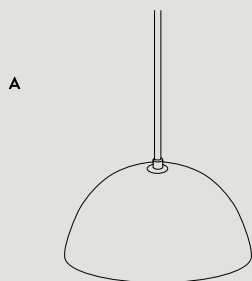

Safety precautions

- Dispose of plastic bag from packaging and do not allow children to play with it.
- Keep product well out of children's reach.
- The lamp is only intended for interior use.
- Consult a professionally qualified electrician if in any doubt.
- If the external cable or cord of this lamp is damaged, it must be replaced by the manufacture or a similar qualified person in order to avoid a hazard.

Contents

- A Shade
- B Bottom shade
- C Canopy
- D Connection box

Tools needed

- G9 light bulb
- Small flat-head screwdriver for wiring

Cleaning instructions

- Wipe surface of lamp shade with a soft, damp sponge or cloth.
- Do not use any abrasive cleaning tools such as steel wool, scouring sponges or stiff brushes.
- Never use strong cleaning agents such as white spirit, turpentine, household glass cleaner or cellulose thinners.
- Only wipe the inside of the shade with a soft, damp cloth or feather duster.

06/23

For indoor use only
G9 maximum 5W LED
Bulb not included



For standard installation please follow step 1-7

Step 1 / 7

Ensure power supply is turned off and remove any existing lamp fitting. Locate the supply cable and ensure it is ready to be fitted to the connector block. Mount the metal bracket (C) securely in the ceiling with screws and wall plugs, appropriate for the ceiling of installation.

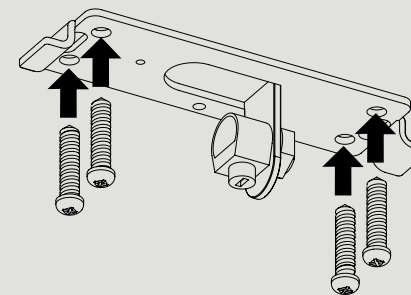

Step 2 / 7

Drill a hole into the side of the canopy and pull electric cord through it.

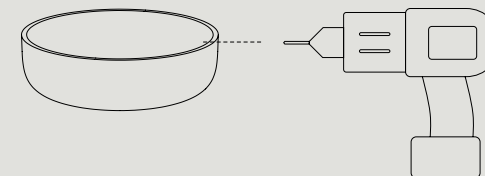

&Tradition®

Hard-wired version

Step 3 / 7

To determine the right suspension height for the lamp, pass the electrical cord through the strain relief of the metal bracket (C). When you have the desired suspension height of the lamp, tighten the plastic screw of the strain relief.

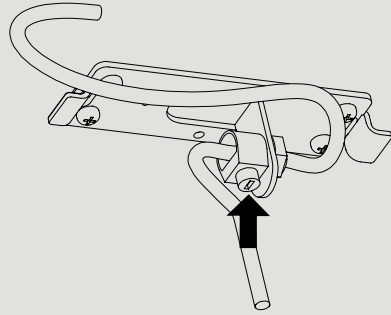

Step 4 / 7

Use the terminal box inside the connection box (D) to assemble the wires from the pendant with the wires from the power supply. Close the connection box and place it inside the canopy.

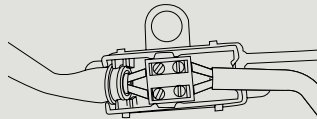

Step 5 / 7

Install the plastic canopy onto the metal bracket.

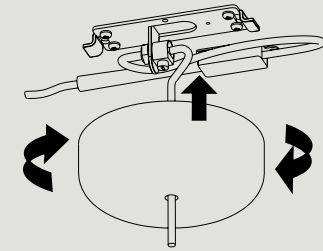

Step 6 / 7

Install the light bulb.

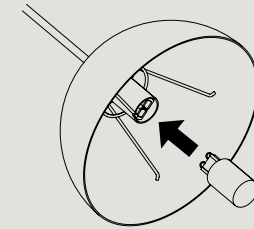

Step 7 / 7

Mount the bottom shade (B) onto the three pronged arm inside the shade (A) as shown. Switch on the power supply at the fusebox and enjoy your new lamp.

