

## ASSEMBLY INSTRUCTIONS FOR YOUR LEDGER TABLE LAMP

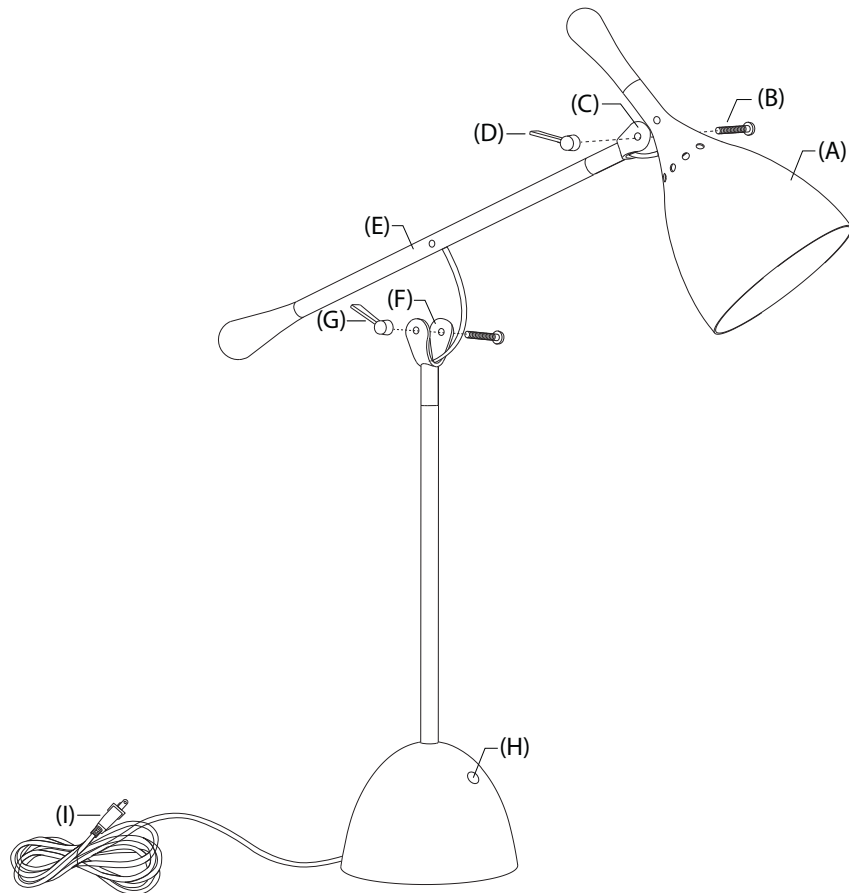

### IMPORTANT SAFETY INSTRUCTIONS:

- \* This lamp has a polarized plug (one blade is wider than the other) as a feature to reduce the risk of electric shock. This plug will fit in a polarized outlet only one way. If it does not fit fully in the outlet, reverse the plug. If it still does not fit, contact a qualified electrician. Do NOT alter the plug.
- \* Do not use with an extension cord unless the plug from the lamp can be fully inserted into the extension cord receptacle.
- \* Switch power off and remove plug from the wall outlet before replacing the bulb.
- \* This lamp is UL rated for dry locations.

### ASSEMBLY INSTRUCTIONS

NOTE: Do not connect electricity until lamp is fully assembled.

1. Unpack all parts and remove packing materials. Place lamp base on a level surface.
2. Place shade (A) into bracket (C), and align holes. Slide bolt (B) through holes and secure shade in place by threading knob (D) onto bolt until hand tight.
3. Place arm (E) into bracket (F) and align holes. Slide remaining bolt (B) through holes and secure arm by threading remaining knob (G) onto bolt until hand tight.
4. To adjust position of arm (E) loosen knob (G). Move arm (E) into desired position. Turn knob (G) until hand tight to secure arm position.
5. To adjust position of shade (A) loosen knob (D). Move shade (A) into desired position. Turn knob (D) until hand tight to secure shade position.
6. Insert one 60W MAX. Type B, medium base bulb into the socket located inside of shade (A).
7. Insert polarized plug (I) into wall outlet.
8. Control power to the fixture by operating switch (H).

\*To clean, use a soft dry cloth. Do not use any chemical or abrasive cleaners.\*