

INSTALLATION INSTRUCTIONS

For Item#2444-66A (New.2022/07/01)

READ AND SAVE THESE INSTRUCTIONS

WARNING! SHUT POWER OFF AT FUSE OR CIRCUIT BREAKER.

AVERTISSEMENT! COUPER LE COURANT AU NIVEAU DES FUSIBLES OU DU DISJONCTEUR.

HANGING THE FIXTURE (Fig. 1)

1. Shut off power at the fuse box or circuit breaker box and remove the old fixture including the mounting hardware.
2. Carefully unpack your new fixture and lay out all the parts in a clear area. Take care not to misplace any small parts necessary for installation.
3. Place larger cloth shade (Q) over ceiling pan (D) and secure with screws (R).
4. Thread two screws (B) about 1/4" into the pre-drilled holes in crossbar (A) spaced the same distance apart as the holes in the ceiling pan (D). The length of screws (B) may be adjusted if necessary.
5. Attach crossbar (A) to the junction box (not included) using mounting screws (C) (Size: #8-32N*L0.5"). The side of the crossbar (A) marked "GND" must face out.

CONNECTING THE WIRES (Fig. 2)

6. Connect the electrical wires as shown in Fig. 2, making sure that all wire connectors are secured. If your junction box has a ground wire (green or bare copper), connect the fixture's ground wire to it. Otherwise, connect the fixture's ground wire directly to the crossbar (A) using the green screw provided.
7. Tuck wire connectors neatly inside the junction box.

COMPLETING THE INSTALLATION (Fig. 1)

8. Slide ceiling pan (D) over both screws (B) so that they protrude through the "keyholes" on the bottom of the pan. Rotate the pan until the screws are in the slots of the "keyholes" and tighten with a screwdriver.
9. Thread all thread (K) to socket holder bracket (F) and tighten with hex nut (J). Adjust hex nut position if necessary.
10. Install (3) three medium base bulbs (E) up to 60 watts each or CFL or LED equivalent (not included) in accordance with the fixture specification—**DO NOT EXCEED THE MAXIMUM WATTAGE RATING! (NE PAS DEPASSER LA PUISSANCE NOMINALE MAXIMALE!)**.
11. Place larger metal ring (G), smaller cloth shade (H), smaller metal ring (I), washer (L), plastic washer (M), glass shield (N), metal washer (P) over all thread (K) and secure with finial (O).

Your installation is now complete. Return power to the junction box and test the fixture.

Note: Illustration (Fig.1) on this manual is for installation purposes only. It may or may not be identical to the fixture purchased.

Fig. 1

Set# A-010
- Crossbar
- Ground screw
- Mounting Screw*2

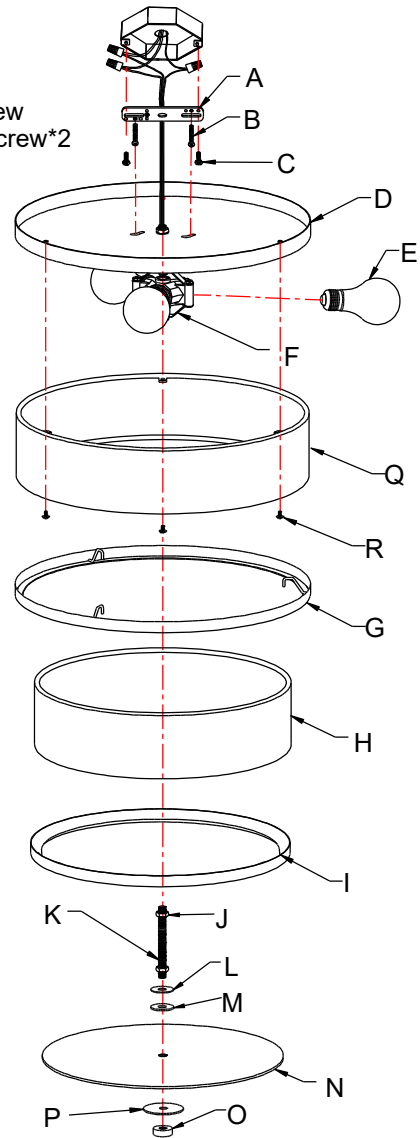
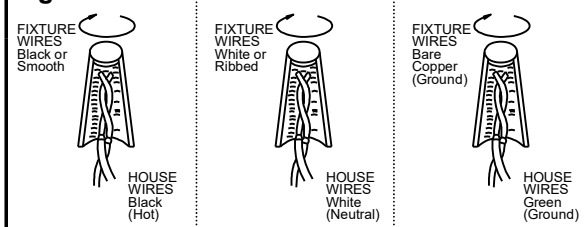

Fig. 2



MIN 90°C SUPPLY CONDUCTORS

LA-3581E