

# INSTALLATION INSTRUCTIONS

Item#824-249/281/613-L (New. 08/21/2018)

## READ AND SAVE THESE INSTRUCTIONS

**WARNING! SHUT POWER OFF AT FUSE OR CIRCUIT BREAKER.**

**AVERTISSEMENT! COUPER LE COURANT AU NIVEAU DES FUSIBLES OU DU DISJONCTEUR.**

### HANGING THE FIXTURE (Fig. 1)

1. Carefully remove the fixture from the carton and check that all parts are included as shown in the illustration.
2. Shut off power at the circuit breaker and remove the old fixture including the mounting hardware.
3. Thread screws (A) into the pre-drilled holes in the circular strap (C) spaced the same distance apart as the holes in the ceiling pan (I) and secure with hex nut (G).
4. Attach the circular strap (C) to the junction box using the mounting screws (F) (size: #8-32N\*L0.5"). The side of circular strap (C) marked "GND" must face out.
5. Loose screw (H) from the rod (O), then remove the ceiling pan (I). Put glass panel (N) on the metal frame (P) and ceiling pan (I), secure by using a glass clips. Through screw (H) into ceiling pan (I) and secure on the rod (O).

### CONNECTING THE WIRES (Fig. 2)

6. While holding the ceiling pan towards the ceiling, connect the electrical wires as shown in (Fig.2), making sure that all wire connectors are secured. If your outlet has a ground wire (green or bare copper), connect the fixture's ground wire to it. Otherwise, connect the fixture's ground wire directly to the mounting plate (C) using the green screw provided. After wires are connected, tuck them carefully into the ceiling outlet box.

### COMPLETING THE INSTALLATION (Fig. 1)

7. Place the ceiling pan (I) onto the mounting screws (A) and secure with the cap nuts (M).
8. Thread the nipple (L) to coupling (J) and tighten with hex nut (K).
9. Secure cup(Q) into the nipple (L). Then through glass shield (R) into the nipple (L) and secure glass shield (R) into the cup by using screws (S) (not over tighten).
10. Place plastic gasket (T) over the nipple (L) and tighten with finial (U).

**CAUTION/ATTENTION:** When handling the fixture, do not apply pressure to the LEDs. Hold the fixture by the base or ceiling pan (I) only.

### Replacing LED module (Fig.3)

The LED module can be replaced by a qualified electrician without cutting the wires and without damaging the decorative element to which the fixture is attached. See installation steps for more details (Fig.3)

**Warning: Turn off power at the fuse box or circuit breaker before replacing the LED module.**

- a. Loosen finial (U) and remove the plastic washer (T).
- b. Loosen screws (S) and remove the glass shield (R).
- c. To remove the fixture from the ceiling: loosen the cap nuts (M) and remove the wire connectors. Then place the fixture on a clear flat surface (Fig.3).
- d. Remove the cup (Q), then loosen screws (X) and carefully remove the LED module (W) from the ceiling pan (I).
- e. Use a pin to press from the hole of the quick connector and disconnect the black/white wire respectively.
- f. Reverse steps a-e for installing the new LED module.

**Note: The LED module should be provided by a specified supplier.**

**IMPORTANT:** Fixture should be installed by a qualified electrician to ensure proper wiring and installation.

**Dimmable with ELV and/or LED compatible wall dimmer switches.**

Fig. 1

Set#A-022  
-Circular Strap  
-Ground Screw  
-Mounting Screw\*2

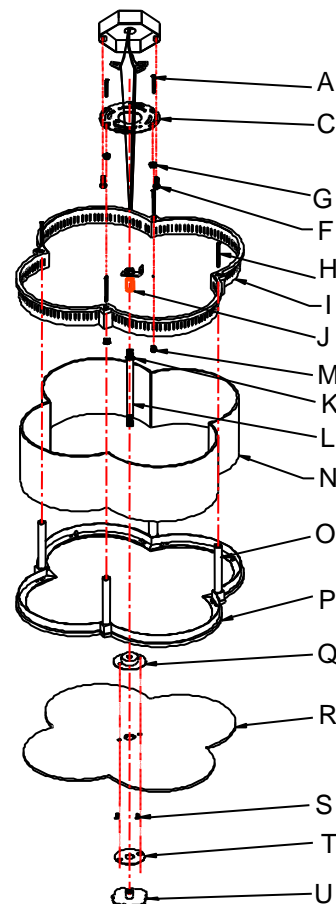

Fig.2

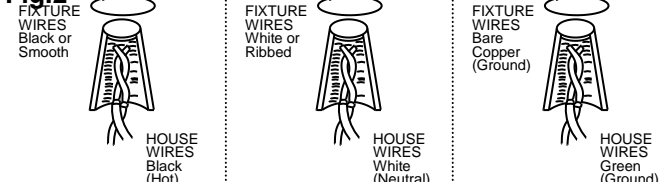

Fig.3

