

ARPS152

### Energy-Saving On/Off Outlet

adorne<sup>®</sup> Energy-Saving On/Off Outlets include a tamper-resistant design featuring a patented shutter system, keeping children safe by preventing them from pushing small objects into the outlet. On/off switch allows you to save energy and stop the flow of power without unplugging your device. Perfect for kitchens, bathrooms, and computer rooms.



### FEATURES & BENEFITS

adorne devices fit in all existing NEMA-approved wallboxes.

Heavy gauge steel frame is grounded via factory installed 12AWG ground lead. Device and metal wall plates are self-grounded to frame.

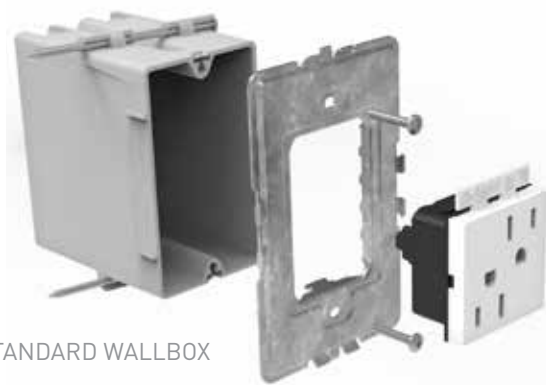

STANDARD WALLBOX

FRAME

DEVICE

adorne devices can be installed in any existing standard wallbox.

Backwire terminal screws are recessed into back of body.

Device snaps into the frame and self-aligns without any screws.

Wall plate snaps onto frame; no screws required.

Modular system solves device alignment problems, improving fit and finish in multi-gang installations.

Wall plate and frames available in 1-6 gang sizes.



WALL PLATE

## ORDERING INFORMATION

CATALOG NUMBER	DESCRIPTION	RATING	NEMA	COMPLIANCE	COLORS	COO
ARPS152M4	Power S-Manual On/Off Outlet-2 Mod	15A, 125V	5-15R		Magnesium	China
ARPS152W4	Power S-Manual On/Off Outlet-2 Mod	15A, 125V	5-15R		White	China
ARPS152G4	Power S-Manual On/Off Outlet-2 Mod	15A, 125V	5-15R		Graphite	China

## VERTICAL MARKETS

- Residential
- Hospitality
- Luxury Office
- Light Commercial

## COMPLEMENTARY PRODUCTS

adore® also offers Paddle Style Dimmers and Fan Control Devices to pair with our Paddle Style Switches for an overall, aesthetically pleasing and multi-functional installation.

**adore® Wall Plates** provide the perfect complement to adore Switches, Dimmers, Outlets, and Accessories. The collection includes a variety of finishes, from metals to leather and wood, as well as plastic plates that are available in contemporary and classic colors.

Each wall plate is packaged with a metal frame to enable easy installation when paired with a device. All plates are screwless and simply snap onto the included metal frame.

All adore wall plates are UL and ETL-approved.



2-Module Paddle Dimmer



2-Module Paddle Fan Speed Control



1-Module Paddle Switch

TECHNICAL SPECIFICATIONS

3rd Party Compliance

cULus Listed, File Number E140597, Standard UL20

Performance

ELECTRICAL

Maximum Working Voltage	120VAC
Current Rated	15A, 20A Feed Through
Temperature Rise	30°C Maximum at full-rated current

MECHANICAL

Back Wire	With internal pressure plates, #8-32 screw
Terminal Accommodations	#14AWG-#12AWG

ENVIRONMENTAL

Flammability	UL94 V2
--------------	---------

Materials

Face	Polycarbonate	Terminal	Brass
Back Body	Polycarbonate	Termination	Steel Plated Scews
Contacts	Silver		

Warranty

Limited Lifetime Warranty

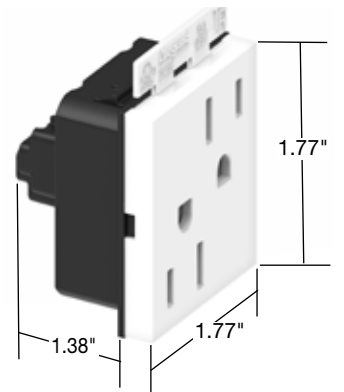
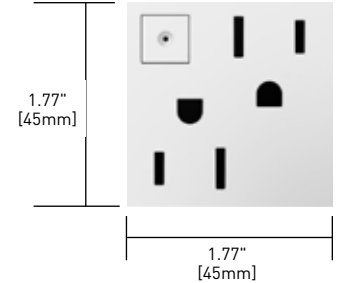

## COMPLEMENTARY DEVICES & ACCESSORIES

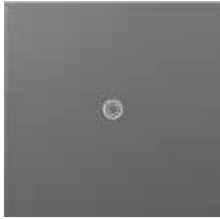

### sofTap™

Switches & Dimmers – designed with an innovative micro-movement that turns lights on and off with just a soft “tap” of the finger.



### SensaSwitch™

Switches & Dimmers – Sensor turns lights on when you enter a room and off when you leave. (Also available in Manual-ON/Auto-OFF format.)



### Whisper™

Switches & Dimmers – A smart design that features elegant lines and a quiet, fluid motion.



### Touch™

Switches & Dimmers – A stunning translucent face works just like an iPhone® – simply touch your finger on the circle to turn lights on and off.



### Paddle™

Switches, Dimmers & Fan Speed Controls – A wide, graceful curve works with a simple up-and-down motion, allowing you to turn lights on and off with ease.



### Wave™

Switches – Smart technology combined with sleek, modern design. Simply wave your hand to turn lights on and off.

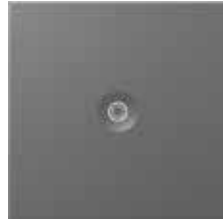

### Push™

Switches – A tactile, finger-sized impression lets you turn lights on and off with a simple push-button motion.

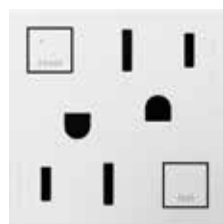

### Tamper-Resistant Outlets/ Tamper-Resistant GFCI Outlets



### USB Charging Outlets



### Nightlight/Portable Nightlight Flashlight

PLUS: Compatible Wall Plates, Accent Lights, Locator Lights, Under-Cabinet Lighting System

**NOTE: All brand and product names referenced in this document are registered trademarks or trademarks of their respective holders.**



**NOTE:** The paper used to print this document is an environmentally responsible paper with 10% post consumer waste, with FSC and SFI Chain of Custody certifications, Lacey Act compliant. 100% of the electricity used to manufacture Flo sheets is generated with Green-e certified renewable energy.



**Legrand, North America**  
60 Woodlawn Street  
West Hartford, CT 06110  
1.877.BY.LEGRAND (295.3472)  
www.legrand.us

**Canada**  
905.738.9195  
www.legrand.ca

FOLLOW US



2

1

REV	EC.NO.	DATE	DESCRIPTION	DFTR	CK.
A			INITIAL RELEASE		

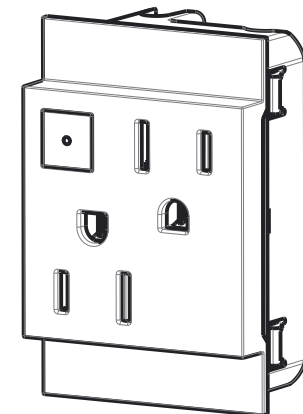
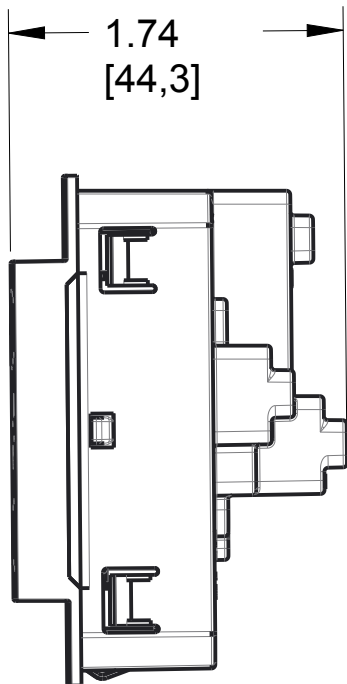
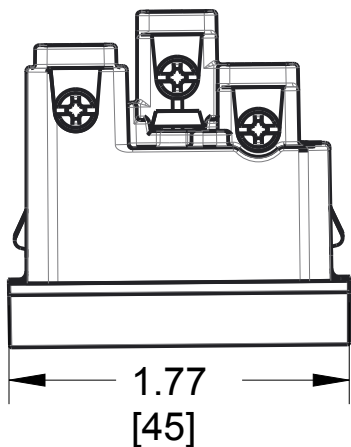

SCALE 0.750

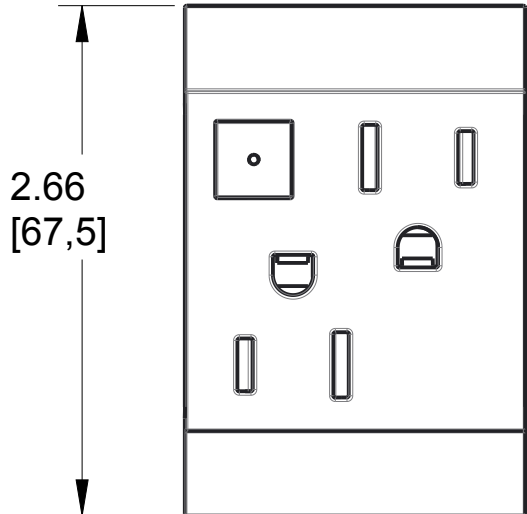

**A** Size Face: 2x2 Module  
 Size Backbody: 3x2 Module  
 3rd Party Compliance: cULus LISTED  
 Ratings: 15A, 125 VAC, All Loads  
 Termination: Back Wire Only  
 Misc: Copper Wire Only  
 For Use With adorne System Only  
 ON/OFF Button Saves Energy When  
 Not In Use By Stopping Flow Of Power

## ARPS152, Energy-Saving ON/OFF Outlet

MATERIAL	SEE NOTE	UNSPECIFIED TOL. FRAC. ± 1/64 ANGLES ± 1.0 DEC. 0 ± 0.02 .00 ± 0.01 .000 ± 0.001	<b>Pass &amp; Seymour</b> <b>legrand</b>		
FINISH	SEE NOTE				
DSGN BY:	6/12/2015		MODEL NAME:	ARPS152	
DR BY:		SHT 1of1	PROJ.	DWG NO.:	REV.:
CK BY:		SCALE:	1.000	CD1189	A

NOTICE: Proprietary and confidential information of Pass & Seymour/Legrand  
 Reproduction or disclosure prohibited under penalty of law.

2

1