

LED Table Lamp

TL28518
INSTALLATION SHEET

START FROM HERE

- Prepare everything in a clear area.
- Wear gloves at all times during this installation.
- Read instructions carefully before you start assembly.
- Keep this instruction sheet for future reference.

Technical Support: 1-855-855-8926

Please Note:

- This Kuzco LED fixture comes with pre-wired LED module(s)
- Unless instructed, Do Not touch any part of the LED module(s) as any unnecessary contact with the module could cause permanent damage
- Touch Dimmer
- 120V input

CAUTION: TO PREVENT ELECTRIC SHOCK, MATCH WIDE BLADE OF PLUG TO WIDE SLOT/ POUR EVITER LES CHOCS ELECTRIQUES, INTRODUIRE LA LAME LA PLUS LARGE DE LA FICHE DANS LA FENTE LA PLUS LARGE

- 1.** Remove the fixture from it's original packaging
- 2.** Attach glass (**4b**) to fixture (**4a**) with decorative bar (**4d**) and secure with screws (**4c**)
- 3.** Connect driver (**1a**) to coaxial connector (**1b**)
- 4.** Plug driver (**1a**) into outlet
- 5.** Use hand to activate dimmer (**3a**). Touch and hold to dim, touch to turn on/off.

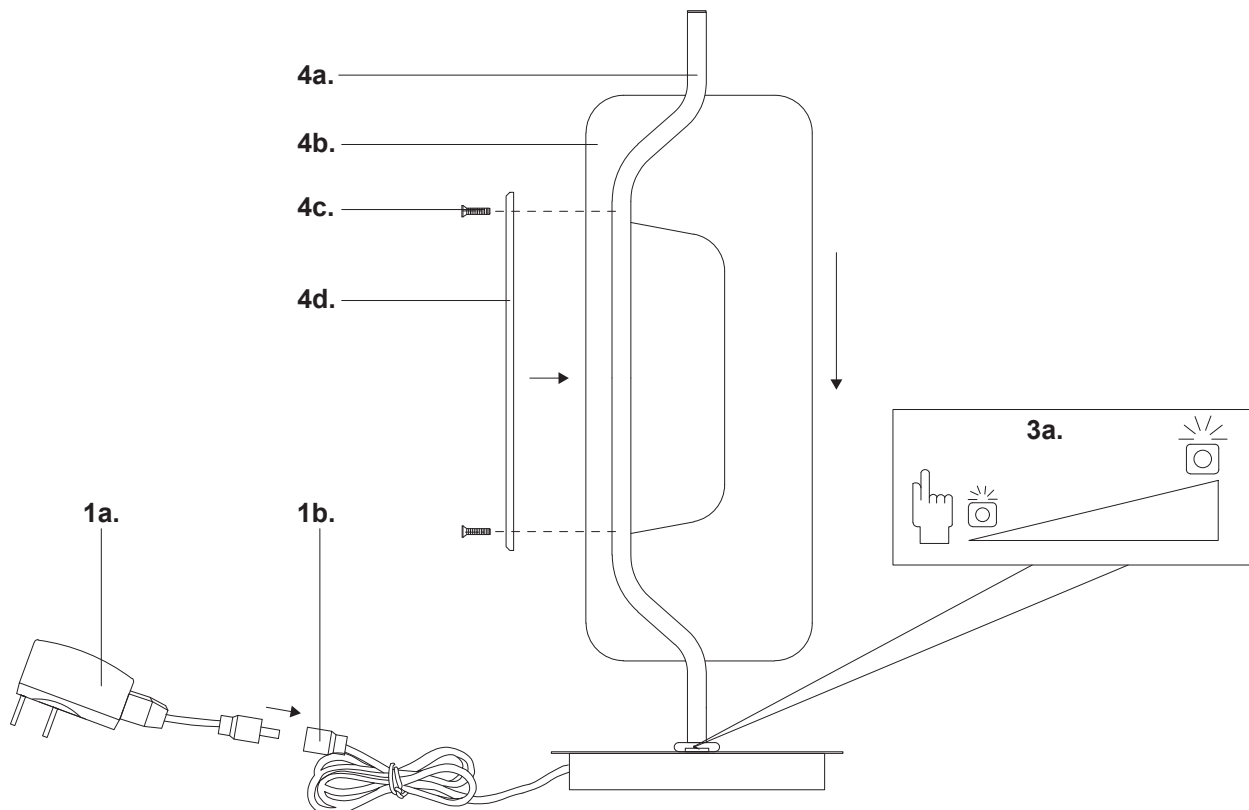

KUZCO

19054 28th Avenue Surrey, BC Canada V3Z 6M3
T: 604 538 7162 TF: 1-855 85 KUZCO F: 604 538 7196
W: kuzcolighting.com
20230109