



# **Dipping Light**

## **Jordi Canudas**

**marset**



Dipping Light A1-13

Dipping Light A2-13

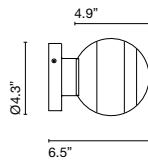
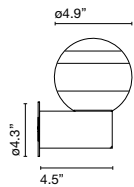

**Dipping Light A1-13 / A2-13**

LED 8W 110V 2700K CRI90  
Light source - 544lm  
(included)

**Hand-blown glass lamp in glossy white with different layers of paint. The wall versions have a metal support that holds up the diffuser.**

**Structure**

- Brushed Brass
- Graphite

**Shade**

- White
- Blue
- Green
- Ambar
- Pink
- Black



\* Under approval process.

Dry locations only

[Download](#) Assembly Instructions

[Download](#) Photometric Data

[Download](#) 2D

[Download](#) 3D

**WARNING.** California Proposition 65 Warning for California Consumers. This product can expose you to chemicals including wood dust and lead which are known to the State of California to cause cancer or birth defects or other reproductive harm. For more information go to [www.P65Warnings.ca.gov](http://www.P65Warnings.ca.gov)

**Watch video**  
[marsetusa@marset.com](mailto:marsetusa@marset.com)  
[www.marset.com](http://www.marset.com)

**Range**

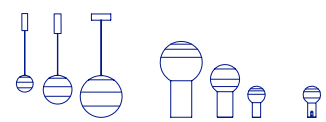

Two different stands have been designed to support the lamp, with one offering lighting in the horizontal direction and the other in the vertical direction. There is also a choice of finish for the wall lamp box between gold and graphite. Two new versions to expand its functionality even more.