

CRYSTORAMA

LIGHTING THE WAY FOR SIXTY YEARS

ASSEMBLY INSTRUCTION MODEL #5972-SL

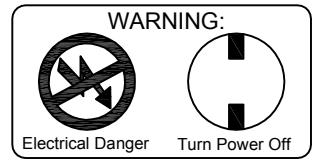
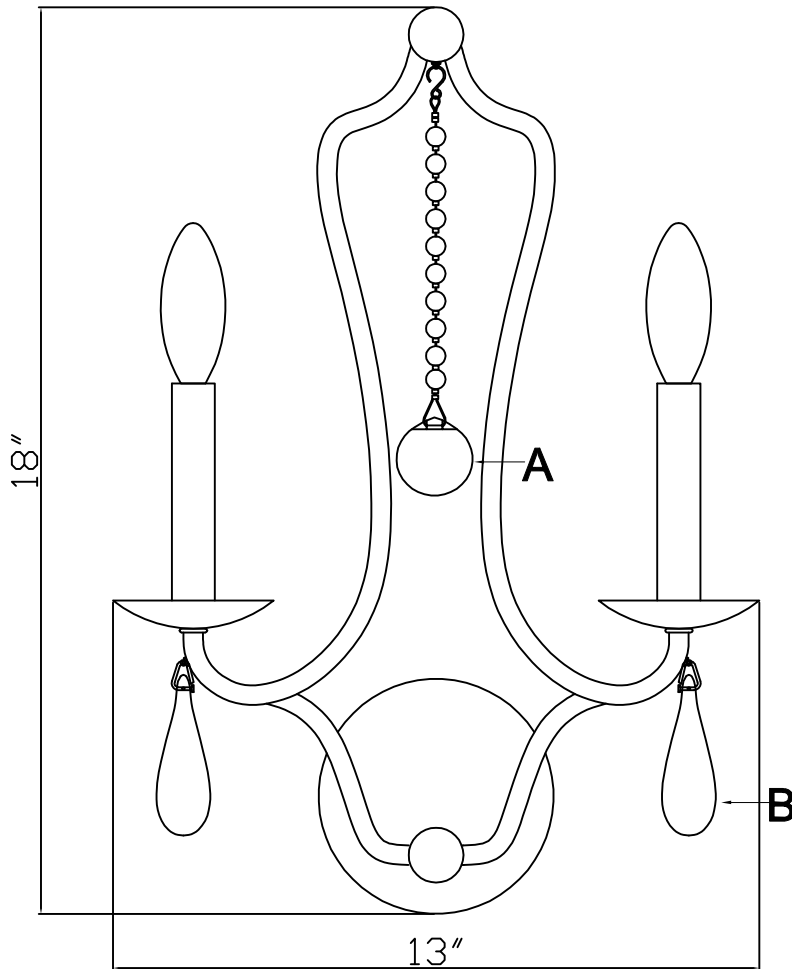

All electrical components must be installed by a licensed electrician in accordance with the National Electric Code and the appropriate local electrical codes.



You will need 2 - Cand.Bulb

40 Watts Recommended

60 Watts Max

USE LED BULBS FOR EXTENDED USE

How to Install For Hanging

1. Install the bulbs(not included) to the socket.
2. Hang the crystal drop to the body.
3. The backplate of the fixture can be mounted to the wall.

Crystal sets

A. 1 piece. (1)40mm+(10)10mm.

B. 2 pieces. (1)27X82mm.

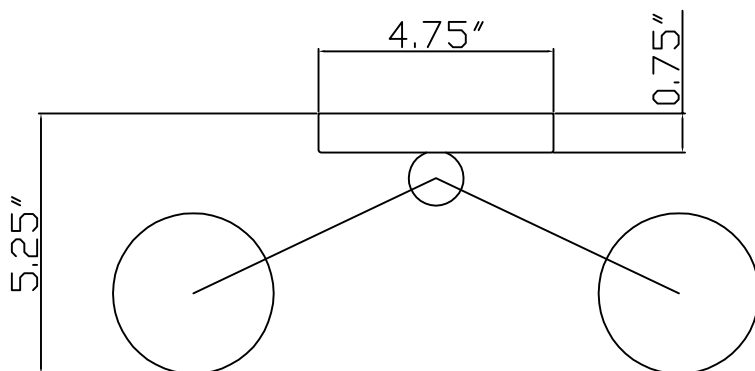

A = (10X10mm+1X40mm Ball)X1

B = (27X82mm Crystal)X2



WARNING: This product can expose you to Lead, which is known to the State of California to cause cancer and/or birth defects or reproductive harm. For more information go to www.P65Warnings.ca.gov

CRYSTORAMA

LIGHTING THE WAY FOR SIXTY YEARS

PART NUMBER MODEL #5972-SL

Part Number

Part Numbers

- A. (1)–Mounting Hardware
- B. (1)–Backplate; W4.75"XH0.75"; XSU5972SLBKP4.75IN
- C. (1)–Fixture Body
- D. (2)–Bobèche; XSU5973SLBOB3.25IN
- E. (2)–Candle Sleeve; $\phi 0.75$ "X4.75"; XSU5972SLCDL4.75IN
- F. (2)–Socket

