



Mica, walnut



The Mica is simply a cube, which has been carefully deconstructed to a sculptural state. By way of the fixture's orientation and petal material composition, it exudes a certain organic symmetry. The Mica accent pendant acts as a beautiful node, creating a sense of space marked with an ambient glow.

Nick Sheridan
Designer

Mica accent pendant

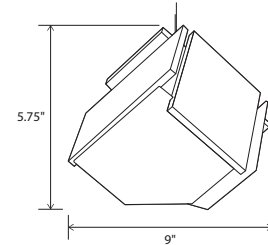

- Dimensions: 9" Ø, 5.75"
- Materials: solid wood, polymer
- Product weight: 3 lb
- Light source: integrated LED
- Light output: 345 Lumens (source)
- Light color*: 2700 K or 3500 K
- Color accuracy: 90+ CRI
- Power usage: 3.2 W
- Dimmable (see driver below)
- Driver location: must be housed in J-box
- Driver dimensions: 2" x 1.3" x 1", included
- Brushed aluminum (CM-006) low-profile square canopy
- Canopy dimensions: 4.5" x 4.5", 0.38"
- External LED driver (2.25" x 1.5" x 1")
- Accent pendants can be clustered by using multi-point round canopy or multi-point linear canopy
- See website for more canopy information
- 6'-0" drop length, field adjustable
- Suitable for a sloped ceiling
- Wood grain will vary
- Specifications subject to change

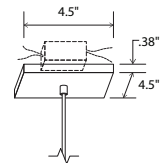

Mica
low-profile
square canopy



walnut
(CM-001)

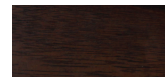

dark stained walnut
(CM-002)



MATERIAL & FINISH OPTIONS

	Mica part # 06 -160-	-
Wood Body		
walnut (CM-001)	W	
dark stained walnut (CM-002)	D	
Lamping*		
2700 K LED	27	
3500 K LED	35	
Driver		
120 V AC input voltage	P1	
ELV dimming only		

- Includes**
- frosted polymer (CM-024)
- *Available in 3000K, 4000K and other color temperatures upon request

