

**Bau Linear Suspension****700LSBAU**

1.0

**PENDANTS****GENERAL PRODUCT INFORMATION:**

This product is suitable for damp locations.

These fixtures are intended to be installed utilizing NEC compliant junction boxes.

This product can be dimmed with most ELV dimmers.

This instruction shows a typical installation.

**CAUTION - RISK OF FIRE**

This product must be installed in accordance with the applicable installation code by a person familiar with the construction and operation of the product and the hazards involved.

Use minimum 90°C supply conductors.

**Two Person Installation Recommended**

7400 Linder Ave, Skokie, IL 60077

847.410.4400

**[www.techlighting.com](http://www.techlighting.com)**

© 2020 Tech Lighting, L.L.C. All rights reserved.  
Visual Comfort & Co.

**DANGER**

The complete fixture exceeds 200 lbs., it must be supported independently of the outlet box unless the outlet box is listed for the weight to be supported.

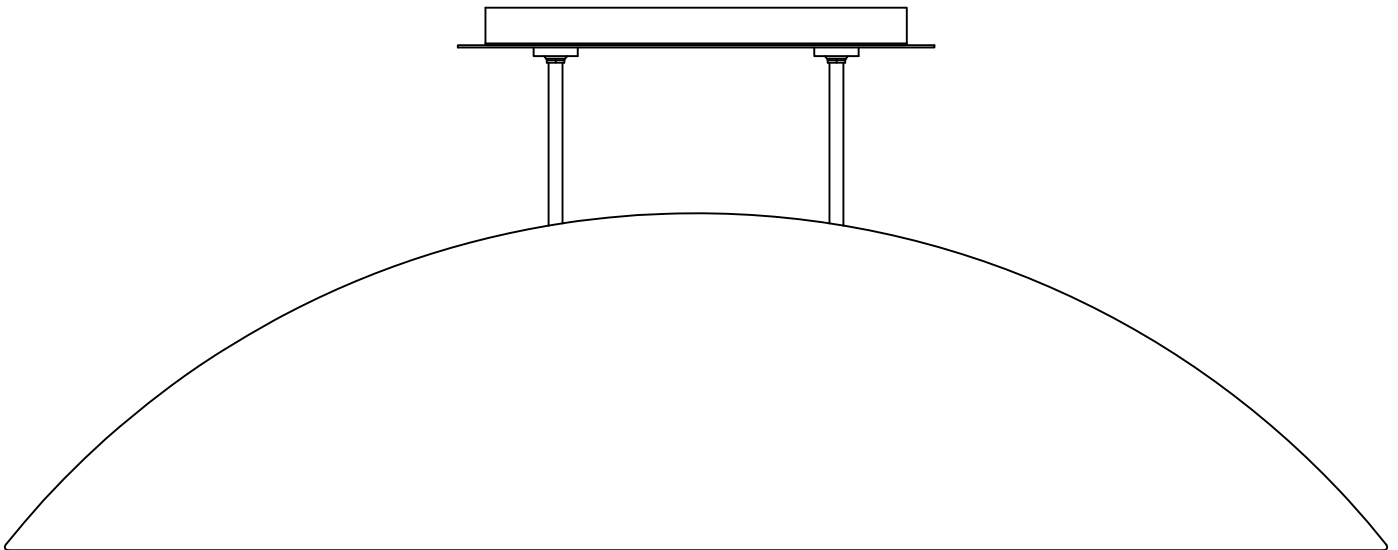

**SAVE THESE INSTRUCTIONS!**

1A

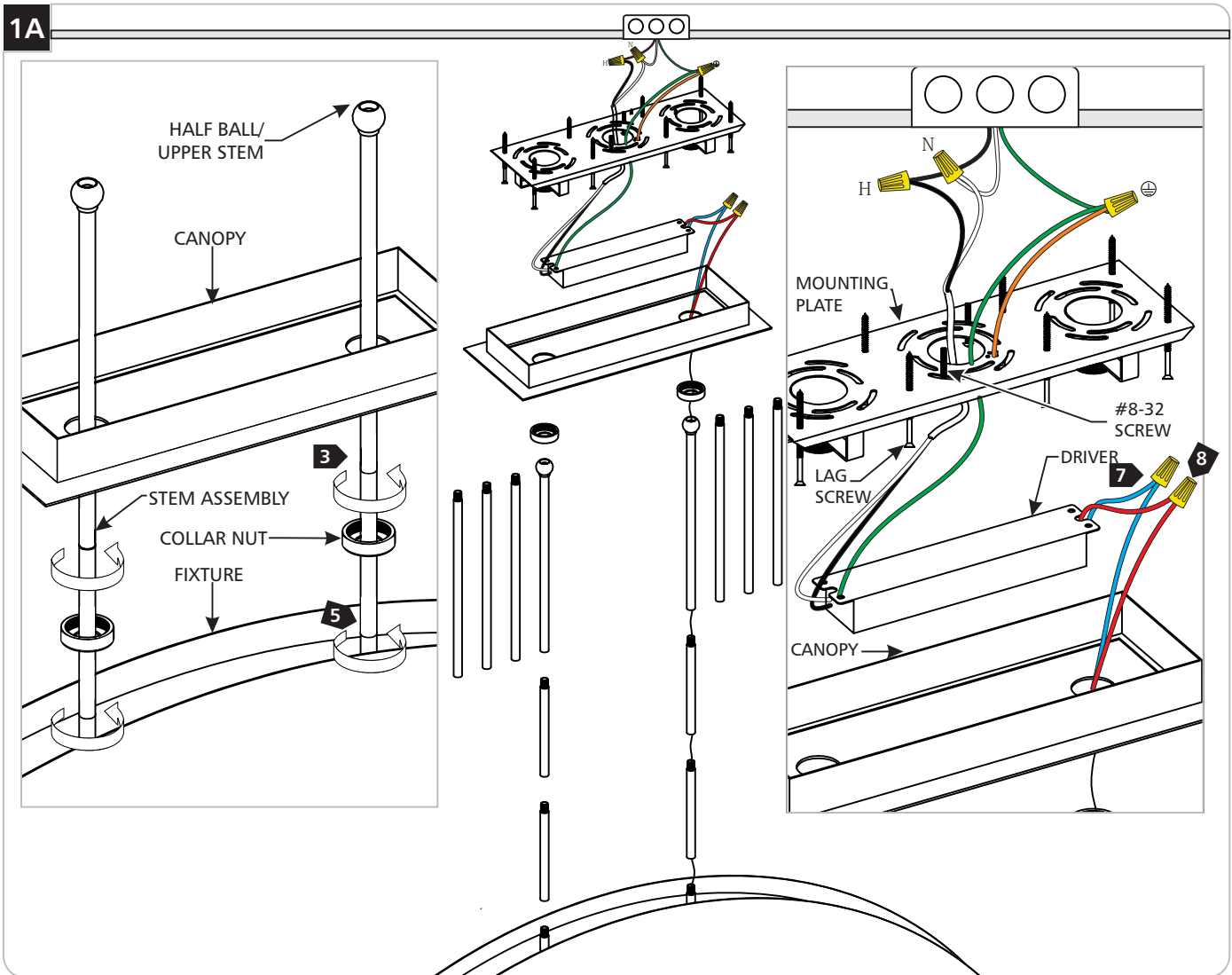

- 1 Remove the mounting plate and driver from the canopy.
- 2 Secure the mounting plate to the junction box with the provided #8-32 screws. **DANGER: If the junction box is not rated for 200 lbs. or more, the mounting plate must be supported independently of the junction box.**
- 3 Determine the desired height of the fixture using the provided stems and half ball/upper stems and assemble them by screwing them together.
- 4 Slide a collar nut over each half ball/stem assembly.
- 5 Feed the fixture wires through a stem assembly, then screw the stem assemblies to the top of the fixture.
- 6 Feed the fixture wires and half ball/stem assembly through the canopy, then seat the half balls into the mounting plate. **(Make sure to avoid pinching the wires on the one side.)**
- 7 Connect the blue driver wire to the blue fixture wire with a wire nut.
- 8 Connect the red driver wire to the red fixture wire with a wire nut.
- 9 Connect the fixture to a suitable ground in accordance with local electrical codes.
- 10 Connect the white driver wires to the neutral power line wire with a wire nut.
- 11 Connect the black driver wires to the hot power line wire with a wire nut.
- 12 Neatly place the drivers, all wires, and wire nut connections inside the canopy, slide the canopy up to over the mounting bracket and secure in place with the collar nuts.