

Parts Included:

Wire Connector

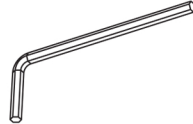

Allen wrench



Outlet Box Screw(#8-32)



Outlet Box Screw(#6-32)



CSA / UL Safety Requirements

CSA/UL requires that these IMPORTANT SAFETY INSTRUCTION be listed:

- Before starting installation of this fixture or removal of a previous fixture, disconnect the power by turning off the circuit breaker or by removing the fuse at the fuse box.
- Consult a qualified electrician if you have any electrical questions or need to replace the driver.

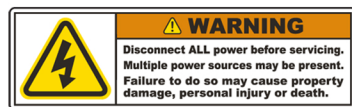

Care Instructions

Arnsberg suggests using only a micro fiber cleaning cloth to clean this fixture. If required, a slightly damp cleaning cloth may be used to spot clean. Do not use common household cleaners on this fixture, as the final finish may be damaged as a result. Enjoy your new Arnsberg fixture.

Arnsberg

customerservice@arnsberg.com

www.arnsberg.com

Mounting Instructions

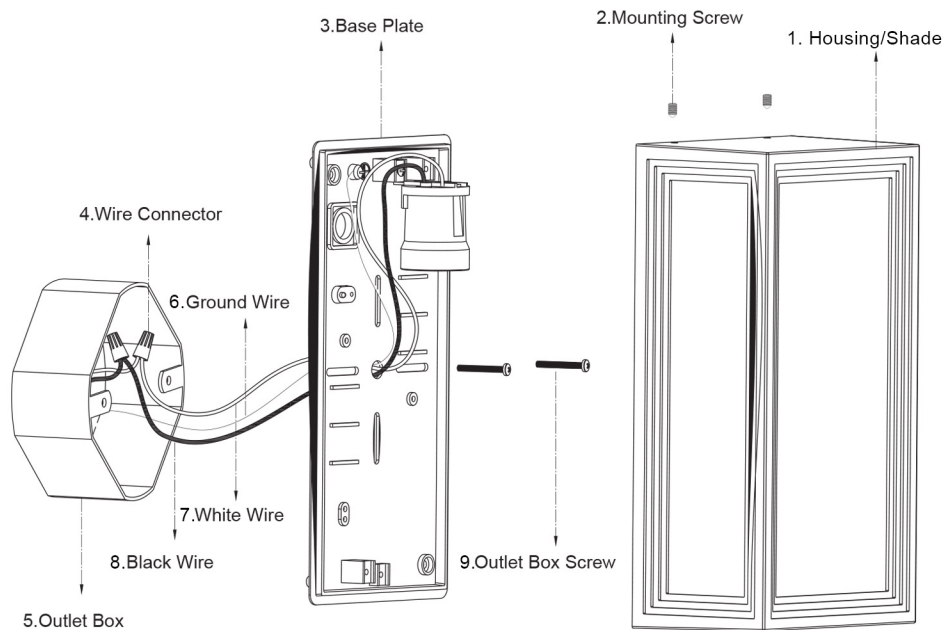

ASSEMBLY INSTRUCTIONS

TIMOK

228060101

Assembly Instructions

1. Turn off the power by turning off the circuit breaker.
2. Open the housing/shade(1) by unscrewing the Mounting Screws (2) and set the housing to the side.
3. Connect the groundwire from the outlet box (5) to the ground wire (6) from the fixture. Connect the white wire (7) from the fixture to the white wire from the outlet box, and connect the black wire (8) from the fixture to the black wire from the outlet box using the provide wire nuts. Wrap the wire connections with electrical tape for a more secure connection. The connected wires can be then be positioned back into the outlet box.
4. Next, the base plate should be attached to the outlet box using the provided outlet box screws (9).
5. Last, the housing/shade (1) should be attached to the base plate (3) using the provided mounting screws (2).
6. Installation is now complete. Turn on the power at the circuit breaker or fuse box. Then the switch can be turned on to activate the fixture.