

easy@Home®



Digital Baby Monitor
USER MANUAL
EHB256

Congratulations

You have just purchased a qualified Wireless 2.4GHz Digital Baby Monitor. Please read these instructions carefully before using the product. Keep these instructions for future reference.

Table of Contents

Parts and Quick Reference.....	1
Safety Precautions.....	3
Color Index of Power Indicator.....	5
Battery Status.....	5
Simple to Operate.....	6
Reception Testing.....	7
Functions Setup.....	7
Location and Set Up.....	11
Maintenance Notice.....	12
Trouble Shooting.....	13
Technical Specification.....	14

Parts and Quick Reference

Parent Unit

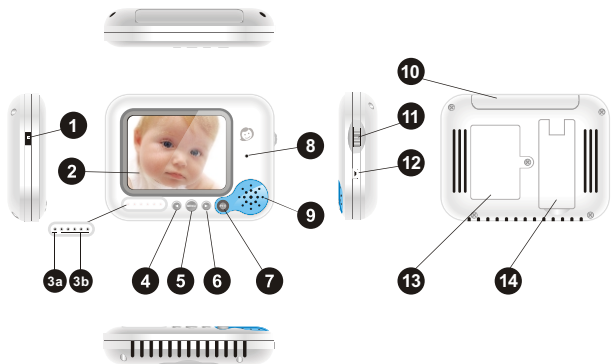

- | | |
|------------------------------|----------------------------|
| 1 VOX Switch | 8 Microphone |
| 2 LCD Display | 9 Speaker |
| 3a Power Indicator | 10 Antenna |
| 3b Signal strength indicator | 11 On /Off & volume switch |
| 4 Option key (◀) | 12 Adaptor Jack |
| 5 Menu key | 13 Battery door |
| 6 Option key (▶) | 14 Stand |
| 7 PTT Switch | |

Baby Unit:

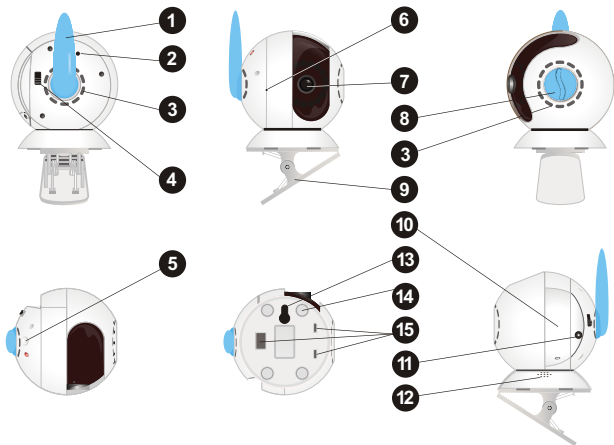

1 Antenna

2 Night Vision Infrared LED's

3 Thermal Via

4 On/Off Switch

5 Link Key

6 Microphone

7 Camera

8 Camera adjusting knob

9 Mounting clip

10 Compartment

11 AC Adaptor Jack

12 Speaker

13 Hole for Hanger

14 Foot mat

15 Clip hole

AC Adaptor:

The AC Adaptor is device that allows you to power on the system with your household electricity. The adaptor can be separately connected to DC IN connectors of Parent Unit and Baby Unit. **Please be reminded to switch off the system before plugging or unplugging the adaptors.**

CAUTION: These adaptors are with exclusive design for this system. Please NEVER try to power up the system with different adaptors or use them for any other appliances.

Safety Precautions

When using this unit, basic safety precautions should always be followed to reduce the risk of fire, electric shock, or personal injury.

- Read and understand all instructions.
- Follow all warnings and instructions marked on this unit or mentioned in this operation instruction.
- This product is not intended to replace adult supervision. Its intent is to assist the adult. It is important that users should stay within the communication range of the system at all times when using it.
- It is essential to check the reception regularly. Please see the reception section for complete instructions.
- Never put the system near water, such as the bathtub, bathroom sink, laundry tub, kitchen sink or in a wet basement, etc. Immersion of this unit in water could cause an electrical shock.
- Place the unit securely on a stable surface. Serious damage and/or injury may result if the unit falls.
- Do not cover slots and openings on the unit. They are provided for ventilation and protection against overheating.
- Install the unit where no one can step or trip on the cord.
- Never push any objects through slots in this unit. This may result in the risk of fire or electric shock. Never spill any liquid on the unit.
- To reduce the risk of electric shock, do not disassemble this unit. Take the unit to authorized service center or qualified technician when service or repair work is required. Opening or removing covers may expose you to dangerous voltages or other risks. Incorrect reassembly can cause electric shock when the unit is subsequently used.
- Keep the system away from heat sources such as radiators, heat registers, stoves or other appliances producing heat. Also keep these

- units out of direct sunlight.
- Always unplug the AC adaptors if not using the system for long periods of time.
- The outer surface of the Baby Unit and Parent Unit can be cleaned with a cloth LIGHTLY dampened with water or a mild cleaning solution.

WARNING:

To reduce the risk of fire or electrical shock, do not expose this unit to rain or any type of moisture.

Privacy Protection

Always remember that you are using public airwaves when you use the Wireless 2.4GHz Digital Baby Monitor. Sound and video may be broadcasted to other receiving devices. Conversations, even from rooms near the camera, may be broadcast as well.

CAUTION: To protect your privacy, always turn the system off when not in use. It is possible that the Parent Unit may be interfered from other devices in the 2.4GHz frequency range.

User can directly operate the unit by the supplied AC adaptor.

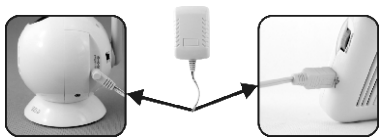

- ◇ Use only the AC adaptor included supplied.
- ◇ Unwrap and fully extend the AC adaptor cord.
- ◇ Plug AC adaptor into a standard wall outlet.
- ◇ Wrap up and secure any excess AC adaptor cord.

Battery Tips:

- The Parent Unit is equipped with rechargeable batteries already installed in the battery compartment, for convenience of its mobile use.
- No batteries are supplied for the Baby Unit. Please always use the AC adaptor to provide power to the Baby Unit.
- Please fully charge the batteries at least once every three months even if you don't use the device, to maintain the optimum capacity of the batteries.
- Charge the batteries under adult supervision.
- Dispose of the batteries safely according to relevant local regulations.

Warning!

- Batteries should not be exposed to excessive heat such as sunshine, radiators or fire
- Danger of fire if batteries are incorrectly replaced

Color Index of Power Indicator

Indication	Light Indicator	
	Parent unit	Baby unit
Normal Operation	Power indicator shows stable red light	Power indicator shows stable red light
Low battery	Red blank battery icon "  " shows on LCD	
In charging (Power Off)	Power indicator shows stable green light	
In charging (Power On)	A charging battery icon shows on LCD	
Pairing status	Select pairing option in main menu of parent unit, power indicator shows red.	The power indicator quick flashes green light.

Battery Status

Low battery status

Parent unit: When low battery, red icon  will be shown on main screen of Parent unit. Please charge the batteries .

Charging the Batteries (only for Parent Unit)



Please charge the rechargeable batteries for first time usage. The batteries will reach the maximum capacity after 4 to 5 times fully charge and complete discharge cycles.

- Use only the supplied AC adaptor for charging the supplied rechargeable batteries.
- Plug into any nearby standard electrical outlet at home and charging automatically begins. A charging battery icon shows.
- When fully charged, a full battery icon shows. The charging time for completely empty batteries is about 8 hours while the parent unit is turned off.

ALWAYS CHARGE THE BATTERIES UNDER ADULT SUPERVISION.

Simple to Operate

Switch on the baby and parent units, and adjust the preferable sound level.

1	<p>Connect with the AC Adaptor With AC adaptor</p> 
2	<p>Turn on the Baby unit, then Parent unit.</p>  <p>Remarks: Default setting: Pairing is auto-scanned.</p>
3	<p>Adjust the appropriate volume level.</p>  <p>Remarks: Night vision will be automatically switched when using in the dark, infra-red LED will be activated, and only Black & White image will be shown.</p>

*** For more detailed operation, please go to “Functions setup”**

Reception Testing

Before using the Parent Unit or changing the location of the system, it is very important to test the video and sound reception:

To test the video reception

- Place the Baby Unit in the most appropriate location. (e.g. on top of the table, mounting on the wall or ceiling)
- Focus and adjust the camera lens towards the baby.
- Check the video reception on screen of the Parent Unit and adjust the appropriate brightness level. (To adjust brightness, please see the "Functions Setup" section)

To test the sound quality

- Speak in a whisper and with normal conversation sound level to Baby Unit.
- Put the Parent Unit far away enough (at least 1m) from Baby Unit to prevent noise feedback.
- Check the sound reception on speaker of the Parent Unit and adjust the appropriate volume. (To adjust volume, please see the "Functions Setup" section)

Functions Setup

Baby Monitor Functions Setup

Power ON/OFF

- Power on the Parent unit by turning on the ON/Off & VOL Switch until a click sound can be heard. The Power Indicator will show red light and 3 second music will be heard for 3 seconds. Power on the Baby unit by turning on the ON/Off Switch. The power indicator will be on and music will be heard for 3 seconds.
- An image will show on the LCD display if signal is received, otherwise a white screen will show.
- Power off the Parent unit by turning off the ON/Off & VOL Switch until a click sound is heard, The Red light of the power indicator will be off after 3 seconds with no display on LCD. Power off Baby unit by turning off the ON/Off Switch. All functions of baby monitor will be stopped.

Parent Unit Screen Display

- **Signal Strength:** It shows the strength of the transmission signal of the transmitting unit. 6 levels for signal strength, higher level means stronger signal.



- **Parent unit Battery:** indicates the current battery status.



Status can be: full charge, 3/4 charge, 1/2 charge, 1/4 charge, low battery.

Charging time for completely empty batteries is about 8 hours while the parent unit is turned off.

Volume Control

- Increase the volume by turning up the **On/Off & Volume** Switch
- Decrease the volume by turning down **On/Off & Volume** Switch

Main Menu

- Press **MENU** key to enter into main menu. Use ◀/▶ key to select, and press again **MENU** key to confirm.
- Then, Select EXIT, Parent unit will return to LCD display.

MAIN MENU

Brightness	3
Outdoor Mode	0
Pairing	
Exit	

Brightness

- Enter into main menu by pressing "**MENU**" key, press "◀ or ▶" key to select Brightness option, then confirm and enter into Brightness menu.
- Press ◀ / ▶ key to adjust the brightness level from 1 to 5. Press **MENU** key to confirm.
- Select EXIT option and press "**MENU**" key to the live video.

Notes: 1 is the darkest .5 is the brightest

Outdoor Mode

- Enter into main menu by pressing “**MENU**” key, press “◀ or ▶” key to select Outdoor Mode option, then press **MENU** key to confirm and enter into Outdoor Mode menu.
- Press ◀ / ▶ key to turn on or turn off Outdoor Mode. Press **MENU** key to confirm.
1 = Outdoor mode is turned on. 0= Outdoor mode is turned off.
- Select EXIT option and press “**MENU**” key to the live video.

Remarks: Outdoor Mode should be used when baby unit is placed in the outdoors.

Pairing

- For Parent Unit, enter into main menu by pressing “**MENU**” key, then press “◀ or ▶” key to select “Pairing” option and wait.
- For Baby Unit, press “**Link**” key 3 seconds until power indicator is fast flashing red light. Press “**MENU**” key of parent unit to confirm.
- When paired successfully, parent unit will display live video on its own. Meanwhile, both parent and baby unit will flash red light.
- If there is no display on LCD screen of parent unit. Please repeat above steps.

Music Function



- At the live video, press “◀” key to turn on music.
- Press the key “▶” to choose the music order as follows, music 1 > music 2 > . . music 6 > music 1
- Press “◀” key when music play to exit music function.

Talking Function

- Under normal communication, baby unit will transmit sound and image to parent unit.
- If parent unit needs to talk back to baby unit, press PTT key on parent unit to talk.
- Release PTT key after talking. The parent unit will be returned to receiving status.

VOX



When turning on VOX, transmission will be activated ONLY if sound is detected by Baby unit. LCD screen would be turned off if no sound is detected within 30 seconds. Once the sound is detected, it will automatically turn on the LCD screen. This is a power saving feature.

Infrared Night Vision



When Baby unit is placed in dark environment, parent unit will be switched to Night Vision mode automatically. At this circumstance, parent unit can also receive image and sound. The image shows in black & white (See picture)

Out of Range Alert.

Under the following conditions, the parent unit will emit the “out of range” alert.

- Baby unit is turned off.
- The units are detected out of communication range.
- Baby unit is in low power.

Antenna

If parent unit is too far from baby unit and can't receive good image from baby unit, there is an antenna to help strength the signal. (See picture)



Lens & Camera Adjustment



- If the video of the mother unit is blurred, adjust the lens switch of the baby unit until the video reaches the best image quality. (See picture)
- Adjust the Camera Rotation Handle to the desired viewing angle.

Location and Set Up

You can position and adjust the Baby Unit in a variety of ways to provide the best view of your baby. To optimize the performance, position the monitor unit 3 ft (1m) away from the baby.

Set up removable Mounting Clip (optional)

The Baby Unit can be clip on the table edge by setting up the removable mounting clip. After inserting the mounting clip at the base bottom, the user can easily fix the Baby Unit into a different location. Setting and disassembly method are shown in the figure below.

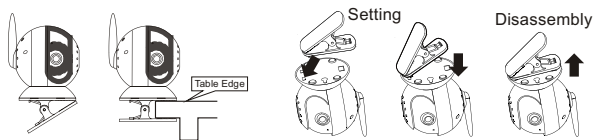

Wall Mount

User can mount the baby unit on the wall or ceiling using the wall mount hole.

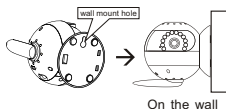

Maintenance Notice

3 AAA rechargeable batteries are pre-installed into the parent unit which can work for around 500 charge and discharge cycles. When the parent unit can only work for a short time after fully charged, you need to replace the batteries. Please replace with the same model of rechargeable batteries from the distributor Easy At Home Medical LLC. (Model No.:BT-100-AC, not for free) or equivalent for parent unit. It is not recommended to use non-rechargeable batteries for environment protection sake.

CAUTION

- Dispose of the batteries safely according to relevant local regulations.
- Never charge non-rechargeable batteries, or it'll cause fire and major damage to you.

How To Replace the Rechargeable Batteries

- Remove screw by a screwdriver.
- Open the battery compartment cover.
- Insert 3 AAA rechargeable (Model No.:BT-100-AC or equivalent) into the Parent unit according to the polarity illustrated in the battery compartment.
- Press down the screw and screw it up again.

Parent Unit

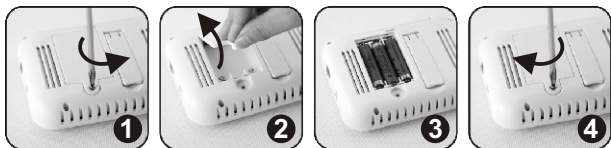

Trouble Shootin

Problem	Possible Cause	Solution
Power indicator LED does not light up	<ol style="list-style-type: none"> 1. Unit is not turned on. 2. Power is switched off 3. Batteries may be used up 4. AC Adaptor not properly connected. 	<ol style="list-style-type: none"> 1. Slide the ON/OFF switch to the "ON" position 2. Make sure that power outlet is turned on. 3. Replace new batteries 4. Check AC Adaptor jack-to-socket and plug-to-outlet nnections.
No image or sound, or image blurred	<ol style="list-style-type: none"> 1. Wrong brightness level 2. Video VOX is on but no sound is received. 3. Low volume level 4. Signal interference due to other household appliance such as cordless or cellular telephone and etc. 	<ol style="list-style-type: none"> 1. Adjust the brightness to the desired level. 2. Press any key on the Parent unit to activate parent unit, select VOX Off, to give a sound to baby unit. 3. Adjust volume level to the desired level. 4. Press the LINK key of baby unit and select pairing option in main menu of parent unit to scan the channel.
Image flickers	<ol style="list-style-type: none"> 1. Object is too close to the Baby Unit. 2. Baby or Parent Unit is close to magnetic objects. 3. Signal interference due to other monitors, cordless or cellular telephones etc. 	<ol style="list-style-type: none"> 1. Remove objects from the Baby Unit at about 1m. 2. Test reception by moving the Baby Unit and / or Parent Unit to different locations throughout the house. 3. Press the LINK key of baby unit and select pairing option in main menu of parent unit to scan the channel.. Identify and eliminate the source of interference.
Audio feedback	<ol style="list-style-type: none"> 1. Two units are too close 2. Volume is too high. 	<ol style="list-style-type: none"> 1. Keep distance between two units at about 1m 2. Lower the volume

Dark image at night	<ol style="list-style-type: none"> 1. Power is switched off 2. Batteries may be used up 3. Brightness level is too high / low 	<ol style="list-style-type: none"> 1. Check the Baby Unit and/or Parent Unit power indicator. Check the connection of the adaptor and the Parent unit. 2. Replace new batteries. 3. Adjust the Exposure level
Lose Link (No signal)	<ol style="list-style-type: none"> 1. Baby unit is turned off. 2. The units are detected out of communication range 3. Baby unit is in low power. 	<ol style="list-style-type: none"> 1. Turn on the Baby unit. 2. Ensure both units are in the communication range. 3. Replace new batteries or operate by the supplied adaptor.

Technical Specification

Parent Unit

- Operation voltage: DC 5.5V 800mA or 3 x "AAA" rechargeable/ alkaline batteries
- Temperature Range : 0°C~40°C (32-104°F)
- Power consumption : ≤4W
Operation Frequency: 2.4GHz~2.4835GHz
- Max Range (clear line of sight) : up to 250m or 820ft(in open area)
- Resolution : 32 x 240 Pixel
- Image Speed : > 12 films/second
- LCD : 3.5" Color LCD
- Size of Hand Held : 120 x 28 x 90 mm

Baby Unit

- Operation voltage : DC5.5V 800mA
- Power Output : 20 dBm
- Temperature Range : 0°C~40°C (32-104°F)
- Power consumption : ≤4W
Operation Frequency : 2.4GHz~2.4835GHz
- Mic Sensitivity : 1-2 m (3.5-6.5ft)
- Size of Baby Unit : 129 x 88 x 83mm
- Object Distance : 1-2m (3.5-6.5ft)

FCC Statement:

This device complies with part 15 of the FCC Rules. Operation is subject to the following two conditions: (1) This device may not cause harmful interference, and (2) this device must accept any interference received, including interference that may cause undesired operation.

Note: This equipment has been tested and found to comply with the limits for a Class B digital device, pursuant to part 15 of the FCC Rules. These limits are designed to provide reasonable protection against harmful interference in a residential installation. This equipment generates uses and can radiate radio frequency energy and, if not installed and used in accordance with the instructions, may cause harmful interference to radio communications. However, there is no guarantee that interference will not occur in a particular installation. If this equipment does cause harmful interference to radio or television reception, which can be determined by turning the equipment off and on, the user is encouraged to try to correct the interference by one or more of the following measures:

- Reorient or relocate the receiving antenna.
 - Increase the separation between the equipment and receiver.
 - Connect the equipment into an outlet on a circuit different from that to which the receiver is connected.
 - Consult the dealer or an experienced radio/TV technician for help.
- Any Changes or modifications not expressly approved by the party responsible for compliance could void the user's authority to operate the equipment.

FCC Radiation Exposure Statement:

This equipment complies with FCC radiation exposure limits set forth for an uncontrolled environment.

This equipment should be installed and operated with minimum distance 20cm between the radiator & your body.

This transmitter must not be co-located or operating in conjunction with any other antenna or transmitter.

----- The End -----

easy@Home®



Easy At Home Medical, LLC

Any questions, please call toll-free 1-855-822-6999

M-F 9:00 a.m. - 5:00 p.m. Central Time

E-mail: service@easyathometesting.com

Web-site: www.easyathometesting.com