

APOC INDUSTRIES

TRACTION/ LADDER BAR INSTALL

1. First step is mounting the axle mount to the vehicle, depending on vehicle you will have a u bolt mount or axle clamp.

CLAMP STYLE- install the clamp around the axle on the side away from the tire, do not tighten the 6 bolts yet leave loose enough you can twist the clamp. You can place the ladder bar mounting tabs straight forward or down depending on preference or clearance concerns.



U BOLT STYLE- These mounts will go between the u bolt nuts and the bracket that goes under the axle, leaving the factory axle bracket in original location place our bracket under it then reinstall the u bolt nuts. (Factory bracket, our bracket, then U bolt nuts). The mounting holes for the ladder bar goes forward and will be offset towards the center of the vehicle. Install and tighten u bolts to specs (look up specs to match the diameter of the u bolts 9/16", 5/8", or 3/4" are the most common sizes.)

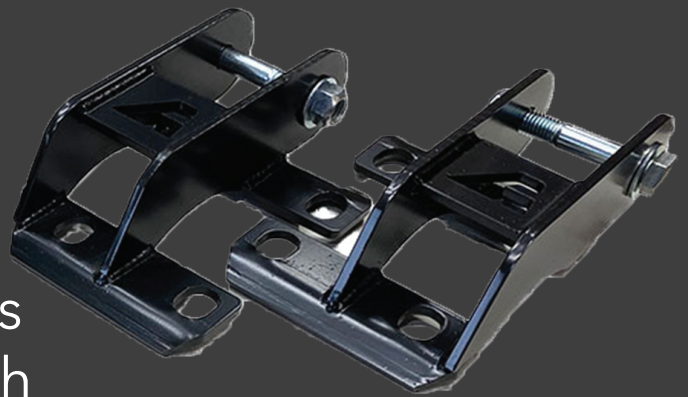

2. Attach the traction bars to the axle side mount do not tighten nuts at this time, install frame mount on the opposite end of traction bar leave the nut loose. Lift the ladder bar up to the frame and verify clearance of the mount and bolts on both sides. If you need to lengthen the bar for clearance you can adjust them out up to 2.5".

3. With the length set and both sides are verified for fitment you can raise traction bar to frame and mark the holes for drilling, the holes will need to be drilled using a 1/2" drill bit. Use caution when drilling not to hit brake lines, electrical wires or fuel tank. Once holes are drilled mount the frame side bracket and tighten bolts at this time.

4. Once all bolts are securely fastened make sure to install grease fittings and lube before use. We do not recommend any particular grease brand just make sure you do grease them periodically.

PROUDLY MADE IN THE USA

IF YOU HAVE ANY QUESTIONS

PLEASE CALL US @

865-983-5004

M-F 8-5 EST