

UHI-4 Insufflator Quick Reference Guide

Disclaimer: Information provided in this guide is not exhaustive. Please refer to the complete Instructions For Use for each item of equipment which should be thoroughly read and understood prior to handling, use and storage of the equipment.

Insufflator Controls

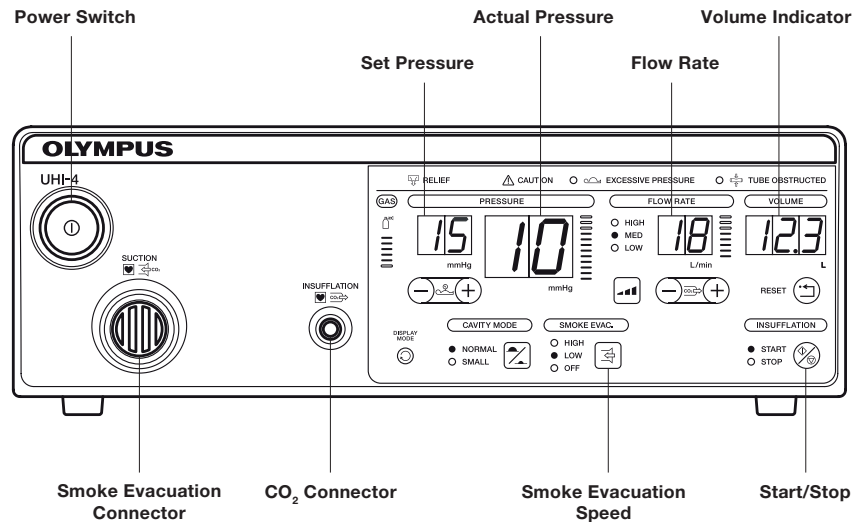

Cavity Modes

There are two cavity modes Normal and Small which regulate the pressure and flow rates.



Cavity mode	Setting pressure range	Note
NORMAL	3 - 25 mmHg (0.4 - 3.3 kPa)	To increase the pressure from 20 to 21 mmHg, keep pressing "+" for at least three seconds
SMALL	3 - 15 mmHg (0.4 - 2.0 kPa)	

Press to toggle between normal and small

Note: The cavity mode cannot be changed once insufflation has started, if required stop insufflation and then change mode.

Flow Rates

There are three flow settings:

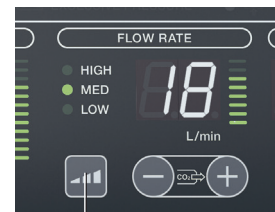

Cavity mode	Setting pressure range	Note
NORMAL	HIGH	20 - 45
	MED	1.1 - 1.9, 2 - 5
	LOW	0.1 - 1.0
SMALL	HIGH	6 - 10
	MED	1.1 - 1.9, 2 - 5
	LOW	0.1 - 1.0

Press to toggle between flow rates

Warning: when using a Veress needle always use the LOW flow mode as insufflation in other modes is dangerous because the cavity pressure may exceed the set pressure.

UHI-4 Insufflator Quick Reference Guide

Disclaimer: Information provided in this guide is not exhaustive. Please refer to the complete Instructions For Use for each item of equipment which should be thoroughly read and understood prior to handling, use and storage of the equipment.

Smoke Evacuation

Use the MAJ-1939 foot switch for smoke evacuation. The smoke and mist generated inside the cavity can be exhausted while maintaining the cavity pressure.

- In the sterile field cut the luer lock end of the tubing (WA95007A) and connect to a ULPA filter, attach to a secondary port and open the tap.
- Attach the thinner diameter tubing into the green suction pinch valve on the UHI-4.

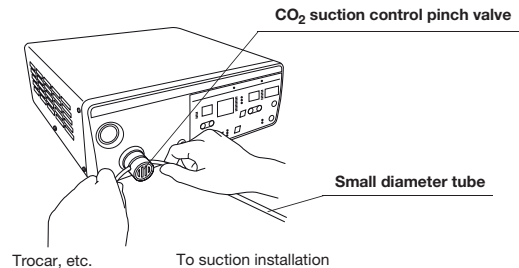

- Attach the blue end of the suction tubing to the suction device and activate suction on this device.

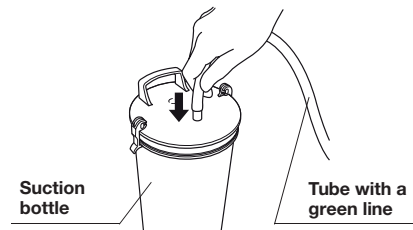

Smoke Evacuation



When used in combination with the Olympus MAJ-1939 foot switch, pressing the appropriate switch allows this instrument to execute insufflation into and suction from the cavity simultaneously to exhaust and remove the generated smoke and mist while maintaining the cavity pressure constant. The flow can be adjusted using the toggle button.

Note: Smoke evacuation will not work if:

- The flow rate on the insufflator is set to LOW
- When the high flow insufflation unit is in the gas flow stop mode.
- When this instrument is in the excessive pressure caution status.
- When this instrument is in the tube obstruction caution status.

Note: If the patient is a child whose cavity volume is small, the cavity pressure will fluctuate greatly. Do not use the smoke evacuation function in such cases.

UHI-4 Insufflator Quick Reference Guide

Disclaimer: Information provided in this guide is not exhaustive. Please refer to the complete Instructions For Use for each item of equipment which should be thoroughly read and understood prior to handling, use and storage of the equipment.

Insufflator Controls

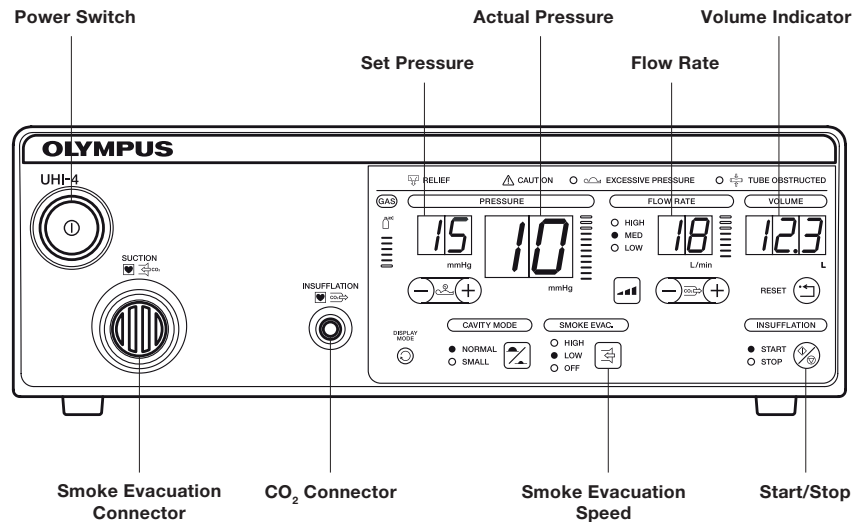

Troubleshooting

Low or no pressure

- Check insufflation tubing connected to insufflator, switched on and tap on port turned on.
- Check gas level and that gas cylinder is turned on. Increase flow rate or pressure.

Excessive pressure alarm continuously sounds

- The high pressure alarm will sound if the patient anaesthetics are no longer effective, consult the anaesthetist.

Smoke Evacuation does not work

- Check the smoke evacuation speed is not set to OFF.
- The flow rate on the insufflator is set to MEDIUM or HIGH.

Useful Part Numbers

WA95005A Insufflation tubing box 20

WA95007A Smoke Evacuation tubing box 20

OLYMPUS

For further information, please contact
Olympus Customer Services on **01702 616 333**
or visit **www.olympus.co.uk**