

# EB41067

emory & bond

## HUNTERDON SERIES

FREE STANDING ACRYLIC TUB

RECTANGULAR DESIGN

SLOTTED OVERFLOW

ROUND DRAINHOLE

MEETS CUPC STANDARDS

5 ADJUSTABLE SUPPORT FEET

NOMINAL SIZE 67" X 32" X 23"

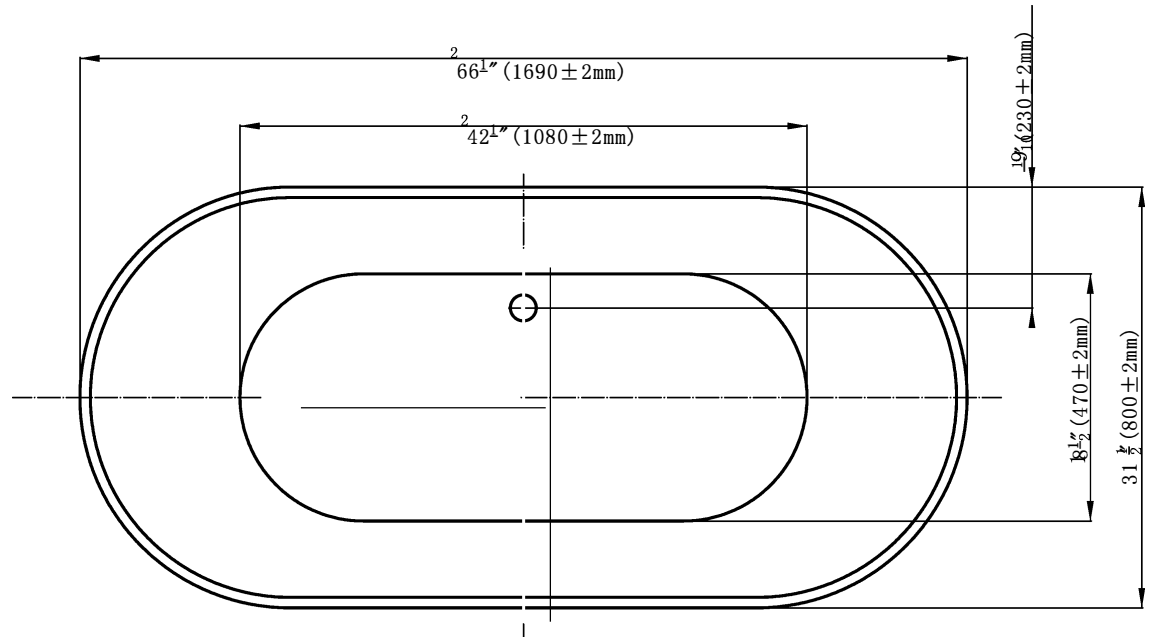
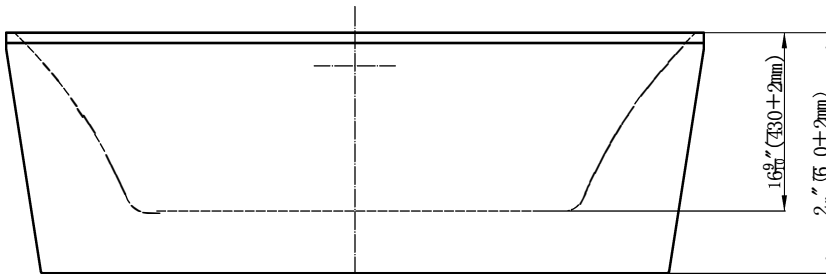



All pictures shown are for illustration purposes only.  
Actual product may vary due to product enhancement.

### Customer Support:

Call : (973)-482-4444

e-mail: info@emoryandbond.com

www.emoryandbond.com

  @emoryandbond