

# SHOWER WATERPROOFING

## SUBSEAL® LIQUID MEMBRANE

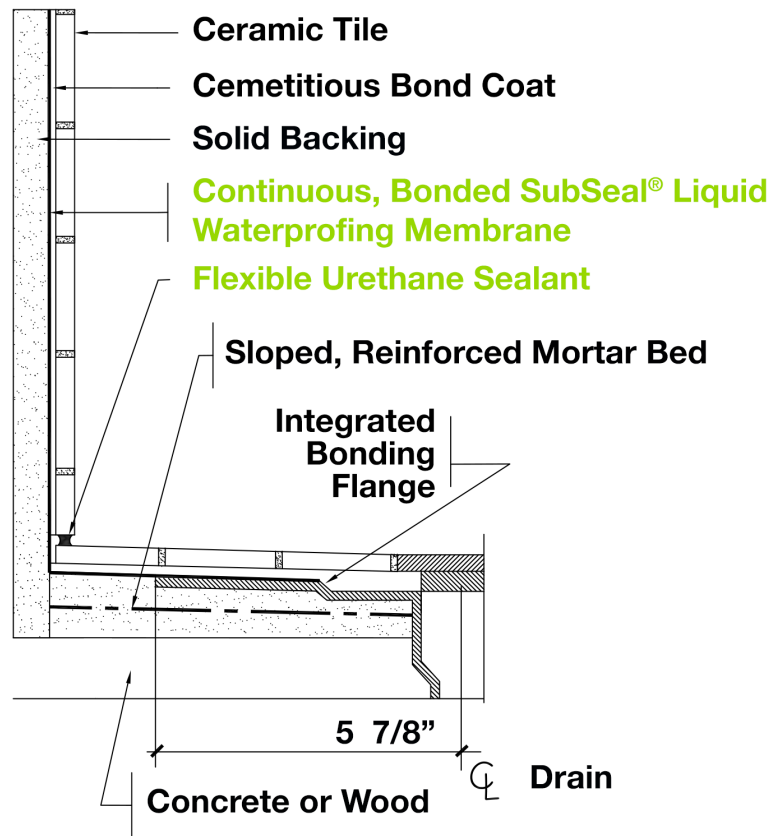

Shower receptors, curbs, seats, etc., must be properly waterproofed and installed to avoid water damage to adjacent building materials.

For specification purposes, the NAC products used in this system are:

- SubSeal Liquid Membrane
- Strataflex Sheet Membrane (If Required)
- NAC Primer
- NAC Approved Urethane Sealant

Detail refers to B422 for shower receptors. See current edition of the TCNA Handbook for additional guidelines.

Visit [NACproducts.com](http://NACproducts.com) or call 800-633-4622 for more information.



[www.nacproducts.com](http://www.nacproducts.com)

©2023 National Applied Construction Products, Inc. All rights reserved. Rev 6/23 #B422-NAC