

NARWAL™

User's Manual

Automatic Water Exchange Module for
Narwal Freo Robot Vacuum and Mop



WARNINGS

- To avoid water leakage, please use a dedicated pipe cutter and avoid bending the pipe.
- To avoid electric shocks, please connect the water supply BEFORE connecting the electricity.
- Please ensure the self-test has been properly completed before using the module.

Product Components

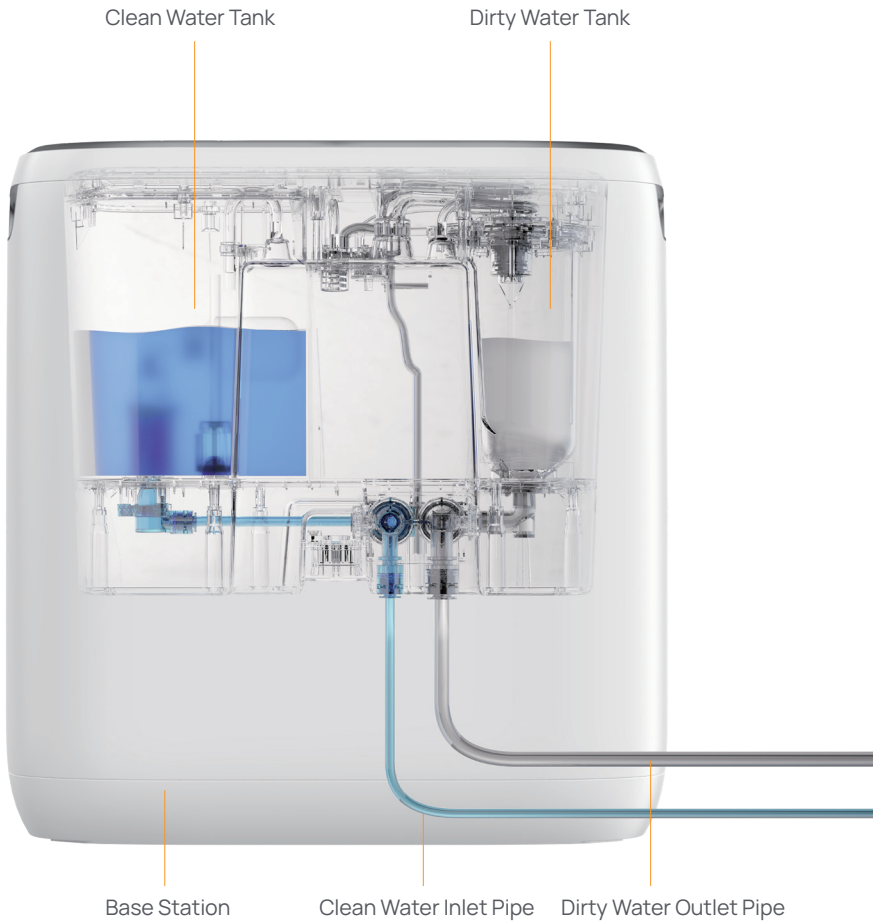

Package Contents

Main Unit

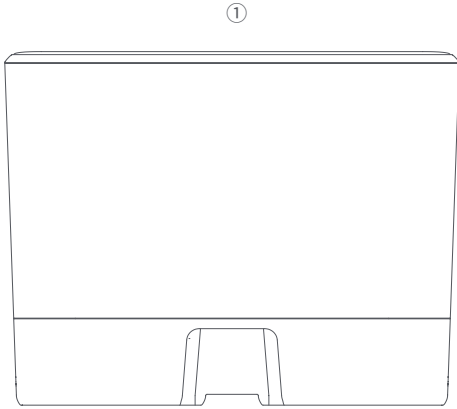

Automatic Water Exchange Module*1

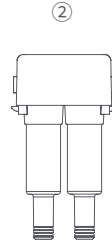

Water Pipe Adapter*1

Standard Accessories

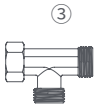

Clean Water T-joint*1



Clean Water Filter *1

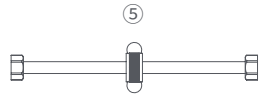

Explosion-proof Pipe*1

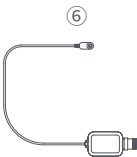

Control Box*1



Clean Water Pipe*6m



Dirty Water Pipe*6m

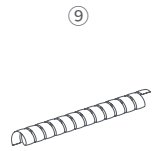

Decorative Pipe*1

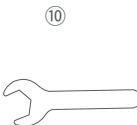

Wrench*1



Cable organizer*1

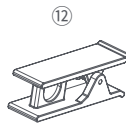

Pipe cutter*1



Cable tie

Instruction of the pipeline installation

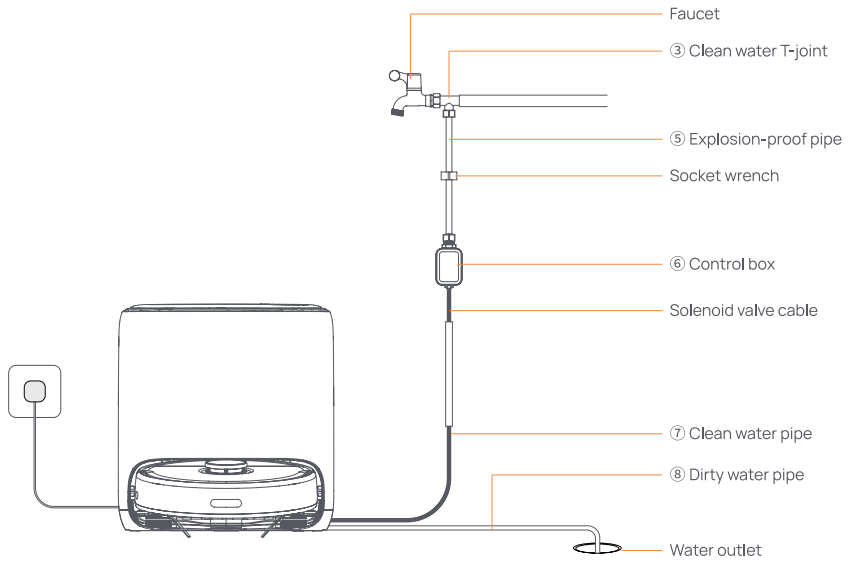

Installing the water pipeline

Installation Environment

1. Ensure that the pipeline distance between the water supply and the base station is $\leq 19.7\text{ft}$ to ensure a reliable connection between them. At the same time, ensure that the pipeline distance between the dirty water outlet and the base station is $\leq 19.7\text{ft}$, and the whole height of the dirty water pipe from the ground is $\leq 2.6\text{ft}$ to ensure smooth drainage.
2. PT 1/2-14 should be used at the connection of the water supply. Otherwise, please purchase a compatible adapter to obtain the desired size.
3. The pressure of the water supply should range from 0.14 MPa to 0.8 MPa. It is recommended to add a booster pump when the pressure is below this value range or add an extra pressure relief valve when the pressure is above this value range.
4. Do not use pipe valves prone to rusting or leakage at the water source to avoid water leakage during operation.

Installing the clean water T-joint^③ and explosion-proof pipe^⑤

1. Turn off the water supply.
2. Locate the installation place and select the best installation option according to the specific conditions. (Refer to the figure below)
3. Remove the faucet, angle valve, or other water supply joints with the wrench supplied.
4. Check whether the filter inside the T-joint is properly installed, and then install the T-joint onto the water supply joint with the wrench.
5. Make sure that the filter^④ is installed inside the clean water T-joint and it is on the side where water enters the T-joint^③.
6. Use the socket wrench on the explosion-proof pipe^⑤ to tighten the clean water T-joint^③.

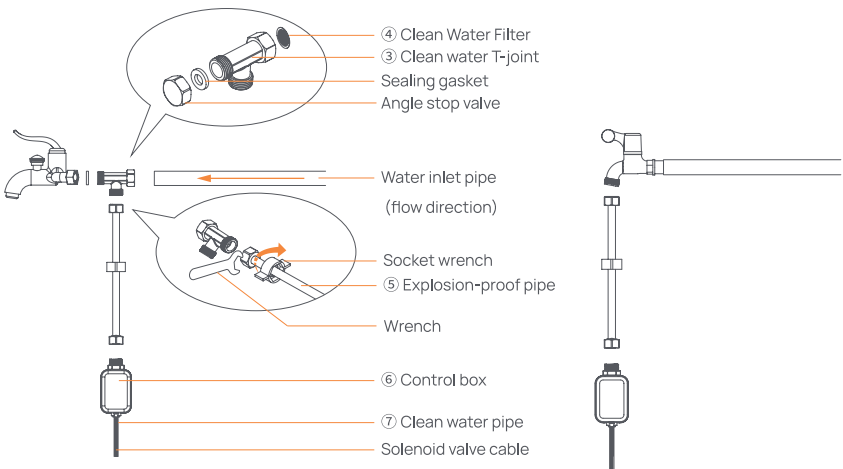

Option ①: The female thread end is connected to the water supply, and the male thread end is installed with 1/2 dual-female thread coupling and connected to the faucet.

Option ②: The female thread end is connected to the outlet pipe of the faucet, and the male thread end is connected to the water fitting of the washing machine.

Installing the control box

1. Check that the filter is installed in the inlet pipe of the control box^⑥.
2. Connect the other end of the explosion-proof pipe^⑤ to the male thread end of the control box^⑥.
3. Use the socket wrench on the explosion-proof pipe^⑤ to tighten it clockwise.

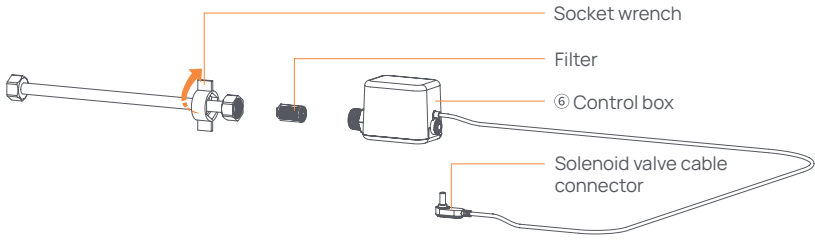

Installing the automatic water exchange unit

1. Open the top lid of the base station and remove the dirty water tank and clean water tank.



2. First, remove the cover of the pin and blowhole protection.

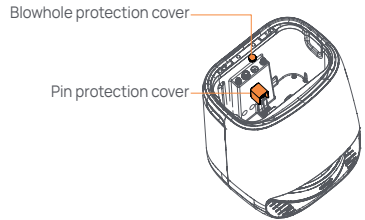

3. Pry off the rear protection cover by with your hand or a screwdriver.

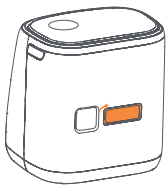

4. Insert the screwdriver into the inlet pipe and outlet pipe of the base station until the inner protection cover comes out.

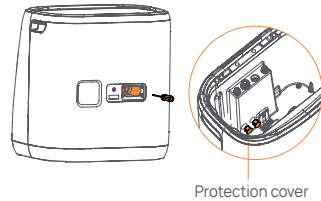

5. Place the automatic water exchange module vertically into the base station along the rear panel to ensure proper installation.

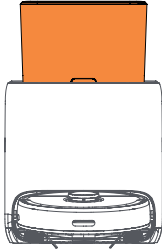

6. Pack the spare parts into the base station for further use.

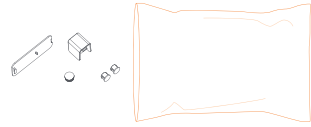

Installing the pipeline

1. Insert the clean water pipe firmly into the quick connector of the control box until the marker line disappears. (If the marker line is still visible, the clear water pipe is not installed properly.)

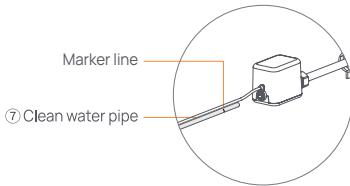

2. Determine the length of the dirty water pipe based on the position of the sewage outlet, and then cut off the excess part of the pipe with the pipe cutter. (Sewage discharge may be affected if the pipeline is too long.)



3. Connect the other ends of the clean water pipe ⑦ and dirty water pipe ⑧ to the corresponding adapters and insert the pipes until the marker line cannot be seen.

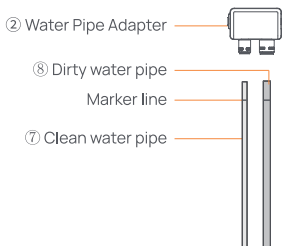

4. Insert the adapter ② into the base station until you hear a click. (Check the condition of the O-ring before connecting. For your convenience, moderately apply the neutral cleaning liquid to the O-ring for lubrication purposes)

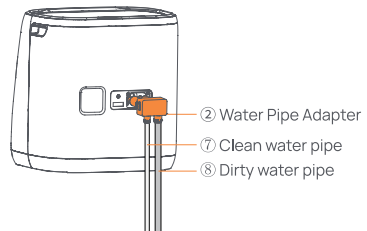

5. Connect the solenoid valve cable of the control box to the back of the base station. (Secure the dirty water pipe with a cable tie to prevent it from slipping out of the sewage outlet.)

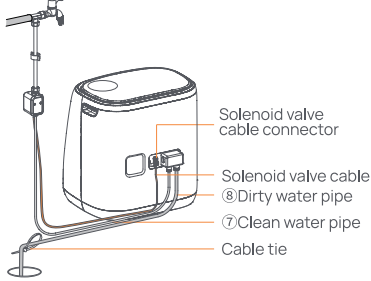

6. Use the cable clip to wrap the clean water pipe and dirty water pipe into the storage pipe as illustrated, and cut off any excess parts of the storage pipe.

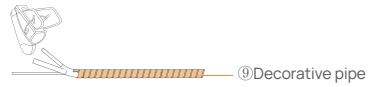

Installation Self-test

1. Make sure the power supply is reliably connected and there is enough space around it.

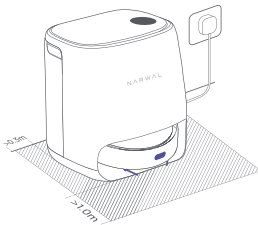

2. Swipe "-" down on the homepage to access the drop-down setup menu.

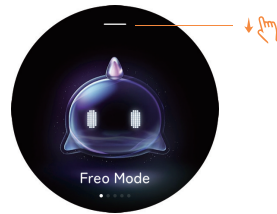

3. Swipe to the "Automatic Water Change Self-test" function and click "Confirm" on the right to start the self-test.



4. After all checks are completed, the page displays "Automatic Water Change Completed". If there is any abnormality, check the corresponding position according to the on-screen instructions.

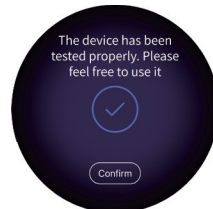

Accessories Maintenance

Filter Maintenance

1. Turn off the water supply, and unscrew the explosion-proof pipe with a socket wrench in the direction shown in the figure below.
2. Remove the filter from the connector of the control box, and rinse it with clean water.
3. Reinstall the filter. Tighten the explosion-proof pipe with the socket wrench to ensure it is securely connected. Then open the clean water valve.

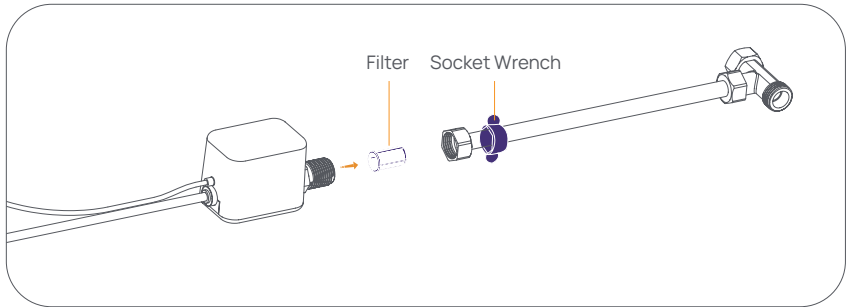

Duckbill Valve Maintenance

1. Take out the drain cleaning stick under the top lid of the automatic water exchange module.
2. Press the button on the quick adapter to pull out the water pipe adapter.
3. Insert the drain cleaning stick in the outlet and out. Repeat it 3-5 times.
4. Reinstall the quick connector and the drain cleaning stick.

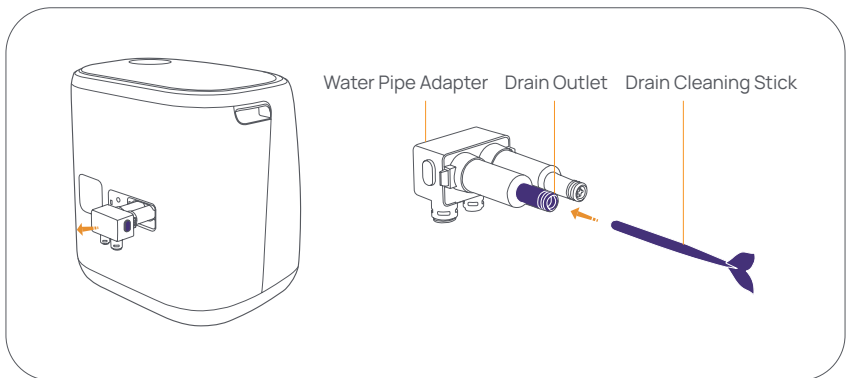

Notes

Before installing/removing the automatic water exchange module, make sure that it is off the power.

Specifications

Model: YJMA002	Dimensions: 335*110*260mm	Weight: approx. 1.2 kg	Color: white	Maximum pressure of inlet water: 1.0 MPA
----------------	------------------------------	---------------------------	--------------	---

Error Codes and Prompts

If there is an error with the automatic water exchange unit, please check the error code on the screen and the corresponding troubleshoot shown in the table below.

Error Code	Base Station Touchscreen Prompt	Robot Voice Prompt	Solution
3000	Automatic water exchange module error. Scan the code for help.	Automatic water exchange module error. Scan the code for help.	1. Check if the water supply is turned off. 2. Check if the pipeline is damaged or leaking. 3. Check if the filter in the clean water tank is blocked.
3001	Automatic water exchange module error. Scan the code for help.	Automatic water exchange module error. Scan the code for help.	Please contact the after-sales service.
3002	Automatic water exchange module error. Scan the code for help.	Automatic water exchange module error. Scan the code for help.	1. Check if the cleaning components are blocked. 2. Check if the dirty water duckbill valve is completed closed. 3. Check if the pipeline is blocked (difficult for the user to troubleshoot). 4. Check if the ventilation valve doesn't work. (cannot be troubleshoot by the user)
3003	Automatic water exchange module error. Scan the code for help.	Automatic water exchange module error. Scan the code for help.	Please contact the after-sales service.

3004	No waterpipe control module detected. Reinstall it properly.	No waterpipe control module detected. Reinstall it properly.	<ol style="list-style-type: none"> 1. Check if the waterpipe control module is correctly installed on the clean water pipe. 2. Check if all valves of the clean water pipe are opened and the house's water supply is enabled. 3. If the error persists, please contact the after-sales service.
3005	Water spray system error. Scan the code for help.	Water spray system error. Scan the code for help.	<ol style="list-style-type: none"> 1. Check if the clean water pipe is properly connected. 2. Check if all valves of the clean water pipe are opened and the house's water supply is enabled. 3. If the error persists, please contact the after-sales service.
3006	Automatic water exchange module error. Scan the code for help.	Automatic water exchange module error. Scan the code for help.	<ol style="list-style-type: none"> 1. Check if the cleaning components are blocked. 2. Check if the dirty water duckbill valve is completely closed. 3. Check if the pipeline is blocked (difficult for the user to troubleshoot). 4. Check if the ventilation valve doesn't work (cannot be troubleshooted by the user)
3007	Pumping system error. Check the quick connector.	Automatic water exchange module error. Scan the code for help.	Please contact the after-sales service.
3008	Drainage system error. Check the dirty water pipe.	Automatic water exchange module error. Scan the code for help.	<ol style="list-style-type: none"> 1. Please check if the dirty water pipe is bent or pressed by a heavy object. 2. Use the drain cleaning stick to dredge the duckbill valve in the quick connector. 3. If the error persists, please contact the after-sales service.

Warranty Policy • for products purchased in the US only

IMPORTANT: Narwal offers a Limited Warranty which does not affect your statutory rights under the laws relating to the sale of consumer products. This Limited Warranty only applies to Narwal products you purchased in the United States (US) from Narwal or its authorized retailers for your own use and not for resale.

Any updates to this Policy will be posted on Narwal.com and we encourage you to periodically review this Policy to ensure you are familiar with the most current version. If there is any inconsistency between this Policy on Narwal.com and any other documents included with or relating to Narwal products, the latest version of this Policy on Narwal.com shall govern.

These Policies are available in other languages at Narwal.com. In the event of a conflict between different translations of these terms, the English version shall prevail.

One (1) Year Limited Warranty

Under this Limited Warranty, Narwal warrants that each Narwal product that you purchase will be free from material and workmanship defects under normal use in accordance with Narwal's published product materials during the period of one (1) year from the date of delivery (the "Warranty Period"). Narwal's published product materials include, but not limited to, user manuals, specifications, in-app notifications, and service communications.

How to Obtain Warranty Service

If a product does not function as warranted during the warranty period, please contact us at support@narwal.com or submit your request through Narwal.com. You will need to provide the serial number of your Product and the original invoice or receipt showing the date of purchase and all details of the Product for the after-sales service.

Please note that the warranty service is only available in the respective Narwal service regions where you purchased your Narwal product.

What Will Narwal Do

If your request is received within the Warranty Period and the Product is found to have failed to function as warranted, Narwal will, at our option:

- repair the Product using new or refurbished parts that are equivalent to new in performance and reliability, or
- exchange the Product with a product that is new or which has been manufactured from new or refurbished parts and is at least functionally equivalent to the original product, or
- exchange the Product with a product that is new and upgraded model which has at least equivalent or upgraded function to the original product.

Where permitted by applicable laws, the Warranty Period will not be extended or updated or otherwise affected by subsequent replacement, resale, repair or replacement of the product. Parts repaired or replaced during the Warranty Period will be warranted for the remainder of the original warranty period. The replaced or repaired product, as applicable, will be returned to you as soon as it is commercially feasible. All parts of the product or other equipment that we replace will become our property.

To resolve the problem, you understand that you may be required to deliver the product to Narwal for further examination. We will arrange for repair or replacement service at no cost if the problem falls under this Limited Warranty. (notice : If you have taken the products to regions outside the US, we will not bear the international freight, transportation charge, customs and other costs of transporting the relevant products to the US, and the above costs and related risks are borne by

you; Moreover, we are not responsible for sending the repaired or replaced products to regions outside the US.) If it is found that the product is not covered by this Limited Warranty, we (and our authorized service company) reserve the right to charge the cost of postage, labour and materials. When repairing or replacing products, we may use new, equivalent to new or refurbished products or parts.

WHAT' S NOT COVERED

Unless agreed in writing, the Limited Warranty will not apply if the defect(s) relate to:

- (a) normal wear and tear (including, without limitation, wear and tear of batteries),
- (b) defects caused by rough or inappropriate handling or use or damage caused by accident, misuse, neglect, fire, water, lightning or other acts of nature,
- (c) the fact that the battery has been short-circuited, if the seals of the battery enclosure or the cells are broken or show evidence of tampering or if the battery has been used in equipment other than those for which it has been specified,
- (d) non-compliance with the Product instructions,
- (e) willful or deliberate damage, neglect or negligence,
- (f) use of spare parts or other replacement items (including consumables) which are not provided or recommended by us,
- (g) any alteration or modification to the Product which has been carried out by you or a third party not authorized by us,
- (h) any failure to adequately package the Product for transportation,
- (i) extreme or external causes beyond our reasonable control including, but not limited to, breakdowns, fluctuations, or interruptions in electric power, ISP (internet service provider) service, or wireless networks,
- (j) weak and/or inconsistent wireless signal strength in your home,
- (k) any Product(s) purchased from unauthorized distributors.

This Limited Warranty does not apply to consumable items. Please find a list of such consumable items at Narwal.com.

This Limited Warranty will be invalid if (a) the Product's serial number has been removed, erased, defaced, altered or is illegible in any way (as determined in our sole discretion), or (b) you are in breach of the terms of this Limited Warranty or your contract with us.

LIMITATION OF LIABILITY

THIS LIMITED WARRANTY IS YOUR SOLE AND EXCLUSIVE REMEDY AGAINST NARWAL AND NARWAL'S SOLE AND EXCLUSIVE LIABILITY IN RESPECT OF DEFECTS IN YOUR PRODUCT. THIS LIMITED WARRANTY REPLACES ALL OTHER NARWAL WARRANTIES AND LIABILITIES, WHETHER ORAL, WRITTEN, (NON-MANDATORY) STATUTORY, CONTRACTUAL, IN TORT OR OTHERWISE, INCLUDING, WITHOUT LIMITATION, AND WHERE PERMITTED BY APPLICABLE LAW TO THE MAXIMUM EXTENT, ANY IMPLIED CONDITIONS, WARRANTIES OR OTHER TERMS AS TO SATISFACTORY QUALITY OR FITNESS FOR PURPOSE. HOWEVER, THIS LIMITED WARRANTY SHALL NEITHER EXCLUDE NOR LIMIT ANY OF YOUR LEGAL (STATUTORY) RIGHTS UNDER THE APPLICABLE NATIONAL LAWS.

TO THE MAXIMUM EXTENT PERMITTED BY APPLICABLE LAW(S) NARWAL DOES NOT ASSUME ANY LIABILITY FOR LOSS OF OR DAMAGE TO OR CORRUPTION OF DATA, FOR ANY LOSS OF PROFIT, LOSS OF USE OF PRODUCTS OR FUNCTIONALITY, LOSS OF BUSINESS, LOSS OF CONTRACTS, LOSS OF REVENUES OR LOSS OF ANTICIPATED SAVINGS, INCREASED COSTS OR EXPENSES OR FOR ANY INDIRECT LOSS OR DAMAGE, CONSEQUENTIAL LOSS OR DAMAGE OR SPECIAL LOSS OR DAMAGE.

TO THE EXTENT PERMITTED BY APPLICABLE LAW, NARWAL'S LIABILITY SHALL BE LIMITED TO THE PURCHASE VALUE OF THE PRODUCT. THE ABOVE LIMITATIONS SHALL NOT APPLY IN CASE OF GROSS NEGLIGENCE OR INTENTIONAL MISCONDUCT OF NARWAL OR IN CASE OF DEATH OR PERSONAL INJURY RESULTING FROM NARWAL'S PROVEN NEGLIGENCE.

Should you have any issue unsolved, do not hesitate to contact us at support@narwal.com

Warranty Policy • for products purchased in Canada only

IMPORTANT: Narwal offers a Limited Warranty which does not affect your statutory rights under the laws relating to the sale of consumer products. This Limited Warranty only applies to Narwal products you purchased in Canada from Narwal or its authorized retailers for your own use and not for resale.

Any updates to this Policy will be posted on Narwal.com and we encourage you to periodically review this Policy to ensure you are familiar with the most current version. If there is any inconsistency between this Policy on Narwal.com and any other documents included with or relating to Narwal products, the latest version of this Policy on Narwal.com shall govern.

These Policies are available in other languages at Narwal.com. In the event of a conflict between different translations of these terms, the English version shall prevail.

One (1) Year Limited Warranty

Under this Limited Warranty, Narwal warrants that each Narwal product that you purchase will be free from material and workmanship defects under normal use in accordance with Narwal's published product materials during the period of one (1) year from the date of delivery (the "Warranty Period"). Narwal's published product materials include, but not limited to, user manuals, specifications, in-app notifications, and service communications.

How to Obtain Warranty Service

If a product does not function as warranted during the warranty period, please contact us at support@narwal.com or submit your request through Narwal.com. You will need to provide the serial number of your Product and the original invoice or receipt showing the date of purchase and all details of the Product for the after-sales service.

Please note that the warranty service is only available in the respective Narwal service regions where you purchased your Narwal product.

What Will Narwal Do

If your request is received within the Warranty Period and the Product is found to have failed to function as warranted, Narwal will, at our option:

- repair the Product using new or refurbished parts that are equivalent to new in performance and reliability, or
- exchange the Product with a product that is new or which has been manufactured from new or refurbished parts and is at least functionally equivalent to the original product, or
- exchange the Product with a product that is new and upgraded model which has at least equivalent or upgraded function to the original product.

Where permitted by applicable laws, the Warranty Period will not be extended or updated or otherwise affected by subsequent replacement, resale, repair or replacement of the product. Parts repaired or replaced during the Warranty Period will be warranted for the remainder of the original warranty period. The replaced or repaired product, as applicable, will be returned to you as soon as it is commercially feasible. All parts of the product or other equipment that we replace will become our property.

To resolve the problem, you understand that you may be required to deliver the product to Narwal for further examination. We will arrange for repair or replacement service at no cost if the problem falls under this Limited Warranty. (notice: If you have taken the products to regions outside Canada, we will not bear the international freight, transportation charge, customs and other costs of transporting the relevant products to Canada, and the above costs and related risks are

borne by you; Moreover, we are not responsible for sending the repaired or replaced products to regions outside Canada.) If it is found that the product is not covered by this Limited Warranty, we (and our authorized service company) reserve the right to charge the cost of postage, labour and materials. When repairing or replacing products, we may use new, equivalent to new or refurbished products or parts.

WHAT' S NOT COVERED

Unless agreed in writing, the Limited Warranty will not apply if the defect(s) relate to:

- (a) normal wear and tear (including, without limitation, wear and tear of batteries),
 - (b) defects caused by rough or inappropriate handling or use or damage caused by accident, misuse, neglect, fire, water, lightning or other acts of nature,
 - (c) the fact that the battery has been short-circuited, if the seals of the battery enclosure or the cells are broken or show evidence of tampering or if the battery has been used in equipment other than those for which it has been specified,
 - (d) non-compliance with the Product instructions,
 - (e) willful or deliberate damage, neglect or negligence,
 - (f) use of spare parts or other replacement items (including consumables) which are not provided or recommended by us,
 - (g) any alteration or modification to the Product which has been carried out by you or a third party not authorized by us,
 - (h) any failure to adequately package the Product for transportation,
 - (i) extreme or external causes beyond our reasonable control including, but not limited to, breakdowns, fluctuations, or interruptions in electric power, ISP (internet service provider) service, or wireless networks,
 - (j) weak and/or inconsistent wireless signal strength in your home,
 - (k) any Product(s) purchased from unauthorized distributors.
- This Limited Warranty does not apply to consumable items. Please find a list of such consumable items at Narwal.com.

This Limited Warranty will be invalid if (a) the Product's serial number has been removed, erased, defaced, altered or is illegible in any way (as determined in our sole discretion), or (b) you are in breach of the terms of this Limited Warranty or your contract with us.

LIMITATION OF LIABILITY

THIS LIMITED WARRANTY IS YOUR SOLE AND EXCLUSIVE REMEDY AGAINST NARWAL AND NARWAL'S SOLE AND EXCLUSIVE LIABILITY IN RESPECT OF DEFECTS IN YOUR PRODUCT. THIS LIMITED WARRANTY REPLACES ALL OTHER NARWAL WARRANTIES AND LIABILITIES, WHETHER ORAL, WRITTEN, (NON-MANDATORY) STATUTORY, CONTRACTUAL, IN TORT OR OTHERWISE, INCLUDING, WITHOUT LIMITATION, AND WHERE PERMITTED BY APPLICABLE LAW TO THE MAXIMUM EXTENT, ANY IMPLIED CONDITIONS, WARRANTIES OR OTHER TERMS AS TO SATISFACTORY QUALITY OR FITNESS FOR PURPOSE. HOWEVER, THIS LIMITED WARRANTY SHALL NEITHER EXCLUDE NOR LIMIT ANY OF YOUR LEGAL (STATUTORY) RIGHTS UNDER THE APPLICABLE NATIONAL LAWS.

TO THE MAXIMUM EXTENT PERMITTED BY APPLICABLE LAW(S) NARWAL DOES NOT ASSUME ANY LIABILITY FOR LOSS OF OR DAMAGE TO OR CORRUPTION OF DATA, FOR ANY LOSS OF PROFIT, LOSS OF USE OF PRODUCTS OR FUNCTIONALITY, LOSS OF BUSINESS, LOSS OF CONTRACTS, LOSS OF REVENUES OR LOSS OF ANTICIPATED SAVINGS, INCREASED COSTS OR EXPENSES OR FOR ANY INDIRECT LOSS OR DAMAGE, CONSEQUENTIAL LOSS OR DAMAGE OR SPECIAL LOSS OR DAMAGE.

TO THE EXTENT PERMITTED BY APPLICABLE LAW, NARWAL'S LIABILITY SHALL BE LIMITED TO THE PURCHASE VALUE OF THE PRODUCT. THE ABOVE LIMITATIONS SHALL NOT APPLY IN CASE OF GROSS NEGLIGENCE OR INTENTIONAL MISCONDUCT OF NARWAL OR IN CASE OF DEATH OR PERSONAL INJURY RESULTING FROM NARWAL'S PROVEN NEGLIGENCE.

Should you have any issue unsolved, do not hesitate to contact us at support@narwal.com

Product Warranty Card

User Name	
Address	
Phone No.	
Product Name and Model Model	
Serial Number	
Purchase Date	

Maintenance records

	Maintenance Date	Fault Description and part Replacement	Maintenance Center	Maintenance Engineer
1				
2				
3				

Manufacturer: Yunjing Intelligence Innovation (Shenzhen) Co., Ltd.
Address: Room A2901, Yunzhongcheng, Building 1, Vanke Yuncheng VI, Dashi 2nd Road, Xili Community, Xili Street, Nanshan District, Shenzhen, Guangdong, China
Email: support.au@narwal.com



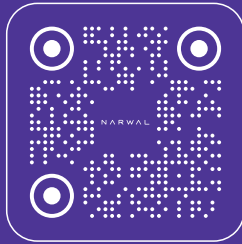

WWW.NARWAL.COM