

EASY-FOLD HIGH CHAIR



INSTRUCTION MANUAL

24601

**ADULT ASSEMBLY REQUIRED
STYLES AND COLORS MAY VARY**



**⚠ WARNING:
CHOKING HAZARD**

Adult assembly required because of small parts. Keep assembly parts out of reach of children under 3 years.

**Read all instructions BEFORE assembly and USE of product
KEEP INSTRUCTIONS FOR FUTURE USE.**

Customer Experience Center
phone: (646)-435-8726
email: gcs@DeltaChildren.com



www.DeltaChildren.com

DCP-IM-06292018-F2

WARNING

READ ALL INSTRUCTIONS BEFORE ASSEMBLY AND USE OF HIGH CHAIR. KEEP INSTRUCTIONS FOR FUTURE USE. INCORRECT ASSEMBLY MAY MAKE THE HIGH CHAIR UNSAFE. FAILURE TO FOLLOW THESE WARNINGS AND INSTRUCTIONS COULD RESULT IN SERIOUS INJURY OR DEATH.

WARNING

FALL HAZARD: Children have suffered severe head injuries including skull fractures when falling from high chairs. Falls can happen suddenly if child is not restrained properly.

- Always use restrains, and adjust to fit snugly – see instructions for proper use.
- Tray is not designed to hold child in chair.
- Stay near and watch child during use.
- Use only by a child capable of sitting upright unassisted.

DCP06262018-F2-1

- **▲ WARNING!** Stay near and watch child during use.
- **▲ WARNING! DO NOT** use until the child can sit up unaided.
- **▲ WARNING! DO NOT** use unless all components are correctly fitted and adjusted.
- **▲ WARNING!** Make sure that restraint system is correctly fitted and snug to the child. Only use in a flat stable surface. Ensure product is fully erected before placing your child inside. Ensure children are clear of all moving parts before making any adjustments.
- **▲ WARNING! NEVER** move the high chair with your child inside.
- **▲ WARNING! DO NOT** allow your child to climb unassisted into, play with or hang onto this product. This is not a toy.
- **▲ WARNING! IMPORTANT!** Read all instructions before assembly and use of the product and inspect the product for damaged hardware, loose joints, missing parts or sharp edges. **DO NOT** use if any parts are missing or broken. Failure to follow these warnings and instructions could result in serious injury or death. Contact Delta Children's Products Customer Service Department at 646-435-8726 for replacement parts and instructions if needed. Never substitute parts.

CARE AND MAINTENANCE

- Ensure all locking devices work correctly and regularly check the locks and fittings for security.
- Regularly check all parts for wear and tear.
- For best results tray can be hand washed using a damp cloth and mild detergent.
- Seat pad should be hand washed using a damp cloth and mild detergent.



Please DO NOT return this product to the store .

If you experience any difficulty with assembly, missing parts or use, please DO NOT return this item to the store. Retail stores are unable to properly assist you. Contact our Customer Service Department directly for assistance
646-435-8726



www.DeltaChildren.com • gcs@DeltaChildren.com
©2018 Delta Children's Products, Inc. New York, NY 10001



EXTENDED WARRANTY

DON'T MISS YOUR CHANCE TO BE COVERED FOR ALL OF LIFE'S MISHAPS!

With Delta's Extended Warranty, you're covered for mechanical failure from normal use or if your item stops working due to normal wear and tear, plus all those unexpected surprises.

2 YEARS OF PROTECTION

For Additional Information:

Simply visit our Website, register your product, and add the Extended Warranty

<https://www.deltachildren.com/pages/product-registration>

Extended Warranty only available in the following States: Arkansas, Colorado, Delaware, District of Columbia, Georgia, Idaho, Illinois, Indiana, Iowa, Kansas, Kentucky, Louisiana, Maryland, Michigan, Mississippi, Missouri, Nebraska, Nevada, New Hampshire, New York, North Carolina, North Dakota, Pennsylvania, Rhode Island, South Dakota, Tennessee, Utah, West Virginia

Parts

IMPORTANT! Please remove all parts from the package and identify them before assembly.

IMPORTANT! Before assembly and each use, inspect this product for damaged hardware, loose joints, missing parts, or sharp edges. NEVER use if any parts are missing or broken. Contact manufacturer for replacement parts and instructions if needed. Never substitute parts. **IMPORTANT!** Adult assembly is required.

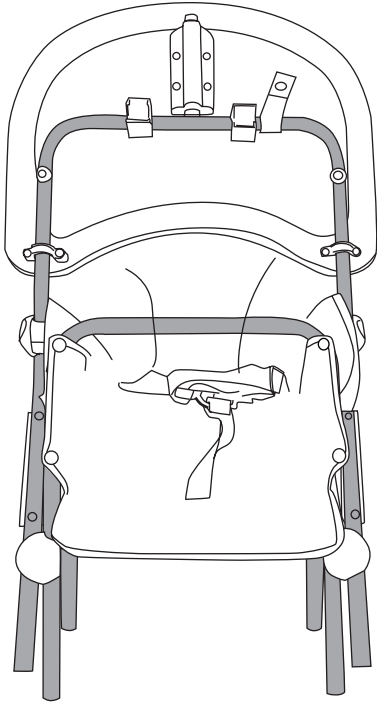

High Chair with Tray

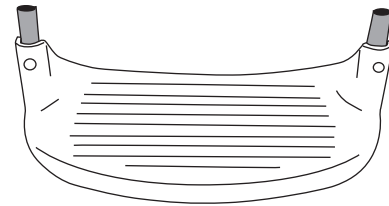

Foot Rest
Part # 50465

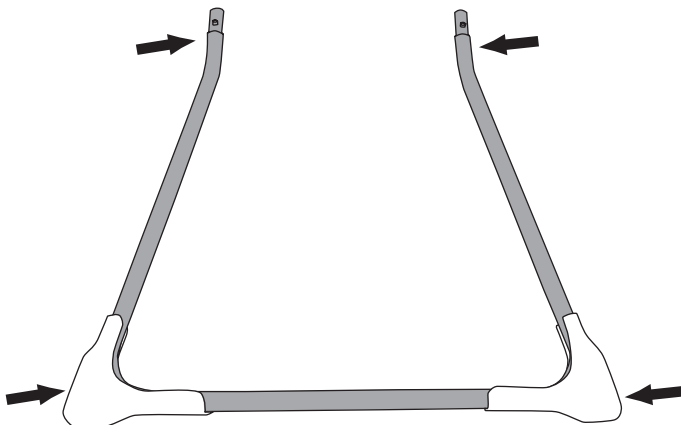

Rear Leg (narrower leg)
Part # 50466

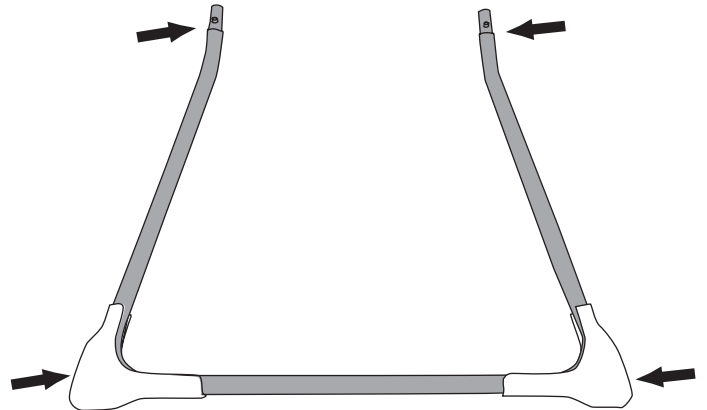

Front Leg (wider leg)
Part # 50467

Assembly

1 Front Leg Attachment

First, position high chair body flat on the floor, with back of tray facing upward. Press the left/right front legs into its housing until you hear it "CLICK". (Fig. 1a) Pull legs gently outward to make sure it is in a fully locked position.

Fully locked position

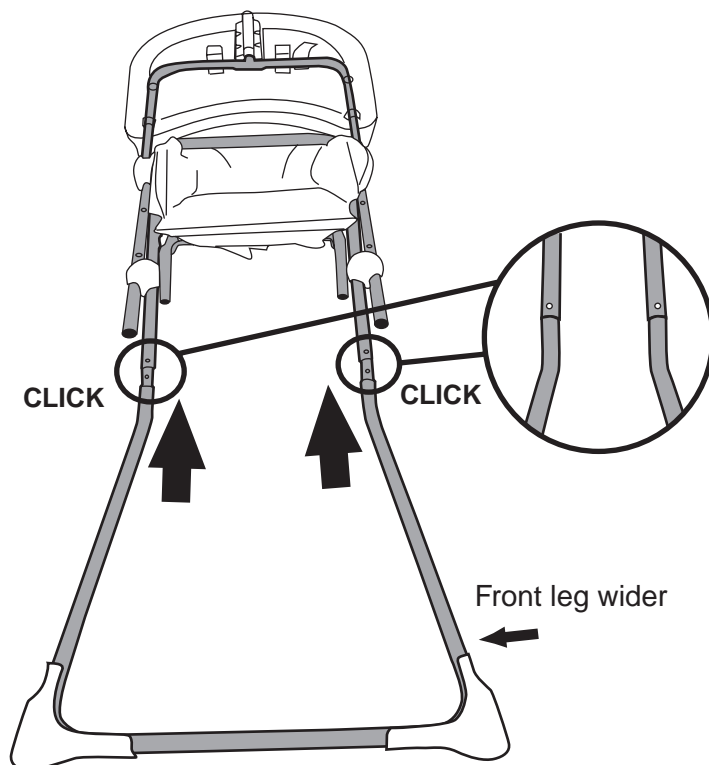
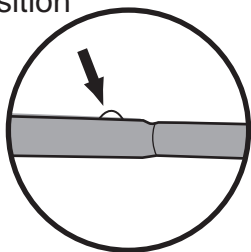

Fig. 1a

2 Rear Leg Attachment

To attach rear legs, flip high chair over, with the back seat facing upward. Press the rear left/right legs into its housing until you hear it "CLICK". (Fig. 1b) Pull legs gently outward to make sure it is in a fully locked position.

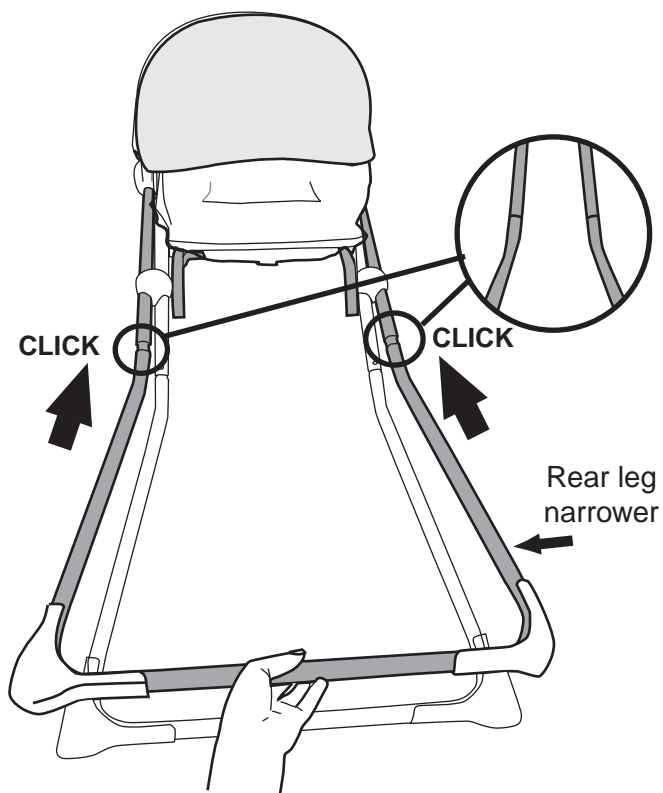

Fig. 1b

Assembly

Assembling Foot Rest

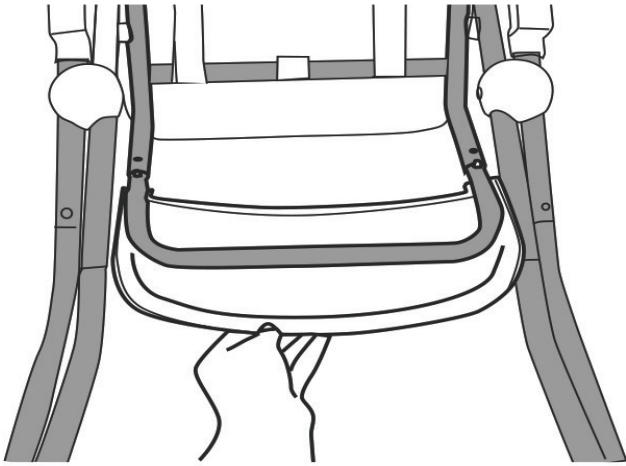

Fig. 2a

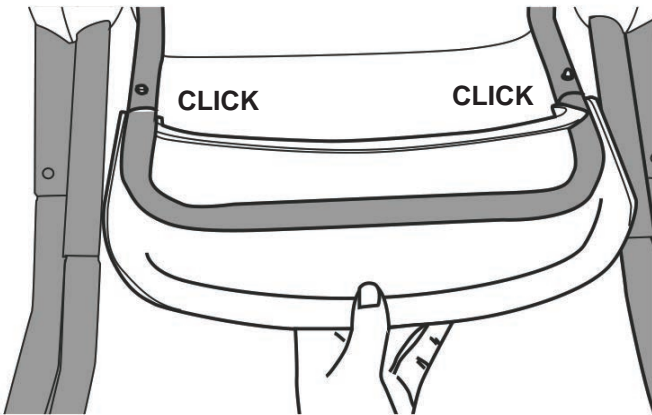
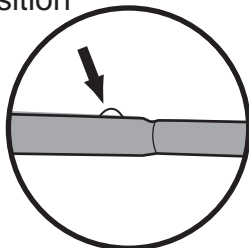

Fig. 2b

1

To assemble the foot rest, keep back of seat facing upward on the ground. Push foot rest in tubes located under the seat. (Fig. 2a) Push until you hear a "CLICK". (Fig. 2b) Pull the foot rest gently outward to make sure it is in a locked position.

Fully locked position



Opening High Chair

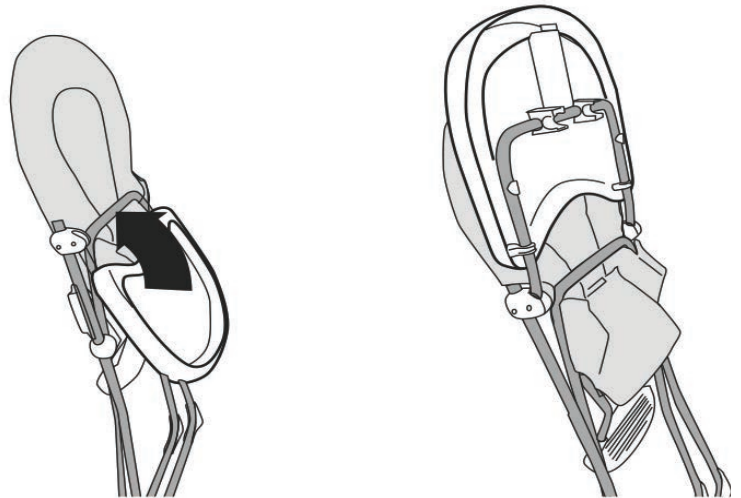

1

Lift and rotate tray into an upward position.

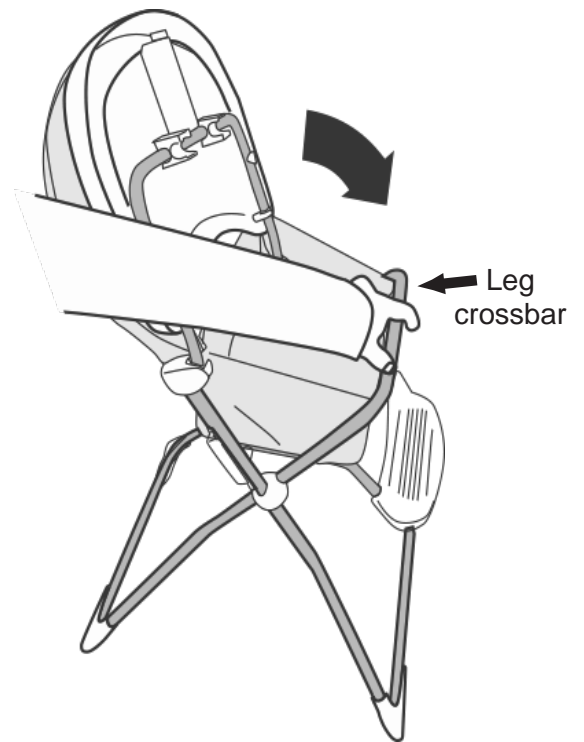

2

Rotate the leg crossbar outward into a fully open position.

Assembly

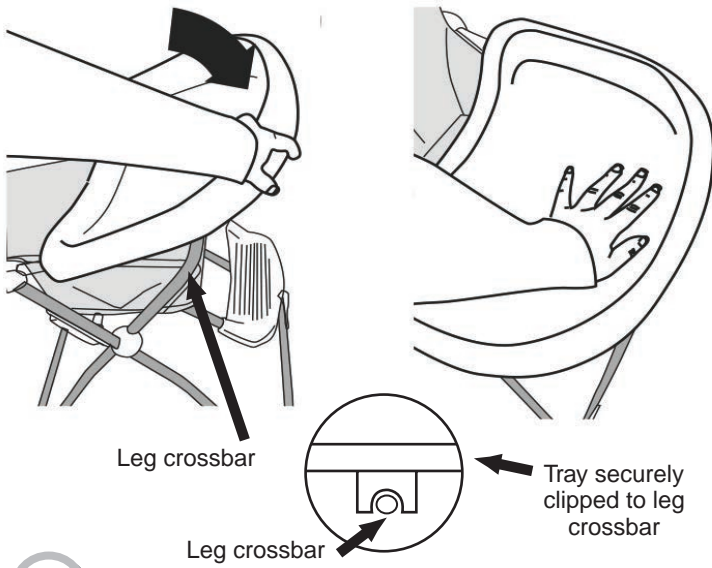

3

Lower the tray and securely clip it to the leg crossbar. Pull tray gently upward to make sure it is in a fully locked position.

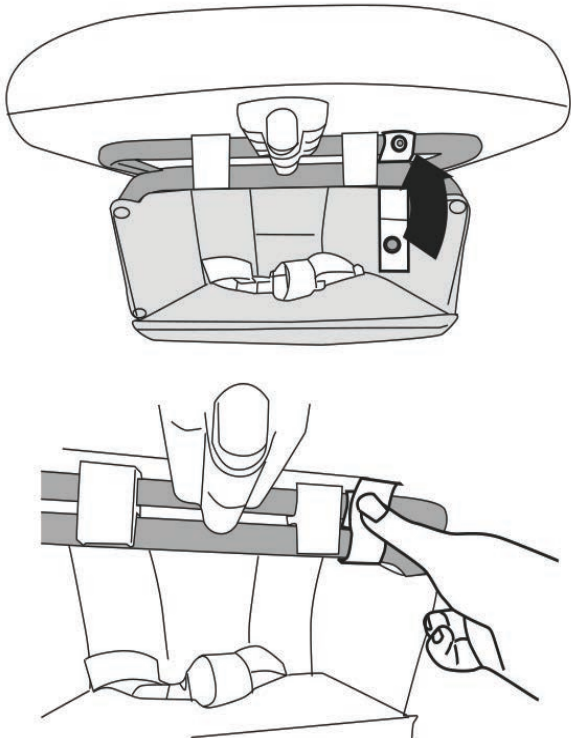

4

Under the tray, snap the strap up around the top of the leg crossbar.

Securing Child

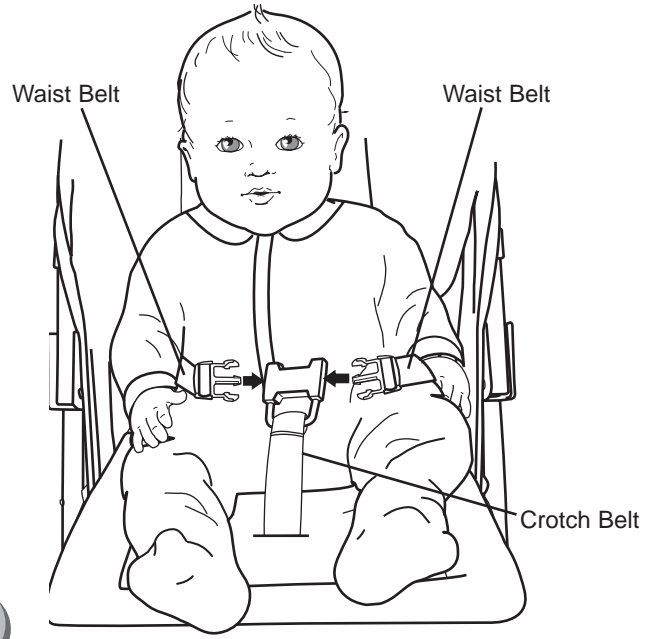

1

Securing Child

- Place your child in the high chair. Position the crotch belt between your child's legs.
- Fasten both waist belts to the buckle on each side of the crotch belt. Make sure you hear a "click" on both sides.
- Check to be sure the restraint system is securely attached by pulling it away from your child. The restraint system should remain attached.

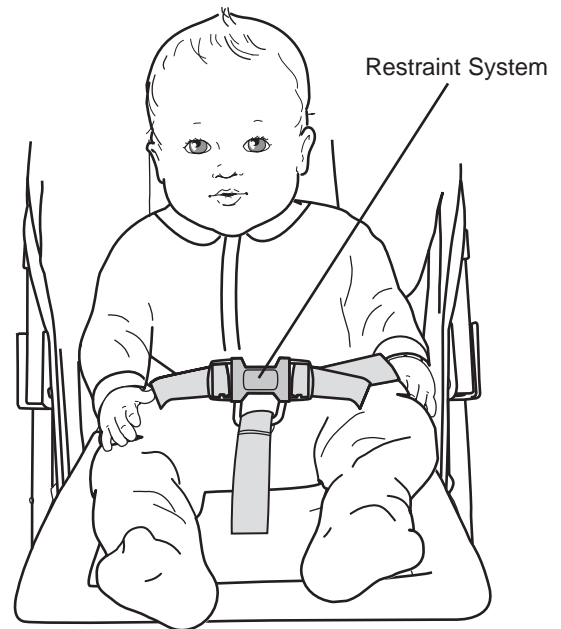

2

Tighten each waist belt so that the restraint system is snug against your child. Please refer to the next section for instructions to tighten the waist belts.

Securing Child

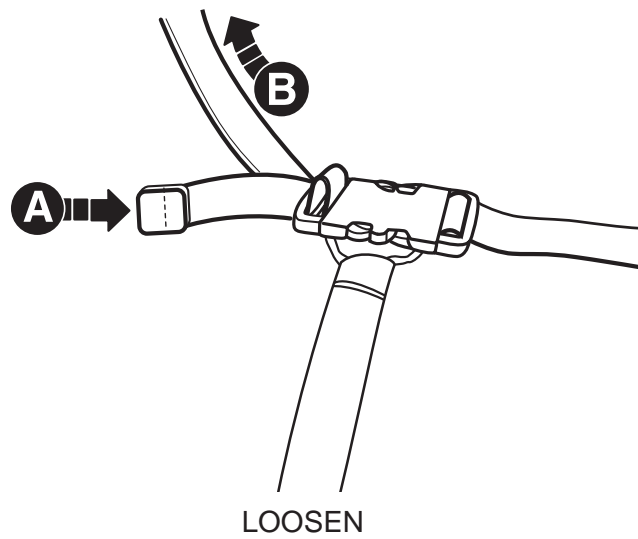
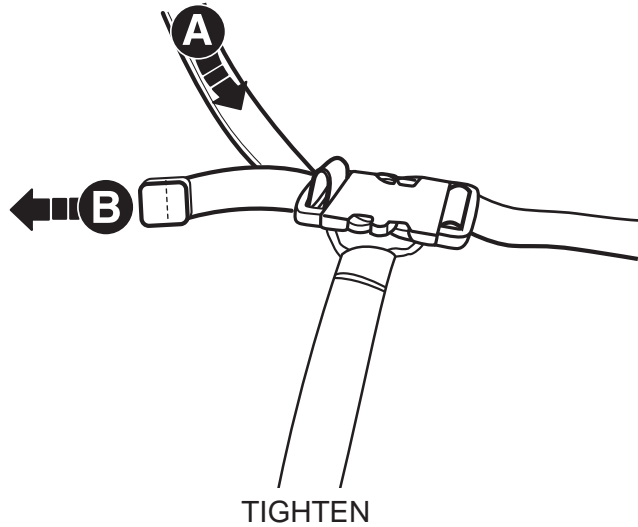

3

To tighten the waist belts:

- Feed the anchored end of a waist belt up through the buckle to form a loop **A**. Pull the free end of the waist belt **B**.
- Repeat this procedure to tighten the other waist belt.

To loosen the waist belts:

- Feed the free end of the waist belt up through the buckle to form a loop **A**. Enlarge the loop by pulling on the end of the loop toward the buckle. Pull the anchored end of the waist belt to shorten the free end of the waist belt **B**.
- Repeat this procedure to loosen the other waist belt.

Please note: After adjusting the restraint system to fit your child, make sure you pull on it to be sure it is securely fastened.

Setup and Use

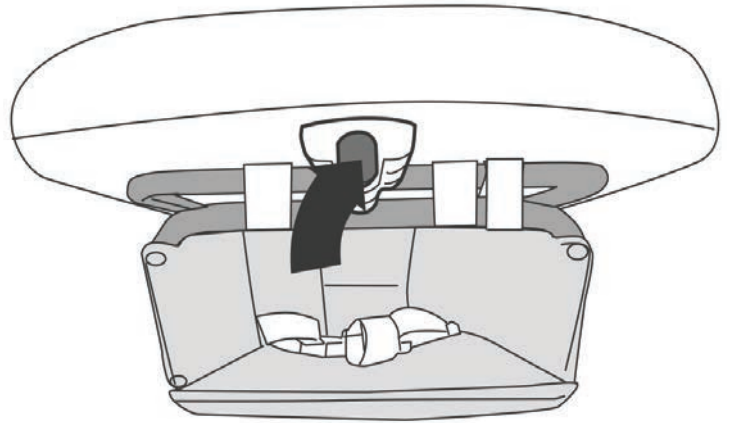

Fig. 3a

1

Press the red button located under the tray (Fig. 3a).

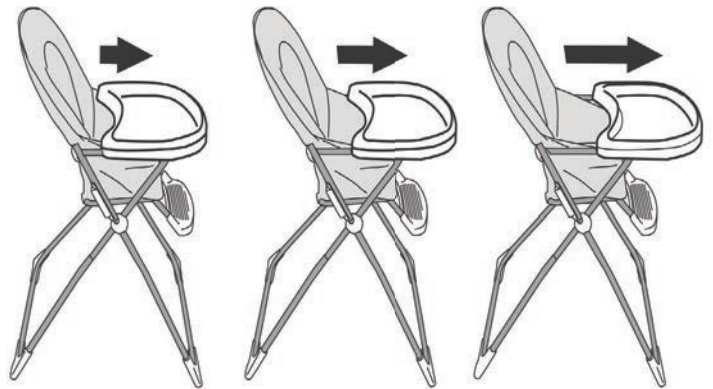
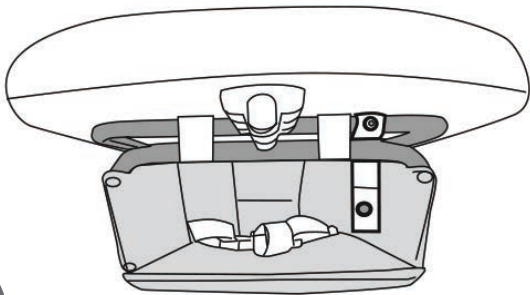
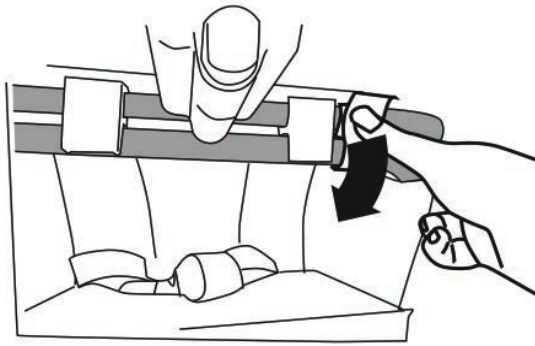

Fig. 3b

2

Set the tray to desired position (Fig. 3b) and release the button. There are 3 positions.

Folding High Chair



1

Release the strap located under the tray.

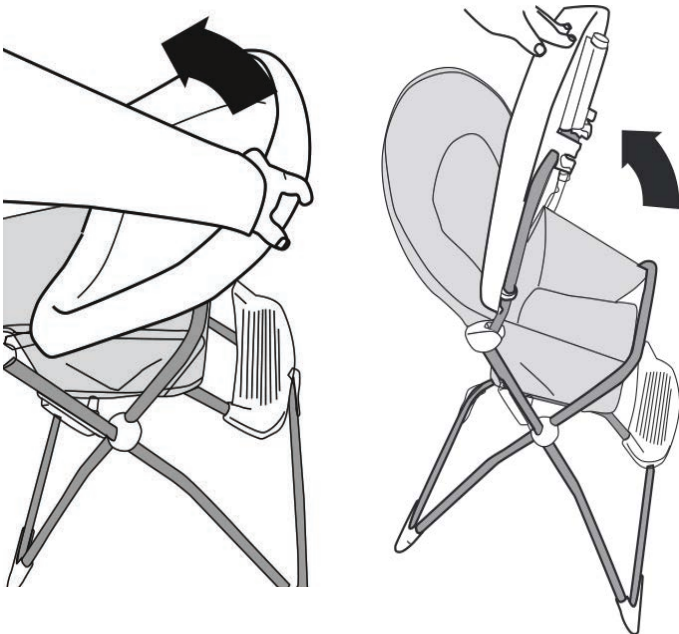

2

Fully lift tray up and detach from the high chair leg crossbar.



3

Once tray is lifted, close the front and rear legs together, by pushing in the leg crossbar getting the high chair in a fully closed position.

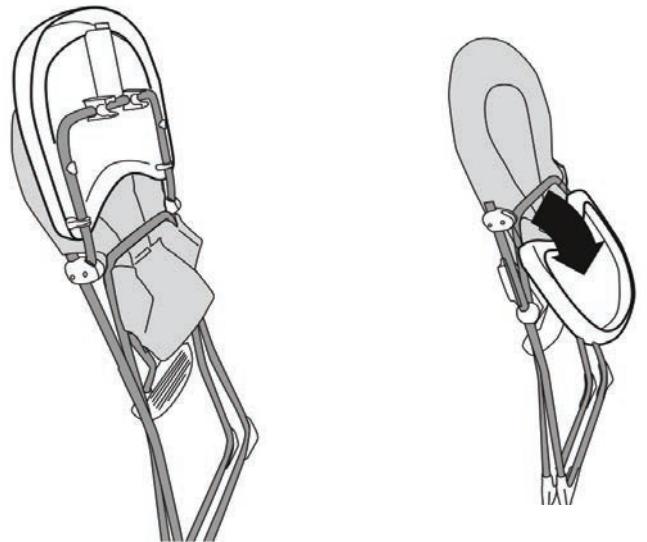

4

Rotate the tray downward to keep the frame folded.



Delta Children's Products Corp.
114 West 26th Street
New York, NY 10001
646-435-8726
www.DeltaChildren.com

Made in China