

CLUTCH PLUS

Jeep®

INSTRUCTION MANUAL

11303

Styles and colours may vary



**▲ WARNING:
CHOKING HAZARD**

Adult assembly required because of small parts. Keep assembly parts out of reach of children under 3 years.

**Read all instructions BEFORE assembly and USE of product
KEEP INSTRUCTIONS FOR FUTURE USE.**

Customer Experience Center
phone: (646) 435-8726
email: gcs@DeltaChildren.com

www.DeltaChildren.com
DCP-IM-F4-03022020

WARNING

WARNING: Please follow all of these instructions to ensure the safety of your child. Keep these instructions for future reference.

WARNING: Failure to follow these instructions could result in serious injury or death.

WARNING: Avoid serious injury from falling or sliding out. Always use the safety harness and ensure that the child is properly positioned according to these instructions.

WARNING: Never leave child unattended.

WARNING: CHOKING HAZARD

Adult assembly required because of small parts.

Keep assembly parts out of reach of children under 3 years.

- Purses, shopping bags, parcels, diaper bags or accessory items may change the balance of the stroller and cause hazardous unstable conditions.
- The maximum weight that can be carried in the basket is 3 lbs, and in the parent tray is 3 lbs.
- Excessive weight may cause a hazardous unstable condition to exist.
- Be certain the stroller is fully erect and latched in open positions before allowing the child near the stroller.
- Use of the stroller with a child weighing more than 50 pounds or 40 inches will cause excessive wear and stress on the stroller and may cause a hazardous unstable condition to exist.
- **DO NOT** use the stroller on stairways or escalators.
- **DO NOT** use the stroller with roller skates or in-line skates.
- Never allow your stroller to be used as a toy.
- To clean use only mild household soap or detergent and warm water on a sponge or clean cloth.
- Check your stroller for loose screws, worn parts, torn material or stitching on a regular basis.
- Replace or repair parts as needed.
- Discontinue use of stroller should it malfunction or become damaged. Please contact our customer service parts hotline to arrange for repair or obtain replacement parts.

TO PREVENT INJURY:

- Make sure fingers and other body parts are clear of the stroller when folding and unfolding.
- Make sure stroller is fully erected and into a fully locked position before placing child in the stroller.
- This stroller may become unstable if a parcel bag, other than one recommend by the manufacturer, is used.

CARE AND MAINTENANCE

- To clean the stroller use a mild household soap with warm water on a sponge or clean cloth.
- Check you stroller for loose screws, worn parts, torn material or stitching on a regular basis. Replace or repair parts as needed.
- Discontinue use of stroller if it should become damaged or malfunctions. Please contact our customer service number (646) 435-8726 to arrange for repair or obtain replacement parts.
- If you experience any difficult with assembly, missing parts or use, please **DO NOT** return this item to the store. Retail stores are unable to properly assists you. Contact our Customer Service Department directly for assistance (646) 435-8726.



Before returning this product to the store! Let's see if we can assist you!

- **Not sure how to assemble our product?**

Visit our site for easy to follow instructions along with some Tricks and Tips assembly videos <https://www.deltachildren.com/pages/instructions>

- **If you are missing a piece or have a damaged part**

Please contact our Consumer Experience Center for assistance at 646-435-8726 or email gcs@DeltaChildren.com. To better assist you please have your Style# or Model# and Lot# available. This can be found on a white rectangular sticker on your product, on the registration card, and on the product's box.

- **In the event we do not have a replacement part available**

You may need to return your product to the retailer for an exchange or refund.

- **Warranty**

In order to protect your investment, don't forget to register your product. You may also wish to consider purchasing our extended warranty.

Visit <https://www.deltachildren.com/pages/extended-warranty> for more details.

- **Please note:**

“All Final”, “As Is” or Third Party/Liquidator sales are not covered under our Limited Manufacturer Warranty.

DELTA CHILDREN

LIMITED MANUFACTURER WARRANTY

This Delta product is warranted to be free from defects for a period of 90 days from the date of purchase under normal use. If a product is defective during this period, we will at our option repair or replace the defective part or product. This limited warranty extends only to the original retail purchaser and is valid only when supplied with proof of purchase, or if received as a gift, when the registration is on file with Delta.

This limited warranty does not cover the following:

- Products purchased as floor models or samples.
- Items purchased on an “as-is” basis, as a second hand product, or as a resale product.
- Items purchased at a Final sale, a “Going out of Business” sale, or a Liquidation sale. This limited warranty gives you specific legal rights and you may also have other rights which vary from state to state.

This limited warranty gives you specific legal rights and you may also have other rights which vary from state to state.

TO REGISTER YOUR PRODUCT for important safety alerts and updates to your product please visit www.deltachildren.com

TO REPORT A PROBLEM, please log on to www.deltachildren.com and click the Consumer Care Tab, or contact us by phone at (646) 435-8726

Date of Purchase: _____ (you should also keep your receipt)

EXTENDED WARRANTY

DON'T MISS YOUR CHANCE TO BE COVERED FOR ALL OF LIFE'S MISHAPS!

With Delta's Extended Warranty, you're covered for mechanical failure from normal use or if your item stops working due to normal wear and tear, plus all those unexpected surprises.

2 YEARS OF PROTECTION

For Additional Information:

Simply visit our Website, register your product, and add the Extended Warranty

<https://www.deltachildren.com/pages/product-registration>

Extended Warranty only available in the following States: Arkansas, Colorado, Delaware, District of Columbia, Georgia, Idaho, Illinois, Indiana, Iowa, Kansas, Kentucky, Louisiana, Maryland, Michigan, Mississippi, Missouri, Nebraska, Nevada, New Hampshire, New York, North Carolina, North Dakota, Pennsylvania, Rhode Island, South Dakota, Tennessee, Utah, West Virginia

PARTS

IMPORTANT! Please remove all parts from the package and identify them before assembly.

IMPORTANT! Before assembly and each use, inspect this product for damaged hardware, loose joints, missing parts, or sharp edges. NEVER use if any parts are missing or broken. Contact manufacturer for replacement parts and instructions if needed. Never substitute parts. **IMPORTANT!** Adult assembly is required.

WARNING: Care must be taken when folding and unfolding the stroller to prevent finger entrapment.



Stroller



Crotch Pad

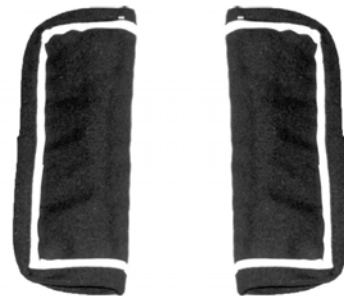

Shoulder Pads

UNFOLDING

HAVING TROUBLE?
HOW TO FOLD & UNFOLD



SCAN QR CODE FOR
INSTRUCTIONAL VIDEO

1 UNHOOK LATCH



FRONT VIEW

2 UNFOLD OUTWARD



3 FINISH UNFOLD

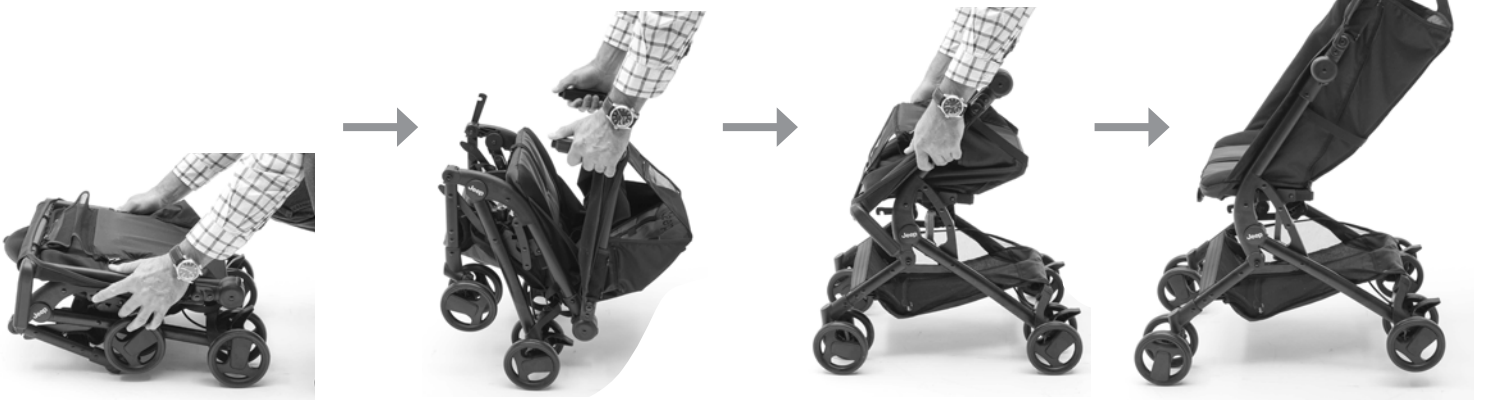

COMPLETE

FOLDING

HAVING TROUBLE?
HOW TO FOLD & UNFOLD



SCAN QR CODE FOR
INSTRUCTIONAL VIDEO

1 PUSH RELEASE BUTTONS

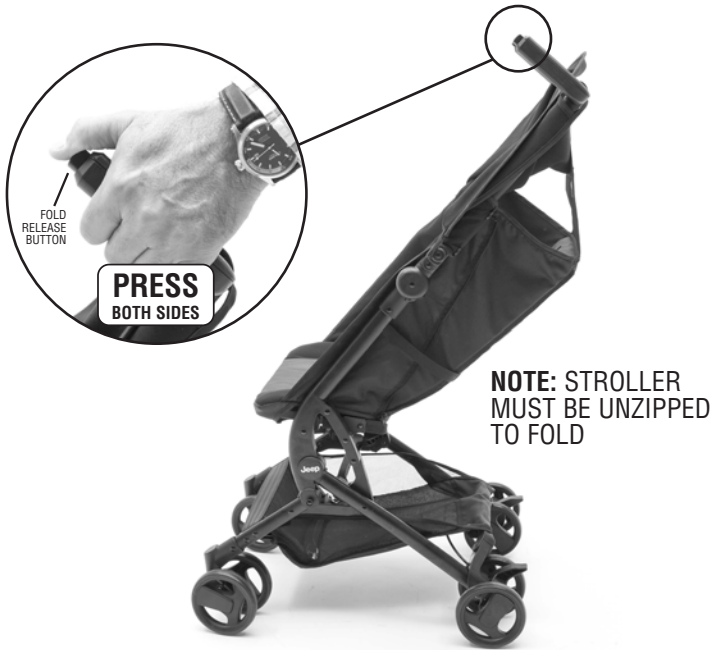

2 FOLD FORWARD



3 FOLD DOWN

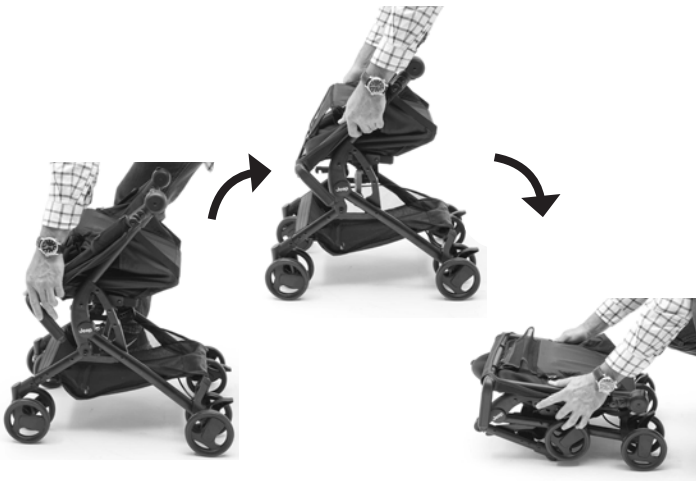

4 FOLD WHEELS & SECURE

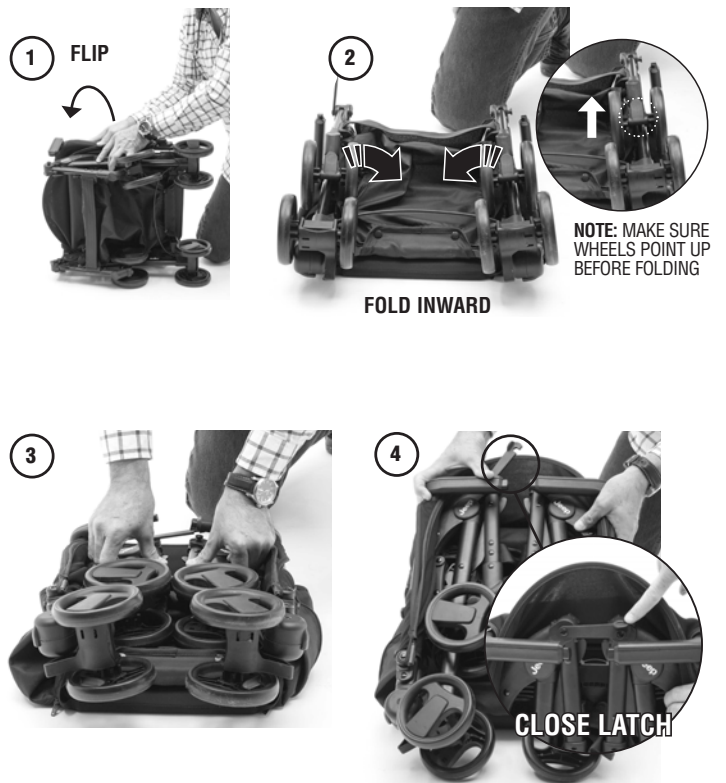

SECURING CHILD

WARNING: Avoid serious injury from falling or sliding out. Always use the seat belt.

Before Placing your Child in Stroller:

Close Canopy. Press brake pedals (in the back wheels) down until they “click” into a fully locked position.

Make sure the brake pedals are pressed down completely.

Always set both brake pedals when parking the stroller.

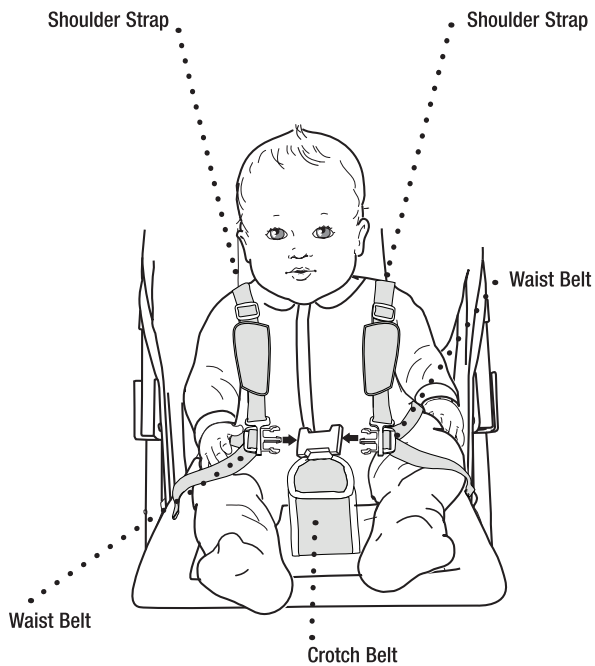

Place your child in the stroller. Position the **Crotch Belt** between your child's legs.

Pull **Shoulder Straps** over child's arm and shoulder and fasten **both** strap ends to the **Restraint System**.

Fasten **both Waist Belts** to the buckle on each side of the **Crotch Belt**. Make sure you hear a “**click**” on both sides.

Check to be sure the restraint system is securely attached by pulling it away from your child. The **Restraint System** should remain attached.

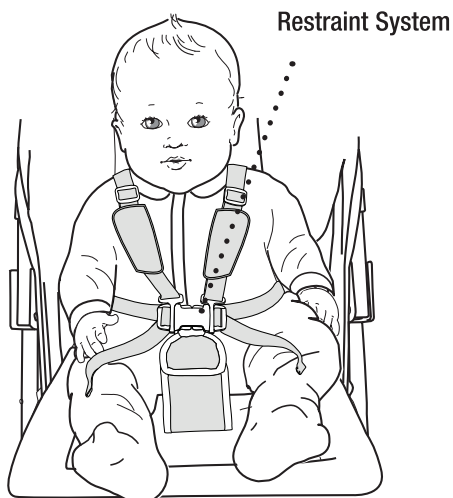

Tighten each **Waist Belt** and **Shoulder Strap** so that the **Restraint System** is snug against your child.

Please refer to the next section for instructions to tighten the Waist Belts.

ADJUSTING SHOULDER STRAPS

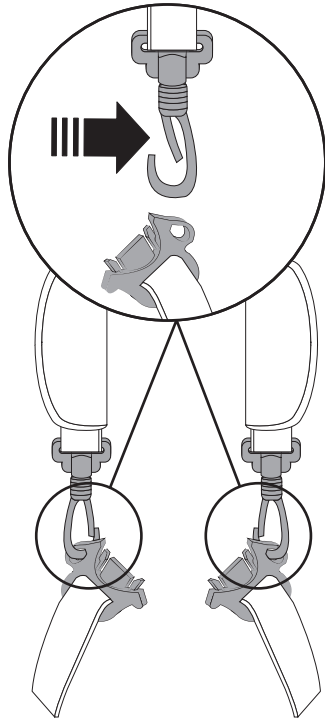

1

- Unhook shoulder strap from center hub.

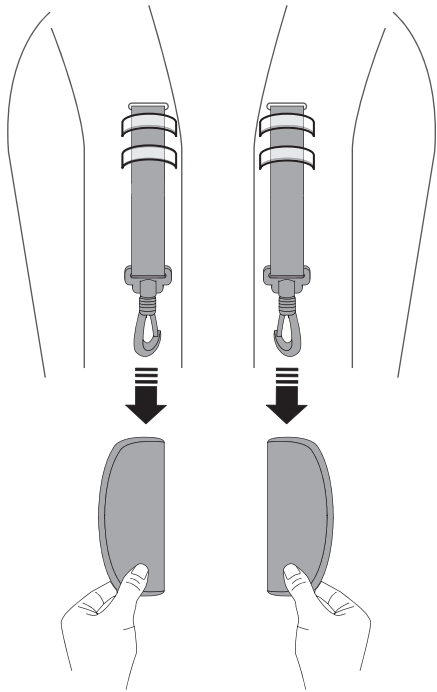

2

- Remove shoulder pads from strap.

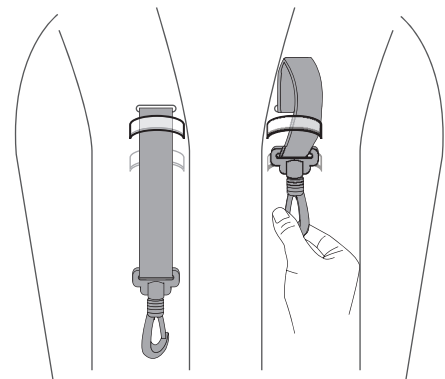
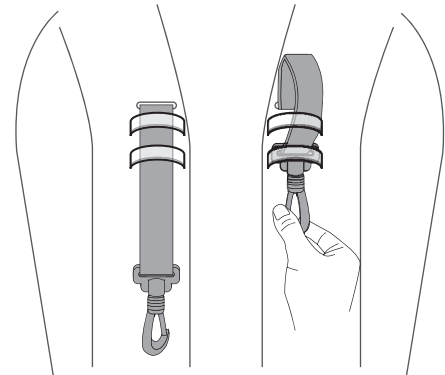
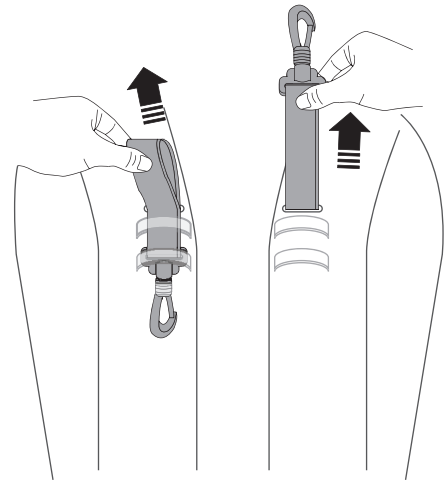

3

- Slide strap out, upward, and into one of the three shoulder strap height positions.

CANOPY



SEAT RECLINE

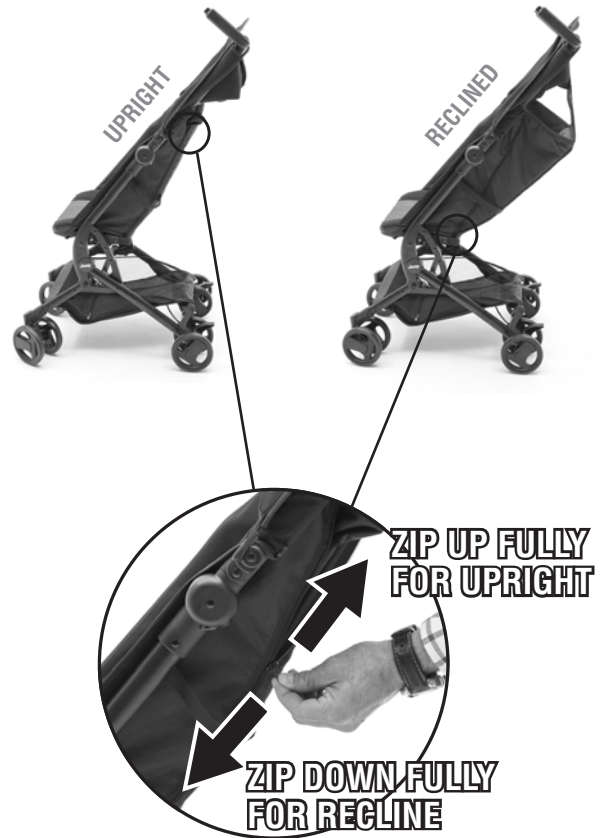

HEADREST RECLINE

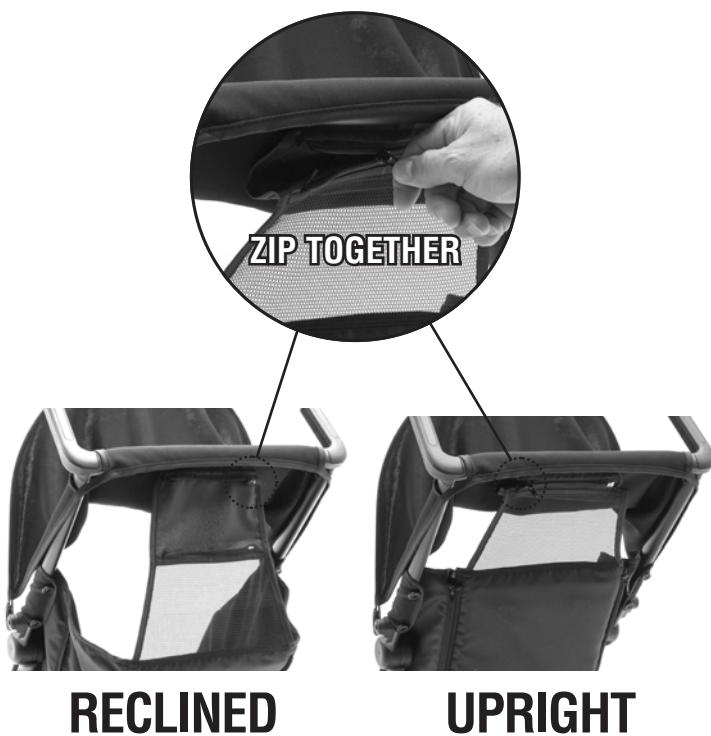

BRAKES

LOCK



STEP ON RIGHT PEDAL TO LOCK

UNLOCK



STEP ON LEFT PEDAL TO UNLOCK

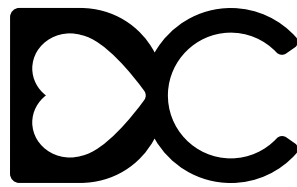

DELTACHILDREN

Delta Children's Products Corp.

114 West 26th Street
New York, NY 10001
646-435-8726
www.DeltaChildren.com