

## *fuse* – 24 MONTH WARRANTY

Fuse will replace the faulty product at no cost to the consumer. The warranty does not extend to any consequential damages or cost that may be incurred and is valid for 24 months from date of purchase. The consumer must return the faulty product to the retail store it was purchased from together with proof of purchase.

The warranty is provided by:  
Pacific Optics (in Australia)  
18 Taree St, Burleigh Heads, QLD 4220  
Telephone: (07) 5593 4222  
Email: info@fuseaudio.com.au

Signature Marketing NZ Ltd (in New Zealand)  
25a Triton Drive, Rosedale, Auckland 0632  
Telephone (NZ): (09) 479 5524  
Email (NZ): sales@signaturenz.com

The benefits to the consumer under this warranty are in addition to other rights and remedies of the consumer under Australian laws in relation to the goods to which the warranty relates. Our goods come with guarantees that cannot be excluded under the Australian Consumer Law. You are entitled to a replacement or refund for major failure and for compensation for any other reasonably foreseeable loss or damage. You are also entitled to have the goods repaired or replaced if the goods fail to be of acceptable quality and the failure does not amount to a major failure.

# *fuse*

## NEON INSTANT HANDSFREE

CAR FM TRANSMITTER



## *fuse*

### QUICK START GUIDE

#### WHAT'S INCLUDED:

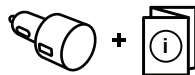

#### 1. PLUG INTO LIGHTER SOCKET

*Insert Neon Instant Handsfree into your vehicle's cigarette lighter socket and the device will power on automatically with your vehicle, then briefly display the vehicle's battery voltage. It will then flash "BT" indicating it is ready to pair via Bluetooth.*

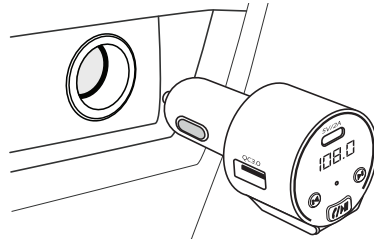

## 2. CONNECT YOUR PHONE

Turn **Bluetooth** on in your phone's settings and select **Fuse Instant BT** from the available Bluetooth devices.

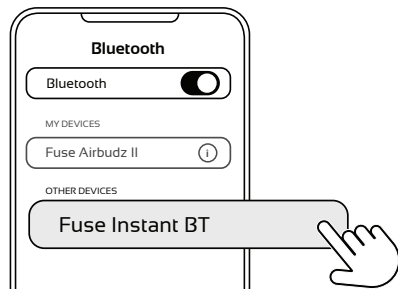

## 3. TUNE YOUR CAR RADIO

Choose an unused FM frequency between 87.5-108MHz on your vehicle's stereo and adjust the volume to a comfortably low level. Set your phone volume to maximum for best results.



## 4. TUNE YOUR FM TRANSMITTER

Adjust the FM frequency on your Neon Instant Handsfree by pressing either **◀** or **▶** button until the FM frequency is shown flashing. Then press either **◀** or **▶** button again until the FM frequency matches your vehicle's stereo.

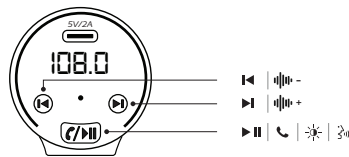

## 5. ENJOY YOUR MUSIC AND CALLS WITH FUSE INSTANT HANDSFREE!

<b>Play/pause</b>	Press <b>⏮/⏭</b>
<b>Previous track</b>	Press <b>◀</b>
<b>Next track</b>	Press <b>▶</b>
<b>Activate voice assistant</b>	Press <b>⏮/⏭</b> for 2 seconds
<b>Answer/Hang up call</b>	Press <b>⏮/⏭</b>
<b>Reject incoming call</b>	Press <b>⏮/⏭</b> for 2 seconds

<b>Change light mode (RGB/White/OFF)</b>	Press <b>⏮/⏭</b> twice
<b>Adjust FM frequency (Frequency will flash)</b>	Press <b>◀</b> or <b>▶</b> for 2 seconds
<b>Frequency up</b>	Press <b>▶</b> when frequency is flashing
<b>Frequency down</b>	Press <b>◀</b> when frequency is flashing

## 6. DOWNLOAD USER MANUAL

For the most up-to-date assistance, please **scan this QR Code** to download the full User Manual before using this product.



**fuse**