



PRE-INSTALLATION GUIDE FOR MODELS VS50, VS50H, VS80 & VS80H



Model VS50



Model VS50H



Model VS80



Model VS80H

This VacStar Model is being installed:

(AS CHECKED)

- | | |
|--------------------------------|--------------------------------|
| <input type="checkbox"/> VS50 | <input type="checkbox"/> VS80 |
| <input type="checkbox"/> VS50H | <input type="checkbox"/> VS80H |

Doctor: _____

Address: _____

Phone#: _____

Dealer: _____

Dealer Address: _____

<i>PRODUCT SPECIFICATIONS</i>				
Electrical	VS50	VS50H	VS80	VS80H
Voltage Rating	230	230	230	230
Voltage Min./Max.	205/253	205/253	205/253	205/253
Full Load Amps	16	16	26.8	26.8
Water				
Inlet Water Pressure (psi)	20 - 100	20 - 100	20 - 100	20 - 100
Flow Rate Per Pump (gal/min) w/ HydroMiser	N/A	0.12	N.A.	0.18
Flow Rate Per Pump (gal/min) w/o HydroMiser	0.50	N/A	0.75	N/A
Inlet Water Temperature (°F)	40 - 75	40 - 75	40 - 75	40 - 75
Power and Heat (@ 100% duty cycle)				
Watts per Hour	1,500	1,875	2,460	3,075
BTU per Hour	5,119	6,398	8,394	10,493
Vacuum Level				
Preset at Factory (In Hg)	10	10	10	10
Physical Characteristics				
Shipping Weight in pounds	160	170	200	210
Height x Width x Depth Dimensions in inches	22 x 28 x 16	25 x 28 x 16	22 x 28 x 16	25 x 28 x 16

All installations must conform to local codes.

PHYSICAL CHARACTERISTICS

Model VS50		Model VS50H		Model VS80		Model VS80H	
Height	21 inches (53 cm)	Height	24 inches (61 cm)	Height	21 inches (53 cm)	Height	24 inches (61 cm)
Width	28 inches (71 cm)	Width	28 inches (71 cm)	Width	28 inches (71 cm)	Width	28 inches (71 cm)
Depth	16 inches (41 cm)	Depth	16 inches (41 cm)	Depth	16 inches (41 cm)	Depth	16 inches (41 cm)
Shipping Weight		Shipping Weight		Shipping Weight		Shipping Weight	
160 lbs. (73 kg)		170 lbs. (77 kg)		200 lbs. (91 kg)		210 lbs. (95 kg)	

SITE REQUIREMENTS

24V CONNECTIONS

Electrical	VS50	VS50H	VS80	VS80H
Min. Circuit Breaker Rating	2 ea. 15A or 1 ea. 30A	2 ea. 15A or 1 ea. 30A	2 ea. 20A or 1 ea. 40A	2 ea. 20A or 1 ea. 40A
Wire Size AWG (Min. Gauge)	2 ea. 14 or 1 ea. 10	2 ea. 14 or 1 ea. 10	2 ea. 12 or 1 ea. 8	2 ea. 12 or 1 ea. 8
Buck/Boost Transformer	#67002	#67002	#67002, 2 ea.	#67002, 2 ea.
Ambient Temperature	(40 - 104°F 5 - 40°C)	40 - 104°F (5 - 40°C)	40 - 104°F (5 - 40°C)	40 - 104°F (5 - 40°C)

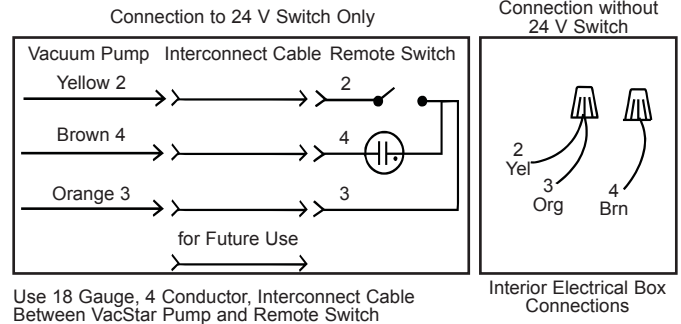

Important: Each pump should have a dedicated circuit panel.

ELECTRICAL CONNECTIONS

- ⇒ If voltage falls below the minimum 205 or maximum 253 during operation, a Buck/Boost Transformer must be installed. See Product Specifications.
- ⇒ All VacStars must be wired directly from an electrical box that complies with local electrical codes to the VacStar's Electrical Connections. See Figure 1.

Figure 1 - Interior View

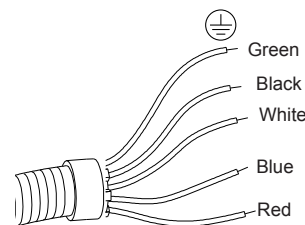

Pumps	Power Leads
Right	(L1) Black (L2) White
Left	(L1) Red (L2) Blue



MEDICAL ELECTRICAL EQUIPMENT

WITH RESPECT TO ELECTRICAL SHOCK, FIRE, MECHANICAL
AND OTHER SPECIFIED HAZARDS ONLY
IN ACCORDANCE WITH UL-60601-1, CAN/CSA C22.2 NO.601.1 66CA

PLUMBING SITE REQUIREMENTS

Plumbing	VS50 & VS50H	VS80 & VS80H
Min. CFM @ 0" Hg	32	44
Air Exhaust with Hydromiser	2" schedule 40 pipe	2" schedule 40 pipe
Overhead Plumbing		
Main Line Dia. Min./Max. ID in inches	1¼ to 1½"	1½ to 2"
End Fitting	1" FNPT	1" FNPT
Overhead Main Line	1/2" ID	1/2" ID
Floor Plumbing		
Main Line Dia. Min./Max. ID in inches	1¼ to 1½"	1¼ to 2"
End Fitting	1" FNPT	1" FNPT
Branch Line Dia. Min./Max. ID in inches	1 to 1½"	1 to 1½"

Note: Suction piping must slope at least a ¼" for each 10 feet of run towards the pump.
Use PVC Schedule 40 or Copper Type M.

VENTILATION REQUIREMENTS

Equipment Room Temperature

The VACSTAR equipment must be used in a controlled temperature environment. Maintain equipment room temperature between 40 and 105 degrees Fahrenheit. Adequate forced ventilation must be provided across the unit by placing an appropriate exhaust fan opposite an equivalent air intake vent. The fan should be higher than the associated intake vent.

Exhaust Vent Protection.

If the exhaust piping is venting to the outside of the building, precautions must be taken to protect the equipment room from weather elements and animal intrusion. This can be accomplished by using one of the three methods shown below.

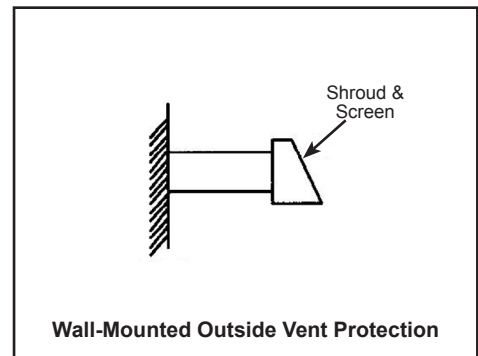
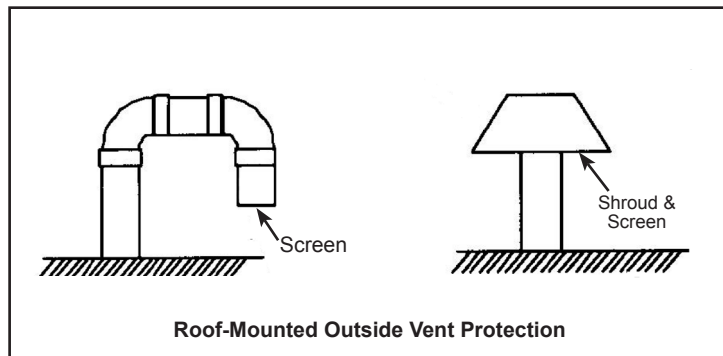

Make sure to use the required pipe type for associated system

PLUMBING INSTALLATION

SUB FLOOR INSTALLATION - THE SUB-FLOOR PLUMBING LAYOUT SHOWN BELOW IS THE RECOMMENDED LAYOUT FOR VACSTAR SYSTEM INSTALLATIONS AND SHOULD BE USED WHENEVER POSSIBLE.

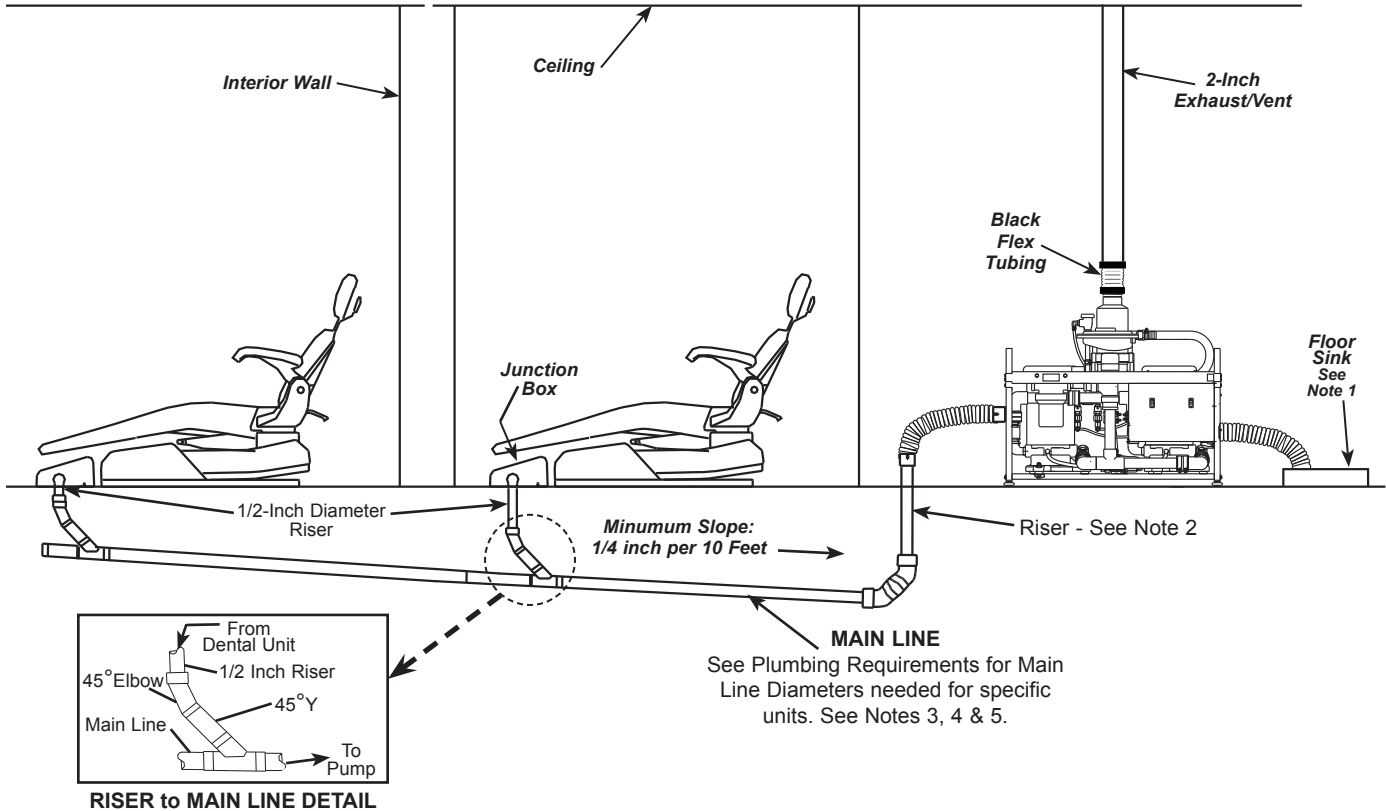

- Notes:**
1. See Optional Drain Connections shown below.
 2. 8-Foot Maximum Height from Main Line to pump.
 3. Consult Dental Unit Manufacturer's Guidelines for correct reduced size and height of termination of vacuum line inside junction box.
 4. Limit branches. Orient main line under junction box or cabinet.
 5. When main line is 1-1/2" I.D. or larger, use 45° Y's and elbows only.
 6. Long radius 90° elbows can be used as alternates to 45° elbows.

All installations must conform to local codes.

PLUMBING INSTALLATION

OVERHEAD INSTALLATION - THE OVERHEAD PLUMBING LAYOUT SHOWN BELOW IS THE ALTERNATE LAYOUT FOR VACSTAR SYSTEM INSTALLATIONS AND SHOULD BE USED ONLY WHEN UNABLE TO USE THE SUB-FLOOR PLUMBING LAYOUT.

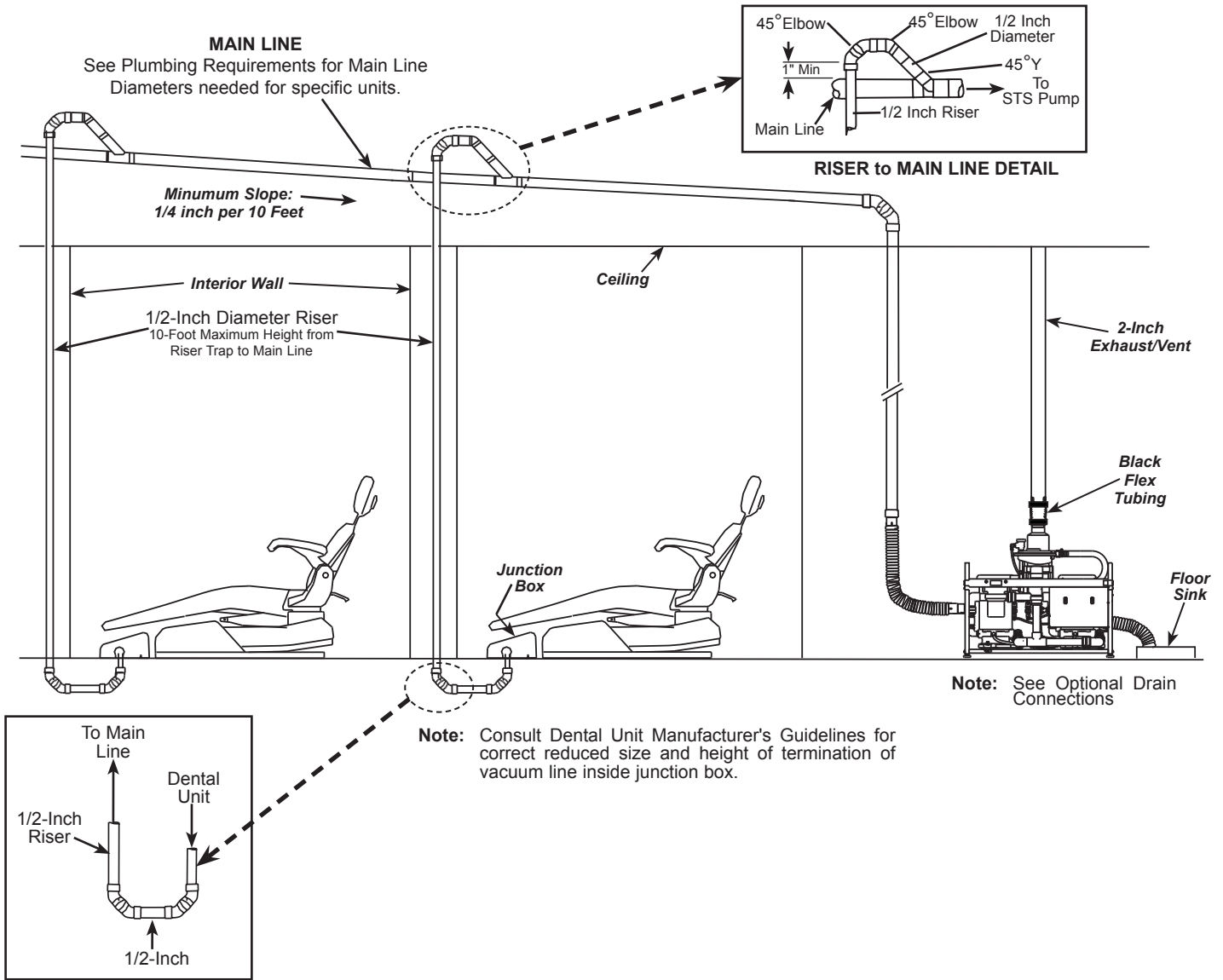

RISER TRAP DETAIL
(Using 45° Elbows)

CONNECTION DETAILS ALL INSTALLATIONS -

45° Elbow
MAKING TURNS
CLEARING AN OBSTRUCTION
45° Elbow

MAIN LINE

- DO NOT use 90° elbows except where main line terminates at vacuum pump.
- Use only 45° elbows to make turns in main line.
- If piping is diverted to clear an obstruction, DO NOT MAKE A TRAP.

DRAIN OPTIONS

Direct connection to vented drain. No traps before vent.

CLOSED VENTED DRAIN

OR

Indirect connection (Air gap) with a p-trap.

1-1/2 Inch P-Trap
6" OPEN DRAIN PIPE

UTILITY ROOM WITHOUT HYDROMISER
WITH OR WITHOUT AIR/WATER SEPARATOR

Typical for both VS50 and VS80

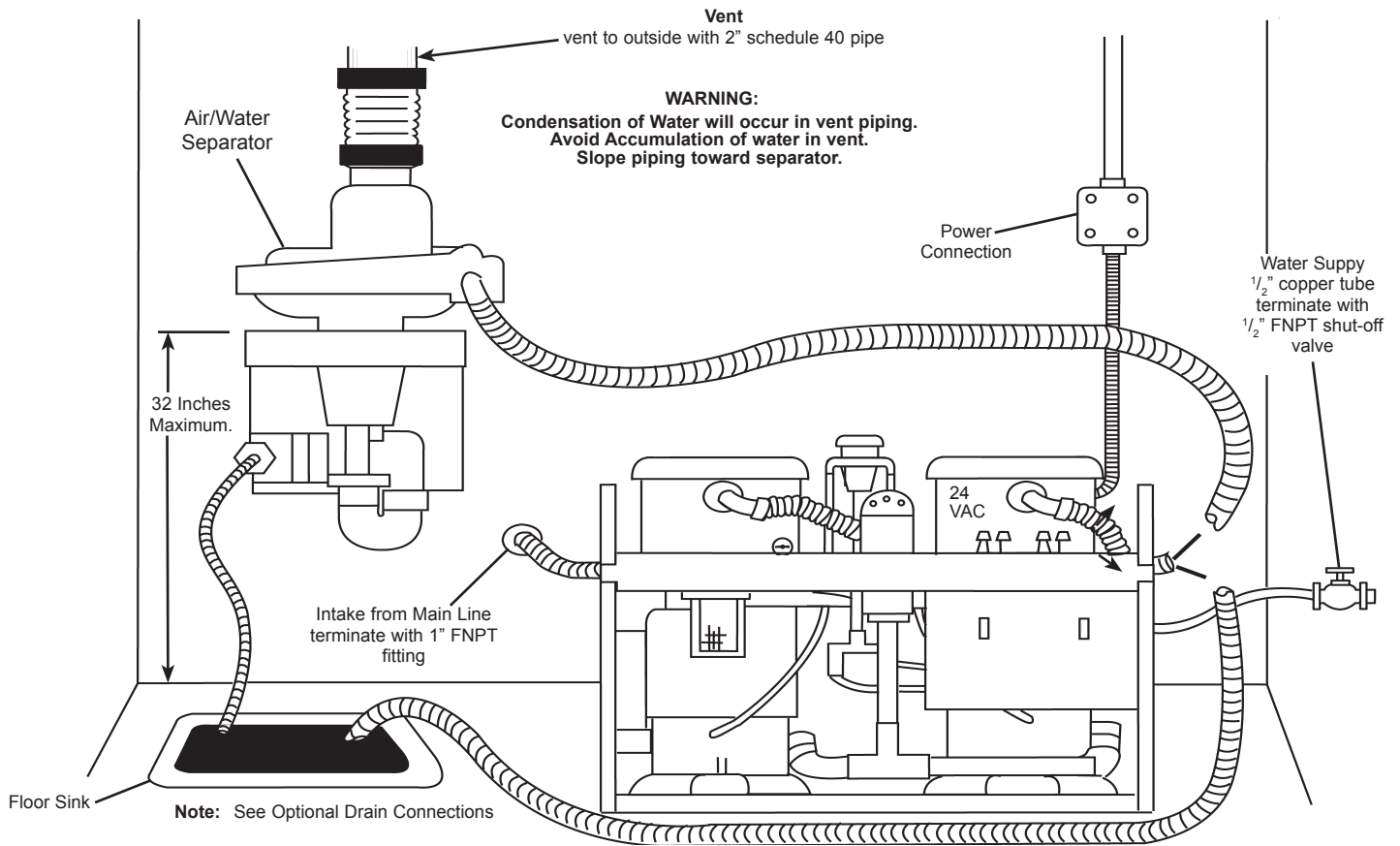

All VacStar vacuums comply with NFPA 99C level 3 requirements

UTILITY ROOM WITH HYDROMISER

Typical for both VS50H and VS80H

If the existing drain is higher than the HydroMiser outlet, the HydroMiser must be mounted so that its outlet is above the drain.
The HydroMiser can be installed up to 32" above the base of the VacStar.

Order Kit PN 55087.

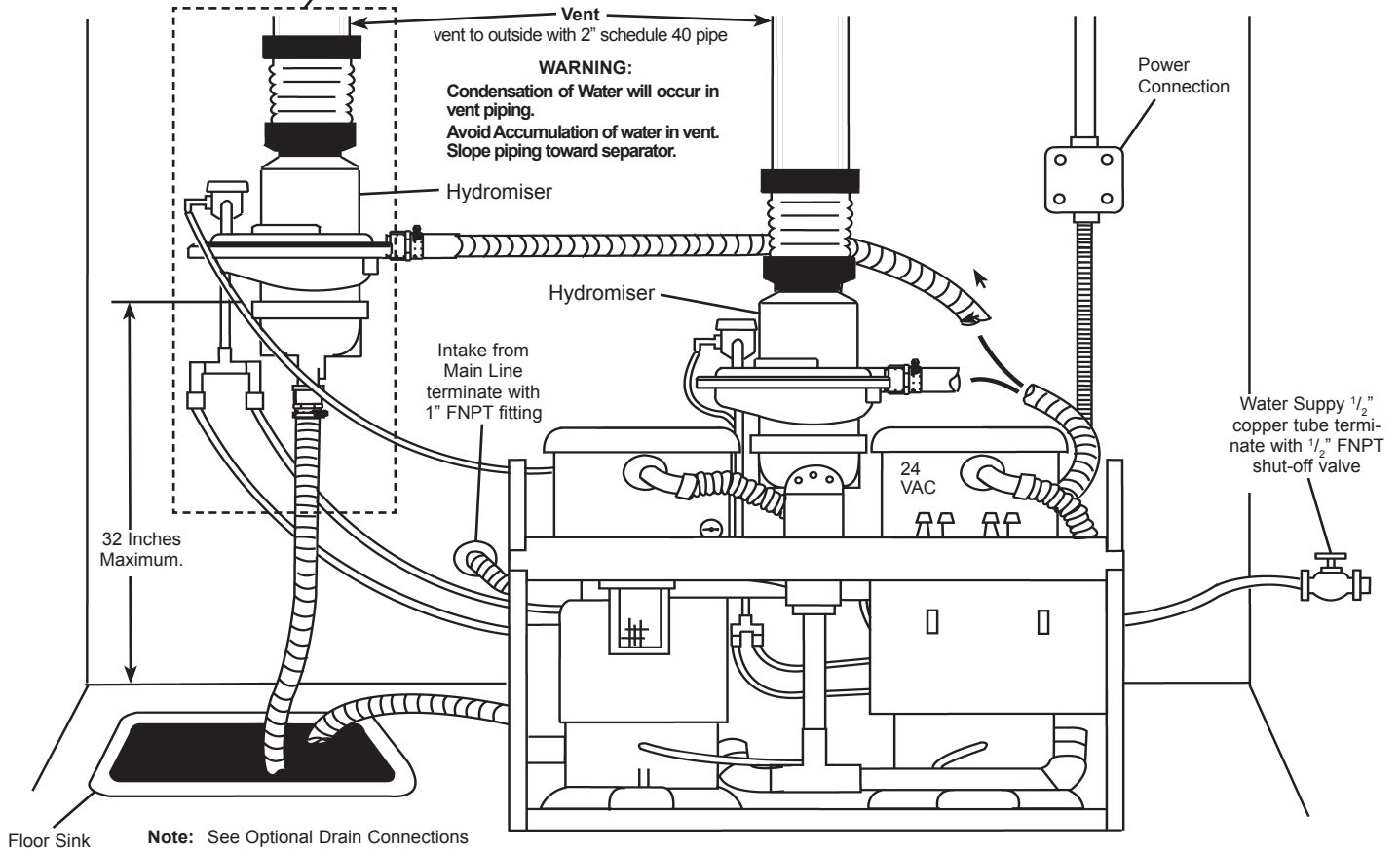

You can obtain more information about Air Techniques' products by visiting our web site at
www.airtechniques.com

Additional installation information is available on our Authorized Air Techniques Dealer web site at
<http://dealers.airtechniques.com>



Air Techniques Inc.
1295 Walt Whitman Road, Melville, NY 11747-3062
Website: www.airtechniques.com
East Coast: 1-800-AIR-TECH (1-800-247-8324) • West Coast: 1-800-822-2899



VacStar and Hydromiser are trademarks of Air Techniques, Inc.
© 2008 Air Techniques, Inc. • Part No. 55349, Rev. M • April 2014