

DESCRIPTION

Spindle-D2 Direct Drive



PART NUMBER

1116300011

REVISION

000

DATE

2/27/2023

DRAWN

dspenny

Grease with #2 lithium based grease every 500 hrs.
Use 10 pumps (0.44 oz) into each of the two
grease zerks.

Warning: Do not over-grease.
Over-greasing will cause
damage or premature failure
of the bearings, housing, & seals.

* The splined insert kit includes
the insert removal tool 11-0913.
Not a spindle component.
For coupling removal only.

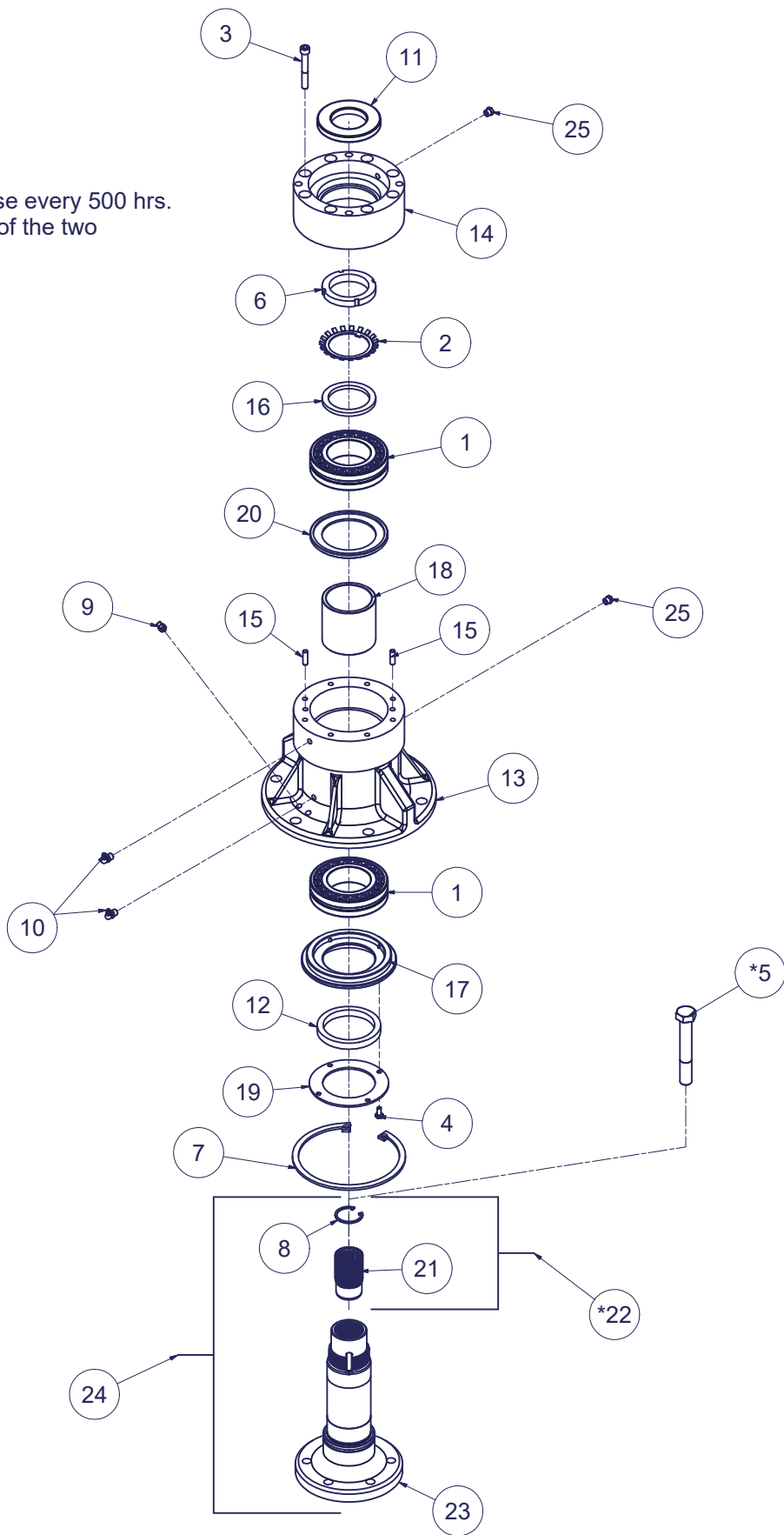

REF.35-0233

DESCRIPTION

Spindle-D2 Direct Drive



PART NUMBER

1116300011

REVISION

000

DATE

2/27/2023

DRAWN

dspenny

REF#	PARTS DESCRIPTION	REQ	PART#	TORQUE (ft-lbs)
1	BEARING	2	10-0055	
2	LOCKING WASHER	1	11-0048	
3	3/8-16 X 2-3/4 ASTM A574 SOCKET CAP, BLACK OXIDE	8	11-0703	51
4	1/4-20 X 1/2 GR 5 HEX CAP, ZINC	4	11-0741	8.5
*5	3/4-16 X 5 GR 8 HEX CAP, PLAIN	1	11-0913	420
6	2-1/2 SPANNER NUT	1	11-1037	
7	LARGE SNAP RING	1	11-2021	
8	SMALL SNAP RING	1	11-2022	
9	PIPE PLUG	1	21-1136	
10	GREASE ZERK	2	23-0005	
11	UPPER SEAL	1	33-0035	
12	LOWER SEAL	1	33-0057	
13	SPINDLE HOUSING	1	35-0021	
14	SEAL/MOTOR MOUNT	1	35-0022	
15	ALIGNMENT PIN	2	35-0032	
16	NUT LOCK SPACER	1	35-0050	
17	BOTTOM SEAL PLATE	1	35-0063	
18	SPINDLE SPACER	1	35-0064	
19	BOTTOM PLATE	1	35-0065	
20	GREASE CATCH	1	35-0066	
21	SPLINE INSERT	1	35-0086	
*22	SPLINED INSERT KIT	1	35-0091	
23	SPINDLE SHAFT	1	35-0232	
24	SPINDLE SHAFT COMPLETE	1	35-0234	
25	BREATHER	2	80-1016	

* The splined insert kit includes
the insert removal tool 11-0913.
Not a spindle component.
For coupling removal only.

REF.35-0233