

Pushbutton Selectors

Package Quantity: 1

Shape	Circuit Category	Contact Code	Contact Block		Normal		Depressed		Ring Operator		Button Color Code		
			Mounting Position	Contact	Normal	Depressed	Normal	Depressed	Part No.				
	A	1NO-1NC (11)	①	NO		●		●			HW1R-2A11*	B G R Y S W	
			②	NC	●						HW1R-2A20*		
		2NO (20)	①	NO		●		■	●				HW1R-2A22*
			②	NO		●		■	●				
		2NO-2NC (22)	①	NO		●			●				HW1R-2A22*
			②	NC	●								
			③	NO		●			●				
			④	NC	●								
		2NO (20)	①	NO		●		■	●				HW1R-2D20*
			②	NO		●			●				
			2NO-2NC (22N1)	①	NO		●			●			HW1R-2D22N1*
				②	NO		●			●			
	2NO-2NC (22N1)	③	NC	●		■	■				HW1R-2E22N1*		
		④	NC	●		■	■						
		①	NO		●			●					
		②	NO		●			●					
	2NO-2NC (22N1)	③	NC				■				HW1R-2F22N1*		
		④	NC	●		■	■						
		①	NO		●			●					
		②	NO		●			●					
	2NO-2NC (22N2)	③	NC				■	●			HW1R-2N22N2*		
		④	NO		●		●	●					
		①	NO		●		●	●					
		②	NO		●		●	●					
2NO-2NC (22N1)	③	NC	●					Blocked		HW1R-2T22N1*			
	④	NC	●					Blocked					
	①	NO		●		●	●						
	②	NO		●		●	●						

- Specify a button color code in place of \* in the Part No. B (black), G (green), R (red), Y (yellow), S (blue), W (white)
- When operating the pushbutton selector, do not turn the operator ring or the lock lever while the button is depressed. Otherwise the pushbutton selector may be damaged.
- On the contact arrangement marked page with ★ in the table above, the rated current (load switching current) is reduced to a half of the related current of the contact block. The rated insulation voltage and the rated thermal current remain unchanged.
- For models with ☆, contacts may overlap when the operator is changed.

Dimensions

All dimensions in mm.

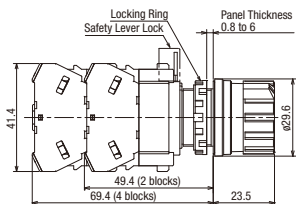

Terminal Screws M3.5

• See B-210 for the bottom view.

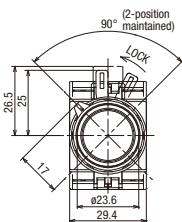

Integrated Terminal Cover

Contact Block Mounting Position

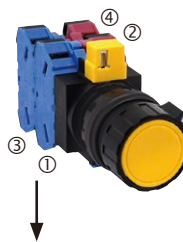

Mounting Position	Contact	Left		Right	
		Normal	Push	Normal	Push
①	NO				●
②	NO		●		
③	NC			●	
④	NC	●			

APEM

Switches & Pilot Lights

Control Boxes

Emergency Stop Switches

Enabling Switches

Safety Products

Explosion Proof

Terminal Blocks

Relays & Sockets

Circuit Protectors

Power Supplies

LED Illumination

Controllers

Operator Interfaces

Sensors

AUTO-ID

Flush Silhouette

ø16

ø22

ø30

Miniature

Pilot Lights

HW

TW

YW