

CHEFMAN

PORTABLE MIRRORED BEAUTY FRIDGE WITH LED LIGHTING

USER GUIDE

- Safety Instructions
- Features
- Operating Instructions
- Cleaning and Maintenance
- Storage and Disposal
- Terms and Conditions
- Warranty

RJ48-ML

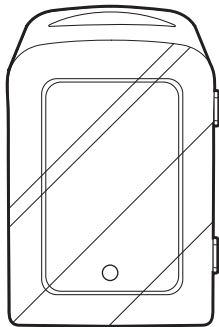

COOKING FORWARD

Welcome!

When we designed our new Portable Mirrored Beauty Fridge with LED Lighting, we had your beauty and skincare routine in mind. Refrigerating cosmetics, toners, and moisturizers can extend their shelf life and applying chilled products delivers a cooling effect that can reduce inflammation and the appearance of undereye bags. The mirrored, LED-lighted door frames your face while the fridge's compact size is perfect for the bedroom, powder room, dorm room, office, and even your car. Its 4-liter capacity will also keep food, drink, and medicine cool. And, with the flip of a switch, can keep hot items warm.

Before you use your new fridge, please take a moment to read all about it, including important safety information.

Sincerely,

The Chefman® Team



READ ALL INSTRUCTIONS BEFORE USE

For your safety and continued enjoyment of this product, always read the instruction manual before using.

CONTENTS

- 1** Safety Instructions
- 5** Features
- 6** Operating Instructions
- 7** Cleaning and Maintenance
- 8** Storage and Disposal
- 9** Terms and Conditions
- 11** Warranty

SAFETY INSTRUCTIONS

IMPORTANT SAFEGUARDS

When using electrical appliances, basic safety precautions should always be followed including the following:

1. Read all instructions.
2. To protect against electrical shock, do not immerse cord or plugs in water or other liquid.
3. Close supervision is necessary when this appliance is used by or near children.
4. Unplug from outlet when not in use and before cleaning. Allow to cool prior to cleaning the product.
5. Do not operate any appliance with a damaged cord or plug or after the appliance malfunctions or has been damaged in any manner. Return appliance to the nearest authorized service facility for examination, repair, or adjustment. For additional help, please contact Chefman® Customer Support.
6. Do not let cord hang over edge of table or counter or touch hot surfaces.

SAFETY INSTRUCTIONS

IMPORTANT SAFEGUARDS

7. Do not place on or near a hot gas or electric burner, or in a heated oven.
8. Always attach plug to appliance first, then plug cord into the wall outlet. To disconnect, turn any control to "off", then remove plug from wall outlet.
9. Do not use appliance for other than intended use.
10. When alternating between Hot and Cold functions, turn the switch to Off first. After 2 minutes, turn the switch from Cold to Hot.
11. When using in a car, disconnect the plug from the cigarette lighter when not in use or the car is not running.
12. Allow adequate ventilation on all sides of the unit when in operation. Keep the fan free of obstructions.

SAVE THESE INSTRUCTIONS.

SAFETY INSTRUCTIONS

IMPORTANT SAFEGUARDS

WARNING: This appliance has a polarized plug (one blade is wider than the other). This plug is intended to fit into a polarized outlet only one way. If the plug does not fit fully into the outlet, reverse the plug. If it still does not fit, contact a qualified electrician. Do not attempt to modify the plug in any way or force it into the outlet. This could result in injury or electric shock.

SHORT CORD INSTRUCTIONS

A short power supply cord is provided to reduce the hazards of entanglement or tripping over a longer cord. Longer detachable power-supply cords or extension cords are available and may be used if care is exercised in their use. If a longer detachable power-supply extension cord is used:

1. The marked electrical rating of the extension cord should be at least as great as the electrical rating of the appliance.
2. The cord should be arranged so that it will not drape over the countertop or tabletop where it can be pulled on by children or tripped over unintentionally.

SAFETY INSTRUCTIONS

IMPORTANT SAFEGUARDS

POWER CORD SAFETY TIPS

1. Never pull or yank on cord or the appliance.
2. To insert plug, grasp it firmly and guide it into outlet.
3. To disconnect appliance, grasp plug and remove it from outlet.
4. Before each use, inspect the power cord for cuts and/or abrasion marks. If any are found, this indicates that the appliance should be serviced, and the power cord replaced. Please contact Chefman Customer Support for assistance.
5. Never wrap the cord tightly around the appliance, as this could place undue stress on the cord where it enters the appliance and cause it to fray and break.

DO NOT OPERATE APPLIANCE IF THE POWER CORD SHOWS ANY DAMAGE OR IF APPLIANCE WORKS INTERMITTENTLY OR STOPS WORKING ENTIRELY.

*California Proposition 65:
(Applicable for California Residents only)*



WARNING:

Cancer and Reproductive Harm -
www.P65Warnings.ca.gov.



Do not place the appliance on a stovetop or any other hot surface.

FEATURES

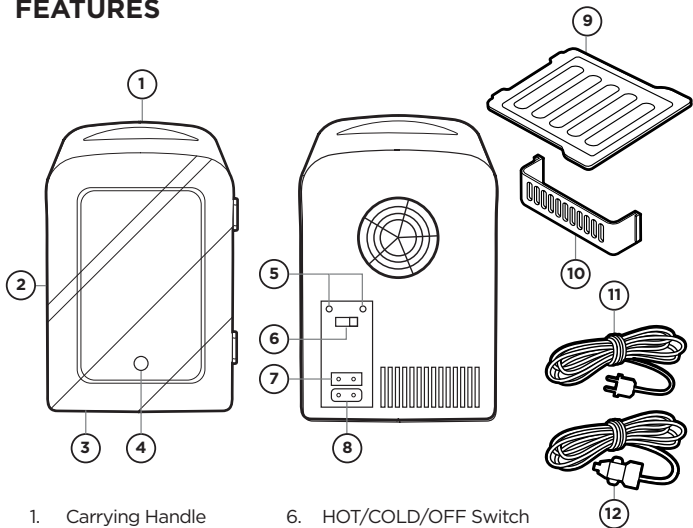

1. Carrying Handle
2. Discreet Door Handle
3. Mirrored Door with LED lights
4. LED light switch
5. Red and Green Indicator Lights
6. HOT/COLD/OFF Switch
7. DC Plug Outlet
8. AC Plug Outlet
9. Removable Shelf
10. Removable Door Shelf
11. AC Cord and Plug
12. DC Cord and Plug

OPERATING INSTRUCTIONS

- When using your personal mini fridge in a car, you can plug it into the cigarette lighter socket, or connect it to a 12V storage battery. When using it at home or at the office, you can plug it into a wall outlet.
- Before using, first connect the plug of the cord into the socket of the personal mini fridge, then connect the other end to the power outlet.
- Once plugged in, you can then slide the switch to Cold or Hot function. Turn the switch to COLD for cooling mode; the green LED light will illuminate. Turn the switch to HOT for warming mode; the red LED light will illuminate.
- When the switch is turned to OFF, the personal mini fridge will function as an insulated box.
- For best results when cooling or heating items, refrigerate items before placing in personal mini fridge on cooling mode, or heat items before putting in warming mode.
- * To turn on LED lights, press button on the front of the fridge.
- The removable door shelf, handy for keeping beauty masks at the ready, lessens space inside the fridge a little. With the door shelf in place, the fridge can hold four 12-ounce cans; to accommodate six, simply remove the shelf.

CLEANING AND MAINTENANCE

- Wipe the outside of the mini fridge with a clean cloth.
- Wash shelves with warm soapy water and dry thoroughly. (Shelves are NOT dishwasher safe.)
- Do not immerse mini fridge or power cords in water.

STORAGE AND DISPOSAL

- Store the appliance in a cool, dry, clean place, out of reach of children and pets.
- Keep the packaging in order to transport the appliance or store the appliance when not in use.

TERMS AND CONDITIONS

Limited Warranty

Our products are backed by a limited 1-year warranty. To register, follow the instructions on the Chefman® Warranty Registration page in this User Guide.

We offer a limited 1-year warranty from the date of purchase. This warranty is void without proof of purchase within the USA, Canada or Mexico.

Service centers and retail stores do not have the right to alter or change the Terms & Conditions of this warranty.

WHAT THE WARRANTY COVERS

- **Manufacturer Defects**

Chefman® products are warranted against defects in material and workmanship for a period of 1 year from the date of purchase, when used in accordance with the Chefman® User Guide.

- **Qualified Replacements**

If your product does not work as it should, we will send you a new one. If the product is no longer available, we will replace it with one that is comparable.

TERMS AND CONDITIONS

Limited Warranty

THIS WARRANTY DOES NOT COVER

- **Misuse** - Damage that occurs from neglectful or improper use of products. See Safety Instructions for information on proper use.
- **Poor Maintenance** - General lack of proper care. See Cleaning and Maintenance Instructions for information on proper maintenance.
- **Commercial Use** - Damage that occurs from commercial use.
- **Altered Products** - Damage that occurs from alterations or modifications by any entity other than Chefman[®]; removal of rating label.
- **Catastrophic Events** - Damage that occurs from fire, floods, or natural disasters.
- **Loss of Interest** - Claims of loss of interest or enjoyment.

CHEFMAN® WARRANTY REGISTRATION

Register your product to add an additional 3 months to your warranty.

What do I Need to Register my Product?

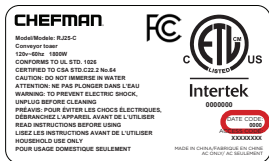

- Contact Information
- Model Number
- Proof of Purchase
(online confirmation, receipt, gift receipt)
- ←•Date code

NOTE: Label depicted here is an example.

How Do I Register my Product?

We offer 2 convenient ways to access the Chefman® registration form:

1. Visit chefman.com/register.
2. Scan the QR code below to access site:



CHEFMAN® WARRANTY REGISTRATION

Need more information?

Please visit us at Chefman.com.

OTHER LIMITATIONS: ALL WARRANTIES OF ANY KIND WHATSOEVER, EXPRESS, IMPLIED AND STATUTORY, ARE HEREBY DISCLAIMED. ALL IMPLIED WARRANTIES OF MERCHANTABILITY AND FITNESS FOR A PARTICULAR PURPOSE ARE HEREBY DISCLAIMED, PROVIDED THAT IF ANY IMPLIED WARRANTIES OF ANY KIND IS REQUIRED BY ANY JURISDICTION, INCLUDING MERCHANTABILITY AND FITNESS FOR A PARTICULAR PURPOSE, THE DURATION OF SUCH IMPLIED WARRANTY IS LIMITED TO ONE (1) YEAR. THIS WARRANTY DOES NOT COVER, AND CHEFMAN® SHALL NOT BE LIABLE, FOR INCIDENTAL, INDIRECT, SPECIAL OR CONSEQUENTIAL DAMAGES, INCLUDING WITHOUT LIMITATION, DAMAGE TO, OR LOSS OF USE OF THE PRODUCT, OR LOST SALES OR PROFITS OR DELAY OR FAILURE TO PERFORM THIS WARRANTY OBLIGATION. THE REMEDIES PROVIDED HEREIN ARE THE EXCLUSIVE REMEDIES UNDER THIS WARRANTY, WHETHER BASED ON CONTRACT, TORT OR OTHERWISE.

This Warranty gives you specific legal rights, and you may also have other rights that vary from state to state or Province to Province. Some states or Provinces do not allow the exclusions or limitations set forth in this Warranty, so the above limitations or exclusions may not apply to you depending on the jurisdiction of purchase.

Chefman® is a registered trademark of RJ BRANDS, LLC.

CHEFMAN



[CHEFMAN.COM](https://www.chefman.com) | [@MYCHEFMAN](https://www.instagram.com/mychefman)

©CHEFMAN 2020