





CHEFMAN®

CHEFMAN®

# ELECTRIC KETTLE+

## QUICK START GUIDE

- Features and Presets
- Before First Use
- Cleaning and Maintenance
- How To Make Tea

@mychefman     

www.chefman.com

©CHEFMAN 2021

RJ11-17-TCTI-SERIES

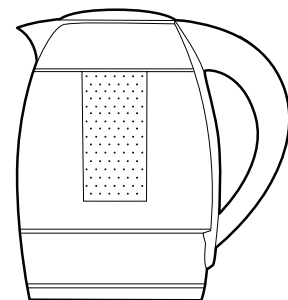

## FEATURES AND PRESETS

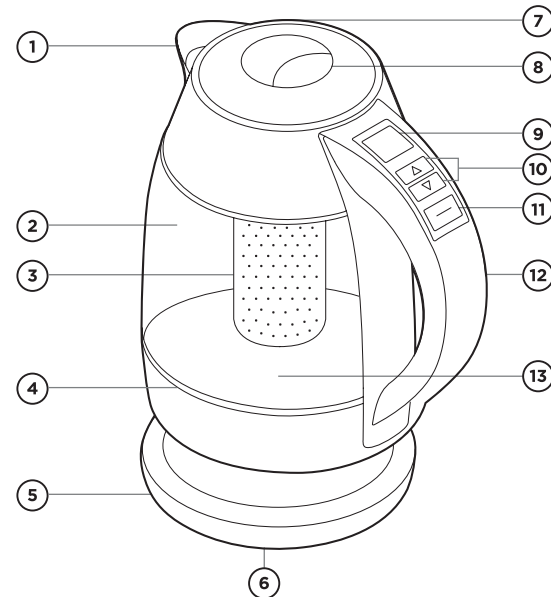

## FEATURES AND PRESETS

1. Drip-free spout
2. Borosilicate glass kettle with water level markings
3. Removable tea infuser (2 parts)
4. Tri-color LED indicator lights
5. 360° swivel power base
6. Out of sight cord storage
7. Lid (opens 90° for easy filling)
8. One-touch lid release button
9. Display
10. Temperature increase/decrease buttons
11. Start/Stop button
12. Stay-cool handle with built-in control panel
13. Coated heating surface

### BUILT-IN PRESETS

- **DELICATE:** 160°F (70°C)
- **GREEN:** 175°F (80°C)
- **WHITE:** 185°F (86°C)
- **OOLONG:** 195°F (90°C)
- **HERBAL:** 212°F (100°C)
- **BLACK:** 212°F (100°C)
- **BOIL:** 212°F (100°C)

### INDICATOR COLORS

- Power Up/Standby:** WHITE
- Heating Water to Temperature:** RED
- Steep Timer/Keep Warm:** GREEN

## BEFORE FIRST USE

1. Remove all packing and materials. Pull out the power cord and place base on a flat surface.
2. Fill kettle with water to the MAX line without tea infuser.
3. Place kettle on base, plug in, set to Boil (212°F), and press Start.
4. When water reaches boil, empty the kettle, then rinse the kettle with clean water. It is now ready for use.  
**NOTE:** Never fill the water above the MAX line or below the MIN line indicated on the kettle.

## CLEANING AND MAINTENANCE

1. Unplug the kettle and allow it to cool completely before cleaning.
2. Clean the interior of the kettle as needed by removing the infuser and carefully rinsing the inside with soapy water. Do not let handle get wet. Rinse inside of kettle thoroughly. Wipe outside of kettle and power base with a damp cloth.  
**WARNING:** Never immerse kettle or power base in water or wash in the dishwasher; doing so will damage the unit.
3. Wash tea infuser in warm soapy water and rinse thoroughly; the infuser is NOT dishwasher-safe.

## HOW TO MAKE TEA

### STEP 1

Fill the kettle to at least the MIN line but not above the MAX line with cold, fresh water, then place kettle securely onto base and plug in.

Choose your preferred temperature, or one of the presets, by pressing the up and down arrows.

Press Start. The indicator lights will turn red indicating heating and average live temperature of the water will display.

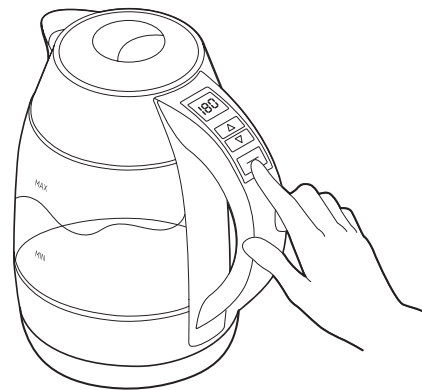

### STEP 2

If using the removable infuser, fill it with either loose tea (about 2 teaspoons per cup) or tea bags based on the amount of water you're heating.

When the final temperature is reached, a Steep Timer will display. The indicator lights will turn solid green and Start/Stop will pulse white. Carefully insert the infuser. Select the suggested steep time or use the arrows to adjust as desired, then press Start. (The indicator lights will slowly pulse green.) When finished steeping, carefully remove the infuser.

**WARNING:** Use extreme caution when adding or removing the infuser as kettle and water will be very hot.

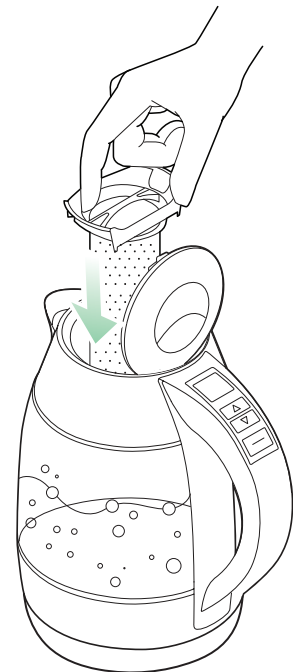

### STEP 3

Lift the kettle off its base to serve. If there is water or tea remaining, return the kettle to the base to keep warm for up to 1 hour.

Otherwise turn off kettle by pressing Start/Stop and unplugging.

**NOTE:** After the Keep Warm period ends, the unit will go into Standby mode. If there is no action within 3 minutes, the unit will go into Sleep mode.

