

Applications

Make	Model	Year	Type
Ford	Focus	2011-2016	ST
	Galaxy	2010-2016	ST Mountune
	Mondeo	2010-2016	ST
	S-MAX	2010-2016	Ti-VCT SCTi EcoBoost

Engine Code

2.0	MGDA, R9DA, TNBA, TNBB, TNWA, TNWB, TPBA, TPWA, XQDA
-----	--

Our products are designed to be used correctly and with care for the purpose for which they are intended. No liability is accepted by Sonic for incorrect use of any of our products, and Sonic cannot be held responsible for any damage to personnel, property or equipment when using the tools. Incorrect use will also invalidate the warranty.

If applicable, the applications database and any instructional information provided has been designed to offer general guidance for a particular tool's use and while all attention is given to the accuracy of the data no project should be attempted without referring first to the manufacturer's technical documentation (workshop or instruction manual) or the use of a recognised authority such as Autodata.

It is our policy to continually improve our products and thus we reserve the right to alter specifications and components without prior notice. It is the responsibility of the user to ensure the suitability of the tools and information prior to their use.

ART NO. 829047

sonic
equipment

Instructions

Engine Timing Kit Ford SCTi Ecoboost Petrol - 2.0



WWW.SONIC-EQUIPMENT.COM

WWW.SONIC-EQUIPMENT.COM

WWW.SONIC-EQUIPMENT.COM

829047 - Engine Timing Kit

Description:

The 829047 kit has been developed specifically for the 2.0 direct Injection chain driven petrol engines fitted with variable valve timing and found in both the Ford and Volvo ranges. 829047 is a 5 piece Engine Timing Kit designed for the Ford 2.0 direct injection ECOBOOST petrol engines found in the Ford Focus, Mondeo and S-Max. Developed to allow the Timing chain to be replaced whilst locking the crankshaft and camshafts in their correct timed positions. The 829047 also includes the crankshaft position sensor alignment tool.

Components

Ref	Comp	OEM	Description
1	4880245	303-1565	Camshaft Alignment Plate
2	4880248		2mm Tensioner Pin
3	4880278	303-1504	Camshaft Alignment Plate
4	4880281	303-1521	Crankshaft Position Sensor Alignment Tool
5	4880049	303-748	Crankshaft Alignment Pin

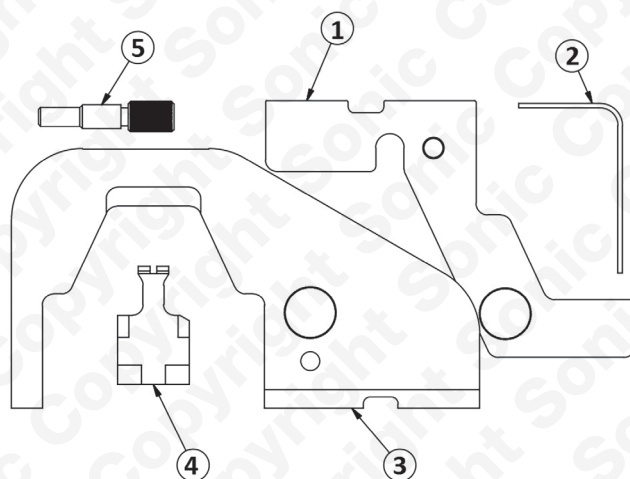

Instructions

The following instructions are for guidance only. Please refer to OEM derived data such as the vehicles manufactures own data or Autodata. The use of these engine timing tools is purely down to the user's discretion and Sonic cannot be held responsible for any damage caused what so ever.

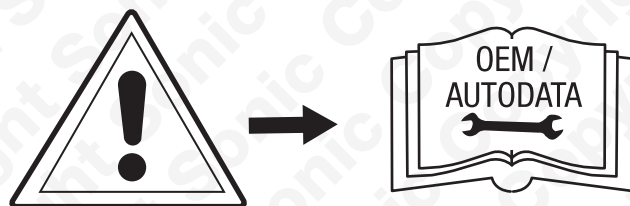

Instructions

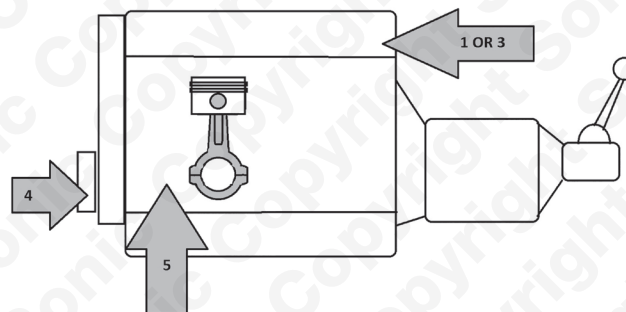

Component Descriptions:

Component 3 - Camshaft alignment plate pre 01/05/2011. Install 1 or 3 as required after component 5 has been installed. It may be necessary to turn the camshafts a small amount, if required use an appropriate wrench on the hexagons on the cams.
Note: when tightening or loosening the cam pulleys always hold the camshafts with a suitable wrench on the hexagons on the camshafts.

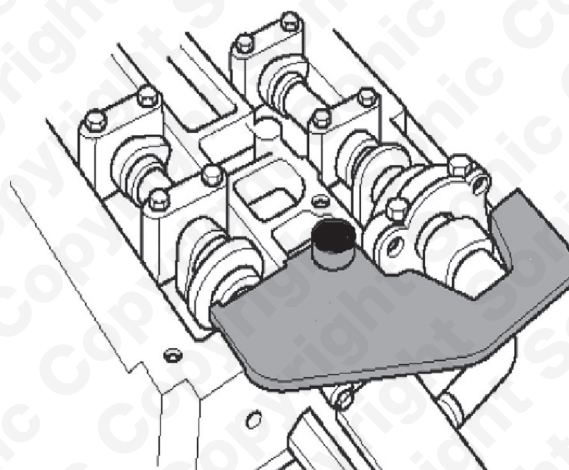

Component 1 - Camshaft alignment plate post 02/05/2011. Fig 2

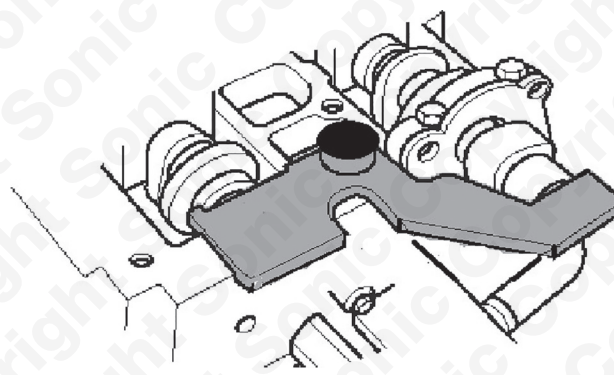

WWW.SONIC-EQUIPMENT.COM

Component 5 - Crankshaft timing pin, designed to screw into the engine block.

Turn the crankshaft to just before TDC, fit component 5 as shown then turn the crankshaft till it contacts 5. As shown.

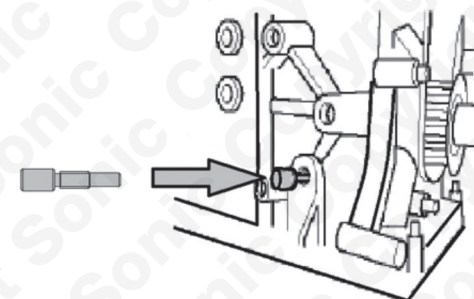

Component 4 = Crankshaft Position Sensor Alignment Tool, used to align the crankshaft position sensor when refitting. The crankshaft sensor is mounted on a slotted bracket that allows the sensor position to be adjusted. Component 4 slides onto the sensor and on to the 20th tooth from the gap in the teeth on the front pulley. In this way it both aligns the sensor with the correct tooth and sets the required distance from the tooth.

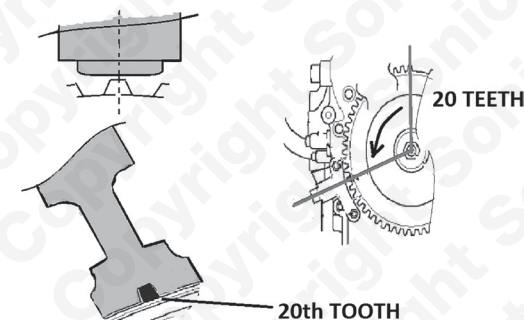

Component 2 = Tensioner Pin, used to lock the cam chain tensioner in its retracted position as shown.

