

## Applications

Make	Model	Year	Type
Citroën	Relay/Jumper	2001-2002	HDi TDi TURBO dTi dCi JTD MAXI
	Relay/Jumper II	2002-2006	
Iveco	Daily	1981-2006	
	Turbo Daily	1986-2000	
Peugeot	Boxer	1999-2002	
	Boxer II	2002-2006	
Renault	Master	1980-1998	
	Master II	1998-2003	
	Master Propulsion	1999-2007	
	Master RWD	1999-2007	
	Mascott	1999-2007	
Fiat	DUCATO	1994-2006	

Engine Code	
2.5	8140.8140.8140.07.8140.21.8140.27S.8140.47.8140.47R.8140.61.8140.67F.37.8140.97.S8U 720.S8U 722.S8U 730.S8U 731.S8U 742.S8U 748.S8U 750.S8U 758.S8U 762.S8U 763.S8U 770.S8U 772.S8U 780.S8U 782.S9U 700.S9U 704.S9U 714.S9U 740
2.8	8140.63.8140.43.8140.43S.8140.23.37.8140.43.37.8140.43C.8140.43B.8140.43N.8140.43R.8140.43.39.8140.63.37.S9W 702.S9W 700.S9W 206.S9W 212

Our products are designed to be used correctly and with care for the purpose for which they are intended. No liability is accepted by Sonic for incorrect use of any of our products, and Sonic cannot be held responsible for any damage to personnel, property or equipment when using the tools. Incorrect use will also invalidate the warranty.

If applicable, the applications database and any instructional information provided has been designed to offer general guidance for a particular tool's use and while all attention is given to the accuracy of the data no project should be attempted without referring first to the manufacturer's technical documentation (workshop or instruction manual) or the use of a recognised authority such as Autodata.

It is our policy to continually improve our products and thus we reserve the right to alter specifications and components without prior notice. It is the responsibility of the user to ensure the suitability of the tools and information prior to their use.

# SONIC

equipment

## Instructions

### Engine Timing Kit Fiat, PSA, Opel, Iveco JTD Diesel - 2.5



## 829026 - Engine Timing Kit

### Description:

The 829026 is a small diesel locking kit specifically assembled to cover the 2.5/2.8 belt driven diesel engines found in the Citroën, Peugeot, Renault and Fiat ranges.

## Components

Ref	Comp	OEM	Description
1	4880132	1 860 638 000	Tensioner Retainer Tool
2	4880095	1 870 667 000, 1 870 765 001	Crankshaft Locking Pin
3	4880090	1 860 617 000	Camshaft & Fuel Pump Setting Pins 5mm x 50 x2

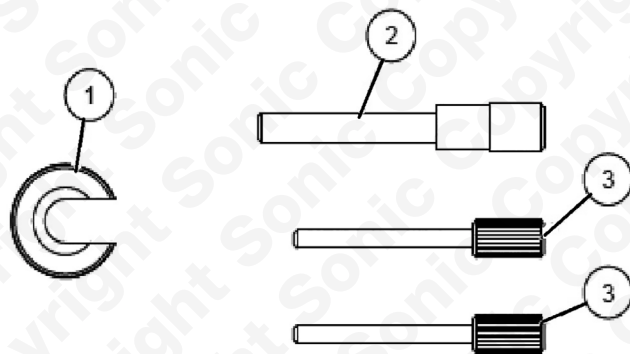

## Instructions

### Component 1 - Tensioner Retainer Tool

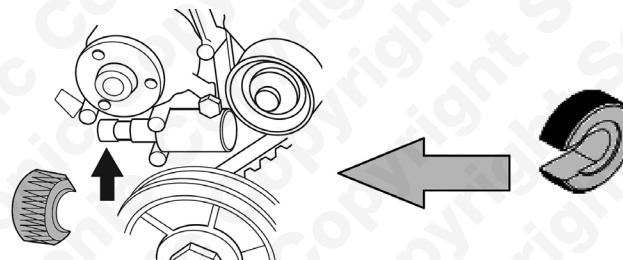

### Component 2 - Crankshaft Locking Pins

Component 2 is used to lock the flywheel with the crankshaft at TDC number 1 cylinder.

NB: do not tighten or loosen fixings against component 1.

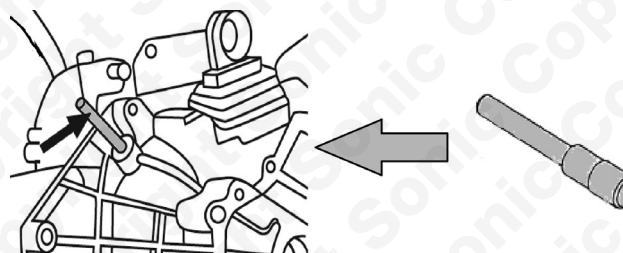

### Component 3 - Camshaft & Fuel Pump Pulley Setting Pins

Component 3 is used to align the camshafts and the high pressure fuel pump pulley.

## Instructions

The following instructions are for guidance only. Please refer to OEM derived data such as the vehicles manufactures own data or Autodata.

The use of these engine timing tools is purely down to the user's discretion and Sonic cannot be held responsible for any damage caused what so ever.

