

Applications

Make	Model	Year	Types
Peugeot	Bipper	2010-2016	
Citroën	Nemo	2010-2016	
Fiat	Punto/Punto Classic	2003-2011	
	500/500C	2007-2016	
	Panda/Panda Classic	2003-2011	
	Doblo	2004-2014	
	Grande Punto	2005-2010	
	Idea	2004-2011	
	Linea	2007-2011	
	Punto Evo	2009-2011	HDi JTD
Lancia	Musa	2004-2011	MultiJet 70 MultiJet 75
	Ypsilon	2003-2011	JTDM
Subaru	Justy G3X	2004-2009	MultiJet 90 DDiS
Suzuki	Ignis	2003-2009	CDTi ecoFLEX TDCi
	Splash	2008-2010	
	Swift	2004-2010	
	Wagon R+	2003-2008	
Opel/Vauxhall	Agila	2003-2010	
	Combo	2003-2012	
	Corsa	2003-2013	
	Meriva	2004-2010	
	Tigra	2004-2010	
Alfa Romeo	MiTo	2008-2010	
Ford	KA	2008-2015	

Engine Code

1.3	F13DTE5 (FHZ), FHZ (F13DTE5), 188A9.000, 169A1.000, 188A8.000, 199A3.000 Z13DT, Z13DTJ, Z13DTI
-----	---

Our products are designed to be used correctly and with care for the purpose for which they are intended. No liability is accepted by Sonic for incorrect use of any of our products, and Sonic cannot be held responsible for any damage to personnel, property or equipment when using the tools. Incorrect use will also invalidate the warranty.

If applicable, the applications database and any instructional information provided has been designed to offer general guidance for a particular tool's use and while all attention is given to the accuracy of the data no project should be attempted without referring first to the manufacturer's technical documentation (workshop or instruction manual) or the use of a recognised authority such as Autodata.

It is our policy to continually improve our products and thus we reserve the right to alter specifications and components without prior notice. It is the responsibility of the user to ensure the suitability of the tools and information prior to their use.

SONIC

equipment

Instructions

Engine Timing & Rebuild Set

Fiat, Opel, Ford, PSA JTD Diesel - 1.3



829016 - Engine Timing & Rebuild Set

Description:
829016 has been developed to allow the user to change the Cam chain on the later 1.3 JTD/CDTi & HDi diesel engines found in the PSA, Fiat, Ford, Suzuki and Opel ranges.

Components

Ref	Comp	OEM	Description
1	4880200	1 871 000 200, 303-1469, KM-662-C	Crankshaft Pulley Flange Holding Tool
2	4880004	1 870 900 400	Timing Chain Tensioning Tool
3	4880005	0104-C, 1 870 900 300, 303-1468	Crankshaft Alignment Tool
4	4880183	0104-A, 1 871 000 900, 1 860 985 000, EN 46781, 09917-68610	Camshaft Alignment Tool Assy. x2
5	4880186	EN 46785, 09912-38300	Crankshaft Pin Assembly
6	4880096	FIAT 8mm PIN	Crankshaft Locking Pin (8mm Dia. 70 Long)

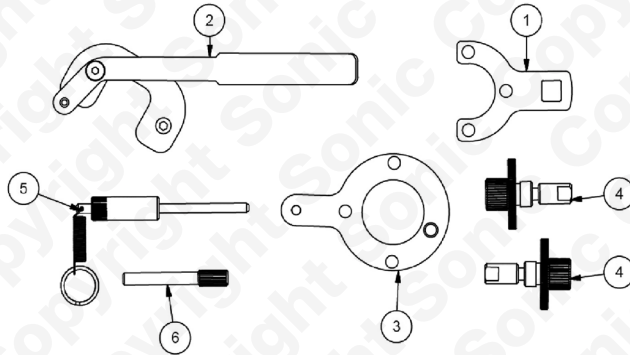

Instructions

The following instructions are for guidance only. Please refer to OEM derived data such as the vehicles manufactures own data or Autodata. The use of these engine timing tools is purely down to the user's discretion and Sonic cannot be held responsible for any damage caused what so ever.

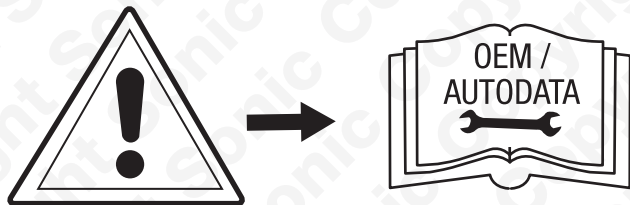

Instructions

- Align all timing marks as described by OEM instructions.

Component 1 - Crankshaft Pulley Flange Holding Tool
Component 1 is to hold the pulley flange while loosening the fixing bolt.

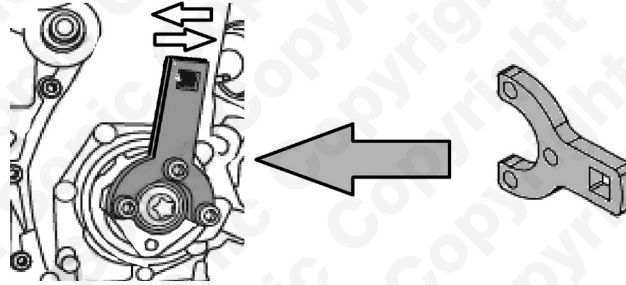

Component 2 - Timing Chain Tensioning Tool
Component 2 is used to clamp the timing chain when replacing the gasket on the one-piece cylinder head. The tool is attached in alignment with the inspection opening on the engine control cover so that the pin acts upon the ribs of the chain slider. Retract the chain tensioner piston so that it moves back to its locked position using the lever. Ensure the tensioner has fully extended first before trying to retract it.

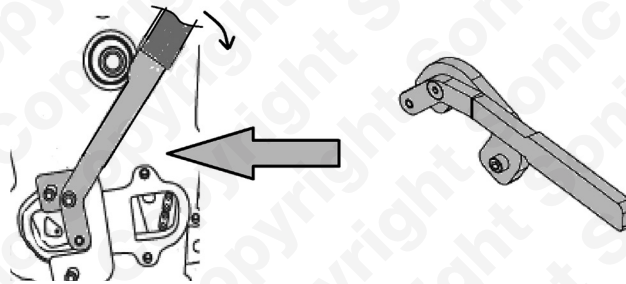

Component 3 - Crankshaft Alignment Tool
Component 3 is used to lock the crankshaft in its timed position. Component 3 fits in place of the flywheel.

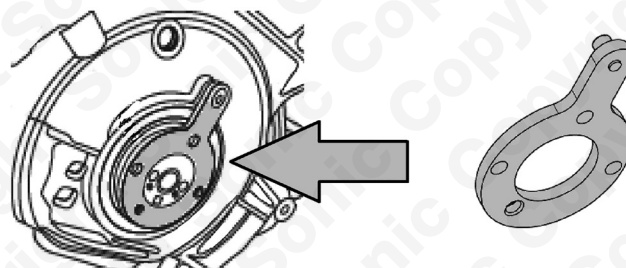

Component 4 - Camshaft Alignment Tool Assy X2
Access must first be gained to the blanking plugs that are positioned one on the front of the cam cover and one on the rear of the cam cover. Lift the high pressure fuel rail and engine wiring harness to gain access. Remove the blanking plugs and screw the locking tools into place with the flats on the inner section of the tools horizontal. The tools are correctly fitted when the inner section of the tools can be easily pushed in with finger pressure.

NOTE: Never Tighten or Loosen camshaft fixings with component 2 fitted

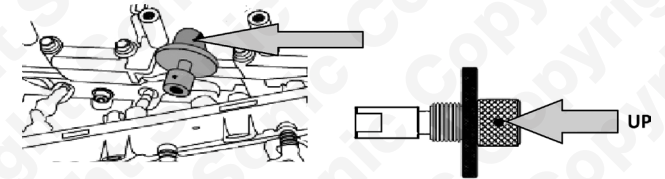

Component 5 - Crankshaft Pin Assembly (Opel/Vauxhall & Suzuki)

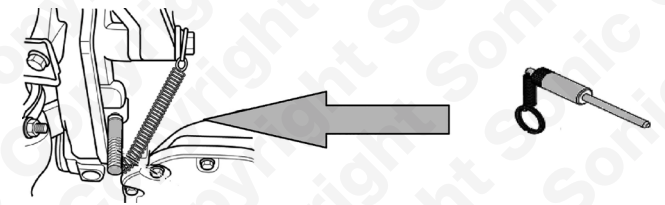

Component 6 - Crankshaft Locking Pin (8mm Dia. 70 Long) (Fiat)

