

Exway Wave Hub/Riot User Manual

Riot

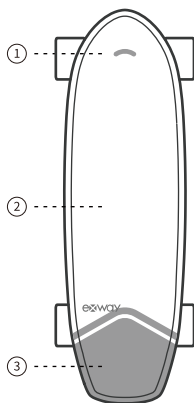

Hub

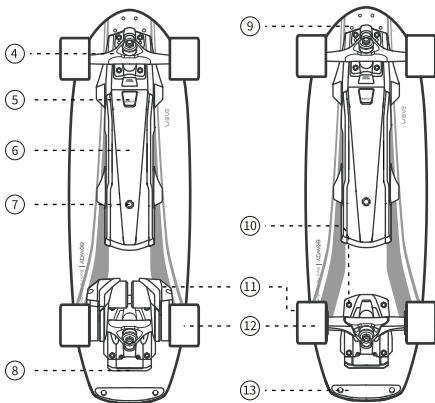

- ① Nose
- ② Grip Tape
- ③ Kicktail
- ④ Truck
- ⑤ Charging Port
- ⑥ Battery
- ⑦ Status Indicator/Power Button
- ⑧ Taillight
- ⑨ Front Extension Port
- ⑩ Motor Controller
- ⑪ Brushless Motors
- ⑫ Brushless Motors/Wheel
- ⑬ Tail Puck

Top Speed: 23mph / 38kph

Hill Climbing: Up to 25% Grade

Range: 15miles / 24km

(Actual data varies depending on rider weight and riding conditions.)

Weight: Riot 7.3kg / Hub 6.9kg

Torque: Riot 4.3Nm × 2 / Hub 3.8Nm

Max Current: 1000W × 2

Rated Current: 430W × 2

Max Amperage: 4A

Power: 100-240VAC, 50 / 60Hz

Battery Capacity: 216Wh

Charging Time: 3.5 hours (1:20 hours with the fast charger)

Trucks: Exway Trist 45° 7"

Brakes: 4 Ride Modes for Beginners to Pros

Recommended Age Range: 16-50 Years

Max Load: 100kg / 220lbs

Waterproof Level: IP53

Battery Swap:

② Press and Hold Down the Battery Release Button

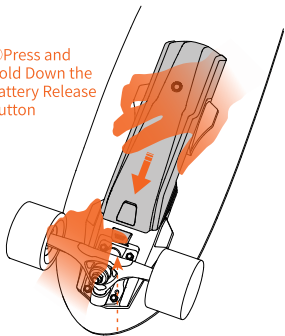

② Slide Battery Backward to Remove

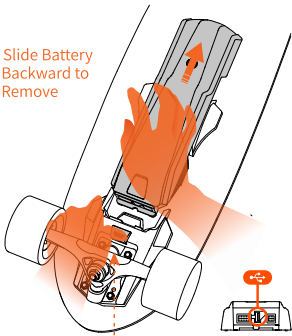

① Press and Hold Down the Battery Release Button



The battery is also equipped with a USB port with 5V-2.1A to charge your devices.

Battery Installation: The battery also has a USB port with 5V-2.1A to charge your devices. (Align both the ports from the battery and deck. Slide the battery into place ensuring that it is securely mounted. Failure to ensure that the battery is correctly mounted could result in severe injury or death.)

Battery Removal: Press down on the button located near the front trucks. While holding the puck, slide the battery towards the rear trucks and lift away from the board.

Install the front lights

Put the lights on the nose of the board and screw the four screws. To switch on the lights, double-tap the remote while the board is connected. To install the front-facing lights, place the lights on the nose of the board, and ensure that the screw holes match with the holes on the board. Screw light in with the four screws provided. Ensure that each screw is fully tightened.

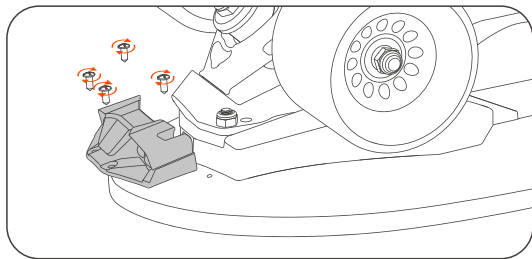

board Indications:



Show the Remaining Range

Single tap while the board is powered off.



State of Charge

When the battery is plugged in to charge, the four status lights will indicate battery level. When the battery is plugged in to charge, the four status lights will indicate battery level.



Power On

Long press for 2 seconds.



Pairing Mode

Long press for 8 seconds while the board is powered off.



Power Off

Long press for 3 seconds while the board is turned on.



Hard Reset

Fast tap 7 times while the board is powered off.

CAUTION:

1. When the skateboard battery has 5% left, the power output will be cut off to better protect the battery. (In free mode, both the power output and brakes will be restricted)
2. Connect the magnetic port on the charger to the power button on the board before plugging into the wall outlet. (Only use an original Exway X1 pro charger)

BY THE WAY:

1. The board will charge for around 3.5h with the standard charger. The indicator on the charger will turn green when the battery is full.
2. This version of the user manual may not be updated, check out the Exway App or www.exwayboard.com to read the most up-to-date version.

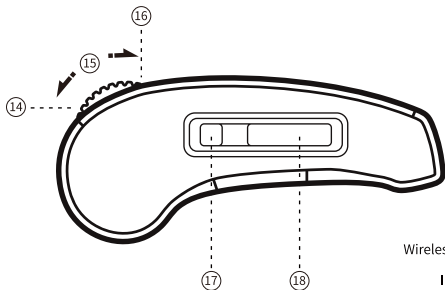

⑭ Acceleration (roll the throttle forward)

⑮ Throttle Wheel

⑯ Breaking (roll the throttle back)

⑰ Multi-Button

⑱ OLED screen

Screen : OLED 0.9"

Wireless Frequency : 2.4GHz

Input Voltage : 5V 1A

Remote Control Operation:



Switch Off (Standby Mode)

Press the Multi-Button for 3 seconds.



Change Ride Mode

Short press the Multi-Button.

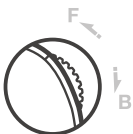

Accelerate/Break

Roll the throttle wheel forward/back.



Change Direction

Triple-tap the Multi-Button.



Turn on/off the Headlight

Double-tap the Multi-Button.

Pairing Remote to Board:



Pairing Mode

Long press 8 sec on the board to turn on pair mode.



Setting Mode

Long press the Multi-Button on the remote for 5 seconds to get into settings mode.



Choose the first option “Re-Pair” by tapping on the Multi- Button.



Choose your board and click “OK”.

Remote Control Calibration



Push the roller forward to the bottom without letting go, press A button to Confirm.



Calibrate the neutral position, release the roller to make it frss, press A button to confirm.



Press A button to confirm when calibration is complete and the calibration interface is automatically exited.

WARNINGS



LOW TEMPERATURE

LOW TEMPERATURE

Temperature is below 0°C (Caution frost).



BATTERY(55°)

BATTERY TEMPERATURE WARNING

Battery temperature is over 55°C



ESC OVERHEAT

ESC HIGHTEMPERATURE WARNING

ESC temperature is over 100°C



ESC OVERHEAT

ESC OVERHEATING WARNING

ESC temperature is over 120°C.

(Stop using your board immediately to allow it to cool)



MOTOR OVERHEAT

MOTOR HIGH TEMPERATURE WARNING

Motor temperature is over 100°C.



MOTOR OVERHEAT

MOTOR OVERHEATING WARNING

Motor temperature is over 120°C. (Stop using your board immediately allow it to cool)



MOTOR BREAKDOWN

MOTOR BREAKDOWN

Motor Seizing



HIGH VOLTAGE(51V)

HIGH VOLTAGE(51V)

Voltage is too high



HIGH VOLTAGE(51.8V)

HIGH VOLTAGE(51.8V)

Voltage is too high (Danger risk ! Discharge it Before use)



LOW TEMPERATURE

Low Charge temperature



BATTERY OVERHEAT

Battery is overheating while charging.



REMOTE DISCONNECTED

Remote is not connected to board.



BMS ERROR

Error with the smart battery management system.

In the box:



①



②



③



④



⑤



⑥



⑦

① Exway Wave

② Remote

③ Charger

④ Remote Charging Cable

⑤ Skate Tool

⑥ User Manual

⑦ 2.0 mm L Wrench
2.5 mm L Wrench
5.0mm L Wrench

Warnings & Safety Information

1. Whenever you ride an Exway board, you risk death or serious injury from loss of control, collisions, and falls. To ride safely, you must read and follow all warnings and instructions in this manual.
2. Always wear a helmet when riding. Never ride in water, wet surfaces, in the rain, slippery or uneven surfaces, steep hills, traffic, cracks, train tracks, gravel, rocks, or any obstacles that could cause a loss of traction. Avoid night riding, areas with poor visibility, and narrow spaces.
3. Do not ride an Exway board in environments, on inclines, or at speeds where you would not be safely in control of an unpowered skateboard. In the event of wireless interference or battery fault, you may need to rely on skating techniques like foot-braking or sliding to stop.
4. Please ride responsibly and respect those around you. How you ride will determine how people view this new mode of transportation.
5. The version of the user manual may not be up to date, check out the Exway App or www.exwayboard.com to read the most up to date version.
6. If you do not use your board for long periods of time, please discharge and recharge your board every 30 days.
7. Scan QR code to download the App and get the most up to date version of the user manual.
8. Do not store board at 100% battery charge for extended periods of time, doing so will permanently damage the battery. Maintain around 60% charge when storing for a long time and do not allow battery charge to go below 40%.



iOS



Android



- Scan the QR code to download the APP to get the · electronic version of the manual
- 扫描二维码下载APP获得电子版说明书
- 掃描二維碼下載APP獲得電子版說明書
- QRコードをスキャンしてAPPをダウンロードし、電子版のマニュアルを取得します
- QR 코드를 스캔하여 전자 버전의 설명서를 받으려면 APP를 다운로드하십시오.
- Scannen Sie den QR-Code, um die APP herunterzuladen und die elektronische Version des Handbuchs zu erhalten.
- Scannez le code QR pour télécharger l'application pour obtenir la version électronique du manuel.

