

**CabinAir**  
Nordzone™ Air quality monitor  
User Guide

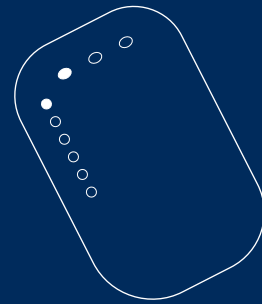

This document and its content, including written material and images, are the property of CabinAir Sweden AB. You may not copy, reproduce, modify, republish or distribute this document or any of its content without express written permission from CabinAir Sweden AB.  
© 2023, CabinAir Sweden. All rights reserved.



This document and its content, including written material and images, are the property of CabinAir Sweden AB. You may not copy, reproduce, modify, republish or distribute this document or any of its content without express written permission from CabinAir Sweden AB.  
© 2023, CabinAir Sweden. All rights reserved.  
501430 revB

### Safety instructions

Read these safety instructions carefully and take necessary precautions to reduce the risk of fire, electric shock or injury.

- WARNING!**  
Warning indicates a hazardous situation that could result in death or serious injury.
- Do not use the product if the main power cord or cables are damaged. Contact your retailer for a replacement.
  - Keep the product away from heat, liquids, detergents and flammable solvents.
  - Do not use the Nordzone™ app while driving.

- CAUTION!**  
Caution indicates a hazardous situation that could result in minor or moderate injury.
- Do not alter any parts in any way.

- DISCLAIMER**
- The product warranty only applies if the product is installed according to these instructions and when original parts are used. For more information about warranty visit [www.cabinair.com](http://www.cabinair.com).
  - CabinAir Sweden AB cannot be held liable for any product or vehicle damage, or personal injuries sustained by the user or others due to faulty installation or usage.

### The Nordzone™ Air quality monitor

The user can upgrade the Nordzone System with the Nordzone Air quality monitor. The monitor is included as part of the Nordzone System Premium unit, or purchased separately. This unit monitors and visualizes the levels of particles and gases inside the cabin and will alert the user to temporarily increased levels of PM, VOCs and CO<sub>2</sub> in situations like traffic jams, tunnel driving or overuse of recirculation mode.

The design is discrete, and the user interface is easy to understand at a glance, meaning you can focus on the driving.

### Interface

The Nordzone™ Air quality monitor measures air quality continuously, displaying the result on the light scale. There are separate light scales, one for PM levels (A) and one for VOCs and CO<sub>2</sub> (B).

- White light** = no action needed.
  - Orange light** = pay attention and take action.
  - Red light** = take immediate action.
- Healthy air** – no action needed.
  - Fresh air but not clean** (increased PM<sub>2.5</sub>) – close windows, temporarily activate recirculation mode.
  - Clean air but not fresh** (increased VOCs/CO<sub>2</sub>) – open fresh air intake.

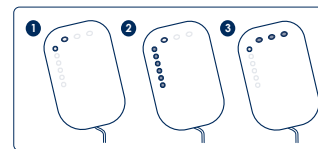
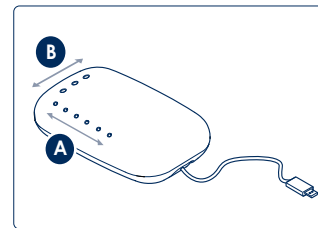

### Installation and placement

- IMPORTANT!**  
Do not cover the unit: Place the Nordzone™ Air quality unit in a position where the air can fully circulate.

The Nordzone Air quality monitor should be placed inside the cabin where the driver can see the interface clearly without being distracted from driving. Mount the air quality monitor in an at-a-glance position close to the power connection. The air quality monitor has a magnetic bottom plate (magnetic holder not included) and also a bottom surface with high friction rubber. The Nordzone Air quality monitor is connected via USB-C cable.

### The Nordzone™ app

The app contains detailed information about your Nordzone System product. It indicates that it is working properly and displays the correct product version. When paired with Nordzone Air quality monitor the app compares real-time air quality data in-cabin and outdoors. It also shows historical data and gives recommendations for how air quality can be further improved.

Find the latest version of the Nordzone app at [www.cabinair.com](http://www.cabinair.com).

### How to improve the air quality in your car

- Close all windows to prevent polluted air entering the cabin without passing the Nordzone™ System filtration solution.
- Avoid overuse of recirculation mode as this may cause CO<sub>2</sub> to build up, leading to drowsiness.
- If the app or monitor indicates increased particle levels in situations such as driving in tunnels, temporarily turn on air recirculation. Make sure fan speed is at a sufficient level and follow the air quality progress in the app or on the monitor to track CO<sub>2</sub> build up.
- If the app or monitor indicates increased VOCs and CO<sub>2</sub> levels, turn on fresh air mode.

### Support

For information regarding support visit [www.cabinair.com](http://www.cabinair.com).

### Warranty

The two (2) year CabinAir limited warranty only applies when the original parts are used and when the product is installed and used according to the instructions of this user manual. For more information visit [www.cabinair.com](http://www.cabinair.com).

### Troubleshooting

Situation	Recommendation
Nordzone™ Air quality monitor does not light up when ignition is turned on.	<ol style="list-style-type: none"> <li>Check that the power source is correctly connected.</li> <li>Contact your retailer if the problem remains.</li> </ol>

### Technical specification

Connectivity	Bluetooth*
Operating supply voltage	5VDC (USB)
Current consumption	0.5A
Operating temperature	- 10 °C to 50 °C
Functional lifetime	80,000 km / 5 years
Frequency range	2,402-2,480 GHz
Output power	-8dBm (CE)
Firmware version	1.0
Hardware version	1.0

### Environment protection

Let's protect the environment! Our products are sustainable designed, and all packaging can be recycled. Do not discard filters or any electronic parts with household waste. Please make sure to follow official guidelines and regulations specific to your region for the most accurate and up-to-date waste disposal recommendations.

Model Code: 9001 012 00 FCC ID: 2AXCNNZQM  
This device complies with Part 15 of the FCC Rules. Operation is subject to the following two conditions:  
(1) this device may not cause harmful interference, and  
(2) this device must accept any interference received, including interference that may cause undesired operation.

\*The Bluetooth® wordmark and logos are registered trademarks owned by Bluetooth SIG, Inc. and any use of such marks by CabinAir Sweden AB is under license. Other trademarks and trade names are those of their respective owners.

# CabinAir

## Nordzone™ 空气质量监测仪

### 用户手册

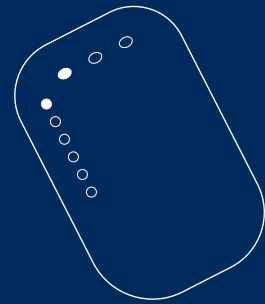

本文件及其中所有内容，包括书面材料及图片，都归 CabinAir Sweden AB 所有。

在未获得 CabinAir Sweden AB 书面允许的情况下，您不得对其中任何内容进行复制、再造、修改、翻版或传播。

© 2023, CabinAir Sweden 版权所有，违者必究。



本文件及其中所有内容，包括书面材料及图片，都归 CabinAir Sweden AB 所有。在未获得 CabinAir Sweden AB 书面允许的情况下，您不得对其中任何内容进行复制、再造、修改、翻版或传播。  
© 2023, CabinAir Sweden 版权所有，违者必究。  
501430 revB

### 如何改善车内空气质量

- 关闭所有窗户，防止污染空气不通过 Nordzone™ 系统直接进入座舱。
- 避免过度使用内循环模式，减少因 CO<sub>2</sub> 累积而导致困乏的风险。
- 在例如隧道中行驶时，如果 app 或监测仪显示颗粒物污染水平增高，则请暂时开启内循环模式。
- 确保风扇速度处于相当的水平，并在 app 或监测仪上跟踪空气质量的进展以及 CO<sub>2</sub> 的积聚水平。
- 如果 app 或监测仪显示 VOCs 和 CO<sub>2</sub> 水平升高，则开启新风模式。

### 用户界面

Nordzone™ 空气质量监测仪持续测量空气质量，并使用指示灯显示监测结果。有两组不同指示灯，一组指示灯用于 PM 水平 (A)，另一种用于 VOCs 和 CO<sub>2</sub> 水平 (B)。

- **白色灯光** = 不需要任何操作。
- **橙色灯光** = 请注意并采取适当措施。
- **红色灯光** = 请马上采取措施。

- 1 健康空气** – 不需要任何操作。
- 2 空气新鲜但不洁净** (升高的 PM<sub>2.5</sub>) – 关闭车窗，并短时开启内循环模式。
- 3 空气洁净但不新鲜** (升高的 VOCs/CO<sub>2</sub>) – 请马上采取措施。

### 安全指南

仔细阅读安全指南，并采取必要的预防措施，以减少火灾、触电或受伤的风险。

**警告!**  
警告表示某种危险情况，如果不加以避免，可能会导致死亡或严重伤害。

- 如果主电源接头或电源线有损坏，请勿使用本产品。联系您的零售商要求更换。
- 使产品远离热源、液体、清洁剂或易燃溶剂。
- 开车时，请不要使用 Nordzone™ app。

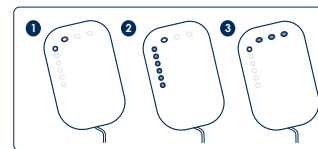
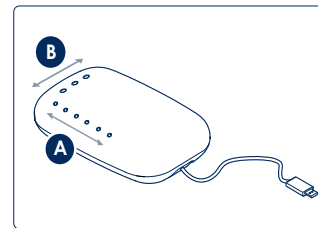

### 故障排除

状况	推荐的操作
车辆点火后 Nordzone™ 空气质量监测仪指示灯未亮起。	1. 检查电源连接是否正确。 2. 如果仍然存在有问题，请与零售商联系。

### 帮助

关于帮助信息，请访问 [www.cabinair.com.cn](http://www.cabinair.com.cn)。

### 质保周期

两 (2) 年的 CabinAir 有限保修期仅适用于使用原装部件，以及按照本用户手册中的说明安装和使用产品。

更多信息请访问 [www.cabinair.com.cn](http://www.cabinair.com.cn)。

**小心!**  
小心表示某种危险情况，如果不加以避免，可能会导致轻度或中度伤害。

- 不要以任何方式更换任何零件。

### 免责声明

- 产品的质保条款只适用于产品按照此用户指导手册安装并使用原装配件。更多信息，请访问 [www.cabinair.com.cn](http://www.cabinair.com.cn)。
- CabinAir Sweden AB 不对任何产品，车辆损坏，用户或其他人员因安装或使用不当而遭受的人身伤害负责。

### 安装和放置位置

**重要!**  
**不要遮盖产品:**  
将 Nordzone™ 空气质量监测仪放置在空气流通的位置。

Nordzone 空气质量监测仪应该被放在座舱内，这样便于观察，又不会分散驾驶员的注意力。将空气质量监测仪安装在靠近电源并且一目了然的位置。空气质量监测仪带有磁性底板 (磁性支架并未提供) 和一个高摩擦橡胶底面。Nordzone 空气质量监测仪是通过 USB-C 连接。

### The Nordzone™ 空气质量监测仪

本仪器监测和显示座舱内颗粒物和气体的水平，并在交通堵塞、隧道行车或过度使用再循环模式等情况下，可对颗粒物、VOCs 和 CO<sub>2</sub> 水平的临时升高发出警报。

设计是极简风格并提供可轻易查看的用户界面，所以您可以时刻关注驾驶。

### The Nordzone™ app

该应用程序包含您购买的 Nordzone 系统产品的详细信息。它可显示工作状态，并显示正确的产品版本号。当与 Nordzone 空气质量监测仪配对时，该应用程序会比较座舱内和室外的实时空气质量数据。它还可显示历史数据，并就如何进一步改善空气质量提出了建议。

从 [www.cabinair.com.cn](http://www.cabinair.com.cn) 找到最新版本的 Nordzone app。

### 技术参数

连接性	蓝牙*
工作电压	5VDC (USB)
消耗电流	0.5A
工作温度	-10 °C to 50 °C
使用寿命	80,000 km / 5 年
频率范围	2,402-2,480 GHz
输出功率	-8dBm (CE)
固件版本	1.0
硬件版本	1.0

### 保护环境

让我们一起保护环境! 我们的产品采用可持续设计，所有包装均可回收。请勿将滤波器或任何电子零件与家庭垃圾一起丢弃。请务必遵守您所在地区的官方指南和法规，以获得最准确和最新的废物处理建议。

型号代码: 9001 012 00 FCC ID: 2AXCNNZAQM  
本设备符合 FCC 规则第 15 部分的规定。操作须符合以下两个条件:  
(1) 此设备不得造成有害干扰，以及  
(2) 本设备必须接受任何接收到的干扰，包括可能导致意外操作的干扰。

\*Bluetooth® 字标和标志是 Bluetooth SIG 公司拥有的注册商标，CabinAir Sweden AB 公司对该等商标的任何使用均已获得许可。  
其他商标和商品名称属于各自的所有者。