

Glass Rinser INSTALLATION INSTRUCTIONS

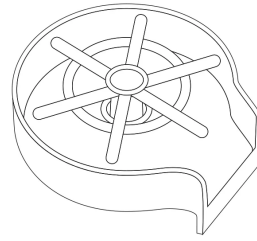

Prior to Installation:

- Inspect product to ensure no damages have occurred while in shipping.
- The step-by-step guidelines in the installation instructions are a general reference. Should there be any discrepancies, **TheWishCrate** cannot be held liable. It is recommended to install all **TheWishCrate** products by hiring a licensed professional.
- Read installation and maintenance instructions thoroughly before installing. Be sure to use proper tools and always wear proper personal safety accessories for your protection.
- Check installation area and make sure nothing is within 2" of the installation hole as it may interfere with the product.



Recommended Tools:

- Wrench
- Silicone
- Bucket
- Flashlight

Included Parts:

- Glass Rinser
- T-Pipe
- Washers
- Supply Hose

1. Turn Off Water Supply

- Turn off water supply at angle stops.

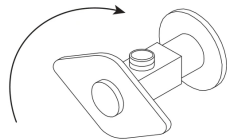

2. Disassemble

- Remove rubber washer and support washer from the mounting shank.

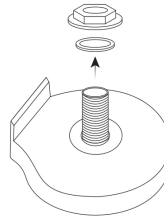

3. Install Rinser

- Place mounting shank through sink hole.
- From below, screw on the rubber washer and support washer to the mounting shank to secure.

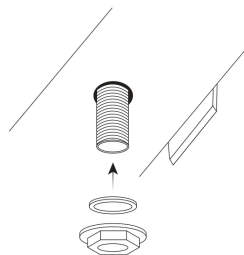

4. Connect Water Supply

- Attach water supply hose to the base of the rinser.
- Connect other end of water supply hose to angle stops using the T-pipe.
- Turn on and check for leaks.

