



For more details on operating this timepiece  
please refer to the enclosed booklet or visit :

[WWW.TSOVET.COM/IM](http://WWW.TSOVET.COM/IM)

VOL.1.05 EN



# TSOVET

## INSTRUCTION MANUAL

# SLR FW42 SOLAR POWER CHRONOGRAPH

## SOLAR-POWERED WATCH

This timepiece is provided with a rechargeable battery for exclusive use with the watch. Unlike with conventional battery-powered watches, therefore, battery replacement is not necessary.

Expose the watch to sunlight or strong artificial light for charging.

The solar cell is a clean energy source and has no adverse effect on the natural environment.

To ensure correct care, please take some time to review the enclosed instructions to review how to operate your watch.

## FEATURES

### **1.Solar-powered watch**

This watch is a solar-powered watch containing a solar cell underneath the dial to convert any form of light into "electrical energy" and store the power in a secondary battery.

### **2.Eliminating the need for battery replacement**

Unlike conventional quartz watches, this watch does not use a silver oxide battery, thus eliminating the need for battery replacement.

### **3.You can use the dial which light transmittance is more than 30%**

It is possible to assemble the dial which transmits light on the solar cell. It enabled to cover the solar cell color, and you can design variety colors of dials.

### **4.Running time**

Expected running time from full charge to stoppage will be around 6 months.

### **5.Power depletion warning function**

The two-second intervals movement of the second hand is a signal of energy depletion. The watch continuous running time after two-second intervals movement is approximately 1 week.

### **6.Over charge prevent function is equipped**

If the secondary battery is charged more than predetermined voltage, over charge prevent function is operated to prevent the secondary battery deterioration and breakage.

## DISPLAY

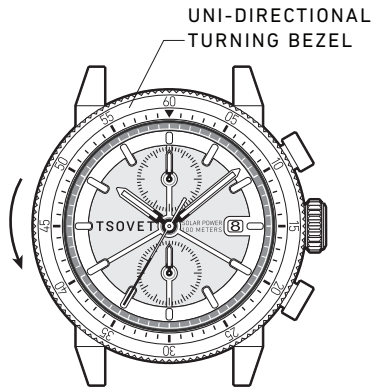
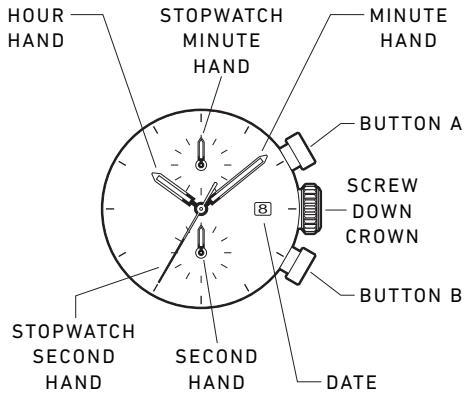

PLEASE READ THE FOLLOWING BEFORE UNSCREWING THE CROWN:

## SCREW-DOWN CROWN

Screw-down crowns are used to ensure water resistance. ALWAYS be certain that your crown is securely screwed down (Position [0] is secured. Positions [1], [2] and [3] are not secured for water resistance).

Do **NOT** unscrew your crown while you are in any environment where moisture is present.

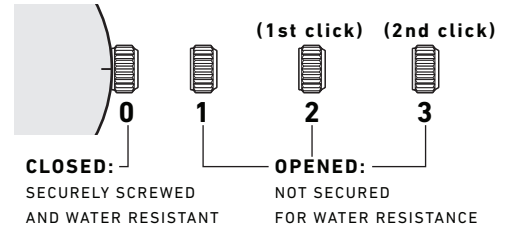

## USING THE SCREW-DOWN CROWN

DO NOT PULL THE CROWN UNLESS IT IS UNSCREWED FIRST:

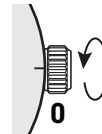

### TO UNSCREW:

Turn the crown anti-clockwise until it turns freely without tension. GENTLY pull the crown out to the other desired positions for watch setting (see specific operating instructions on the following pages).

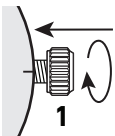

#### **TO SCREW:**

Push the crown **ALL THE WAY IN** (towards the watch) **THEN** begin to turn clockwise until it is securely screwed down.

**NOTE:** Failure to **SECURELY** screw down the crown after setting the watch may affect its water resistance.

## **HOW TO CHARGE AND START THE WATCH**

### **CHARGING THE WATCH**

When you start the watch or when the energy remaining in the secondary battery is very low, charge it sufficiently by exposing the watch to light.

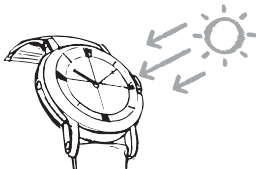

1. Expose the watch to sunlight or strong artificial light (of more than 1,000 Lx).

When the watch has stopped operating, the small second hand will start moving at two-second intervals.

- The small second hand immediately starts moving at two-second intervals, but the energy stored in the secondary battery is not yet sufficient. If the watch is turned away from the light, it may stop operating.

It is not necessary to charge the watch fully. It

is important, however, to charge the watch sufficiently, especially in the case of initial charging.

2. Keep the watch exposed to the light until the small second hand moves at one-second intervals.
3. When the watch is charged after it has completely stopped, set start usually moving at one-second intervals.

### **CAUTION**

When charging the watch, do not place it too close to fluorescent lamp or other light sources as the watch temperature will become extremely high, causing damage to the parts inside the watch.

### **TO PREVENT ENERGY DEPLETION**

- Avoid covering the watch face with your clothing while wearing it.
- When the watch is not in use, leave it in a brightly lit place for as long as possible. Make sure that the watch temperature does not exceed 50°C.

## **POWER DEPLETION WARNING FUNCTION**

When the energy stored in the secondary battery is reduced to an extremely low level, the small second hand starts moving at two-second intervals instead of the normal one-second intervals. In that case, recharge the watch as soon as possible by exposing it to light. Otherwise, the watch may stop operating in about 1 week.

## GUIDELINES FOR CHARGING TIME

The below table provides only general guidelines.

Illumination (Lux)	Source of light	Environment	Time required (approx.)		
			A	B(*)	C
700	Fluorescent lamp	Inside office	-	35 hours	90 minutes
3,000		30w 20 cm	65 hours	8 hours	20 minutes
10,000	Sunlight	Cloudy	18 hours	2,5 hours	6 minutes
100,000		Fine weather	5 hours	1 hours	2 minutes

**Condition A:** Time required for full charge.

**Condition B:** Time required for steady operation.

**Condition C:** Time required for 1 day's charge.

(\*) The values in this column represent the charging times required until the small second hand moves constantly at one-second intervals after the watch starts operating with the small second hand moving at two-second intervals.

Even if the watch is not charged for the time specified in the column, the small second hand may temporarily move at one-second intervals. But it will soon resume moving at two-second intervals; therefore, charge the watch for more than the specified period.

## HOW TO SET THE TIME

1. Unscrew the crown and pull it out to position **[3]-(2nd click)**.
2. Turn the crown clockwise to set the correct time.
3. Push the crown in then screw it securely.

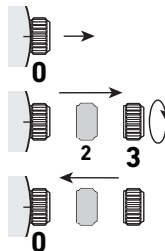

\* Take a.m./p.m. into consideration when setting the hour and minute hands to the desired time.

\* Always be certain that your crown is **SECURELY SCREWED**; this will prevent moisture from entering in.

## HOW TO SET THE DATE

1. Unscrew the crown and pull it out to position [2]-(1st click).
2. Turn the crown clockwise to set the correct date.
3. Push the crown in then screw it securely.

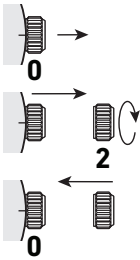

\* Do not set the date between 9:00 P.M. and 1:00 A.M.

## STOPWATCH FUNCTION

- The stopwatch can measure up to 60 minutes.

### STANDARD MEASUREMENT

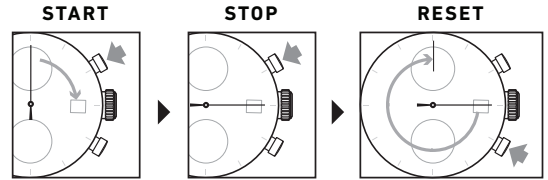

### ACCUMULATED ELAPSED TIME MEASUREMENT

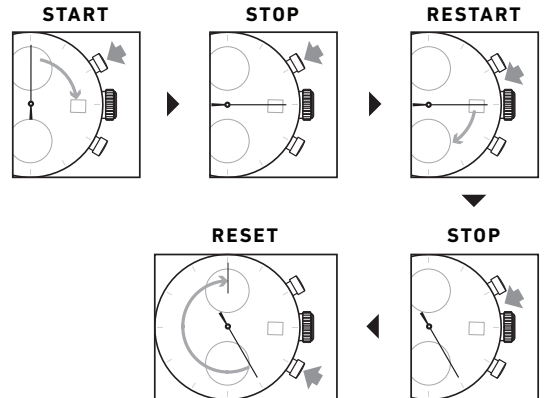

Restart and stop of the stopwatch can be repeated by pressing the button **A**.

## SPLIT TIME MEASUREMENT

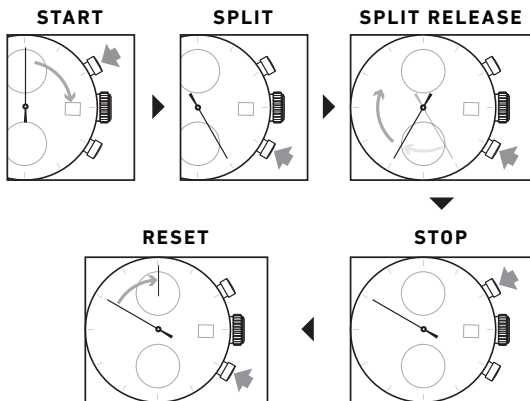

Measurement and release of split time can be repeated as many times as necessary by pressing the button **B**.

## MEASUREMENT OF TWO COMPETITORS

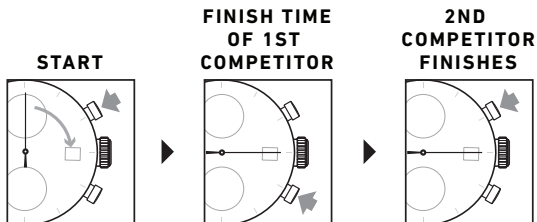

**FINISH TIME OF 2ND COMPETITOR**

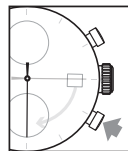

**RESET**

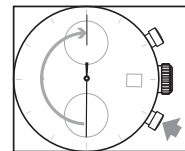

## SYSTEM RESET

When an abnormal display appears, reset the built-in integrated circuit.

1. Pull the crown out to the **[3]- (2nd click)** position.
2. Press the buttons A and B at the same time for longer than 2 seconds.
3. Push the crown back to the normal position.

**PRESS LONGER THAN 2 SECONDS**

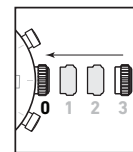
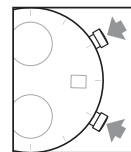
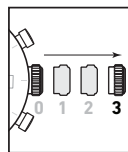

## STOPWATCH HAND "0" POSITION

1. Pull crown out to the **[3]-(2nd click)** position.
2. Press button A for 2 seconds.  
(Stopwatch Minute hand turns a full round and can now be set to correct "0" position.)
3. Press button B repeatedly to set Stopwatch Minute hand to "0" position.
4. Press button A for 2 seconds.  
(Stopwatch Second hand turns a full round and can now be set to correct "0" position.)
5. Press button B repeatedly to set Stopwatch Second hand to "0" position.
6. Push crown back to normal position.

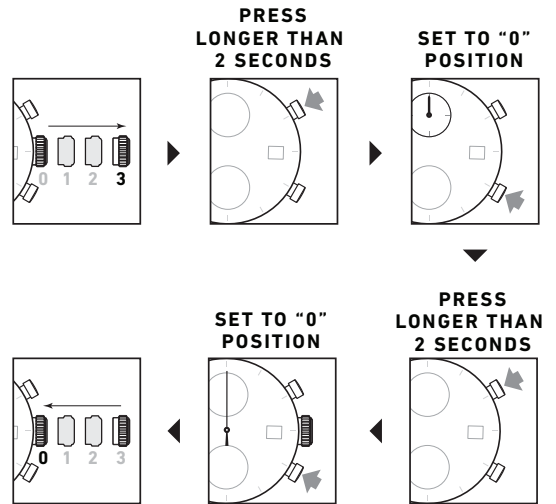

STOPWATCH  
HANDS  
"0" POSITIONS

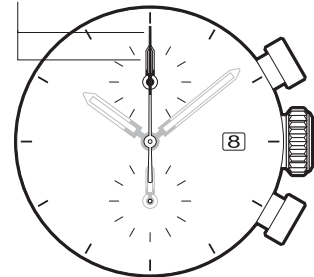



## WATER RESISTANCE

The water resistance indicated on your timepiece serves only as a guide. Actual water resistance may vary depending on a number of important factors including temperature, water salinity, and actual use under water.

The water resistance of your timepiece may eventually be compromised over time with general wear and tear and the use of your watch under adverse conditions.

Always remember to employ the screw down crown (if available) to maintain the water resistance of your timepiece. Warranty may be voided if the screw down crown has not been properly employed.

Note that you should NEVER wear your watch in a jacuzzi, hot shower or steam room where steam may enter the case despite the watertight seals used to protect your watch.

The steam may cause condensation inside your watch, which may affect and damage the inner workings of your watch – which would also not be covered by the warranty.

## HOW TO USE A DEPLOYANT CLASP

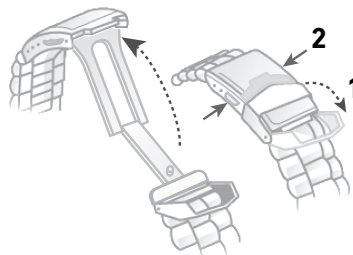

1. Flip the cover.
2. Press the buttons on the clasp sides.

## HOW TO RESIZE METAL BRACELET

On the inside of the bracelet, you will see some small arrows engraved on removeable links.

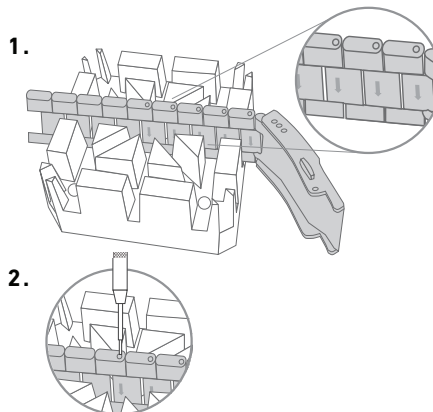

3.

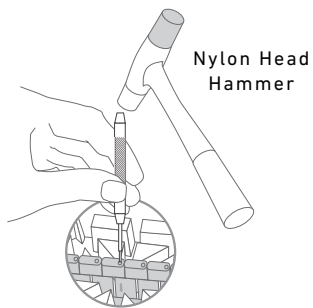

4.

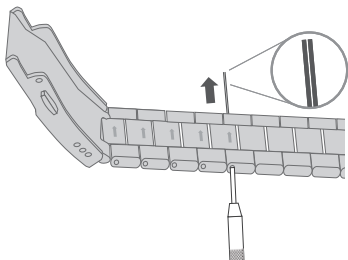

5.

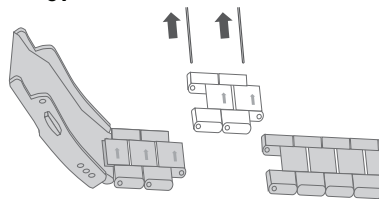

6.

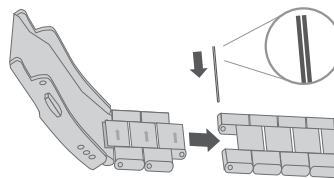

7.

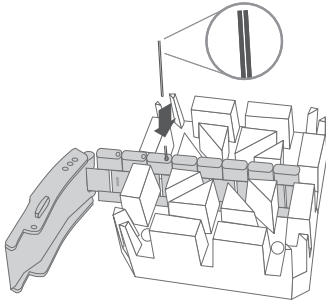

9.

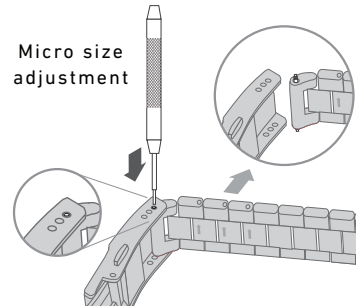

8.

Nylon Head  
Hammer

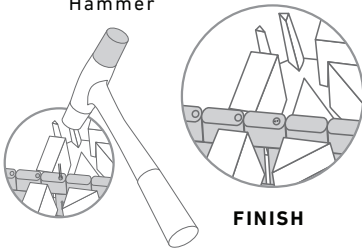

10.

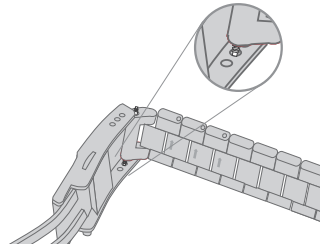

11.

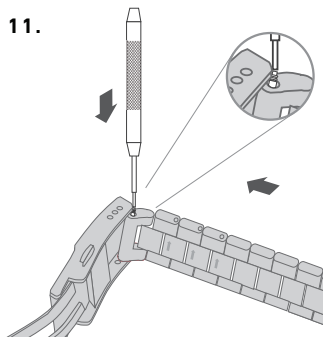

12.

