



For more details on operating this timepiece
please refer to the enclosed booklet or visit :

WWW.TSOVET.COM/IM

VOL.1.04 EN



TSOVET

INSTRUCTION MANUAL

SMT DW42 GMT HYBRID KINEMATIC

AUTOQUARTZ

This timepiece combine the best features of an automatic and a quartz technology, which contains an energy storage device. It uses the movement of the arm to convert kinetic energy into electrical energy to power the watch and then also store the power in a rechargeable device. As long as you wear it, it will always be charged. Therefore, you no longer need to worry about when the watch stops.

To ensure correct care, please take some time to review the enclosed instructions to review how to operate your watch.

FEATURES

1. Automatic power generating system

This watch generates "the electric energy" to power the watch, utilizing the movement of your body, and stores the power in the secondary battery.

2. Eliminating the need for battery replacement

Unlike conventional quartz watches, this watch does not use a silver oxide battery, thus eliminating the need for battery replacement.

3. Running time

Expected running time from full charge to stoppage will be around 6 months.

4. Power depletion warning function

(1) The two-second intervals of the second hand is a signal of energy depletion.

When the two-seconds interval starts, the watch runs down in approximately 24 hours. It is recommended charging earlier.

(2) When unused state without the charge detection continues, the watch stop after two-seconds intervals for 24 hours.

The watch starts by the charge detection, and the second hand will start usual moving at one-second intervals.

5. Instant-start function

Provided with the instant-start function, the watch starts usual operation after swing it several times.

6. Over charge prevent function

If the secondary battery is charged more than predetermined voltage, over charge prevent function is operated.

DISPLAY

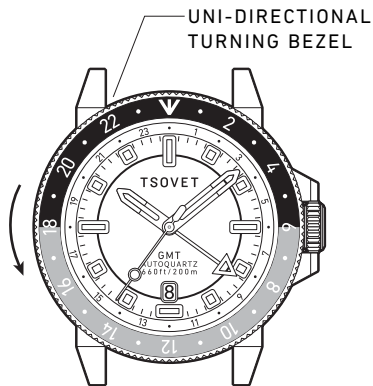
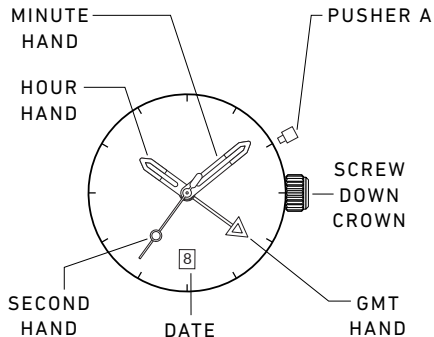

PLEASE READ THE FOLLOWING BEFORE UNSCREWING THE CROWN:

SCREW-DOWN CROWN

Screw-down crowns are used to ensure water resistance. ALWAYS be certain that your crown is securely screwed down (Position **[0]** is secured. Positions **[1]**, **[2]** and **[3]** are not secured for water resistance).

Do **NOT** unscrew your crown while you are in any environment where moisture is present.

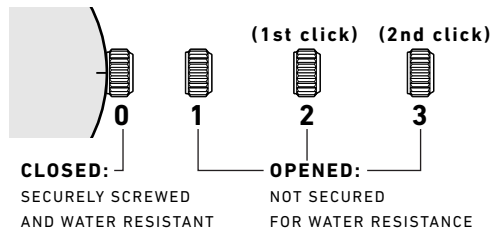

USING THE SCREW-DOWN CROWN

DO NOT PULL THE CROWN UNLESS IT IS UNSCREWED FIRST:

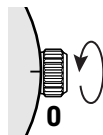

TO UNSCREW:

Turn the crown anti-clockwise until it turns freely without tension. GENTLY pull the crown out to the other desired positions for watch setting (see specific operating instructions on the following pages).

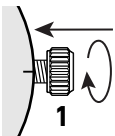

TO SCREW:

Push the crown **ALL THE WAY IN** (towards the watch) **THEN** begin to turn clockwise until it is securely screwed down.

NOTE: Failure to **SECURELY** screw down the crown after setting the watch may affect its water resistance.

HOW TO CHARGE THE WATCH

While the watch is swung, the automatic power generating system works, and the watch is powered by the electrical energy.

Swing the watch from side to side at a rate of 2 to 3 swings in a second.

HOW TO START USING THE STOPPED WATCH

1.Normal stop state

The watch starts to move by several times of swinging.

After one-two seconds, the second hand will start usually moving at one-second intervals.

Power storage indicator shows five seconds and usually moves for one day.

2.After the long term leaving (more than three years)

The capacitor continues to discharge and the voltage decreases ever after the watch has stopped.

In the case of the watch having been left for a long time, and the voltage of the rechargeable battery extremely decreases, the second hand moves at two-second intervals until it becomes the operable voltage.

Please swing the watch until the second hand moves at one-second intervals.

POWER STORAGE INDICATOR

1.How to use

Push the **Pusher A** button at 2H position.



2.Indication

By pressing the button, the second hand moves quickly a certain amount of seconds depending on the power storage in a watch.

The second hand starts to move quickly from current position.

After the second hand moves quickly a certain amount of seconds, it keeps stopping until the current time is caught up with the second hand.

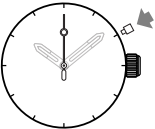
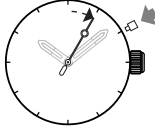
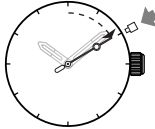
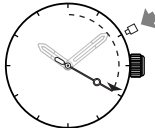
3. Relationship between the quick movement of the second hand and power storage

Quick movement of second hand		Power storage
No move		The watch may run down soon. Please be sure to recharge the watch. The second hand moves two-second interval.
5 seconds		Approximately more than 1 day of power storage is available.
10 seconds		Approximately more than 7 days of power storage is available.
20 seconds		Approximately 1 month of power storage is available.
30 seconds		Approximately 4 to 6 months of power storage is available.

4. Recheck the power storage

You can check the power storage one more time immediately by pushing the button.

HOW TO SET THE TIME

1. Unscrew the crown and pull it out to position **[3]**-(2nd click).
2. Turn the crown to set the correct time.
3. Push the crown in then screw it securely.

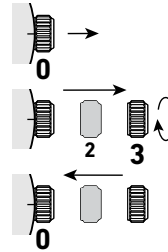

- * Take a.m./p.m. into consideration when setting the hour and minute hands to the desired time.
- * Always be certain that your crown is **SECURELY SCREWED**; this will prevent moisture from entering in.

HOW TO SET THE DATE

1. Unscrew the crown and pull it out to position **[2]**-(1st click).
2. Turn the crown anti-clockwise to set the correct date.
3. Push the crown in then screw it securely.

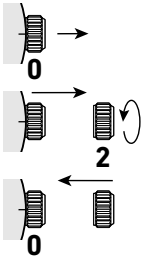

* Do not set the date between 9:00 P.M. and 4:00 A.M.

HOW TO SET SECOND TIME ZONE

1. Unscrew the crown and pull it out to position [2]-(1st click).
2. Turn the crown clockwise to set the correct time zone indication (refer to the 24Hrs. marking on the bezel)
3. Push the crown in then screw it securely.

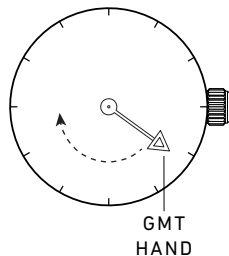
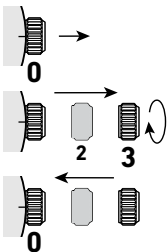

HOW TO READ A THIRD TIME ZONE

Your watch is equipped with a turning outer bezel calibrated with a 24 hour time zone marking.

With this, you can in fact read off a third time zone at a glance.

Example:

Time zone 1 or home time.

This would be the normal time read off by the main hour and minute hands.

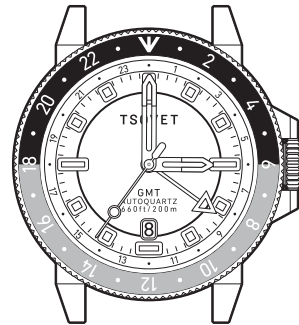

Time zone 2

By setting the independent GMT dual time hand, you can read off a second time zone – off the fixed 24 hour markings on the dial.

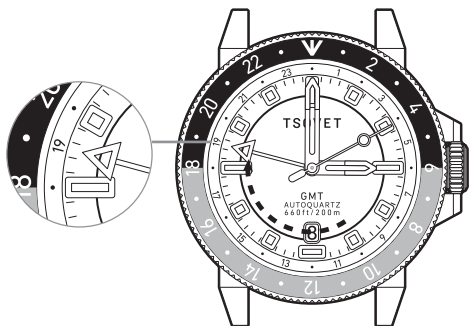

Example:

You are in **London** where the time is 3pm (15.00)

You would like to your GMT hand to read the time in **Dubai** (+4 from London)

Simply adjust your GMT hand to align it at the 19 position (19.00)

You would also like to keep an instant view of the time in **Hong Kong** (+4 from Dubai)

Turn the inner bezel so that the 19 and 23 align.

The time in Hong Kong will then be visible at a glance.

Time zone 3

By turning the bezel that operates the outer 24 hour ring you can align another timezone.

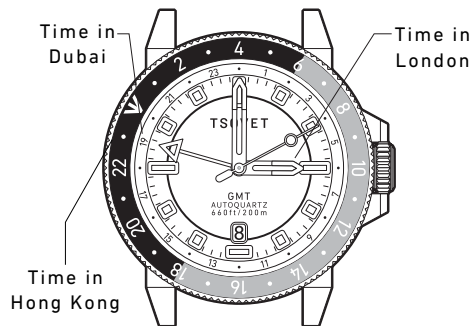
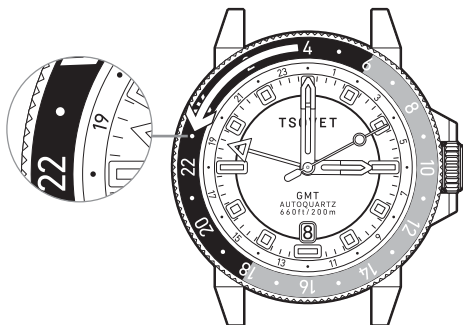

WATER RESISTANCE

The water resistance indicated on your timepiece serves only as a guide. Actual water resistance may vary depending on a number of important factors including temperature, water salinity, and actual use under water.

The water resistance of your timepiece may eventually be compromised over time with general wear and tear and the use of your watch under adverse conditions.

Always remember to employ the screw down crown (if available) to maintain the water resistance of your timepiece. Warranty may be voided if the screw down crown has not been properly employed.

Note that you should NEVER wear your watch in a jacuzzi, hot shower or steam room where steam may enter the case despite the watertight seals used to protect your watch.

The steam may cause condensation inside your watch, which may affect and damage the inner workings of your watch – which would also not be covered by the warranty.

HOW TO USE A DEPLOYANT CLASP

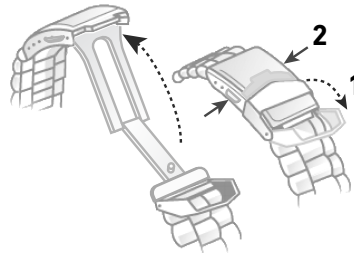

1. Flip the cover.
2. Press the buttons on the clasp sides.

HOW TO RESIZE METAL BRACELET

On the inside of the bracelet, you will see some small arrows engraved on removeable links.

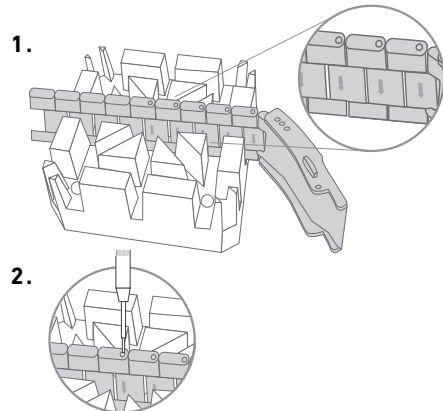

3.

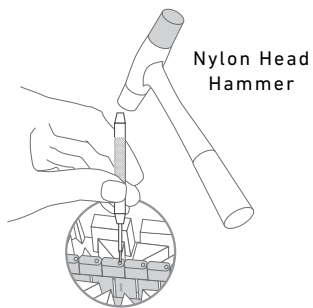

4.

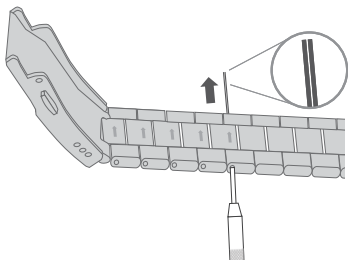

5.

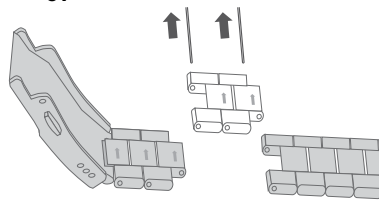

6.

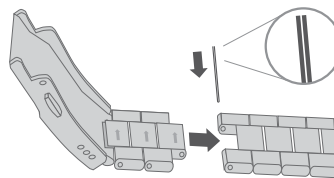

7.

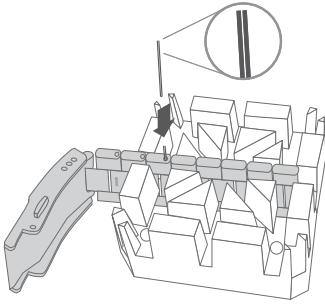

9.

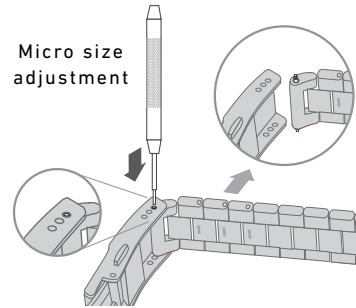

8.

Nylon Head Hammer

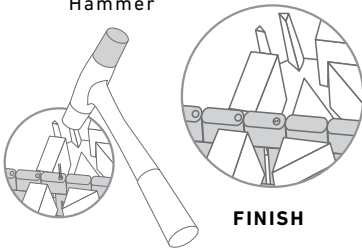

10.

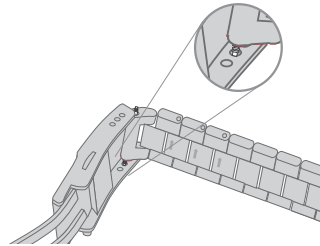

11.

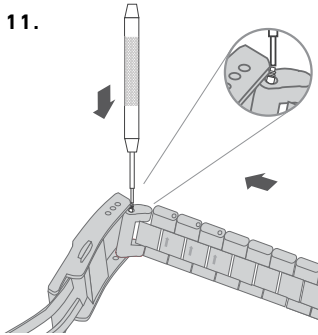

12.

