

KAIA

ORA

INSTALLATION MANUAL

ORA

1 Suspension

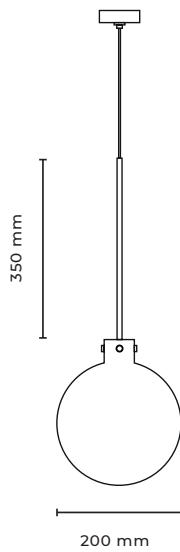

Type

Material

Environment

Dimensions

Stem Length

Weight

Ceiling Rose

Certification

Lamping

Pendant

Brass

Indoors

Glass Ø 200 mm

customized

2 Kg

Ø 80 mm x 65 mm

IP20 CE

Filament: E14 115mm Tube Light

Bulb, clear, 25W, 2200 K, dimmable

OR Led: E14 115mm Tube Light

Bulb, clear, 2.7 W (250lm), 2600K,

dimmable

* Please note the glass is mouth blown. The crystal glass might have some natural imperfections which are a result of the glass manufacturing process.

* Due to the manufacturing process, slight differences in the finish between the different brass parts, might occur.

** Lighting fixtures designed for the indoor environment up to 24 ° C.

STEP 1 TOP VIEW

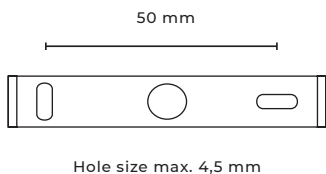

Remove the base from the installation bracket.

INSTALLATION

Before commencing installation ensure the relevant mains supply has been safely isolated/ disconnected . Installation should be carried out by a qualified electrician. Ensure all electrical connections are tight with no loose strands, including factory made connections. The Mains power must only be switched on once the fitting has been electrically connected to the driver.

STEP 2 SIDE VIEW

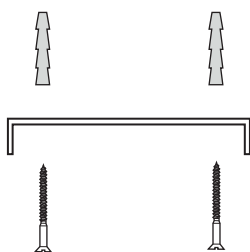

Affix the bracket to the ceiling with 2 screws (hole size max. 4.5 mm, 50 mm apart).

STEP 3 SIDE VIEW

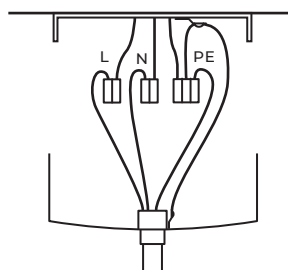

Connect the unit to the mains.

STEP 4 SIDE VIEW

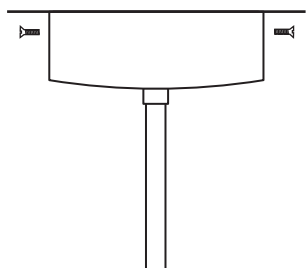

Fix the unit back on its base and re-tighten 2 screws on the side.

STEP 5



Adjust the adjustable screws to the glass ball opening. There has to be a minimum of 1 mm distance between the metal and the glass.

STEP 6

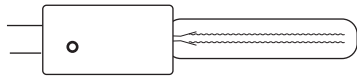

Screw in all bulbs, then switch on the circuit and test if the bulbs are functioning. With transportation the lampholders might get interfered and the bulb will not connect correctly. In this case please **disconnect the lighting fixture from the circuit**, bend the contact brackets slightly to ensure that the bulbs and the lampholder are connected.

STEP 7

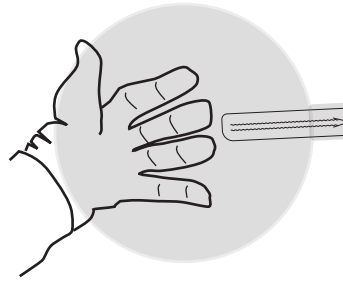

Carefully secure the glass sphere.

STEP 8

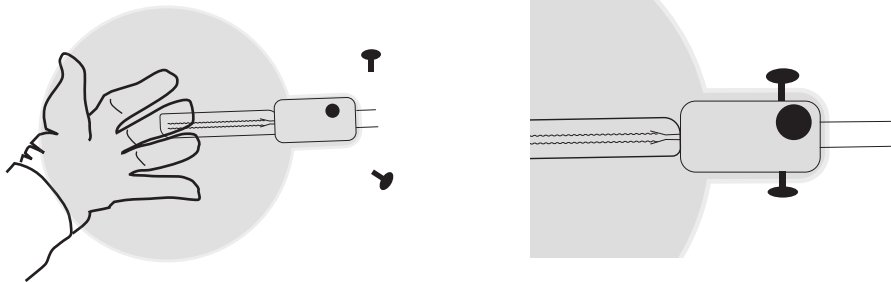

Carefully fix loosely with the supplied knurled-head screw by hand. Do not use a screw-driver. Do not screw too tightly, ensure there is at least 1 mm tolerance between the glass and the screw.

GLOVES

You have chosen an oiled and waxed finish for your lighting fixtures, please make sure that these will only be touched with provided gloves and that the Care Instructions will be followed strictly.

CAR INSTRUCTIONS

1. Use a soft dry cloth to ensure a fingerprint free surface. We recommend the use of micro fibre cloths.
2. Warning: do not use alcohol or other solvents for cleaning.