

# KAIA

## MOUNTING INSTRUCTION & MAINTENANCE MANUAL

### SIS

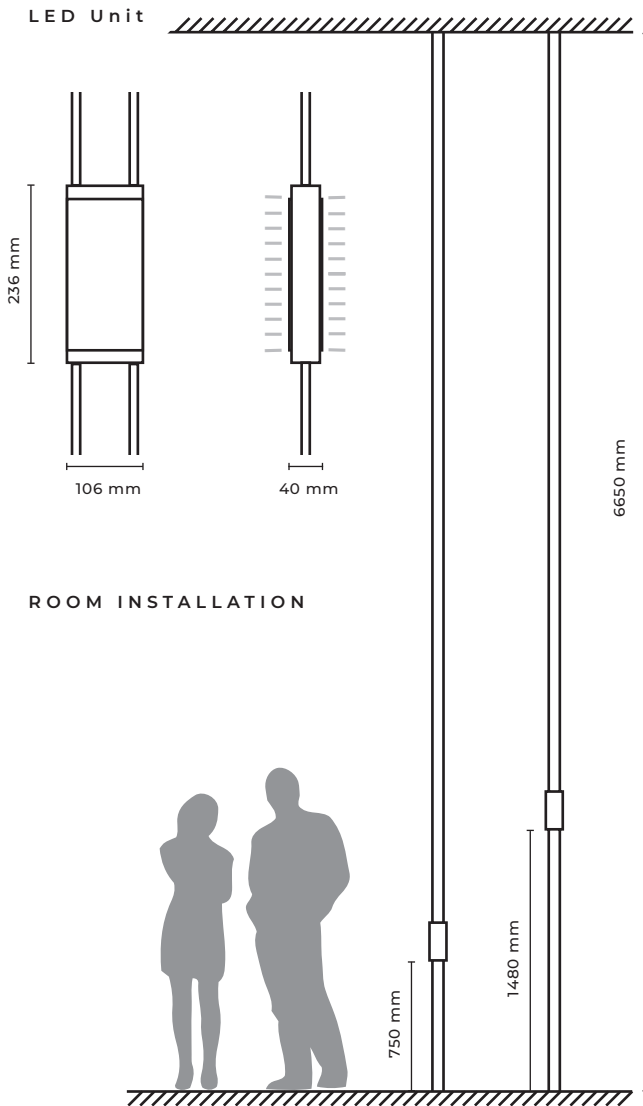

Type	Room installation
Material	Solid brass, acrylic
Environment	Indoors
Dimensions	106 x 40 x 236 mm
Weight	1,7 kg
Certification	IP40 CE
Lamping	LED technology, 24 V*, Warm White 3000 K, 652 lumens, dimmable Lifetime 70 000 h.
Dimming	DALI
LED Driver	Tridonic LCA 60W 24V one4all SC PRE
LED Watt	11,2 W (2x 5,6 W)
Surface finish	customized aged brass (mat)

Type	Room installation
Quantity	6 pcs.
Material	Solid brass, acrylic
Environment	Indoors
Stem Length	1000 - 2000 mm
Dimensions	320 x 40 x 8180 mm
visible Dimensions	320 x 40 x 6650 mm
Floor / ceiling Plate	320 x 170 x 2 mm
Weight per pcs.	12 kg
Surface finish	customized aged brass (mat)

## STEP 1

Undo the rope connection between the turnbuckle and the rope holders in the floor

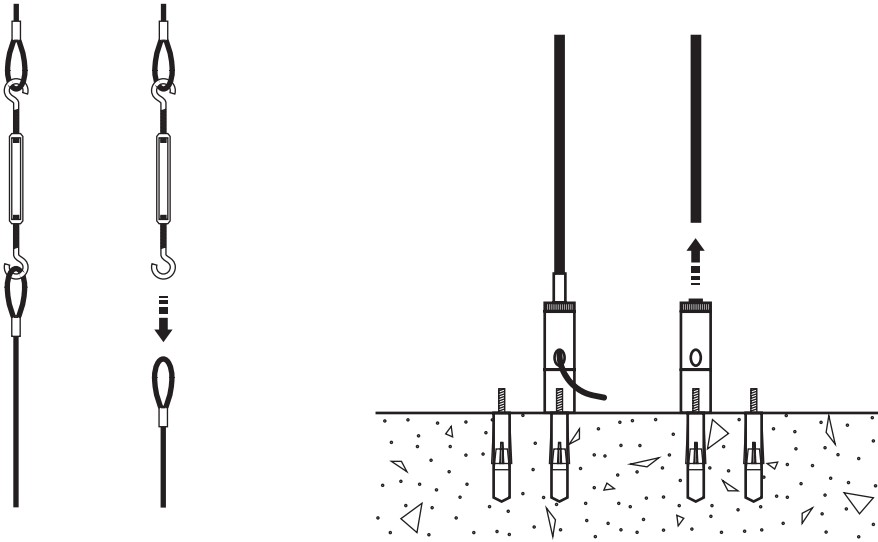

## STEP 2

Place the drilling template over the inspection opening and mark the holes on the floor.

Drill the holes with a 10mm drill (suitable for the threaded inserts). The drill must be suitable for the material of the floor and the ceiling. KAIA assumes no responsibility for any damage resulting from improper use.

Use assembly adhesive when inserting the thread inserts

Stone floor

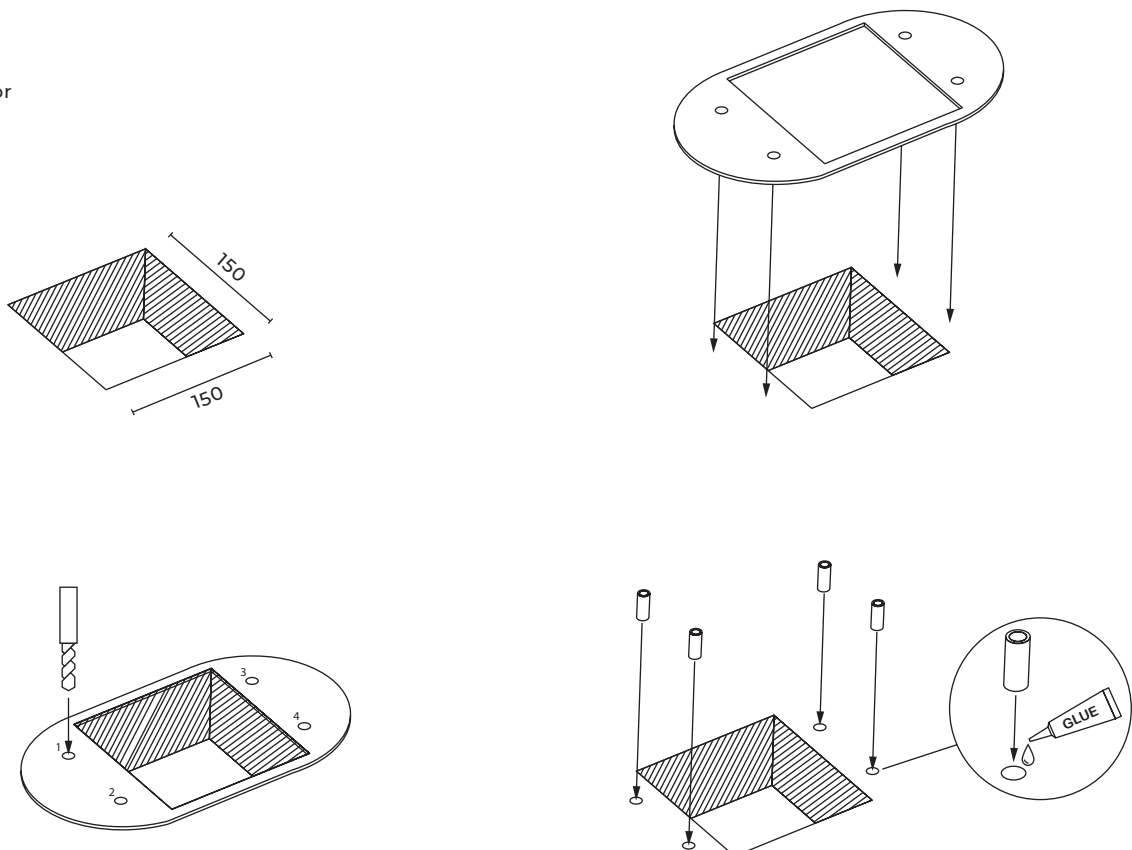

## STEP 2

ceiling

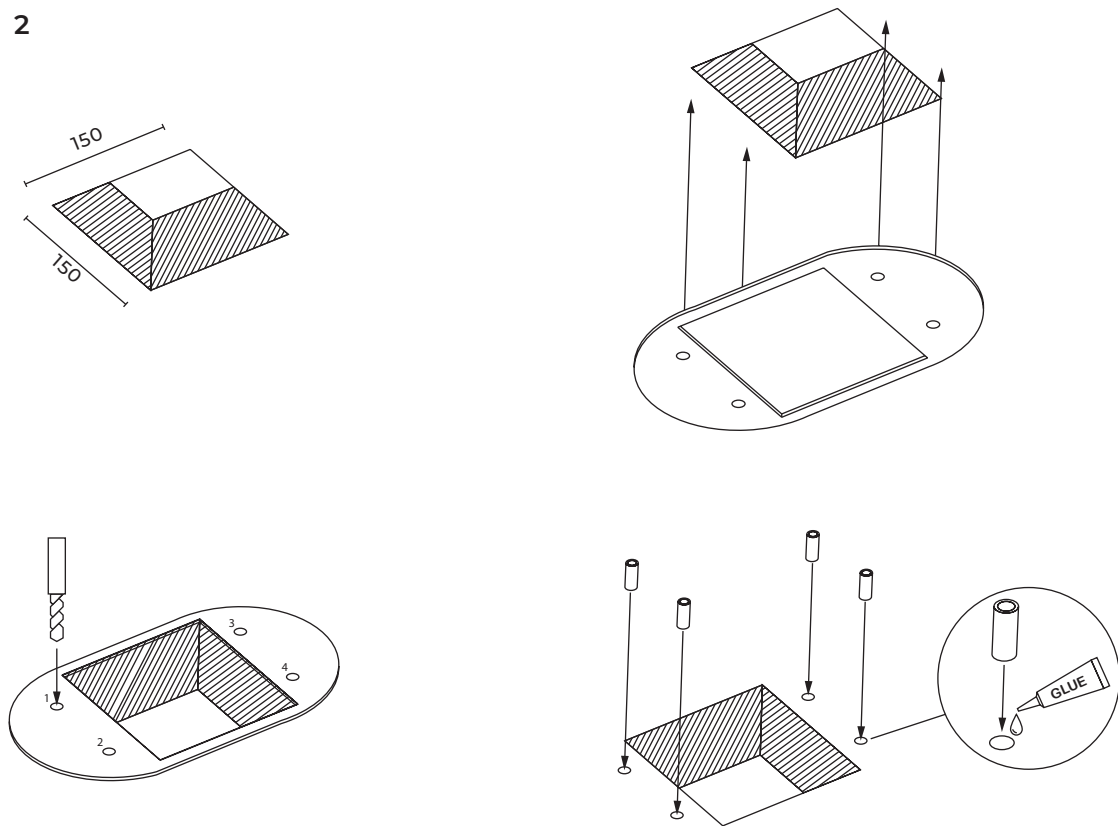

## STEP 3

Install the footbrackets in the lowered floor onto the already installed threaded bolts. Use two serrated lock washers and M6 nuts. Repeat this process for all 6 positions.

lowered floor



## STEP 4

Preparing the stems. Glue the threaded inserts into the stems. See overview!

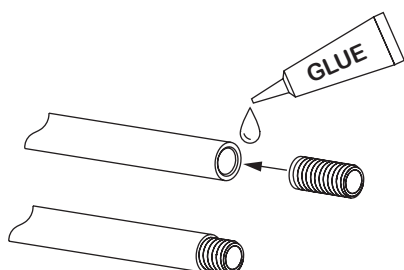

24 x 2000 - one side		
10 x 1800 - one side		
10 x 1000 - both sides		
2 x 1740 - both sides		
2 x 1060 - one side		

## STEP 5

Next, thread the components onto the steel cables. The order is from top to bottom:

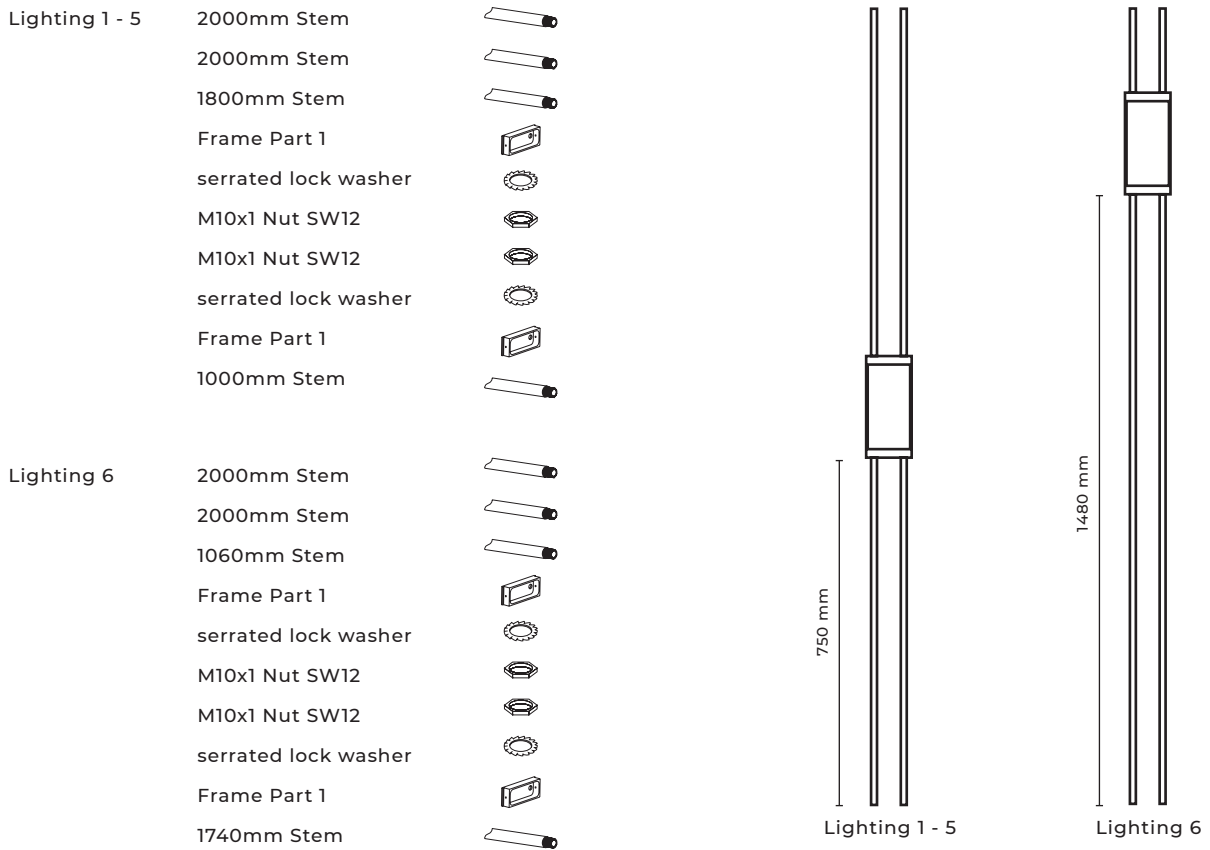

## STEP 6

Then screw the frame parts to the adjacent stems. Pull the cables for the LED through the upper stems up to and including the first frame part. Use a stem for + or -

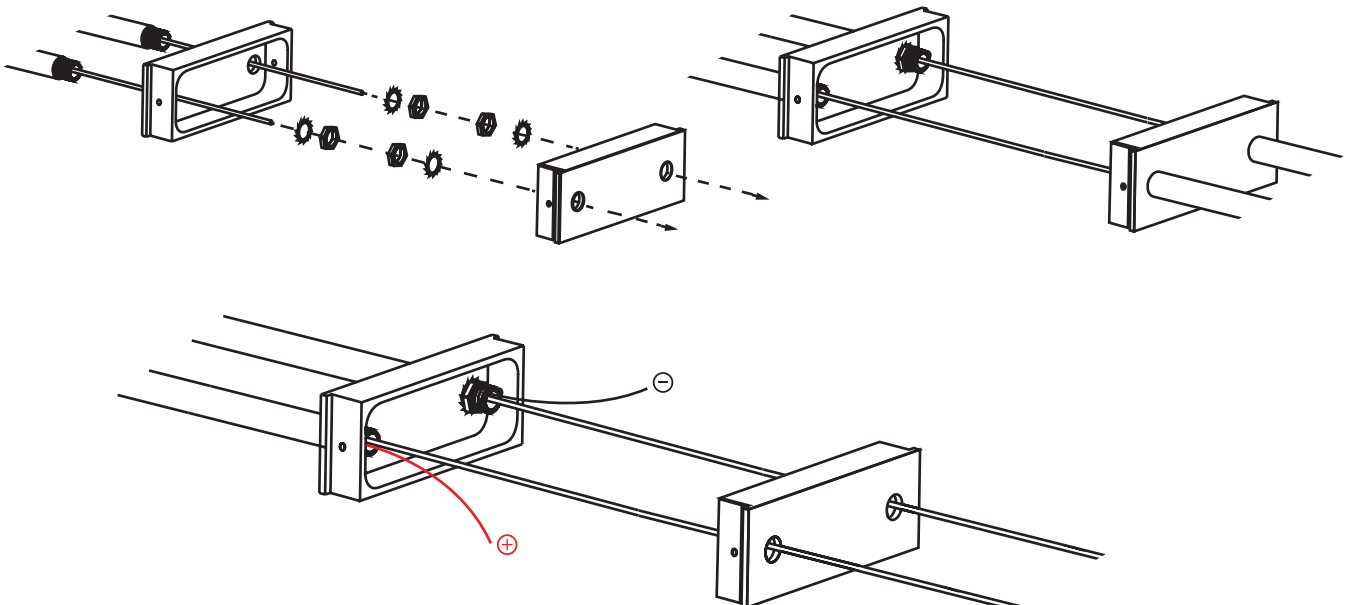

## STEP 7

Screw the bottom stems to the mounting bracket. Use serrated lock washers and the enclosed M10x1 nuts with a larger wrench size. Fasten the steel cable in the cable holder.

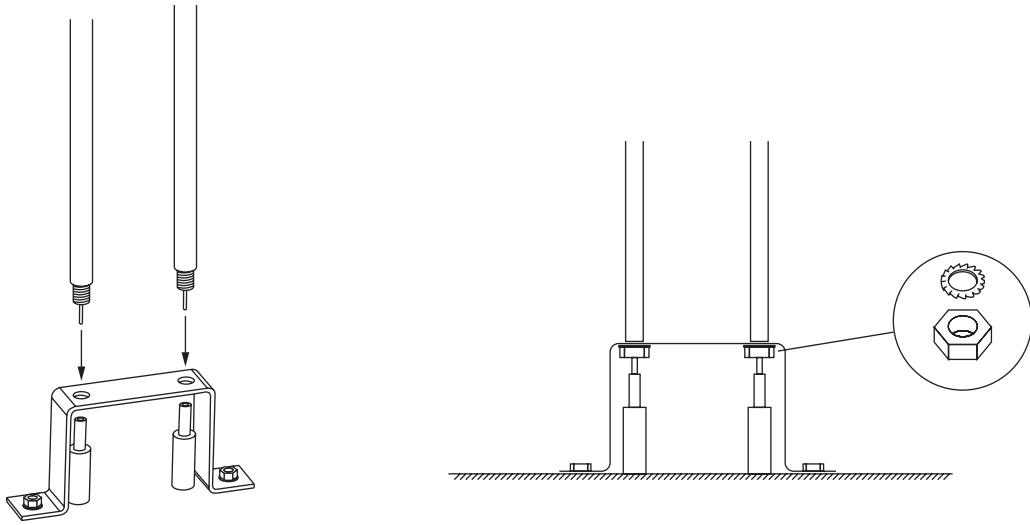

## STEP 8

Screw the side parts of the frame to the lower part. Use the countersunk screws M3 x 8mm.

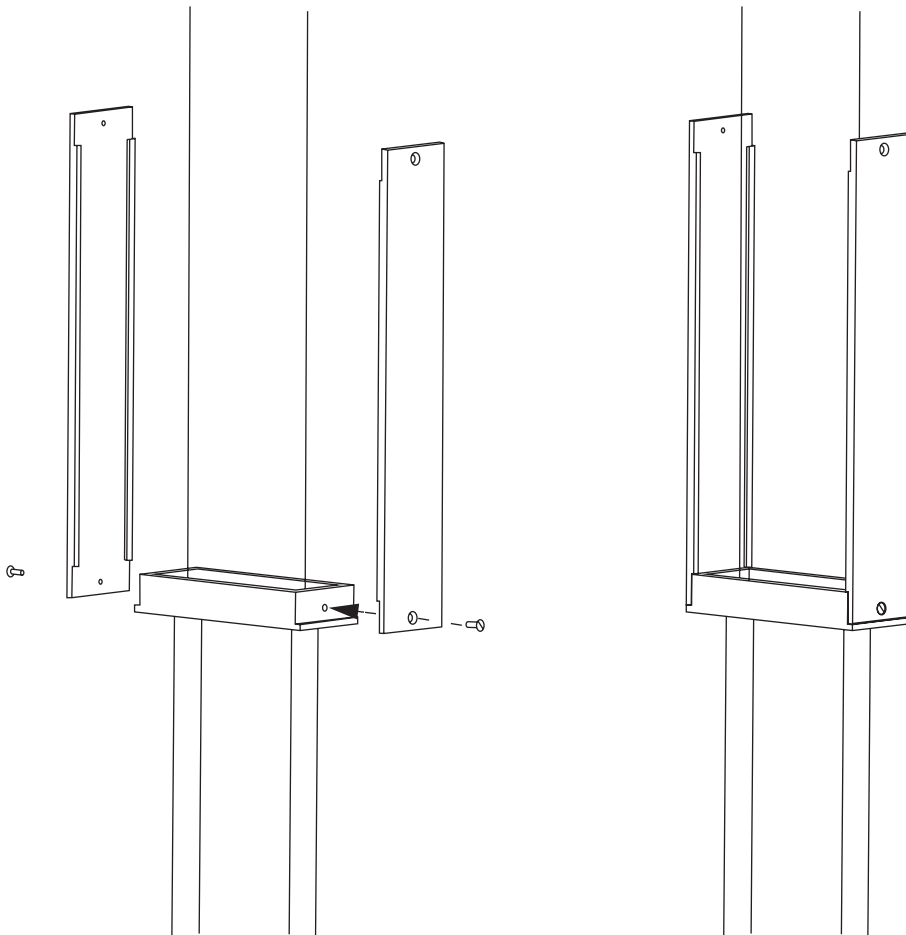

## STEP 9

Push the LED panels into the groove of the frame from above. Place both panels with the cable exit facing the top.

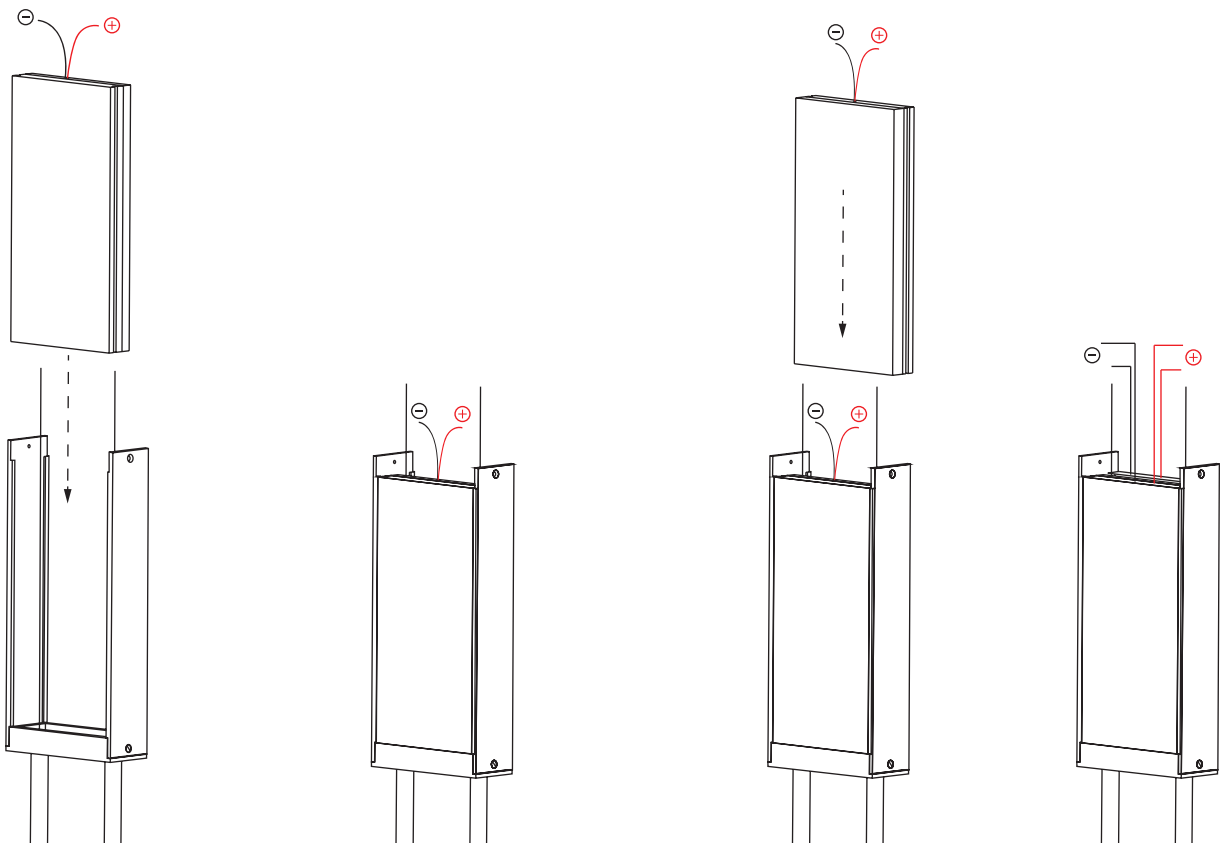

## STEP 10

Connect the cables to the WAGO terminals. + and - must be in separate terminals!

Hide the clamps with the cables inside the frame and close it with the upper frame part. Also screw the upper part to the side parts with M3 x8 screws.

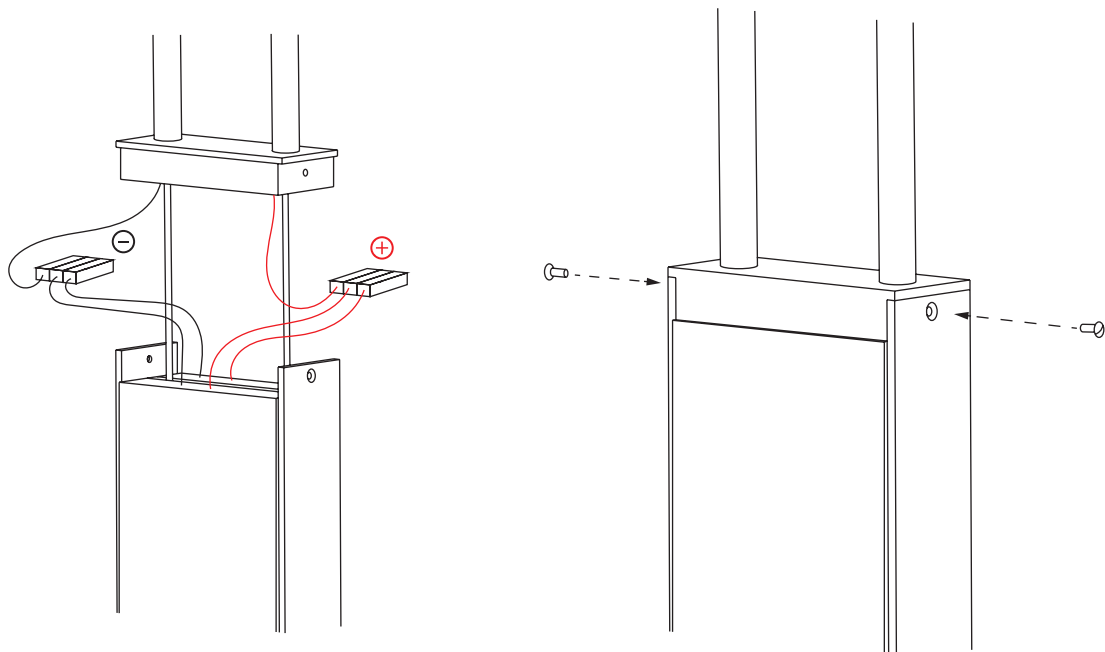

## STEP 11

Now screw the stems together and assemble the lamp from bottom to top. To do this, hang the steel cable in the turnbuckle.

Adjust the rope length correctly to achieve a stabilizing tension. Use the adjustment options on the turnbuckle and on the lower cable holders.

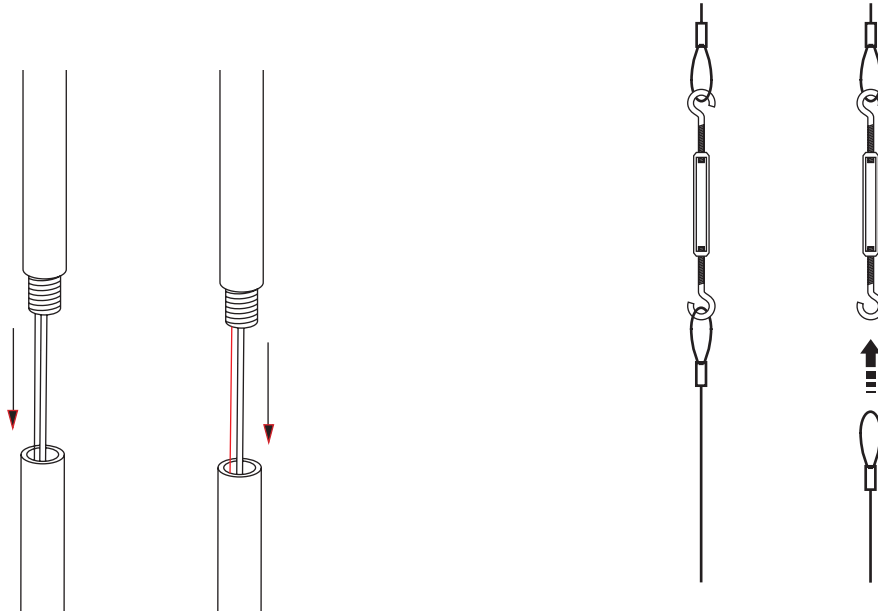

## STEP 12

Connect the lights to the dimmers (Tridonic LCA 60). For correct installation, use the enclosed data sheet of the dimmer.

**The electrical installation may only be examined by trained persons. Please note that improper work with electricity can result in significant health risks!**

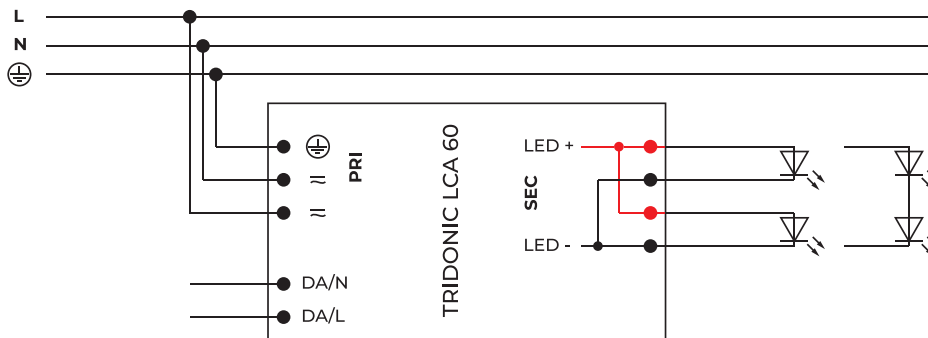

## STEP 13

Once the electrical installation has been completed and the functions of the lights have been checked, close the inspection openings with the brass panels. Place the divided plate so that they lie concentrically over the threaded sleeves. Then use the M6 x 20 screws for attachment. Repeat this process on the ceiling.

Stone floor

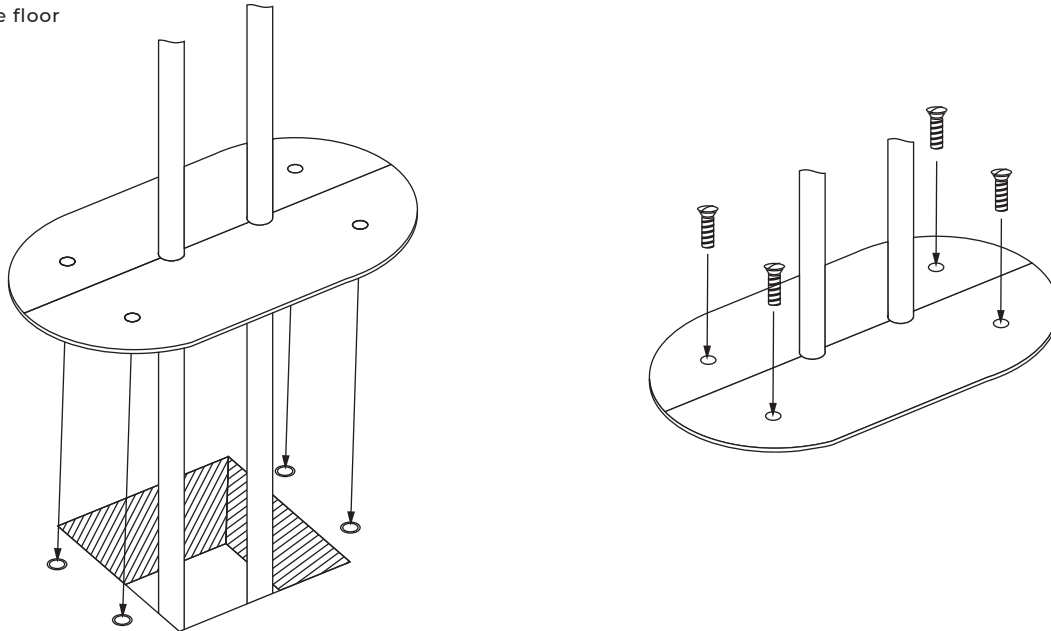

ceiling

