

BRISTOL
ER9410-MBOX
STEP LIGHTS

PROJECT

DESCRIPTION

Dry location back box compatible with the ER7110 and ER9410.



SPECIFICATION DETAILS

Fixture Dimensions	W9-1/2" x H3-1/4" x E1-3/4"
Location	Dry

* For custom options, consult factory for details.
 * For warranty information, please visit www.kuzcolighting.com/warranty

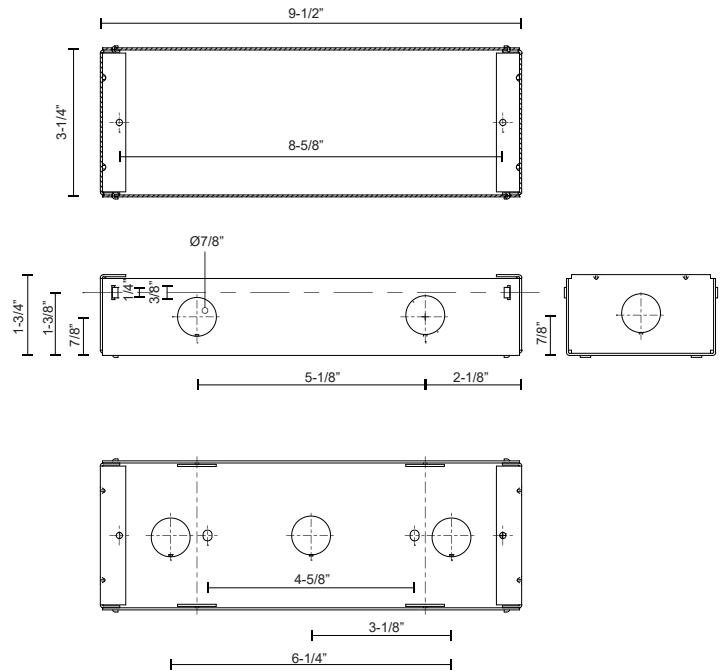

KUZCO

CANADA: 19054 28TH AVENUE - SURREY, BC V3Z 6M3
 USA: 3035 E. LONE MOUNTAIN ROAD - LAS VEGAS, NV 89081

WWW.KUZCOLIGHTING.COM

© 2017 KUZCO LIGHTING. ALL RIGHTS RESERVED.

COMMENT

