

Q-Optics

Flip Style Loupes



USER MANUAL

PLEASE READ AND FOLLOW THESE INSTRUCTION PRIOR TO
USING YOUR Q-OPTICS FLIP STYLE LOUPES

Table of Contents

Wearing the Frame	2
Quick Set	3
Optimize Hinge Setting	4
Cleaning and Disinfecting	5
Prescription Service – Rx	5
Removing and Changing Loupes	6
Attaching a Headlight	6
Vertical Height Adjustment	7
Accessories	7
Optional Accessories and Replacement Parts	8

Q-Optics

Product Support Info

Toll-Free U.S. and Canada: 1-800-858-2121

Phone: (972) 298-2669

Fax: (972) 298-6592

Web Site: www.q-optics.com

Email: support@q-optics.com



P.O. Box 382120 • Duncanville, TX 75138
Phone: (972) 298-2669 • 1-800-858-2121 • Fax: (972) 298-6592

Wearing the Frame

Frames should rest high on the nose.



Correct



Incorrect

Saddle / Nose Pad Adjustment:

To adjust the nose pads or saddle so the loupes will sit higher on the nose gently press the pads/saddle closer together.

To adjust the nose pads or saddle so the loupes will sit lower on the nose spread the pads/saddle further apart.



To raise loupes on face press pad or saddle closer together

Raise Loupes

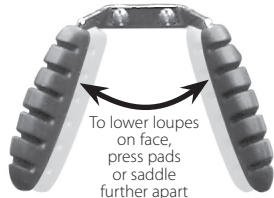

To lower loupes on face, press pads or saddle further apart

Lower Loupes

Ear tips:



Bend ear tips for a more secure, comfortable fit.

Note: You may also visit your local optometrist or eyeglass shop for an adjustment.

Quick Set – Achieve the correct line of sight.

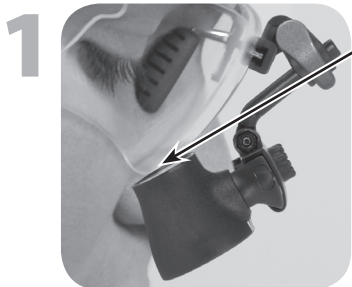

Push optics against frame lens.



Set Interupillary Distance

Use interupillary knob (IP Knob) to adjust loupes to the widest possible distance.

Slowly converge loupes until you see one image.



WRONG

Double image - too far apart



RIGHT

Single image
- slight oval image area



RIGHT - Optimum

Single image
- round image area



WRONG

Restricted image
- too close together

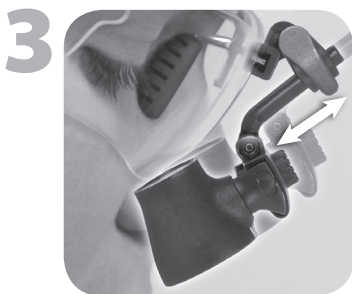

Set Loupe Height

See Vertical Height Adjustment on page 7

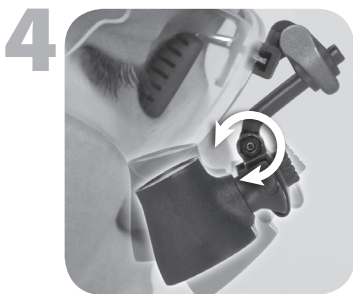

Set Declination Angle



Too Steep



Too Shallow

Optimize Hinge Setting

High Ergonomic Viewing (Chair Side)



Bench Work (Lab Work)

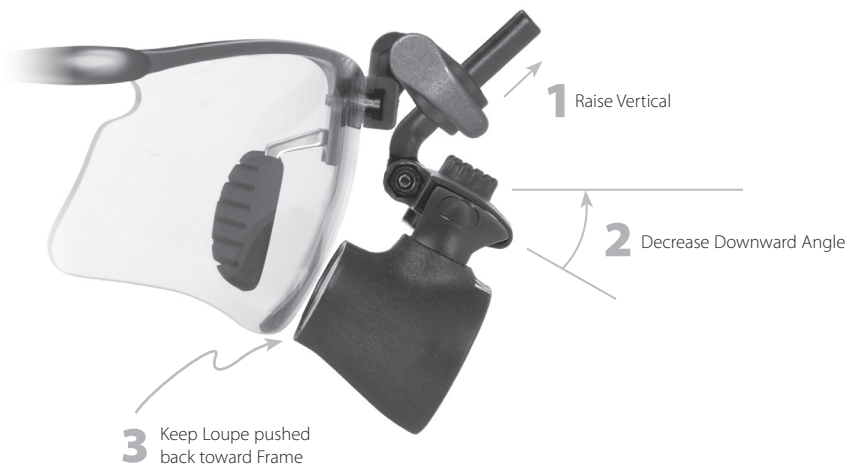

Cleaning / Disinfecting

It is OK to rinse your loupes under fast moving room temperature water.

NEVER SOAK LOUPES.

It is OK to disinfect loupes using alcohol, Lysol® spray, 10% bleach and water mix or other surface disinfectant.



Warning



**Never attempt to sterilize loupes by any method!
Never soak loupes in any solution – not even water!
Never place loupes in an ultrasonic cleaner!**

Prescription Service – Rx

Q-Optics loupes provide a magnified view for improved performance. Q-Optics do not correct vision. If you work with prescription lenses or you normally work with reading glasses then you should use Q-Optics loupes with your prescription installed. Most single strength and bifocal prescriptions can be placed in the frame by Q-Optics at a nominal charge with the purchase of a new set of loupes. For ease of use, progressive lenses and trifocal prescriptions are typically converted to flat top bifocals. Prescriptions for Q-Optics may also be obtained and placed by your local optometrist or eyeglass provider.



Removing & Changing Loupes

Remove Loupes

- 1 Applying pressure to the area of the hinge shown
- 2 Slide hinge to the right as shown



Install Loupes

- 1 Align slot on left side of hinge with screw on front of loupes
- 2 Slide hinge to the left as shown



Attaching a Headlight

Install Headlight

- 1 Orient large opening on clip with interpupillary knob
- 2 Slide headlight onto hinge as shown

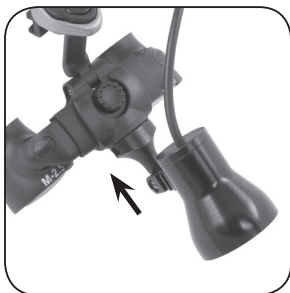
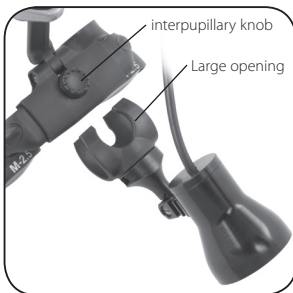

Vertical Height Adjustment

- 1** Loosen locking set screw (if necessary) located on the back of the vertical slide with the supplied hex wrench.
- 2** Adjust vertical slide to desired position.
- 3** Tighten the locking set screw.
CAUTION: Tighten the set screw until a slight resistance is felt with the hex wrench. It takes very little pressure to lock the vertical slide in place.

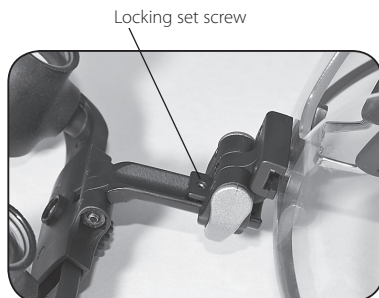

Accessories (included)

- Autoclavable / removable handle
- Side shields
- Micro fiber cleaning cloth
- Additional nose pad set or saddle
- Lens cap covers
- Sport strap or elastic band



Accessories will vary depending on frame style and telescope type.

Optional Accessories & Replacement Parts



Combo Case
Loupe & Headlight



Loupe Case



Custom Color
Accent Clips



Sport Strap
Cloth End



Sport Strap
Silicone End



Replacement Nose Pads



Cleaning Solution



Disinfectant



Cleaning Cloth

Q-Optics

For more information contact:

P.O. Box 382120 • Duncanville, TX 75138
1-800-858-2121 • (972) 298-2669 • Fax: (972) 298-6592
www.q-optics.com
support@q-optics.com

www.q-optics.com

Have a better look™.

© 2010 Q-Optics. All rights reserved. Product specifications are subject to change at any time without prior notice.
UI308-10002-01, ECN 917