

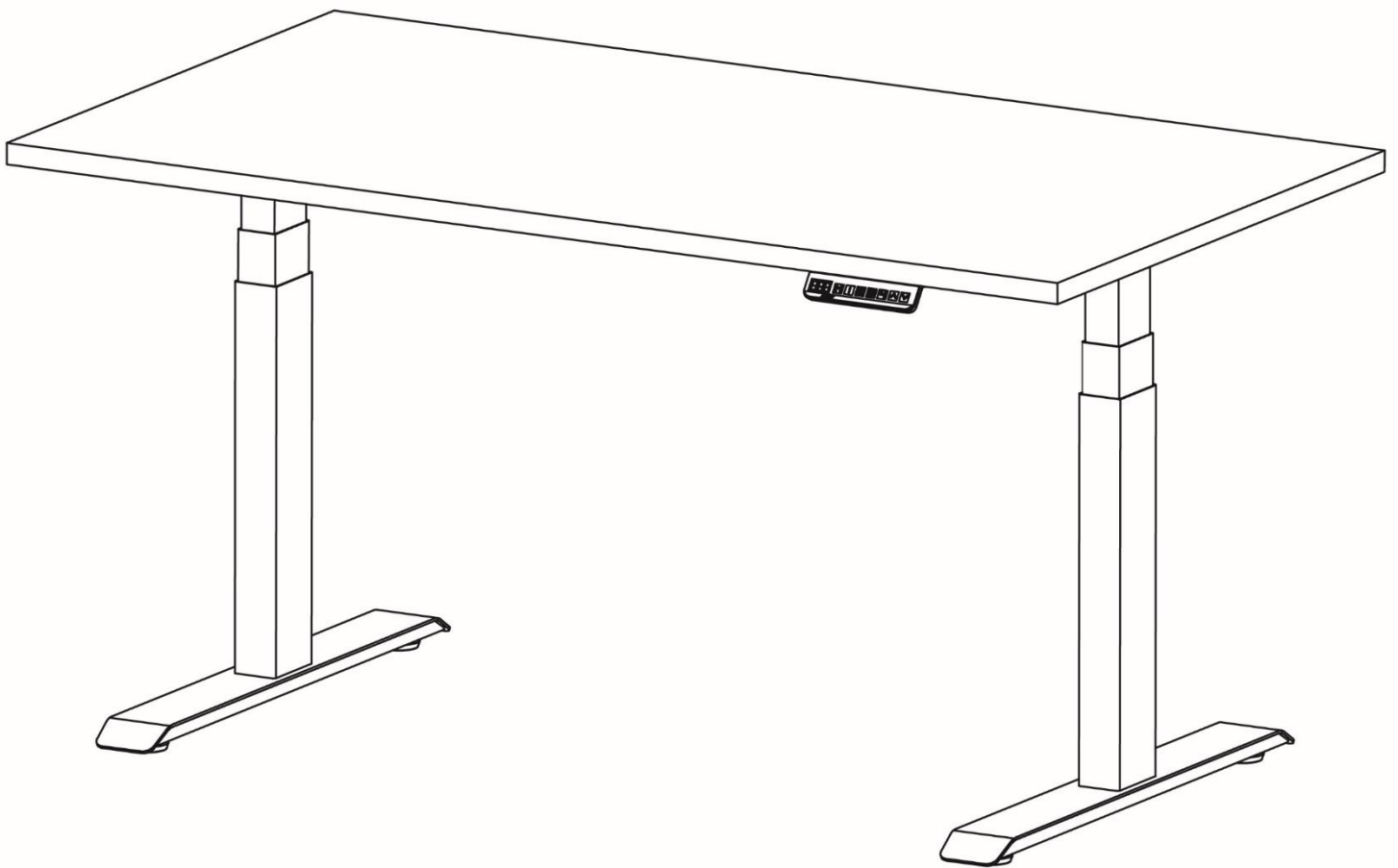

# ELECTRIC HEIGHT ADJUSTABLE TABLE CLASSIC



Assembly and Operation Instructions

# Parts List

Part	Name	Qty
1	End Frame	2
2	Cross Rail	2
3	Lift Column	2
4	Side Bracket	2
5	Foot	2
6	Control Box	1
7	Handset	1
8	Lift Column Cable	2
9	Power Cord	1
10	Cable Clip	8
11	Levelling Foot	4
12	Hex Socket Screws Pack A - M6X12mm	16

Part	Name	Qty
13	Hex Socket Screws Pack B - M6X35mm	4
14	Hex Socket Screws Pack C - M6X14mm	6
15	Wood Screws Pack D – M5X16mm	8
16	Hex Socket Screws Pack E - M6X10mm	8
17	4mm Allen Key	1
18	Phillips Screwdriver or Electric Hand Drill (Not included)	-

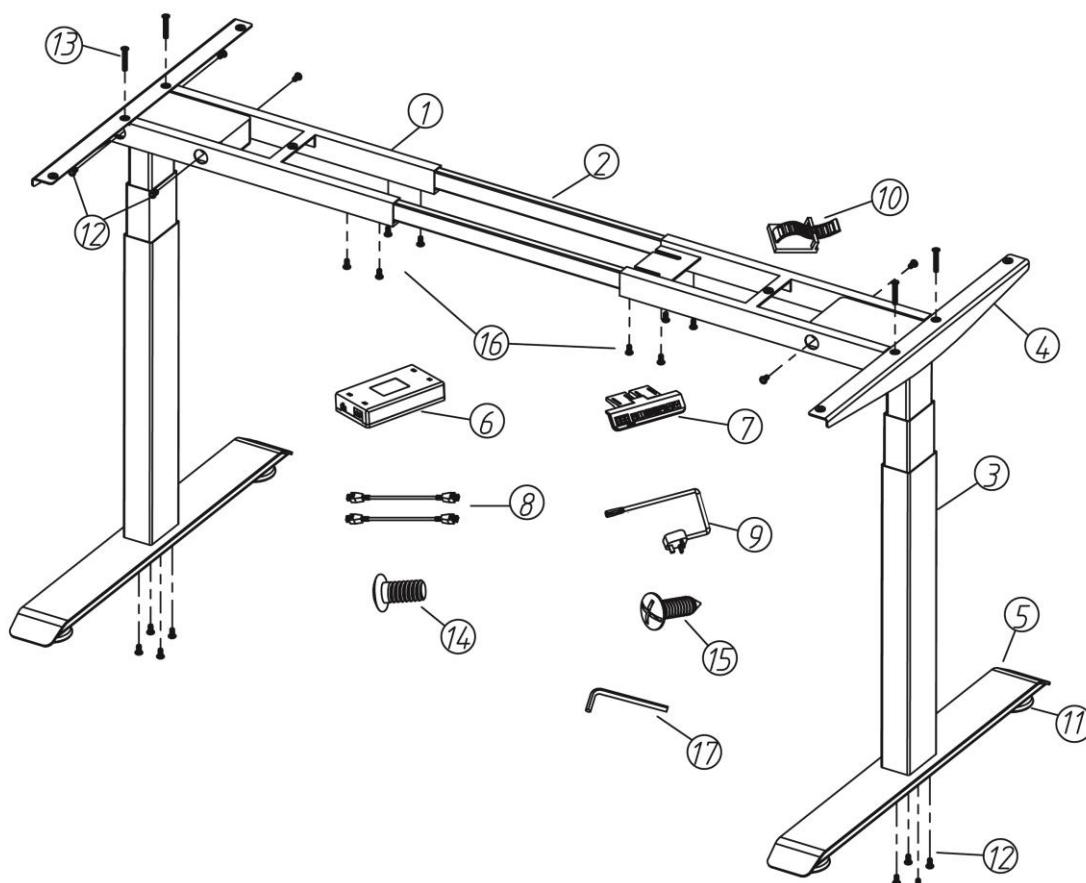

## STEP 1

Lay out all the parts to ensure that all items in the parts list are present.

Fully separate the End Frames (Part 1). You will find the Cross Rails (Part 2) inside.

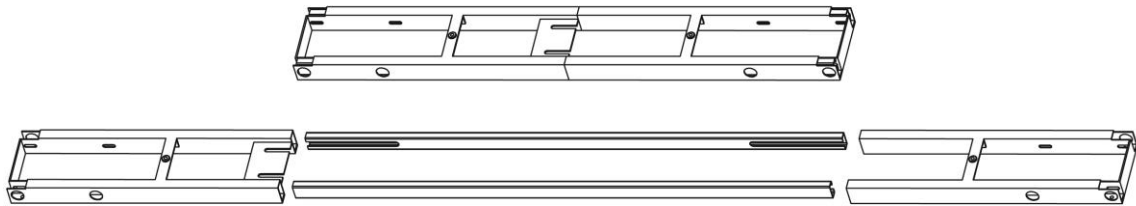

## STEP 2

Position Lift Column (Part 3) into the End Frame (Part 1) as shown in the diagram.

**Note: Orientate the center screw hole of the End Frame flushed to the top surface of the Lift Column.**

Align the edge holes of the Lift Column with the holes in the End Frame. Insert and fasten using 4 screws from Pack A with the supplied 4mm Allen Key (Part 17).

Repeat the same process for the other Lift Column.

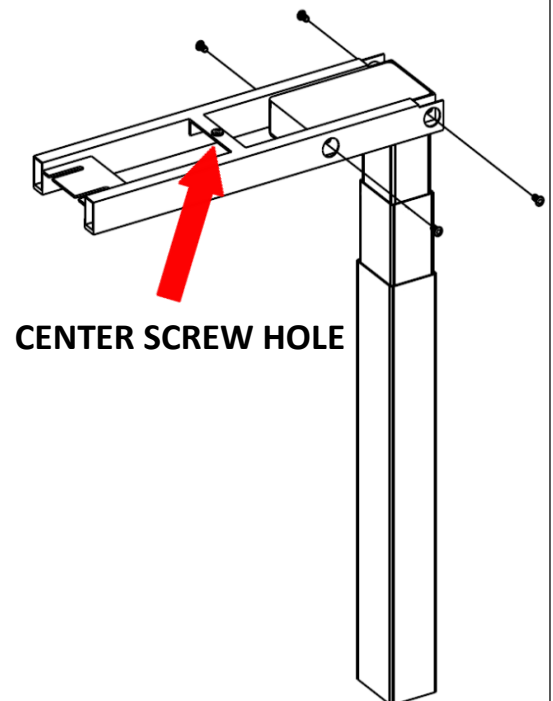

## STEP 3

Insert the Side Bracket (Part 4) into the End Frame (Part 1) and align the screw holes as shown.

**Note:** You may need to gently tap the bracket into place to align the screw holes.

Insert and fasten using 2 screws from Pack B.

Repeat the same process for the other Lift Column.



If there is difficulty fastening the screws, it may be because some of the earlier installed screws were fastened too tightly. Loosen if necessary.

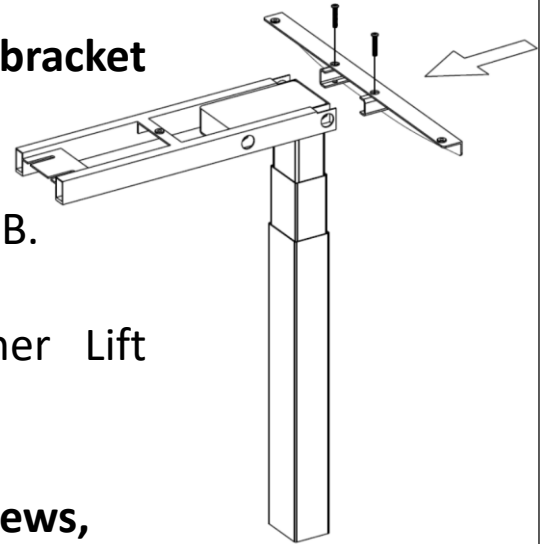

## STEP 4

Attach the foot (Part 5) to the bottom of the Lift Column (Part 3) and align the screw holes. Insert and fasten using 4 screws from Pack A in a criss-cross pattern.

Repeat the same process for the other Lift Column.

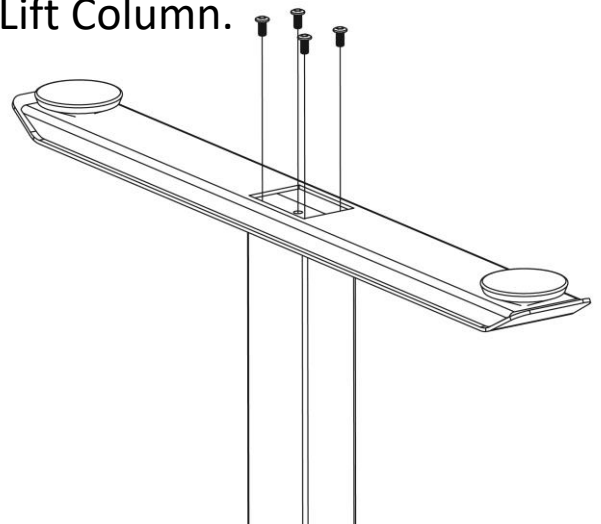

## STEP 5

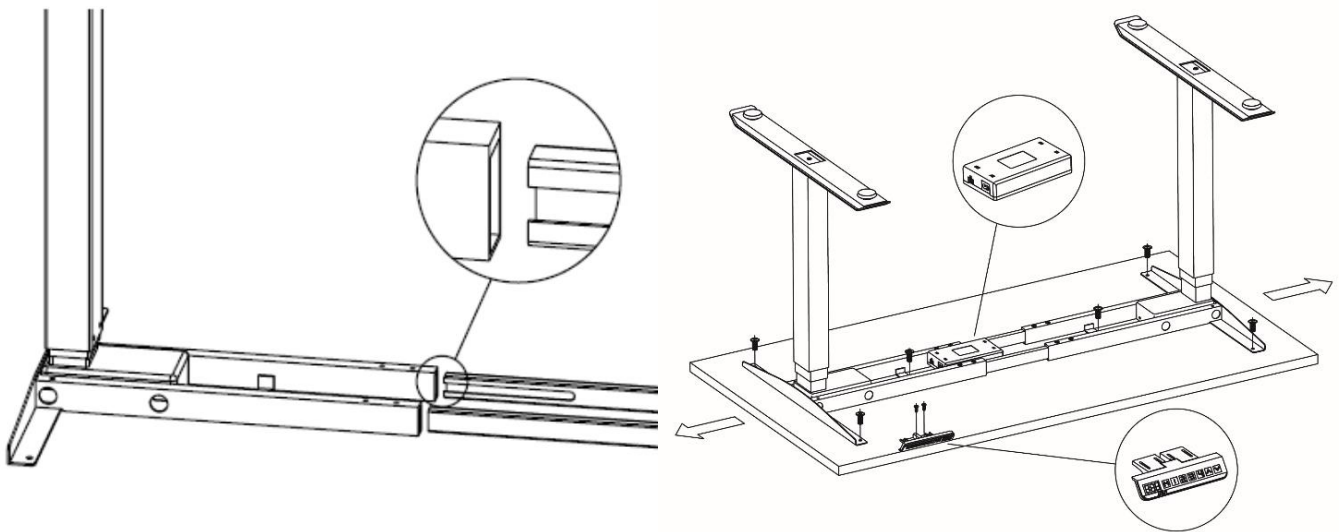

Orientate the side of the table top carton with the text "**Face up during installation**" upwards. Open the carton and ensure that the bottom surface of the table top faces upwards during installation.



**Leave the table top in its original carton during installation to avoid damaging the table top and its work surface.**

Place the two assembled Lift Columns (Part 3) on the bottom surface of the table top and insert the Cross Rails (Part 2) into the End Frames (Part 1). Ensure the Cross Rail slots face inwards.

Check that the frame assembly is sitting flat on the table top.



**If the frame assembly does not sit flat, redo steps 2 and 3 to ensure that the End Frame and Side Bracket are levelled with the top of the Lift Column.**

## STEP 5 - CONTINUED

### **Option 1: For table tops with AdapTABLE preinstalled nuts:**

Align the 6 screw holes (2 on each Side Bracket and 1 on each End Frame) to the preinstalled nuts on AdapTABLE supplied table tops. Insert and fasten using 6 screws from Pack C to fix the frame to the table top.

### **Option 2: For table tops without preinstalled nuts:**

Slide the Lift Columns out and leave approximately 3 – 4cm of space at each end. Center the frame assembly to the table top. Insert and fasten using 6 wood screws from Pack D to fix the frame to the table top.



**Check and make sure that the supplied wood screws in Pack D are not too long for the table top. Wood screws which are too long can puncture and damage the work surface. If the wood screws are too long, purchase shorter wood screws which fits your table top.**



**Maximum width of the frame is 180cm.**

Attach the Control Box (Part 6) by sliding it into the bracket welded to the End Frame (Part 1).

Align the handset (Part 7) flushed to the front edge of the table top (tapped holes are available on both sides of AdapTABLE supplied table tops). Insert and fasten using 2 wood screws from Pack D.



**Do not overtighten the screws. Overtightening could cause damage to the components.**

## STEP 6

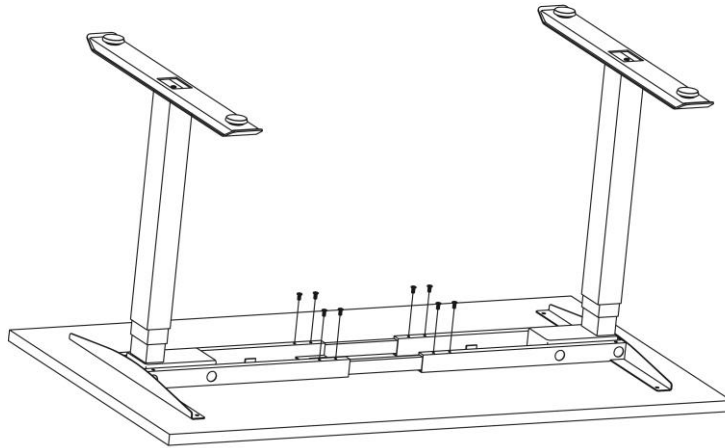

Ensure the Cross Rails (Part 2) are positioned evenly within the End Frames (Part 1). Insert and fasten using 8 screws from Pack E in a criss-cross pattern to fix the Cross Rails in position.

**Note:** If the cable trays are included. Align and fasten the *cable cover tray's* slots to the screw holes. Align and fasten the *cable management tray* to the 3 screw holes at the back of the table-top.

## STEP 7

Connect the Handset (Part 7) cable to the Control Box (Part 6). Connect the motor cables on the Lift Columns (Part 3) to the Control Box using the Lift Column Cables (Part 8). Connect the Power Cord (Part 9) to the Control Box.

Secure all cables neatly using the Cable Clips provided (Part 10).

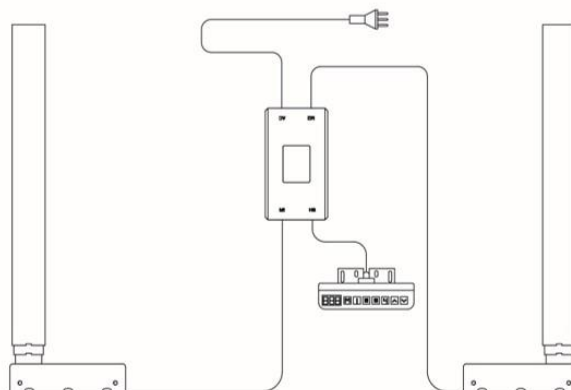

## STEP 8

---

Turn the assembled table over with minimally 2 personnel by grabbing the table top (do not grab by the Lift Columns) and using the feet as pivot points. Adjust the Levelling Feet (Part 11) as needed.

Plug the Power Cord (Part 9) into the mains and turn on the power.

Reset the frame before use. See Operation Guide for the Reset Procedure.



**Make sure no obstacles are above or below the table.**

**Make sure the table is not touching any walls.**

**Make sure all cords have the appropriate length to accommodate changes in height.**

---

**CONGRATULATIONS!**

**THE SET UP IS FINISHED**

**YOUR ELECTRIC HEIGHT ADJUSTABLE TABLE  
IS READY TO BE USED**



# OPERATION GUIDE

---

## **Reset Procedure**

To be performed 1) after initial set up and 2) when the system becomes abnormal. Press and hold the down arrow button until a buzzer sound is heard, signaling completion of the reset procedure. During the procedure, after the table reaches its lowest height, the handset displays “RST” while the table shifts slightly down and back up. It takes approximately 5 seconds after the table reaches its lowest height to complete the entire reset procedure.

## **Adjusting Height**

Press and hold the up arrow button to move the table up to the desired height, release to stop. Press and hold the down arrow button to move the table down to the desired height, release to stop.

## **Memory Preset**

Depending on the handset’s model, it may store up to 3 or 4 height presets. Use the up and down arrow buttons on the handset to reach the desired height. Press the M button and the handset displays “S-”. Press any of the numeral buttons to preset the height setting to that corresponding number. Pressing a preset button adjusts the table automatically to the saved height setting. During automatic height adjustments, pressing any button stops the adjustment.

## **Child Lock / Lock**

Press and hold the up and down arrow buttons together for approximately 5 seconds. Child lock is activated when you hear a buzzer sound and the handset flashes “- - -”. Release the up and down arrow buttons.

# OPERATION GUIDE

## **Unlock Child Lock / Unlock**

When the table has child lock activated, press and hold the up and down arrow buttons together for approximately 5 seconds. Child lock is deactivated when you hear a buzzer sound and the handset displays the height value. Release the up and down arrow buttons.

## **Sedentary Mode**

Press buttons “1” and “3” together and handset displays “0.0h”. Select the sedentary countdown duration in steps of 30 mins (0.5 = 30 mins) by increasing with the up arrow and decreasing with the down arrow. The setting will automatically exit by itself after 2 seconds. Upon successful set up of the sedentary mode, the handset’s display flashes every 5 seconds. When the sedentary countdown ends, users will be notified by buzzer sounds. Sedentary countdown ranges between 30 mins to 5 hours, in steps of 30 mins.

To cancel sedentary mode: Press buttons “1” and “3” together and handset displays “X.Xh” (X denotes a numeral). Press the down arrow button till the handset displays “0.0h”. The setting will automatically exit by itself after 2 seconds.

## **Set custom maximum and minimum height (good for obstacle avoidance)**

### **Set the maximum height**

Move the table to the maximum height you would like to limit the table to. Press the M and up arrow buttons together for approximately 5 seconds. Release the buttons when you hear a buzzer sound, signaling maximum height set. To remove the custom maximum height setting: 1) Use reset procedure or 2) Move the table to the maximum height followed by pressing the M and up arrow buttons together for approximately 5 seconds. Release the buttons when you hear a buzzer sound, signaling the cancellation of the custom maximum height.

# OPERATION GUIDE

---

## Set the minimum height

Move the table to the minimum height you would like to limit the table to. Press the M and down arrow buttons together for approximately 5 seconds. Release the buttons when you hear a buzzer sound, signaling minimum height set. To remove the custom minimum height setting: 1) Use reset procedure or 2) Move the table to the minimum height followed by pressing the M and down arrow buttons together for approximately 5 seconds. Release the buttons when you hear a buzzer sound, signaling the cancellation of the custom minimum height.

## **Anti-Collision Sensitivity & Unit Of Height Setting**

Please kindly contact technical support.

## **Warning:**

Do not move the table continuously for more than 2 minutes without at least an 18 minutes break interval.

To avoid overloading the transformer, there is an overload protection program inbuilt into the system. If the table stops working, let it cool off for at least 18 minutes before trying to adjust the height again. "E09" will appear on the handset display if the lifting mechanisms are overheated.

# OPERATION GUIDE

## Error Code Key

Code	Meaning	Suggested Actions
<b>E01</b>	Power supply exceed input voltage range.	Check if power supply is within required input voltage range.
<b>E02</b>	Lift columns unbalanced by > 10mm.	Perform reset procedure.
<b>E03</b>	Handset not connected.	Plug handset wire connector into the control box.
<b>E04</b>	Handset communication error.	Check handset for damage. Reconnect handset wire connector into the control box.
<b>E05</b>	Obstacle detected, anti-collision activated.	Release depressed button.
<b>E06</b>	Start up error.	Reconnect all cable connectors into control box. If problem persists, check with technical support.
<b>E07</b>	Control system error.	Perform reset procedure.
<b>E08</b>	Table tilts during height adjustment.	Perform reset procedure.
<b>E09</b>	Overheated or duty cycle limit was reached.	Let the table electronics cool down for at least 18 minutes before using.
<b>E11/21</b>	Motor M1/M2 is not connected.	Plug M1/M2 motor cable connectors into the control box.
<b>E12/22</b>	Motor M1/M2 current sampling error.	Reconnect M1/M2 motor cable connectors into control box. If problem persists, check with technical support.
<b>E13/23</b>	Phase loss or phase line disconnected from motor M1/M2.	Reconnect M1/M2 motor cable connectors into control box. If problem persists, check with technical support.
<b>E14/24</b>	Hall sensor error or hall sensor wire disconnected from motor M1/M2.	Reconnect M1/M2 motor cable connectors into control box. If problem persists, check with technical support.
<b>E15/25</b>	Motor M1/M2 internal circuit error.	Reconnect M1/M2 motor cable connectors into control box. If problem persists, check with technical support.
<b>E16/26</b>	Motor M1/M2 stalled.	Perform reset procedure.
<b>E17/27</b>	Motor M1/M2 directional error.	Reconnect M1/M2 motor cable connectors into control box. If problem persists, check with technical support.
<b>E18/28</b>	Table overloaded.	Reduce weight on the table.

# OPERATION GUIDE

## Error Code Key

Code	Meaning	Suggested Actions
<b>E40</b>	Series connection error.	Reconnect all cable connectors into control box. If problem persists, check with technical support.
<b>E41</b>	Series signal error.	Reconnect all cable connectors into control box. If problem persists, check with technical support.
<b>E42</b>	Memory error.	Reconnect all cable connectors into control box. If problem persists, check with technical support.
<b>E43</b>	Gyro-sensor error.	Reconnect all cable connectors into control box. If problem persists, check with technical support.

## TECHNICAL SPECIFICATIONS

Height Range	60 – 125cm (without desktop)
Base width	110 – 180cm
Travel Speed	38mm/s (no load)
Weight capacity	130kg
Motor count	2
Segments	3
Duty Cycle	10%; Max 2 mins on, Min 18 mins off
Input Voltage	100 VAC – 240 VAC
Noise	<50 dB
Certificates	CE / UL / SAA
Features	Electric motor lifting mechanism
	Soft start/stop
	Adjustable levelling foot
	3-4 Memory presets (handset dependent)
	Metric/imperial units
	Child lock function
	Sedentary countdown timer
	Adjustable anti-collision system
	Custom max and min height set up
	Short circuit protection
	Overheat protection

# CAUTION

Make sure no obstacles are above or below the table. Make sure the table is not touching any walls. Make sure all cords have the appropriate length to accommodate changes in height.



## **WARNING! PINCH POINT!**

Keep hands and fingers clear!



Keep children from operating sit stand tables, control units and handsets. There is a risk of injury and electric shock.



Keep all electrical components away from liquids.



Do not sit or stand on the table frame.  
Do not crawl or lie under the table frame.



Do not place any objects taller than 40cm underneath the table.



Do not attempt to open any of the components - the Lift Columns, Control Box, or Handset Controller. There is a risk of electric shock.



The product is designed with a duty cycle of 10%  
(Max 2 mins on, min 18 mins off).

## USE & LIABILITY

This sit stand table has electric motors and is designed for use in dry work areas only. The table height is adjustable so that it can be positioned at the most ergonomically suitable height. Any other use is at user's risk. Under no circumstances does the manufacturer accept warranty claims or liability claims for damages caused from improper use or handling of the table frame.