

babybee

luna stroller manual



babybeonline.com

IMPORTANT! Keep For Future Reference
Australian Safety Standard: AS/NZS 2088:2013
and Consumer Protections Notice No. 8 of 2007



Welcome aboard and
thanks for choosing
Babybee.



Read me first

Before we start, there's a few important things you need to be aware of:

Safety first

The safety of your family is our number one priority. Please take the time to carefully read this manual and all warning notices on pages 17-19 before getting started. Incorrect assembly or use can result in serious injury or death.

⚠️ WARNING

TO PREVENT INJURY FROM CHOKING, CAREFULLY REMOVE AND IMMEDIATELY MOVE OUT OF REACH ALL PROTECTIVE PACKAGING. NEVER LEAVE YOUR CHILD UNATTENDED WITH THE PRAM OR PACKAGING.

Return Policy

If you decide that the **LUNA** is not the perfect one for you, we offer a Free Return Policy when returned in original condition and packaging (with no signs of usage). Please be mindful of this when unboxing and setting up. Refer to our website for full terms and conditions.

Support

If at any stage you require assistance with set up or use, please refer to our website. There, you'll find instructional videos and FAQ's. Or feel free to email us anytime at:

au.support@babybeeonline.com or
nz.support@babybeeonline.com

Enjoy the ride, from all of us at

 **babybee**

What's in the box

Please check that you have all the correct parts before getting started.



- 1 - Stroller
- 2 - 2x rear wheels
- 3 - 2x front swivel wheels
- 4 - 2x belly bars
- 5 - 2x sets of harness covers

- 6 - Rain cover
- 7 - 2x foot covers
- 8 - User manual
- 9 - 1x newborn cocoon
- 10 - 2x seat liners

Contents

- 04 What's in the box checklist
- 06 Step 1: **Setting up your stroller**
- 08 Using your LUNA
- 08 Rear brake
- 08 Front swivel wheels
- 09 Seat recline
- 09 Adjusting the footrest
- 10 Safety harness
- 11 Canopy
- 11 Folding the Stroller
- 12 Free accessories
- 13 Newborn Cocoon
- 14 Tips for maintaining your pram
- 15 Cleaning
- 16 Warranty
- 17 Safety warnings

Step 1 - Setting up your stroller

- 1** To open the frame from the folded position, release the frame lock on the left side of the frame and lift the handlebar upwards until the frame locks into place.



- 2** To attach the rear wheels, push each wheel pin into the sides of the brake bar until you hear a "click". Give them a tug to ensure they are attached securely.



- 3** Next, insert each front wheel pin into the centre of the socket ensuring you hear them "click" in. Give each wheel a firm tug to ensure they are secure.



4

Finally, insert the belly bars into the belly bar sockets on the seat frame. To remove from one side or both, press the button on the side you want to release, and pull the belly bar out.

Your LUNA is now set up and ready to roll!



TIP: Your **canopy** visor may need a little TLC after shipping. To get it looking nice and new again simply reshape as best you can with your hands. If you have a clothes steamer you can also apply steam to the canopy to help smooth any wrinkles.

⚠️ WARNING

- EACH SEAT ACCOMMODATES ONE PASSENGER WITH A MAXIMUM WEIGHT LIMIT OF 20KG.
- DO NOT ALLOW YOUR CHILD TO CLIMB UNASSISTED INTO THE STROLLER.
- DO NOT CARRY EXTRA CHILDREN OR BAGS ON THIS STROLLER. THIS MAY CAUSE YOUR STROLLER TO TIP.
- NEVER LEAVE COVERS ON OR OVER THE STROLLER INDOORS, IN VERY HOT WEATHER OR NEAR A HEAT SOURCE. ALWAYS
- SUPERVISE AND MONITOR YOUR CHILD REGULARLY WHILST THE STROLLER IS COVERED.

Using your LUNA

Correct use:

Any vehicle with moving parts will need to be used and treated with care and given regular maintenance to remain safe and in good condition. Please be gentle, don't overload it, avoid excessive off road use and be sure to follow the maintenance instructions on page 14 to keep your **LUNA** looking and feeling newer for longer!

Rear brake:

When stopping, use the brake at all times by pressing down on the bottom of the red paddle with your foot. To start travelling again press down on top side of the paddle to disengage the brake and off you go!



Front swivel wheels:

When travelling fast along straight surfaces or across uneven terrain, the front wheels may spin or cause what's commonly known as "wheel shudder". To lock the front swivel wheels into place, press the wheel lock down. To go back to 360° swivel mode, press the buttons up again. To remove the front wheels, press the black button on the inside of the side of the wheel socket and pull the wheel down.



Note: The wheel must be in this position for the lock to engage.

Rear wheels:

To remove the rear wheels, press the button located on the brake bar and pull the wheel off.



Basket:

The **LUNA** basket has been tested to hold 10kg. Overloading the basket with more weight may cause the basket to break. The basket can be removed by undoing the press studs on all sides.

Reclining the seat:

Squeeze the release latch on the back of the seat and pull it downwards stopping at your desired position. To raise the seat, hold both straps with one hand and squeeze the release latch while pushing the back of the seat up with your other hand.



Adjusting the footrest:

Lift the footrest to up till it clicks into place. Push down, squeeze the release buttons underneath and lower. Please take care when using the foot rest. Forcing it or putting too much pressure may cause damage.



⚠️ WARNING

CHILDREN CLIMBING ON THE FOOTREST MAY CAUSE IT TO BREAK.

Using your LUNA

Safety Harness:

Always engage the brake before placing your child in the stroller.

To secure the harness:

- 1 Attach each of the 4 harness straps into the central buckle.
- 2 Adjust the length of each strap to ensure it fits nice and snug.
- 3 Always give the harness a tug to ensure its secure.
- 4 To release press the button in the middle of the buckle.

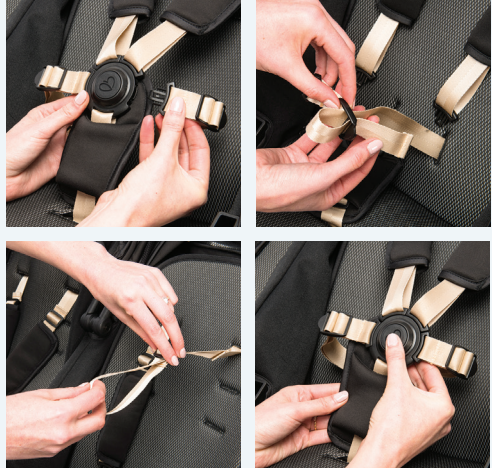

To adjust the height of the harness straps:

- 1 Depending on your child's height, thread the shoulder strap through the appropriate slot on the seat.
- 2 Ensure it is thread through the corresponding slot of the seat liner.
- 3 Adjust the strap length using the buckle as required.



Having trouble? Visit our website for a video tutorial on how to adjust the harness.

⚠️ WARNING

- USE THIS HARNESS AT ALL TIMES. ALWAYS USE THE HARNESS WHEN YOUR CHILD IS IN THE STROLLER.
- ALWAYS ADJUST THE HARNESS APPROPRIATELY FOR YOUR CHILDREN'S SIZES AND ENSURE ALL 5 STRAPS ARE SECURED.
- NEVER LEAVE THE HARNESS BUCKLED WHEN NOT FITTED TO A CHILD IN THE STROLLER. THE HARNESS CAN FORM LOOPS WHICH MAY CAUSE A STRANGULATION HAZARD.

Canopy:

Adjust the canopy as needed to protect your child from the sun and wind. For maximum protection, use the zip to extend the canopy to its maximum length. The visor can be pushed in or out depending on your requirement.

Folding the Stroller

- 1 Make sure the canopy is retracted and the brake is engaged.
- 2 Slide the black button on top of the handlebar to the left & then simultaneously squeeze the larger black button under the handlebar in.
- 3 This will release the frame and allow you to push the handlebar forwards to collapse the stroller.
- 4 You can hold the seat frame to assist you when folding.
- 5 Always ensure that the frame lock on the side of the frame has securely attached to prevent the stroller from opening while transporting it.



⚠️ WARNING

- ALWAYS REMOVE THE COCOON PRIOR TO FOLDING.
- ALWAYS TAKE CARE WHEN FOLDING THE FRAME AND LIFT FROM THE CARRY BARS BEHIND THE SEATS.
- ENSURE CHILDREN ARE OUT OF REACH OF THE STROLLER BEFORE FOLDING.
- TO AVOID POSSIBLE INJURY, ALWAYS ENSURE THAT THE FRAME LOCK IS SECURED BEFORE LIFTING AND CARRYING THE STROLLER.
- TAKE EXTRA CARE WHEN FOLDING, LIFTING, AND CARRYING THE STROLLER. ALWAYS LIFT AND CARRY YOUR STROLLER USING BOTH HANDS.

Free Accessories

Seat Liner

Attach the seat liner by threading the harness straps from the seat through the corresponding slot on the liner.



Foot Covers

Place the foot cover over the foot rest and secure the straps with the Velcro over the belly bar.



Rain Cover

Pull the rain cover over the top of the canopy. Attach the long Velcro sides at the back of the stroller and loop the Velcro at the front around the front wheel hubs.



Newborn Cocoon

Read me first: Failure to follow warning instructions could result in serious injury or even death!

⚠️ WARNING

- ALWAYS REMOVE BABY FROM COCOON BEFORE REMOVING THE COCOON FROM THE STROLLER.
- ENSURE COCOON SIDES ARE SECURELY FASTENED TO THE SIDES OF THE SEAT. IF NOT SECURE, FABRIC COULD POSE A SUFFOCATION RISK.
- NOT DESIGNED FOR PROLONGED PERIODS OF TIME OR OVERNIGHT SLEEPING.
- MONITOR YOUR BABY REGULARLY WHILST IN COCOON.
- TO REDUCE THE RISK OF SIDS, BABIES SHOULD BE PLACED ON THEIR BACKS AND THE COCOON KEPT CLEAR OF SOFT TOYS, BLANKETS AND OTHER POTENTIAL SUFFOCATION HAZARDS.
- IN HOT WEATHER, REMOVE COCOON COVER AND MONITOR BABY'S TEMPERATURE REGULARLY.
- DESIGNED FOR USE WITH THE BABYBEE **LUNA** ONLY. DO NOT USE WITHOUT STROLLER.

- 1 Recline the seat to the flat position and extend the foot rest.
- 2 Thread the attachment belt on the bottom of the cocoon through the sides of the seat and buckle underneath. There are slots in the seat fabric to do this.
- 3 Do the same at the foot end, fastening the attachment belt around the foot rest. Make sure both are fastened tightly.
- 4 Attach the studs at the head end of the cocoon to the inside of the seat fabric to keep it in place.
- 5 Fasten the toggles in the position of your choice depending on the weather. Belly bar can be on or off.



TIP: Instructional set-up videos can be found on our website should you need them.

Tips for maintaining your stroller.

Excessive wear can reduce the effectiveness and safety of your stroller. To keep your LUNA in good working condition and ensure that it lasts as long as possible will require regular maintenance and you will need to service your stroller every 6 months.

Regular maintenance should include:

- 1 Inspecting the locking devices, levers, joints, buttons, brakes, wheels, safety harness and fixtures to ensure they are secure, moving freely and in full working order.
- 2 If any parts of the stroller have become stiff, difficult to operate or begin to squeak, first ensure that dirt is not the cause. Then try a light application of a sprayable silicone lubricant, ensuring that it penetrates between the components. **Note:** Only use lubricant labeled 'Silicone Lubricant', other lubricants can deteriorate the plastic parts of your stroller and also attract dirt and dust e.g. DO NOT use standard WD40).

We recommend WD-40 SPECIALIST Silicon Lubricant or SCA Silicone Spray available from Supercheap Auto, Bunnings and most hardware stores.

- 3 Follow our cleaning instructions on the next page.

Correct use

The **LUNA** has been designed for urban living and weekend adventures which means it's ideal for walking on sealed footpaths, in shopping centres, cafes and down at your local park. Use of the **LUNA** off-road or over uneven terrain will place more stress on the frame and wheels and cause it to wear out faster. For this reason, we recommend "weekend adventures" and not regular off-road use.

Correct storage

- Do not leave the stroller in direct sunlight for prolonged periods of time to avoid colour fade.
- Do not leave in your car on days of extreme heat or near any heat source or fire.

⚠ WARNING POISONOUS, TOXIC SUBSTANCE. USE WITH CARE
ENSURE CHILDREN ARE NOT PRESENT WHEN APPLYING SILICON LUBRICANT OR ALLOWING IT TO DRY. ALWAYS SPRAY OUTSIDE OR IN A WELL VENTILATED AREA. WIPE AWAY EXCESS SOLUTION BEFORE USE.

- Do not store the stroller with heavy items on top of it.
- Store the stroller in a dry, well-ventilated and safe place.

Preventing rust & mould

After exposure to wet or damp conditions (especially trips to the beach, snow or in the rain), leave the stroller fully open in a warm, well-ventilated environment to prevent rust and mould. You may need to dry with a soft, lint free cloth. Left damp it will encourage mildew, mould or rust to form, damaging the stroller.

Spare parts

- The brakes and wheels are subject to normal wear and should be replaced if necessary.
- Spare parts are available for purchase on the parts and accessories page of our website (babybeeonline.com). If the part you require is not listed please email us for a quote.

Cleaning instructions

For a comprehensive deep cleaning guide (we recommended you do this every 6 months) please refer to our website.

- Use a soft brush to brush down the stroller and remove any dirt or dust making sure you get into all the nooks and crannies (i.e. inside the wheel hubs, inside the joints from all folding parts etc). You could also give it a good vacuum.
- Wipe dry with a soft towel or cloth and allow all parts to dry thoroughly before using.

- At the first sign of rust, remove with steel wool.
- All plastic, fabric and metal parts of the stroller may be sponged clean with a soft cloth in warm water and a mild detergent.
- The seat liners are machine washable on a delicate setting (maximum water temperature of 30°C) however handwashing will keep them looking newer for longer.

Do Not

- Do not immerse the seat or canopy in water, sponge clean only.
- Do not clean with abrasive materials or using ammonia, bleach, solvents, caustic or spirit-based cleaners.
- Do not press or iron.
- Do not rub or wring fabric.
- Do not tumble dry.
- Do not dry clean.

WARNING

- **DO NOT CLEAN YOUR PRAM WITH CHILDREN AROUND.**
- **DO NOT DISMANTLE OR ALTER ANY PART OF THE FOLDING MECHANISMS, FRAME, BRAKE AXEL OR WHEELS FOR CLEANING OR ANY OTHER REASON.**
- **DO NOT USE IF ANY PART IS BROKEN, TORN OR MISSING. REPLACEMENT PARTS ARE AVAILABLE FROM OUR WEBSITE OR BY CONTACTING US.**

Failing to adhere to these maintenance and cleaning instructions could damage or effect the safety of your pram and may void your warranty.

Warranty Information

Your LUNA comes with a 2 year defects warranty to cover against faults in materials and workmanship when your stroller is used under normal conditions, according to our user manuals and technical specifications.

The benefits under our warranty are in addition to other rights and remedies under the law in relation to consumer goods: **Our goods come with guarantees that cannot be excluded under the Consumer Law in the country of purchase. You are entitled to a replacement or refund for a major failure and for compensation for any other reasonably foreseeable loss or damage. You are also entitled to have the goods repaired or replaced if the goods fail to be of acceptable quality and the failure does not amount to a major failure.**

The warranty period starts from the date that your stroller is dispatched from our warehouse and is valid in the country of purchase only.

To make a claim email us at **au.support@babybeeonline.com** with or **nz.support@babybeeonline.com** with a detailed description, video and/or photos of the defect and a photo of the batch number, which is located inside the back of your basket. Our warranty team will then determine the best way to resolve any defects or faults. Babybee reserves the right to repair, exchange or replace the damaged item with a replacement part. Some parts may be replaced with newer model parts as the stroller is improved over time.

The warranty is not valid in the following cases:

- Defects or faults resulting from improper assembly, care or use as outlined in our user manual;
- Defects or faults resulting from an accident, airline or transport damage;
- Normal wear and tear, including scratches to the frame or colour fading of the fabrics;
- Damage to handle/bellybar grips or fabrics (i.e. scuffs or tears) as a result of normal handling and daily use;
- Corrosion, mould or rust due to extreme environmental conditions, including high humidity, salt spray, snow or due to lack of regular maintenance.
- Products that are purchased second hand or from an unauthorised distributor;
- Using a part or accessory that is not compatible with the product and/or not manufactured by Babybee Prams;
- If you or a third party has attempted to modify or repair the pram without having received written permission from Babybee Prams.
- Claims from anyone other than the original purchaser (i.e. no longer valid if gifted or sold to another individual)
- Damage resulting from extreme heat conditions (i.e leaving in car on hot days)
- Customer dissatisfaction with the product in terms of fit, weight, functionality, colour or design.

Safety Warnings

The Babybee LUNA is designed and tested to comply with AS/NZS2088:2013.

The ACCC has identified several key hazards associated with strollers which could result in serious injury or even death:

- The pram or stroller rolling away from the carers control
- Limb and finger injuries
- Falls
- Strangulation or suffocation

Please read and follow the bellow warning notices before using your stroller:

WARNING

TO AVOID INJURY OR DEATH:

- **ALWAYS APPLY THE BRAKES WHEN THE PRAM/STROLLER IS STATIONARY.**
- **DO NOT LEAVE CHILDREN UNATTENDED.**
- **SECURE THE CHILD IN THE HARNESS AT ALL TIMES.**
- **DO NOT CARRY EXTRA CHILDREN OR BAGS ON THIS PRAM/STROLLER.**
- **MAKE SURE CHILDREN ARE CLEAR OF ANY MOVING PARTS IF YOU ADJUST THE PRAM/STROLLER.**

Seat Specific

- This stroller seats two passengers with a maximum weight limit of 20kg per seat.
- Not suitable for a child under 6 months old who cannot sit up unaided.
- Do not allow your child to climb unassisted into the stroller.

Safety Harness

- Please ensure that your child correctly wears the fitted and adjusted safety harness at all times with all 5 straps secured.
- Never leave the harness buckled when not fitted to the child in the stroller. The harness can form loops which may cause a strangulation hazard.

Cocoon Specific

- Not to be used for overnight or unsupervised sleeping.
- Only use the cocoon in a flat position. Do not sit on an angle.
- To reduce the risk of SIDS, do not add additional blankets or toys inside the cocoon and only place your baby on its back.
- Monitor your child regularly when using the cocoon.

WARNING

- **DO NOT USE THE COCOON ONCE THE CHILD CAN SIT UP UNAIDED.**

Safety Warnings Continued

Accessories & replacement parts

- Do not use parts or accessories that are not approved for use with the Babybee **LUNA** range. Doing so may be unsafe and may also void your warranty. (e.g. toddler boards, bag hooks, raincovers etc)

Carrying your stroller

- To avoid finger entrapment, keep your own and your children's fingers clear of any folding parts.
- Do not lift or carry the stroller when occupied by your child.
- Do not lift or carry the stroller when fully assembled. Only lift and carry after folding.
- Ensure that the frame lock is engaged before lifting or carrying the stroller.
- Make sure the stroller and all parts are secured when being transported in a vehicle.

General safety

- This is not a toy. Do not allow your child to climb, stand on or play with the stroller.
- Do not use the stroller in a manner for which it is not designed.

- Keep children clear of the stroller before making any adjustments.
- Not suitable for running, rollerblading or skating.
- Remove your child and fold the stroller/stroller when going up or down stairs or escalators.
- Take your child out of the stroller when travelling by bus, tram or train.
- Gentle sloping surfaces may be unstable. On steeper sloping an uneven surfaces, there is a possibility that the stroller may tip over and you may need to remove your child.
- Do not use if any part is broken, torn or missing. Replacement parts are available from our website or by contacting us.
- Do not use or leave the stroller near open fire or exposed flame.
- Never leave rain covers, canopy/ cocoon covers on or over the stroller indoors, in a hot atmosphere or near a heat source. Always supervise whilst the stroller is covered.
- Always ensure that the frame and the seat/cocoon are correctly engaged before using the product.
- Do not overload the stroller with additional children, bags, other items or accessories.

- Bags and other items must not be hung from the handle bar as they may damage the frame or otherwise cause the stroller to become unbalanced and tip over.
- Do not allow children to stand on the axle/brake bar between the wheels. This is unsafe and could damage the stroller.

Maximum weight limits:

- Maximum weight for a child in the cocoon is 9kg.
- Maximum weight for a child in the seat is 20kg.
- Maximum weight limit for the basket is 10kg.

Supervision

- Never leave your child unattended with the stroller. It should only be used under adult supervision.

Others using your pram

- If the stroller is being used by someone unfamiliar with it (such as grandparents) always explain to them how the stroller works and its safety features.

⚠ WARNING

USE THE TETHER STRAP TO STOP THE PRAM/STROLLER ROLLING AWAY.





Designer style.
Unbeatable value.



Babybee prams



babybeeprams



au.support@babybeeonline.com
nz.support@babybeeonline.com

Model: 2019 **LUNA**. Version: 2 - June 2021. Information subject to change. Please see website for current version.

[babybeeonline.com](https://www.babybeeonline.com)