

VR09

Wheel speed sensor (Differential Hall Effect)

Maximum frequency	20 KHz
Distance to target	0.5 to 3 mm
Supply voltage	4 to 25 V
Supply current	15 mA
Output signal	NPN open collector
Output resistance	Needs a pull Up resistor
Max voltage on the output	25 V
LED indicator	Yes
Orientation	Straight or right angle (see drawing)
Sensitive element	Differential Hall Effect
Fixing hole	Diam 4 at 12 mm from sensor axis
Dimensions	25 x 9 x 9 mm
Material	Stainless steel & Aluminium
Weight (without cable)	15 g
Protection	IP66
Vibration test	20 Gpp 5'
Shock	500 G
Operating temp	-50 to 150°C
Storage temp	-50 to 150°C

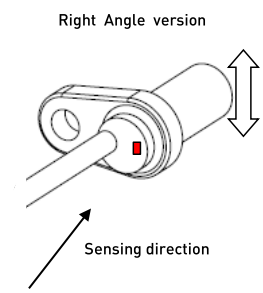
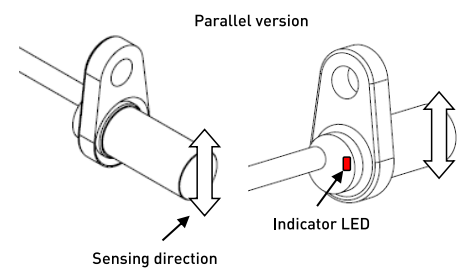
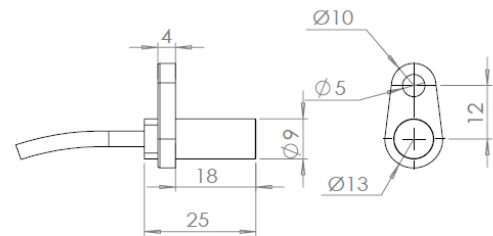

Ordering ref ex : VR-09-R-RA
VR-09-orientation

Parallel (P)
Right Angle (RA)

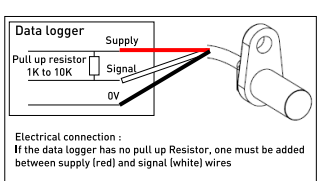

Red Supply
Black 0V
White Signal
Braid Not connected

In the interest of continuous product improvement, we reserve the right to alter without prior notice the specifications and features described on this document