

Compressor HKI 444 Premium



Thank you for choosing HKI AIR SUSPENSION products to control your air suspension.

Our mission is to provide the best experience for you and your vehicle. Our commitment is huge, from development, manufacture, service, sale and warranty.

This manual will provide all important information for the correct and safe use of our products.

However, if you have any difficulties or if you have any questions that are not addressed in this document, please feel free to contact our team.

hki@hkiairsuspension.com

HKIAIR
SUSPENSION

The 12v air compressor is an essential component of the air suspension system. It is responsible for filling the air tank that is used to inflate each air bag in the vehicle. Simply put, it's the heart of your air suspension.

The product was specially developed to work without oil or any other internal lubricant, its internal components have this characteristic.

Pneumatic Installation

The air compressor must not have any restriction on the passage of the air generated by it to the air tank, opt for exclusive ports for the product with a diameter equal to or greater than that of the hose.

If two air compressors are installed, prefer an individual ports, each air compressor independently entering the air tank.

Always use a thread sealant of your choice to make such a pneumatic installation.

The air compressor can be installed at any angle, as long as the product is very well fixed, using the 4 fixing points.

HKI 444 Premium compressors are **RESISTANT** to water and not waterproof, therefore any external installation that may have contact with abundant water in any situation must be avoided at all costs.

However, if external installation of the compressor is necessary, relocate the compressor's air filter to a location free from any possibility of contact with water.

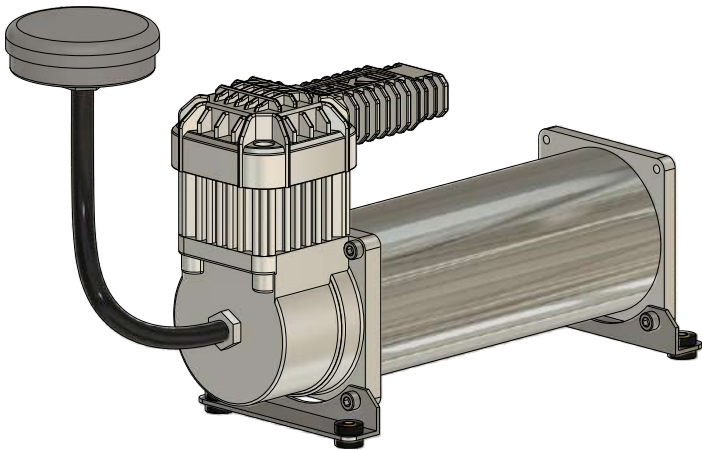

The pressure switch installation must be done by a professional and its bad installation may compromise its functionality and even harm the compressor's electrical system.

ALWAYS depressurize the system and disconnect the 12v power cable from the battery before mounting or dismantling the

Electrical Installation

In order to maintain the functioning and durability of the product, the electrical installation must be followed as suggested below.

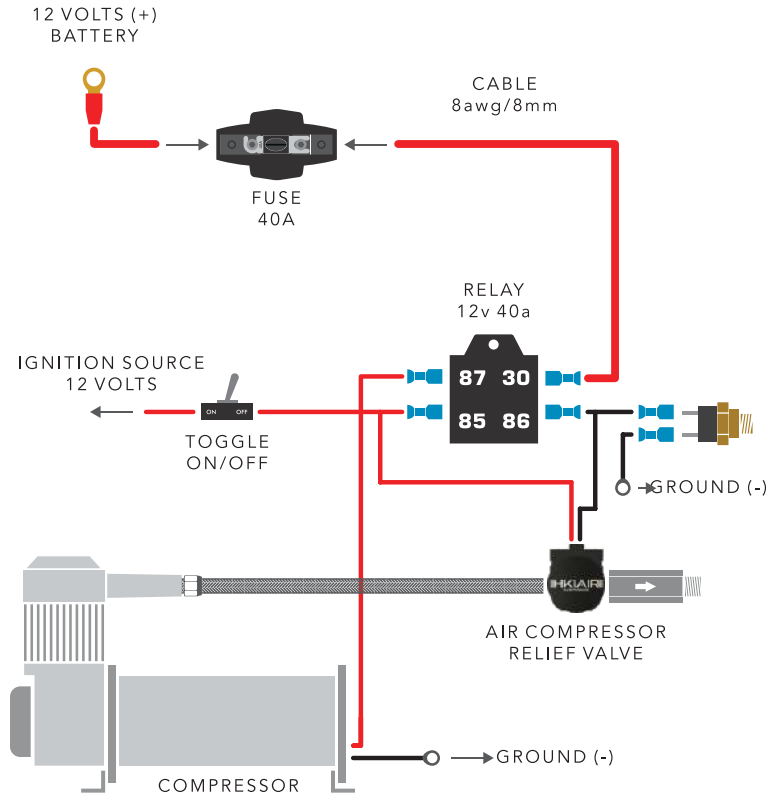

For the installation of two compressors, consider:

- Addition of one more 12v 40a Relay with pin 86 interconnected. *That is, the cable that will connect to one of the pressure switch poles must be the same for pins 86 of the two relays.*
 - Change system fuse from 40a to 80a.
 - The 12v cable coming from the battery should connect to pin 30 on both relays.
 - The positive cable of each electric compressor (red) must be connected separately to pin 87 of each relay
 - The 12v turn key cable must connect to pin 85, for relay actuation, of both relays.
- In this way, the two compressors will always work at the same time, avoiding any overload in the electrical system.*

