

# Toiee®

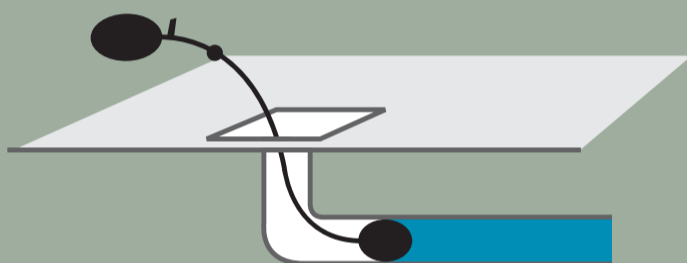

## Drain Plug - en afspærringsballon



**SCAN  
ME!**

- 1** **Placer Drain Plug i afløbet**  
*Place Drain Plug in the drain/sewer*
- 2** **Pump op indtil Drain Plug er hård**  
*Pump up until the Drain Plug is hard*
- 3** **Kontrollér at trykket er hårdt nok**  
*Check if the pressure is hard enough*



Produkt info.



Se videoen

**Stop water coming  
up the sewers and drains**

Patent Pending

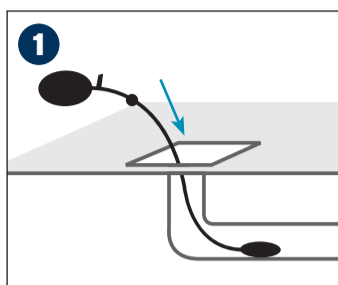

**Placer Drain Plug i afløbet**  
Place Drain Plug in the drain/  
sewer

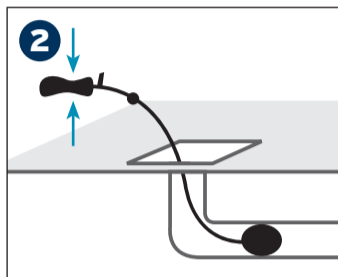

**Pump op indtil Drain Plug er hård**  
Pump up until the Drain Plug  
is hard

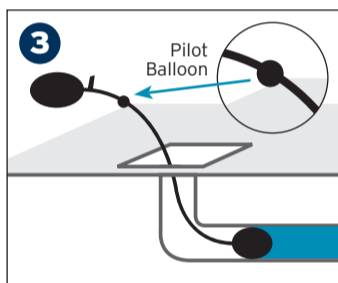

**Kontrollér at trykket er hårdt nok**  
Check if the pressure is hard  
enough

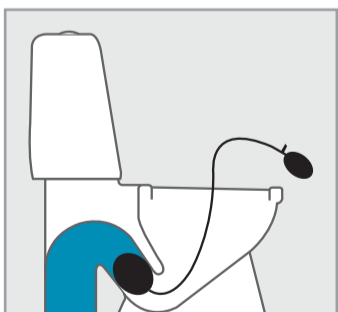

**110 mm kan også benyttes i toiletter**  
110 mm may also be used  
in toilets

 Find os på Facebook

 Se os på Trustpilot

# Toiee® Drain Plug

## Stop water coming up the sewers and drains

**Toiee® Drain Plug** afspærringsballon er det enkle værktøj, der er let at anvende, og er udviklet så det kan hjælpe i mange situationer, hvor der er risiko for opstigende vand. **Toiee® Drain Plug** findes til alle afløbsdimensioner i boliger: 32mm, 40/50mm, 75mm og 110mm.

**Toiee® Drain Plug** er testet af det internationalt certificerede testcenter DTI, Danmarks Teknologiske Institut. Testen viser at **Toiee® Drain Plug** afspærringsballon modstår et tryk fra vandet i afløbet på mere end 3m H<sub>2</sub>O (3 meter vandsøjle, eller 0,3 bar/30kPa).

**Toiee® Drain Plug** leveres komplet med afspærringsballon, slange, håndpumpe, pilotballon til trykkontrol samt trykudligningsventil.

**Toiee® Drain Plug** placeres i det pågældende afløbsrør inden et formodet skybrud. Hvis muligt, rengør afløbsrøret indvendig før montering. Kontrollér løbende at **Toiee® Drain Plug** holder trykket, ved at kontrollere pilotballonens hårdhed. Når risikoen for skybrud er overstået, fjernes **Toiee® Drain Plug** ved at tømme afspærringsballonen for luft gennem trykudligningsventilen, og trække i slangen.

**Toiee® Drain Plug** kan på ingen måde give samme beskyttelse som et regulært højt vandlukke installeret som en integreret del af afløbsinstallationen. Brug af **Toiee® Drain Plug** er altid på brugerens egen risiko. Ansvarsfraskrivelse: Producent, distributør og forhandler kan ikke på noget tidspunkt gøres erstatningspligtig for eventuelle skader opstået i forbindelse med brug af **Toiee® Drain Plug**. Dette gælder både hvis produktet taber tryk, revner eller på anden måde beskadiges, og der opstår oversvømmelse.

Anvendelse af **Toiee® Drain Plug** fritager ikke nogen for at tage almindelige fornuftige forholdsregler i forbindelse med risiko for oversvømmelse. Se råd om forebyggelse af skybrud på: [www.forsikringopension.dk](http://www.forsikringopension.dk) eller [www.bolius.dk](http://www.bolius.dk)

 **Toiee® Drain Plug** blocking balloon for sewer and drain is a simple tool, easy to use and developed to be helpful in many situations including preventing the risk of upcoming water from sewers and drains. **Toiee® Drain Plug** is available in all dimensions of drain pipes for the home: 32mm, 40/50mm, 75mm, and 110mm.

**Toiee® Drain Plug** has been tested by the internationally certified test center DTI, The Danish Technological Institute. The test proves that **Toiee® Drain Plug** blocking balloon resists a pressure of 3m H<sub>2</sub>O (3 meters of water pressure, or 0.3 bar/30kPa).

**Toiee® Drain Plug** tool set is ready to use. The tool set includes: Blocking balloon, air supply hose combined with a pilot balloon for checking the pressure of the blocking balloon, hand pump and a pressure release valve for emptying the blocking balloon.

**Toiee® Drain Plug** is placed in the sewer or drain before the risk of a flood. If possible clean the inside of the pipe first. From time to time check the pressure of the blocking balloon by controlling the hardness of the pilot balloon while the risk of flood is present. When the risk of a flood has passed, the blocking balloon is released by pressing the release valve and the blocking balloon is pulled out from the pipe by the air supply hose.

**Toiee® Drain Plug** will not provide the same protection as a professionally installed flood valve in a sewage installation. The use of **Toiee® Drain Plug** is at the risk of the individual user. The manufacturer, distributor and the dealers do not accept any liability of any charge related to the use of **Toiee® Drain Plug**, even if the product loses pressure, bursts or is subject to any other damage - and a flood occurs.

The usage of **Toiee® Drain Plug** does not excuse anybody from the responsibility of taking common reasonable precautions at the risk of a flood.

**Toiee® Danmark ApS**  
www.toiee.dk - Toiee® nr.: 201  
Distribution: www.vvs-trading.dk  
Nr. 1911.  
DB nr.: 1897042

