

# vanmade gear™ EASY INSTRUCTIONS FOR MOUNTING & STORING YOUR SHADES

This graphic will give you a simple rundown about how to easily mount your shades and properly store them for longevity.

1.

Our standard shades are quick and easy to mount!  
Align the magnetic border of the shade to the exposed metal around the window frame.  
**!Tip: Our VMG tag should be visible or you may be trying to mount the wrong side. !**

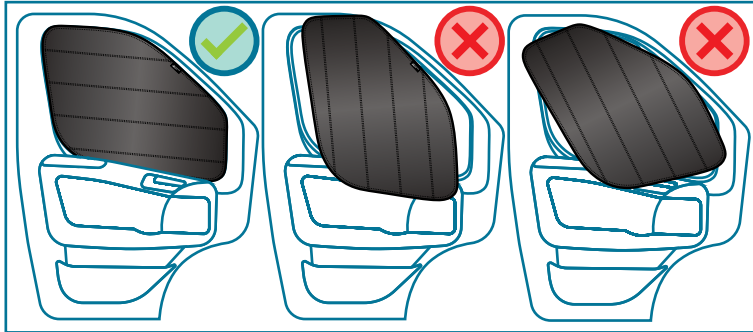

2.

To begin mounting your windshield shade, line the bottom edge along the bottom of the windshield glass. The top center slit has perforation folds so you can easily tuck the flaps behind the rearview mirror. Fold the visors down to secure it.  
**!Note: The shade is wider than the windshield so the right and left edges can be folded inward for complete shade with no light leaks. !**

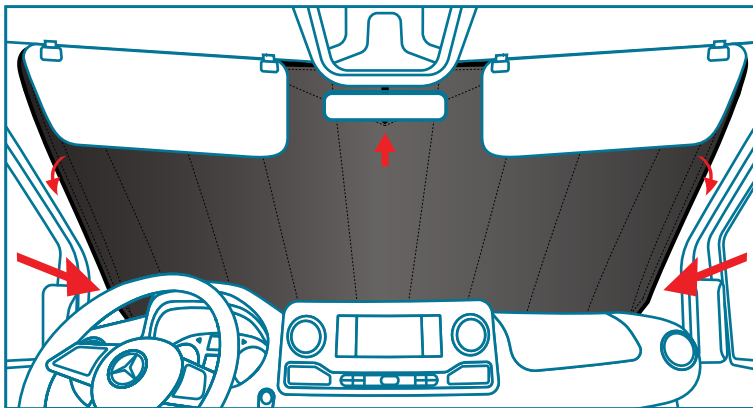

3.

VISIT OUR WEBSITE FOR MORE!

If you've purchased some of our specialized shades and are looking for more instructions and tips on mounting them, follow this QR code to find a list of all of our product instructions!

Our team is happy to offer support Monday to Friday, 8:30AM-4:30PM PST. You can call (503) 941-0741, or find our Contact form on the website.



4.

Our cab sets (windshield and front door shades) fold up *accordion style* and can be stored in our VMG windshield shade storage bags. Your windshield shade comes in this handy bag and it can be purchased on the site if you only have front door shades.

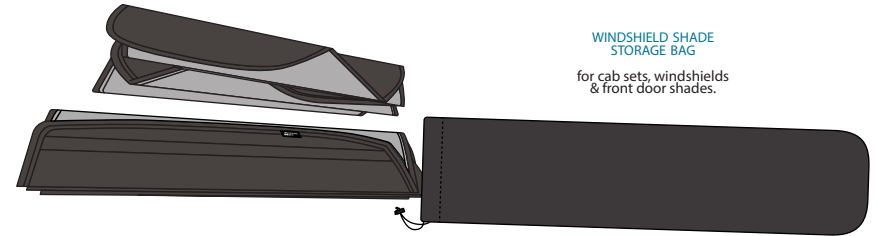

5.

Most of our other standard shades are equipped with magnetic fidlock straps. These shades are better stored *rolled up* rather than accordion style.

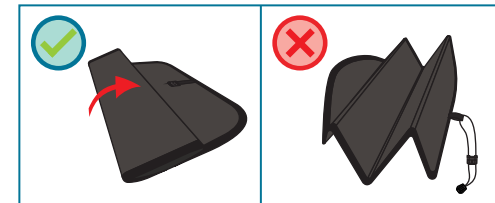

Once the shade is rolled up, the bungee end of the fidlock wraps around the shade to connect to the strap end fidlock. Both ends should easily snap together magnetically. Other shades may utilize a simple buckle or toggles so they can be rolled up and stored.

